



Wyss Associates, Inc.
 Landscape Architecture
 Civil Engineering
 Planning
 4000 Hennepin Avenue, Suite 200
 Minneapolis, MN 55412
 Tel: 612-338-3333 Fax: 612-338-3333
 www.wyssassociates.com



Designed By: Drawn By:
 MCF / TJA/M
 Check Date: CML / ASW
 Project No: RES. 2010 02-28-10
 Revision No: 05113
 Prepared By: Survey Date:
 FMS/ELI, AUCD 2008
 Approved: _____

POWOW GARDENS & ART MARKET

**CITY OF RAPID CITY
 GRADING MANAGEMENT DEPT
 DEVELOPMENT SERVICES**

These are copies of the plans of construction with necessary amendments, specifications, design sheets and supporting documents. This City of Rapid City does not warrant the liability, accuracy or completeness of the information contained in the plans, drawings or documents. It is the responsibility of the contractor to determine the accuracy of the information contained in the plans, drawings and documents prior to construction of the proposed project. Please see documents.

Engineering Review: _____
 Date: _____

GRADING PLAN

Sheet No. 01 of 31

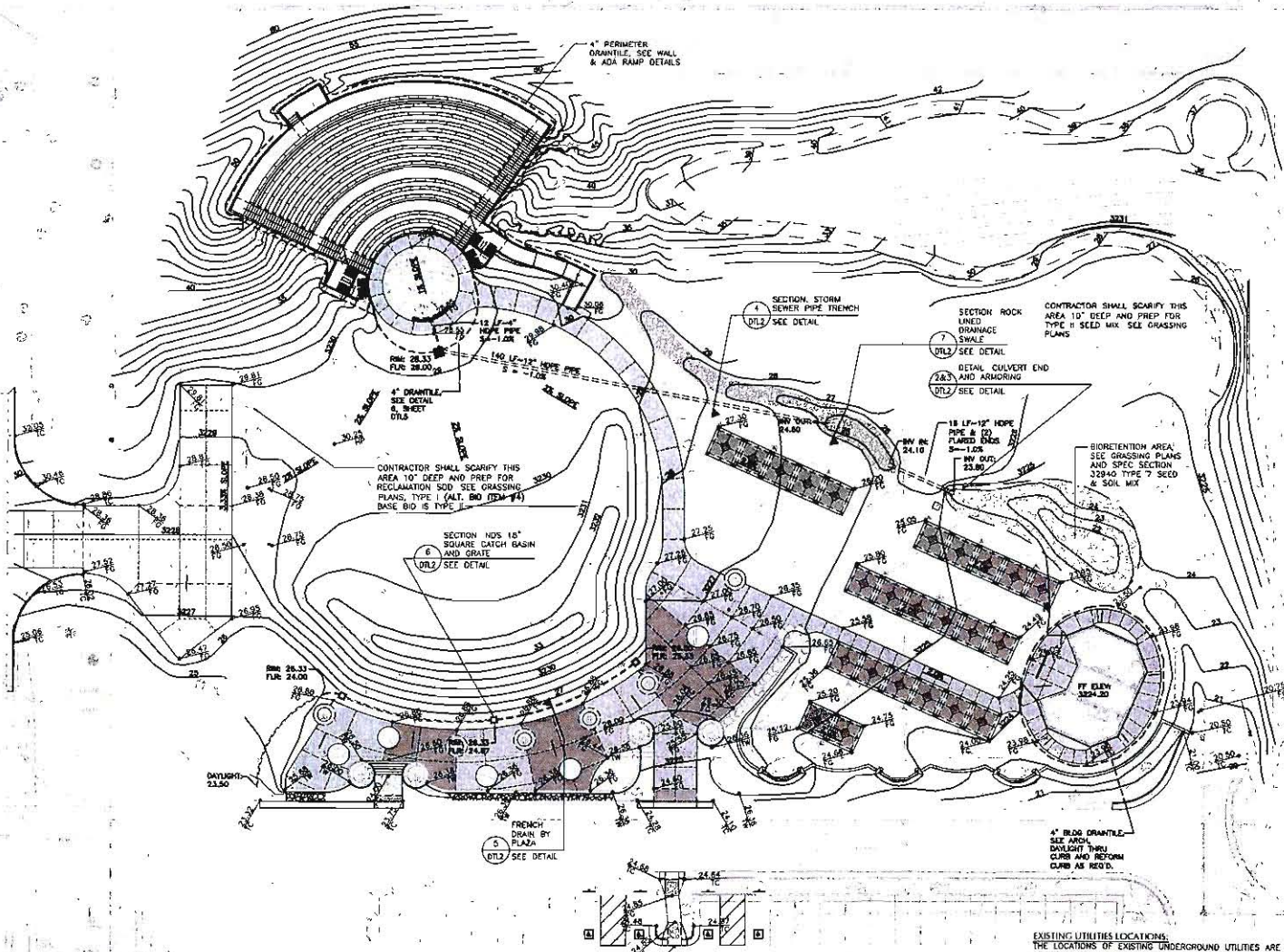

GRADING NOTES.

- BEFORE COMMENCING ANY CONSTRUCTION ACTIVITY, INSTALL A TEMPORARY ROCK CONSTRUCTION ENTRANCE AT EACH POINT WHERE VEHICLES EXIT THE CONSTRUCTION SITE. ROCK ENTRANCE SHALL CONSIST OF A 50 FOOT LONG 18 FOOT WIDE CURVED CONCRETE GRAVEL AGGREGATE MAT. LAY GEO-TEXTILE FABRIC BENEATH THE AGGREGATE. STRATEGICALLY PLACE CURBS TO PROTECT STOCKPILES. SHALL BE USED AS A BARRIER OF SEDIMENTATION RUNOFF. COORDINATE WITH LANDSCAPE ARCHITECT THE LOCATION OF THESE STOCKPILES.
- CONTRACTOR SHALL LIMIT THE CONSTRUCTION ACTIVITY TO THE AREAS DEFINED WITHIN THE GRADED AREAS AS SHOWN ON THE GRADING PLAN. CONTRACTOR SHALL USE DUSTING VEGETATED GRASSLANDS & NATIVE VEGETATION AS A BARRIER FOR SEDIMENTATION RUNOFF. COORDINATE WITH LANDSCAPE ARCHITECT THE LOCATION OF THESE AREAS.
- CONTRACTOR SHALL LIMIT THE CONSTRUCTION ACTIVITY TO THE AREAS DEFINED WITHIN THE GRADED AREAS AS SHOWN ON THE GRADING PLAN. CONTRACTOR SHALL USE DUSTING VEGETATED GRASSLANDS & NATIVE VEGETATION AS A BARRIER FOR SEDIMENTATION RUNOFF. COORDINATE WITH LANDSCAPE ARCHITECT THE LOCATION OF THESE AREAS.
- CONTRACTOR SHALL LIMIT THE CONSTRUCTION ACTIVITY TO THE AREAS DEFINED WITHIN THE GRADED AREAS AS SHOWN ON THE GRADING PLAN. CONTRACTOR SHALL USE DUSTING VEGETATED GRASSLANDS & NATIVE VEGETATION AS A BARRIER FOR SEDIMENTATION RUNOFF. COORDINATE WITH LANDSCAPE ARCHITECT THE LOCATION OF THESE AREAS.
- CONTRACTOR SHALL LIMIT THE CONSTRUCTION ACTIVITY TO THE AREAS DEFINED WITHIN THE GRADED AREAS AS SHOWN ON THE GRADING PLAN. CONTRACTOR SHALL USE DUSTING VEGETATED GRASSLANDS & NATIVE VEGETATION AS A BARRIER FOR SEDIMENTATION RUNOFF. COORDINATE WITH LANDSCAPE ARCHITECT THE LOCATION OF THESE AREAS.
- CONTRACTOR SHALL LIMIT THE CONSTRUCTION ACTIVITY TO THE AREAS DEFINED WITHIN THE GRADED AREAS AS SHOWN ON THE GRADING PLAN. CONTRACTOR SHALL USE DUSTING VEGETATED GRASSLANDS & NATIVE VEGETATION AS A BARRIER FOR SEDIMENTATION RUNOFF. COORDINATE WITH LANDSCAPE ARCHITECT THE LOCATION OF THESE AREAS.
- CONTRACTOR SHALL LIMIT THE CONSTRUCTION ACTIVITY TO THE AREAS DEFINED WITHIN THE GRADED AREAS AS SHOWN ON THE GRADING PLAN. CONTRACTOR SHALL USE DUSTING VEGETATED GRASSLANDS & NATIVE VEGETATION AS A BARRIER FOR SEDIMENTATION RUNOFF. COORDINATE WITH LANDSCAPE ARCHITECT THE LOCATION OF THESE AREAS.
- CONTRACTOR SHALL LIMIT THE CONSTRUCTION ACTIVITY TO THE AREAS DEFINED WITHIN THE GRADED AREAS AS SHOWN ON THE GRADING PLAN. CONTRACTOR SHALL USE DUSTING VEGETATED GRASSLANDS & NATIVE VEGETATION AS A BARRIER FOR SEDIMENTATION RUNOFF. COORDINATE WITH LANDSCAPE ARCHITECT THE LOCATION OF THESE AREAS.
- CONTRACTOR SHALL LIMIT THE CONSTRUCTION ACTIVITY TO THE AREAS DEFINED WITHIN THE GRADED AREAS AS SHOWN ON THE GRADING PLAN. CONTRACTOR SHALL USE DUSTING VEGETATED GRASSLANDS & NATIVE VEGETATION AS A BARRIER FOR SEDIMENTATION RUNOFF. COORDINATE WITH LANDSCAPE ARCHITECT THE LOCATION OF THESE AREAS.
- CONTRACTOR SHALL LIMIT THE CONSTRUCTION ACTIVITY TO THE AREAS DEFINED WITHIN THE GRADED AREAS AS SHOWN ON THE GRADING PLAN. CONTRACTOR SHALL USE DUSTING VEGETATED GRASSLANDS & NATIVE VEGETATION AS A BARRIER FOR SEDIMENTATION RUNOFF. COORDINATE WITH LANDSCAPE ARCHITECT THE LOCATION OF THESE AREAS.
- CONTRACTOR SHALL LIMIT THE CONSTRUCTION ACTIVITY TO THE AREAS DEFINED WITHIN THE GRADED AREAS AS SHOWN ON THE GRADING PLAN. CONTRACTOR SHALL USE DUSTING VEGETATED GRASSLANDS & NATIVE VEGETATION AS A BARRIER FOR SEDIMENTATION RUNOFF. COORDINATE WITH LANDSCAPE ARCHITECT THE LOCATION OF THESE AREAS.
- CONTRACTOR SHALL LIMIT THE CONSTRUCTION ACTIVITY TO THE AREAS DEFINED WITHIN THE GRADED AREAS AS SHOWN ON THE GRADING PLAN. CONTRACTOR SHALL USE DUSTING VEGETATED GRASSLANDS & NATIVE VEGETATION AS A BARRIER FOR SEDIMENTATION RUNOFF. COORDINATE WITH LANDSCAPE ARCHITECT THE LOCATION OF THESE AREAS.

**CITY OF RAPID CITY
 GRADING MANAGEMENT DEPT
 DEVELOPMENT SERVICES**

These are copies of the plans of construction with necessary amendments, specifications, design sheets and supporting documents. This City of Rapid City does not warrant the liability, accuracy or completeness of the information contained in the plans, drawings or documents. It is the responsibility of the contractor to determine the accuracy of the information contained in the plans, drawings and documents prior to construction of the proposed project. Please see documents.

Engineering Review: _____
 Date: _____

EXISTING UTILITIES LOCATIONS.
 THE LOCATIONS OF EXISTING UNDERGROUND UTILITIES ARE SHOWN IN AN APPROXIMATE WAY ONLY AND HAVE NOT BEEN INDEPENDENTLY VERIFIED BY THE OWNERS OR HIS REPRESENTATIVE. THE CONTRACTOR SHALL DETERMINE THE EXACT LOCATION OF ALL EXISTING UTILITIES BEFORE COMMENCING WORK, AND AGREES TO BE FULLY RESPONSIBLE FOR ANY AND ALL DAMAGES WHICH MIGHT BE OCCASIONED BY THE CONTRACTOR'S FAILURE TO EXACTLY LOCATE AND PRESERVE ANY AND ALL UNDERGROUND UTILITIES. CONTACT THE SOUTH DAKOTA ONE CALL NOTIFICATION CENTER 2025 CENTRE POINTE BOULEVARD #310 MENARDIA HEIGHTS, MN 55120 1-800-781-7474