



Ferber Engineering Company, Inc.
TEC
 Civil Engineering • Water Resources • Transportation • Land Surveying
 225 East Westmore St., Rapid City, SD 57701 • Phone: (605) 343-3311



CITY OF RAPID CITY
 JACKSON SPRINGS WATER TREATMENT PLANT
 CITY PROJECT WTP10-1858
 RAPID CITY, SD

VICINITY
 MAP
 1

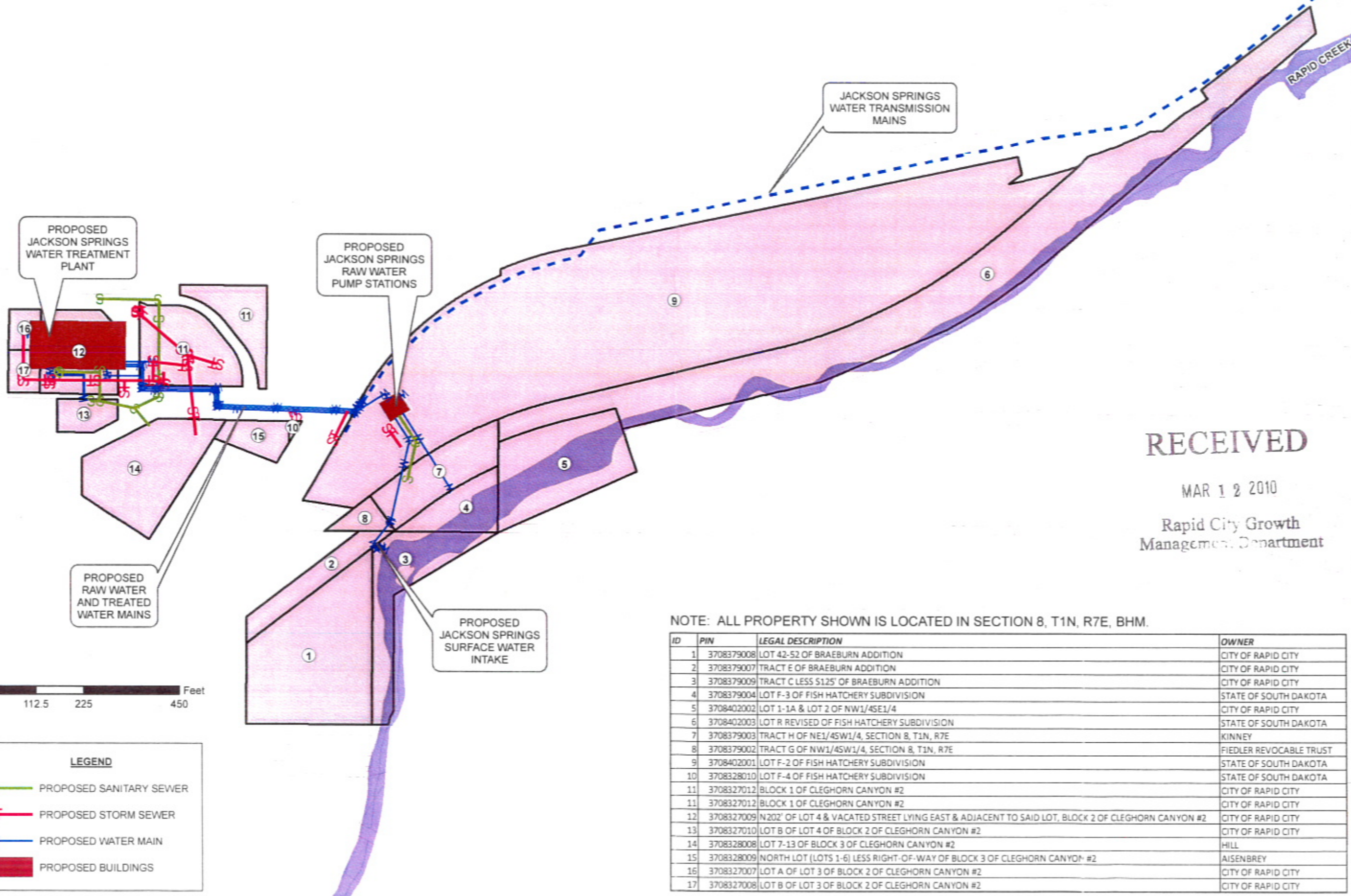

RECEIVED
 MAR 12 2010
 Rapid City Growth
 Management Department

NOTE: ALL PROPERTY SHOWN IS LOCATED IN SECTION 8, T1N, R7E, BHM.

ID	PIN	LEGAL DESCRIPTION	OWNER
1	3708379008	LOT 42-52 OF BRAEBURN ADDITION	CITY OF RAPID CITY
2	3708379007	TRACT E OF BRAEBURN ADDITION	CITY OF RAPID CITY
3	3708379009	TRACT C LESS S125' OF BRAEBURN ADDITION	CITY OF RAPID CITY
4	3708379004	LOT F-3 OF FISH HATCHERY SUBDIVISION	STATE OF SOUTH DAKOTA
5	3708402002	LOT 1-1A & LOT 2 OF NW1/4SE1/4	CITY OF RAPID CITY
6	3708402003	LOT R REVISED OF FISH HATCHERY SUBDIVISION	STATE OF SOUTH DAKOTA
7	3708379003	TRACT H OF NE1/4SW1/4, SECTION 8, T1N, R7E	KINNEY
8	3708379002	TRACT G OF NW1/4SW1/4, SECTION 8, T1N, R7E	FIEDLER REVOCABLE TRUST
9	3708402001	LOT F-2 OF FISH HATCHERY SUBDIVISION	STATE OF SOUTH DAKOTA
10	3708328010	LOT F-4 OF FISH HATCHERY SUBDIVISION	STATE OF SOUTH DAKOTA
11	3708327012	BLOCK 1 OF CLEGHORN CANYON #2	CITY OF RAPID CITY
11	3708327012	BLOCK 1 OF CLEGHORN CANYON #2	CITY OF RAPID CITY
12	3708327009	N202' OF LOT 4 & VACATED STREET LYING EAST & ADJACENT TO SAID LOT, BLOCK 2 OF CLEGHORN CANYON #2	CITY OF RAPID CITY
13	3708327010	LOT 8 OF LOT 4 OF BLOCK 2 OF CLEGHORN CANYON #2	CITY OF RAPID CITY
14	3708328008	LOT 7-13 OF BLOCK 3 OF CLEGHORN CANYON #2	HILL
15	3708328009	NORTH LOT (LOTS 1-6) LESS RIGHT-OF-WAY OF BLOCK 3 OF CLEGHORN CANYON #2	AISENBREY
16	3708327007	LOT A OF LOT 3 OF BLOCK 2 OF CLEGHORN CANYON #2	CITY OF RAPID CITY
17	3708327008	LOT B OF LOT 3 OF BLOCK 2 OF CLEGHORN CANYON #2	CITY OF RAPID CITY



LEGEND

- PROPOSED SANITARY SEWER
- PROPOSED STORM SEWER
- PROPOSED WATER MAIN
- PROPOSED BUILDINGS