

## AREA 'B' - PLANNED DEVELOPMENT SUBMITTAL

# VILLAGE AT FOUNDER'S PARK

RAPID CITY, SOUTH DAKOTA

DATE: 8-10-07

### AREA 'B' LOT 8 - PUD SUBMITTAL

TITLE SHEET

PLAT PLAN

SITE DEVELOPMENT PLAN (8.1)

SITE PLAN (1.10)

TRASH ENCLOSURE

VILLAGE ENTRANCE SIGN 'A'

BUILDING IDENTIFICATION SIGN 'B'

OUTDOOR MECHANICAL ENCLOSURE

BASEMENT FLOOR PLAN

FIRST FLOOR PLAN

SECOND FLOOR PLAN

BUILDING ELEVATION

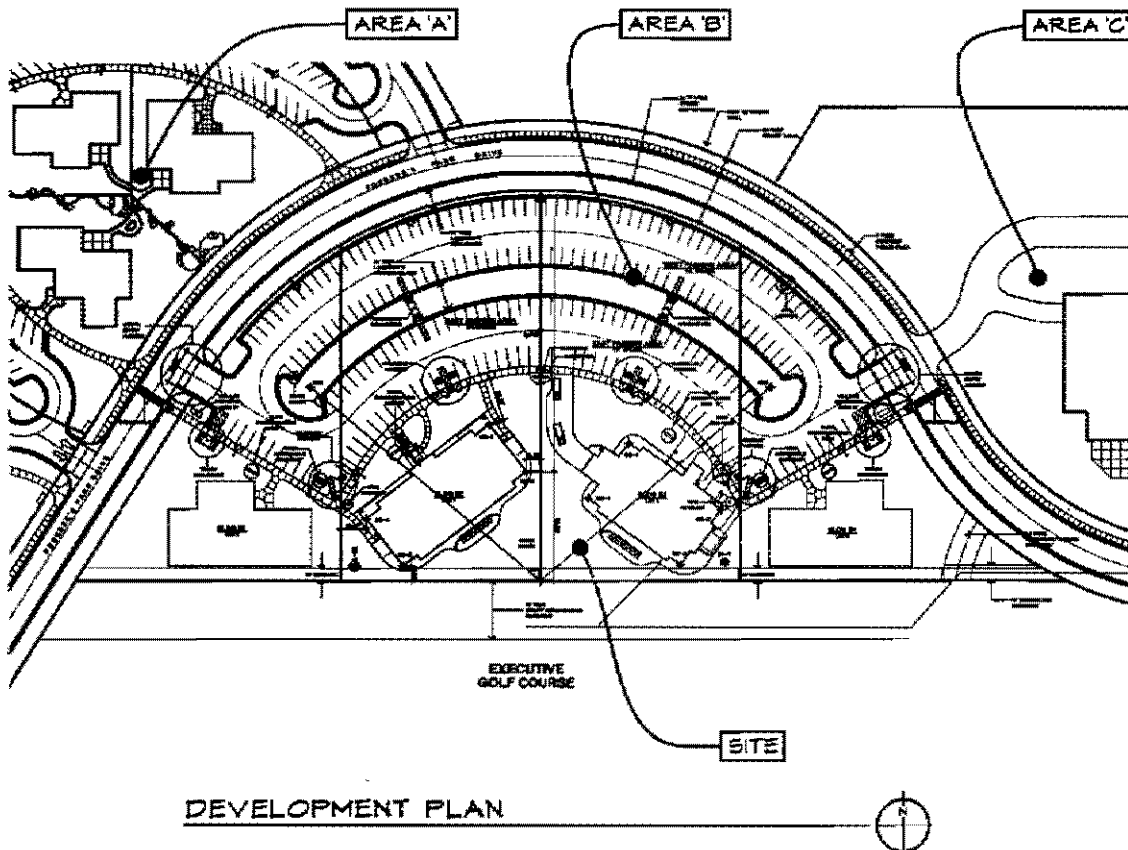

DEVELOPMENT PLAN

#### OWNER:

FOUNDER'S PARK, LLC  
1118 LINDEN STREET  
RAPID CITY, SD 57701  
TEL: 605/342-1111  
FAX: 605/342-1112

#### LAND PLANNING:

LANDSCAPE ARCHITECTURE  
1118 LINDEN STREET  
RAPID CITY, SD 57701  
TEL: 605/342-1111  
FAX: 605/342-1112

#### CIVIL ENGINEERING:

CIVIL ENGINEER  
1118 LINDEN STREET  
RAPID CITY, SD 57701  
TEL: 605/342-1111  
FAX: 605/342-1112

#### ARCHITECTURE:

ARCHITECTURE  
1118 LINDEN STREET  
RAPID CITY, SD 57701  
TEL: 605/342-1111  
FAX: 605/342-1112