

**1** DETAIL: LIME CREEK COUNCIL RING  
L2.25 SCALE: 1/4" = 1'-0"

GENERAL NOTE:  
1. BOULDERS TO BE PROVIDED BY OWNER AND PLACED BY CONTRACTOR. BOULDERS FOR SEATING CIRCLES CHARACTERISTICS SHALL BE APPROX. WIDTH: 2'-3', HT: 18"-24", LENGTH: 3'-5'  
2. BOULDERS TO BE FREE OF ABRASIONS, SCARS AND EXTREMELY SHARP CHARACTERISTICS

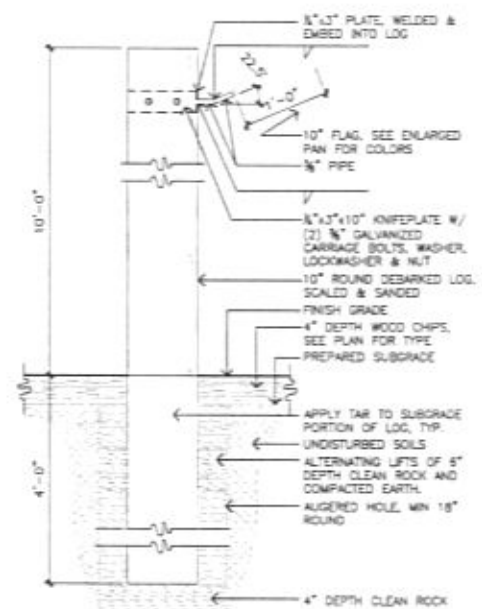

**2** DETAIL: TOTEM POLE  
L2.25 SCALE: 1" = 1'-0"

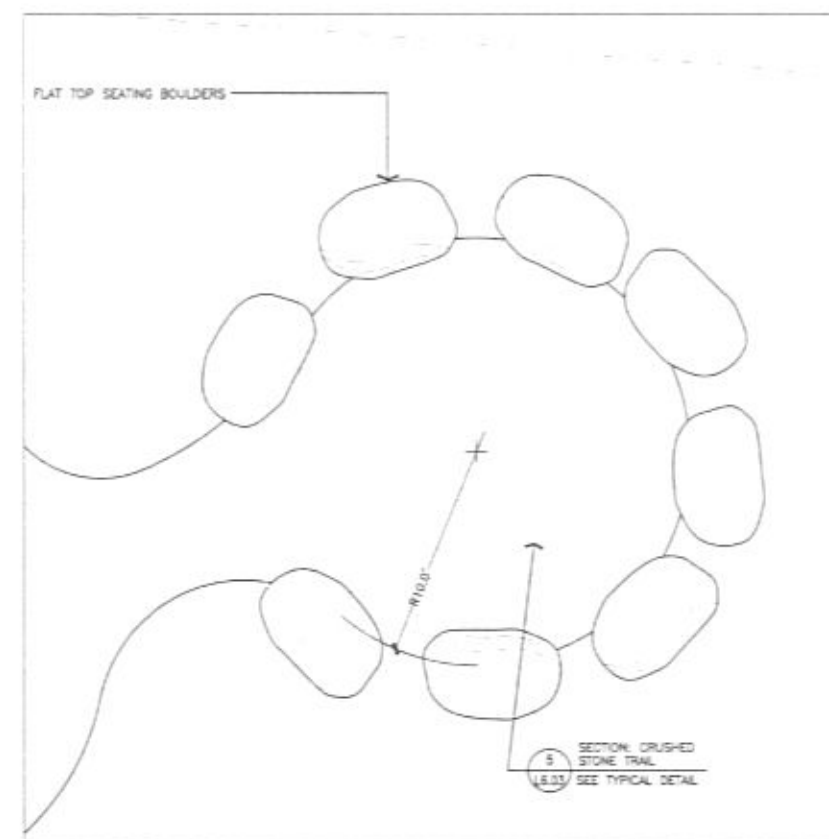

**3** DETAIL: STONE HENGE COUNCIL RING  
L2.25 SCALE: 1/4" = 1'-0"

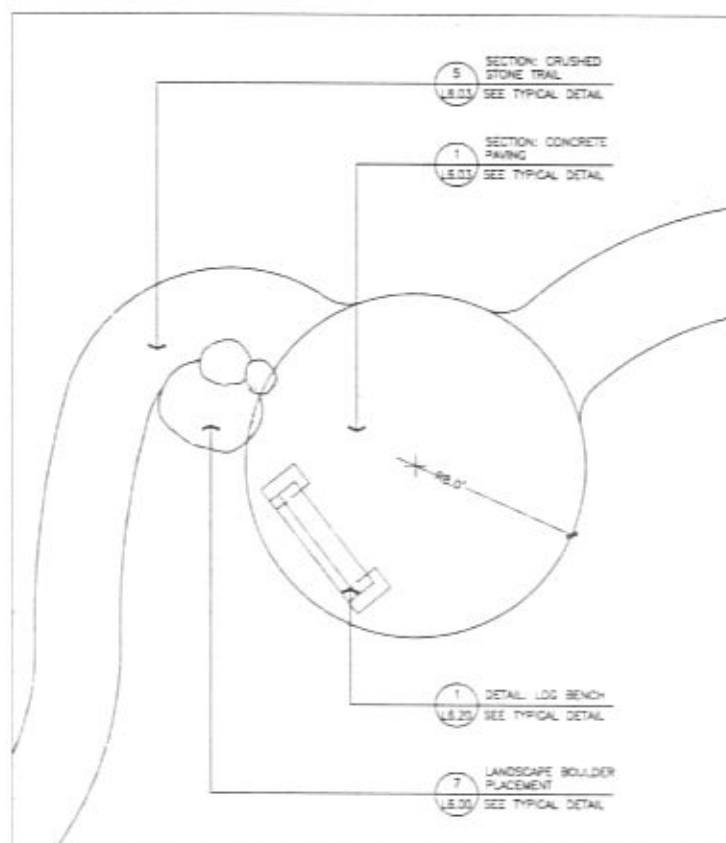

**4** DETAIL: CONCRETE SEATING AREA  
L2.25 SCALE: 1/4" = 1'-0"

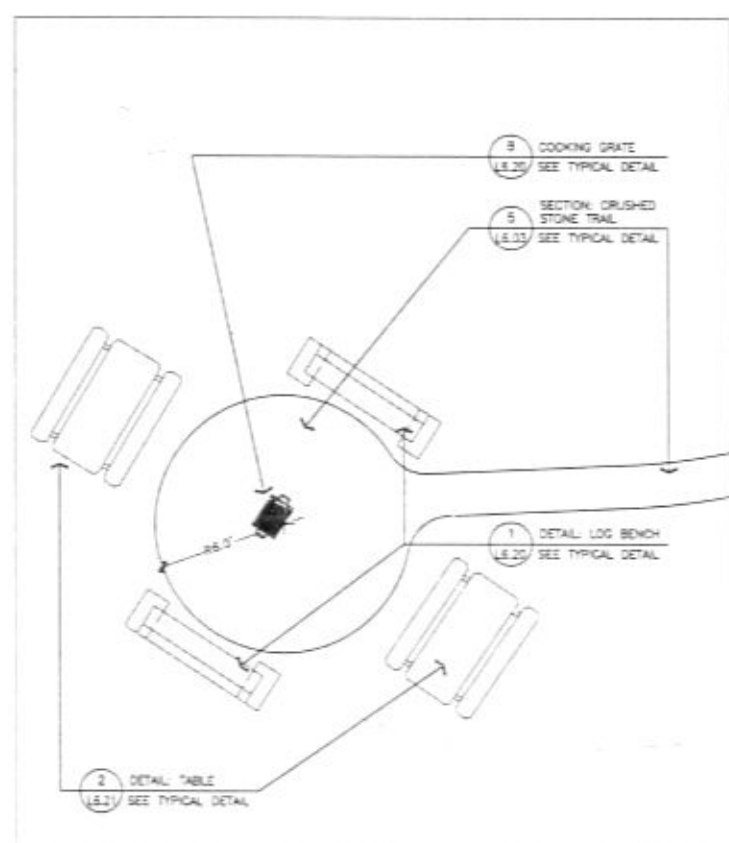

**5** DETAIL: PICNIC / SEATING AREA  
L2.25 SCALE: 1/4" = 1'-0"

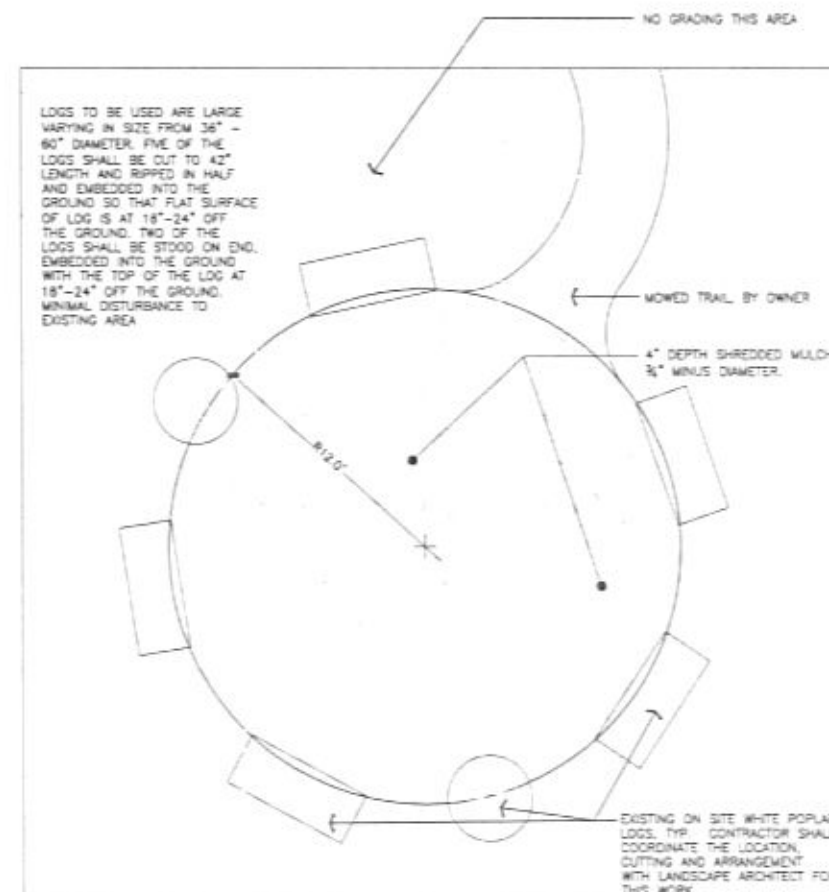

**6** DETAIL: POPLAR GROVE COUNCIL RING  
L2.25 SCALE: 1/4" = 1'-0"

ARCHITECT:  
**ARC** H I T E C T U R E  
I N T E R N A T I O N A L  
205 NORTH LAKEWOOD  
RAPID CITY, SOUTH DAKOTA 57702  
605.343.9608  
WWW.ARCINTERNATIONAL.COM  
BRINGING ARCHITECTURE TO YOUR WORLD

CIVIL ENGINEER:  
**Ferfer**  
Engineering  
Company, Inc.  
205 NORTH LAKEWOOD  
RAPID CITY, SOUTH DAKOTA 57702  
605.343.9608  
CONTACT: DAVE MUCKE

STRUCTURAL ENGINEER:  
3202 West Main  
Suite C  
Rapid City, South Dakota 57702  
605.343.9608  
**Albertson Engineering Inc.**  
CONTACT: DAVID LEFFERT

MECHANICAL/ELECTRICAL ENGINEER:  
**WPE** WEST PLAINS  
ENGINEERING INC.  
1750 BRAND ROAD • RAPID CITY, SD 57702  
PHONE: 605.348-7452 • FAX: 605.348-9442  
WWW.WESTPLAINSENGINEERING.COM  
CONTACT: DOUG FERFER, DAVID BERG

LANDSCAPE ARCHITECT:  
**Wyss**  
Associates, Inc.  
Landscape Architecture • Civil/Structural/Architectural • Park & Recreation Design  
125 East Main • Rapid City, South Dakota 57701-9775 • 605.342.1258 • 605.342.1259  
WWW.WYSSASSOCIATES.COM  
CONTACT: MATT FROELL

DATE: NOVEMBER 12, 2009  
PROJECT MANAGER: MATTHEW D. FROELL  
PROJECT NUMBER: 2005-017

REGISTERED LANDSCAPE ARCHITECT  
NO. 8223  
MATTHEW D. FROELL  
SOUTH DAKOTA  
11/18/2009

OUTDOOR CAMPUS  
South Dakota Game, Fish & Parks  
RAPID CITY, SOUTH DAKOTA

SITE DETAILS

**L2.25**