

SITE PLAN NOTES

BASE DRAWING IS COMPILED FROM RAPID CITY'S OUTLAND FIELD SURVEY

PROJECT LOCATION

Address - 514 City Springs Road
 - adjacent City Building at 514, 516 & 518 City Springs Rd
 R.T.E. Section 72
 Location
 Area - 2.72

PROJECT DESCRIPTION

Improvements to the play equipment were through an adult process and was approved by the city council in 2008. For a number of years the city has approved that many have been removed. The remaining play equipment consists of a wooden play structure with 2 swing sets and 2 sets of slides. Most of the existing equipment has reached play value in its poor condition and should be removed.

PROJECT OBJECTIVES

The main goal of this project is to renovate the playground and to add a new structure to the play area while preserving the green space and mature trees in the area. There will be a new play structure that has a play area in front of the structure and a ramp to the playground. There will be a small plaza on the south-east corner of the playground. The plaza will have benches and a trash receptacle and will be paved for about 2000 square feet. The play area will be equipped for 100 play (ages 1-5). The area will have 2 swing sets, 1 sand digger and 1 play structure. To be installed in the area will be a ramp to the play area. The play area will be installed around the existing play area. The area will be paved for the other play area (ages 5-12). The area will consist of a sand digger and 1 slide. The area will be paved with asphalt and will be a ramp to the play area.

The major items to be installed are as follows:

- Children's Observation Viewing Area
- Outdoor Play Area
- Play Equipment
- Benches and Trash Receptacles
- Ornamental Landscaping
- Gateway Feature

PARKING PROVIDED	
ITEM	POINTS
TOTAL SITE AREA	1,161,230sf
TOTAL DEVELOPED AREA	42,000sf
BUILDING STRUCTURE AREA	12,228sf
EXISTING PARKING PROVIDED	48 total, including 2 ADA spaces

11 ADA spaces are provided for the site in the parking lot.

Note: All parking is existing. This project is a renovation, not new development. The existing parking spaces for each space are shown in the site plan. The dimensions and areas shown are for the existing parking spaces.

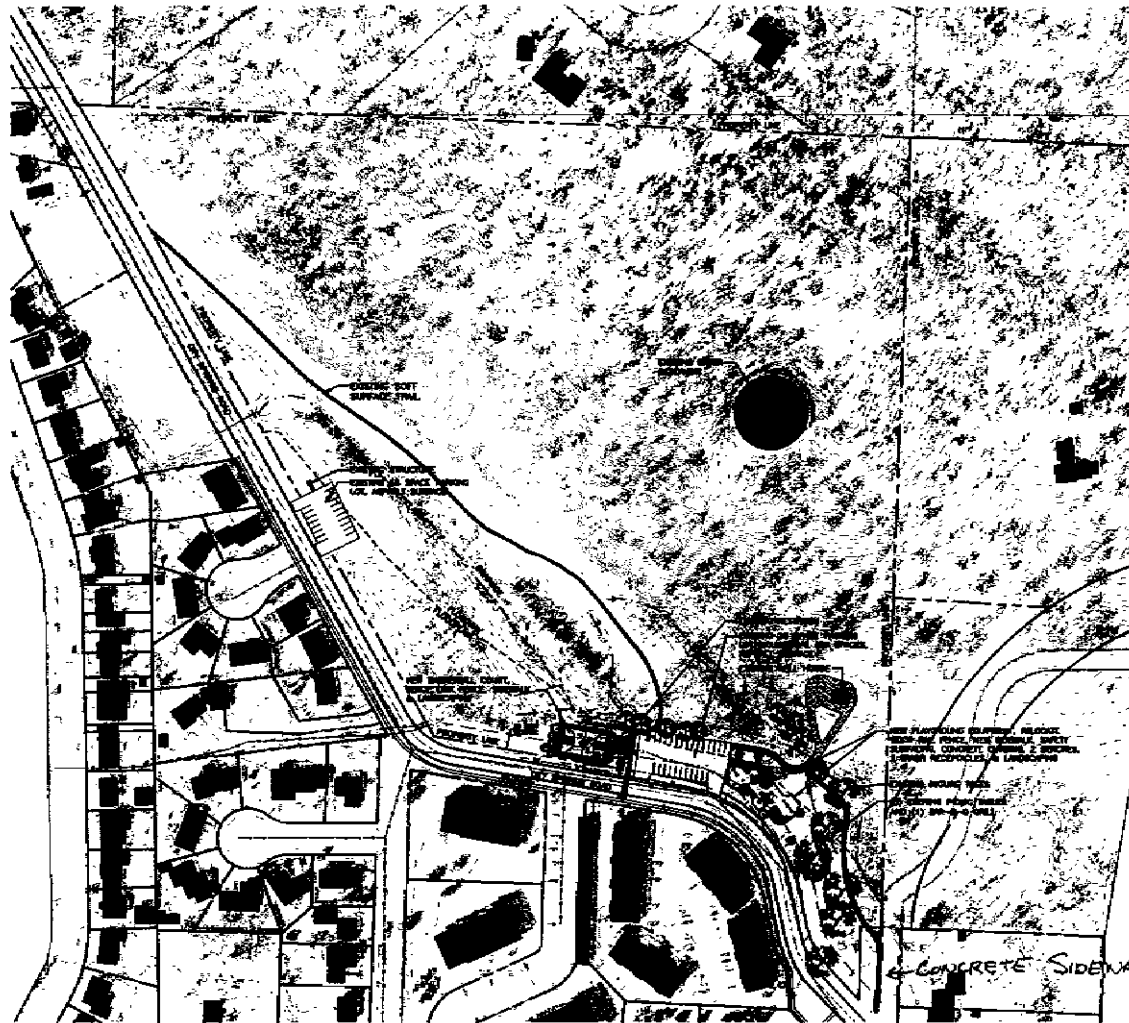

EXISTING PLAY EQUIPMENT TO BE REMOVED AND REPLACED WITH NEW PLAY EQUIPMENT. THE EXISTING PLAY EQUIPMENT IS LOCATED IN THE PLAY AREA. THE NEW PLAY EQUIPMENT IS LOCATED IN THE PLAY AREA. THE EXISTING PLAY EQUIPMENT IS LOCATED IN THE PLAY AREA. THE NEW PLAY EQUIPMENT IS LOCATED IN THE PLAY AREA.

CONCRETE SIDEWALK

RAMP (ADA)

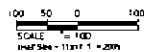

CITY of RAPID CITY
 PLANNING & DEVELOPMENT DEPARTMENT

DATE	BY	FOR
APR 2008	PL	PL
MAY 2008	PL	PL
JUN 2008	PL	PL
JUL 2008	PL	PL
AUG 2008	PL	PL
SEP 2008	PL	PL
OCT 2008	PL	PL
NOV 2008	PL	PL
DEC 2008	PL	PL
JAN 2009	PL	PL
FEB 2009	PL	PL
MAR 2009	PL	PL
APR 2009	PL	PL
MAY 2009	PL	PL
JUN 2009	PL	PL
JUL 2009	PL	PL
AUG 2009	PL	PL
SEP 2009	PL	PL
OCT 2009	PL	PL
NOV 2009	PL	PL
DEC 2009	PL	PL
JAN 2010	PL	PL
FEB 2010	PL	PL
MAR 2010	PL	PL
APR 2010	PL	PL
MAY 2010	PL	PL
JUN 2010	PL	PL
JUL 2010	PL	PL
AUG 2010	PL	PL
SEP 2010	PL	PL
OCT 2010	PL	PL
NOV 2010	PL	PL
DEC 2010	PL	PL
JAN 2011	PL	PL
FEB 2011	PL	PL
MAR 2011	PL	PL
APR 2011	PL	PL
MAY 2011	PL	PL
JUN 2011	PL	PL
JUL 2011	PL	PL
AUG 2011	PL	PL
SEP 2011	PL	PL
OCT 2011	PL	PL
NOV 2011	PL	PL
DEC 2011	PL	PL
JAN 2012	PL	PL
FEB 2012	PL	PL
MAR 2012	PL	PL
APR 2012	PL	PL
MAY 2012	PL	PL
JUN 2012	PL	PL
JUL 2012	PL	PL
AUG 2012	PL	PL
SEP 2012	PL	PL
OCT 2012	PL	PL
NOV 2012	PL	PL
DEC 2012	PL	PL
JAN 2013	PL	PL
FEB 2013	PL	PL
MAR 2013	PL	PL
APR 2013	PL	PL
MAY 2013	PL	PL
JUN 2013	PL	PL
JUL 2013	PL	PL
AUG 2013	PL	PL
SEP 2013	PL	PL
OCT 2013	PL	PL
NOV 2013	PL	PL
DEC 2013	PL	PL
JAN 2014	PL	PL
FEB 2014	PL	PL
MAR 2014	PL	PL
APR 2014	PL	PL
MAY 2014	PL	PL
JUN 2014	PL	PL
JUL 2014	PL	PL
AUG 2014	PL	PL
SEP 2014	PL	PL
OCT 2014	PL	PL
NOV 2014	PL	PL
DEC 2014	PL	PL
JAN 2015	PL	PL
FEB 2015	PL	PL
MAR 2015	PL	PL
APR 2015	PL	PL
MAY 2015	PL	PL
JUN 2015	PL	PL
JUL 2015	PL	PL
AUG 2015	PL	PL
SEP 2015	PL	PL
OCT 2015	PL	PL
NOV 2015	PL	PL
DEC 2015	PL	PL
JAN 2016	PL	PL
FEB 2016	PL	PL
MAR 2016	PL	PL
APR 2016	PL	PL
MAY 2016	PL	PL
JUN 2016	PL	PL
JUL 2016	PL	PL
AUG 2016	PL	PL
SEP 2016	PL	PL
OCT 2016	PL	PL
NOV 2016	PL	PL
DEC 2016	PL	PL
JAN 2017	PL	PL
FEB 2017	PL	PL
MAR 2017	PL	PL
APR 2017	PL	PL
MAY 2017	PL	PL
JUN 2017	PL	PL
JUL 2017	PL	PL
AUG 2017	PL	PL
SEP 2017	PL	PL
OCT 2017	PL	PL
NOV 2017	PL	PL
DEC 2017	PL	PL
JAN 2018	PL	PL
FEB 2018	PL	PL
MAR 2018	PL	PL
APR 2018	PL	PL
MAY 2018	PL	PL
JUN 2018	PL	PL
JUL 2018	PL	PL
AUG 2018	PL	PL
SEP 2018	PL	PL
OCT 2018	PL	PL
NOV 2018	PL	PL
DEC 2018	PL	PL
JAN 2019	PL	PL
FEB 2019	PL	PL
MAR 2019	PL	PL
APR 2019	PL	PL
MAY 2019	PL	PL
JUN 2019	PL	PL
JUL 2019	PL	PL
AUG 2019	PL	PL
SEP 2019	PL	PL
OCT 2019	PL	PL
NOV 2019	PL	PL
DEC 2019	PL	PL
JAN 2020	PL	PL
FEB 2020	PL	PL
MAR 2020	PL	PL
APR 2020	PL	PL
MAY 2020	PL	PL
JUN 2020	PL	PL
JUL 2020	PL	PL
AUG 2020	PL	PL
SEP 2020	PL	PL
OCT 2020	PL	PL
NOV 2020	PL	PL
DEC 2020	PL	PL
JAN 2021	PL	PL
FEB 2021	PL	PL
MAR 2021	PL	PL
APR 2021	PL	PL
MAY 2021	PL	PL
JUN 2021	PL	PL
JUL 2021	PL	PL
AUG 2021	PL	PL
SEP 2021	PL	PL
OCT 2021	PL	PL
NOV 2021	PL	PL
DEC 2021	PL	PL
JAN 2022	PL	PL
FEB 2022	PL	PL
MAR 2022	PL	PL
APR 2022	PL	PL
MAY 2022	PL	PL
JUN 2022	PL	PL
JUL 2022	PL	PL
AUG 2022	PL	PL
SEP 2022	PL	PL
OCT 2022	PL	PL
NOV 2022	PL	PL
DEC 2022	PL	PL
JAN 2023	PL	PL
FEB 2023	PL	PL
MAR 2023	PL	PL
APR 2023	PL	PL
MAY 2023	PL	PL
JUN 2023	PL	PL
JUL 2023	PL	PL
AUG 2023	PL	PL
SEP 2023	PL	PL
OCT 2023	PL	PL
NOV 2023	PL	PL
DEC 2023	PL	PL
JAN 2024	PL	PL
FEB 2024	PL	PL
MAR 2024	PL	PL
APR 2024	PL	PL
MAY 2024	PL	PL
JUN 2024	PL	PL
JUL 2024	PL	PL
AUG 2024	PL	PL
SEP 2024	PL	PL
OCT 2024	PL	PL
NOV 2024	PL	PL
DEC 2024	PL	PL
JAN 2025	PL	PL
FEB 2025	PL	PL
MAR 2025	PL	PL
APR 2025	PL	PL
MAY 2025	PL	PL
JUN 2025	PL	PL
JUL 2025	PL	PL
AUG 2025	PL	PL
SEP 2025	PL	PL
OCT 2025	PL	PL
NOV 2025	PL	PL
DEC 2025	PL	PL

**Wilderness Park
 Playground Renovation**