

JERRY J. WENDLAND
LAND SURVEYING
6909 Ridgeview Dr.
Black Hawk, SD
57718-9555

Tele: 605-787-4503 / Fax: 605-787-9454
ANGLE SURVEYS



1"=20'
0911013M

NOTE:
House encroaches
into easement

I, Jerry J. Wendland, Registered Land Surveyor #4224 in the State of South Dakota, do hereby certify that this drawing and the survey thereof were performed by me or under my direct supervision. The major improvements to the property are shown to the accuracy needed to satisfy the needs of a title company, mortgage company, and/or lender, and that any encroachments, in evidence or known to me, if any, are so noted or shown hereon. Dated this 11th day of November 2009.

**This is not a boundary survey,
not to be used to locate
additional improvements.**



Legal Description:
Lot 10, Block 7,
Red Rock Meadows
Rapid City, Pennington
County, South Dakota

Buyer:
Jeffrey & Diana Penney
6515 Seminole Lane
Rapid City, SD 57702

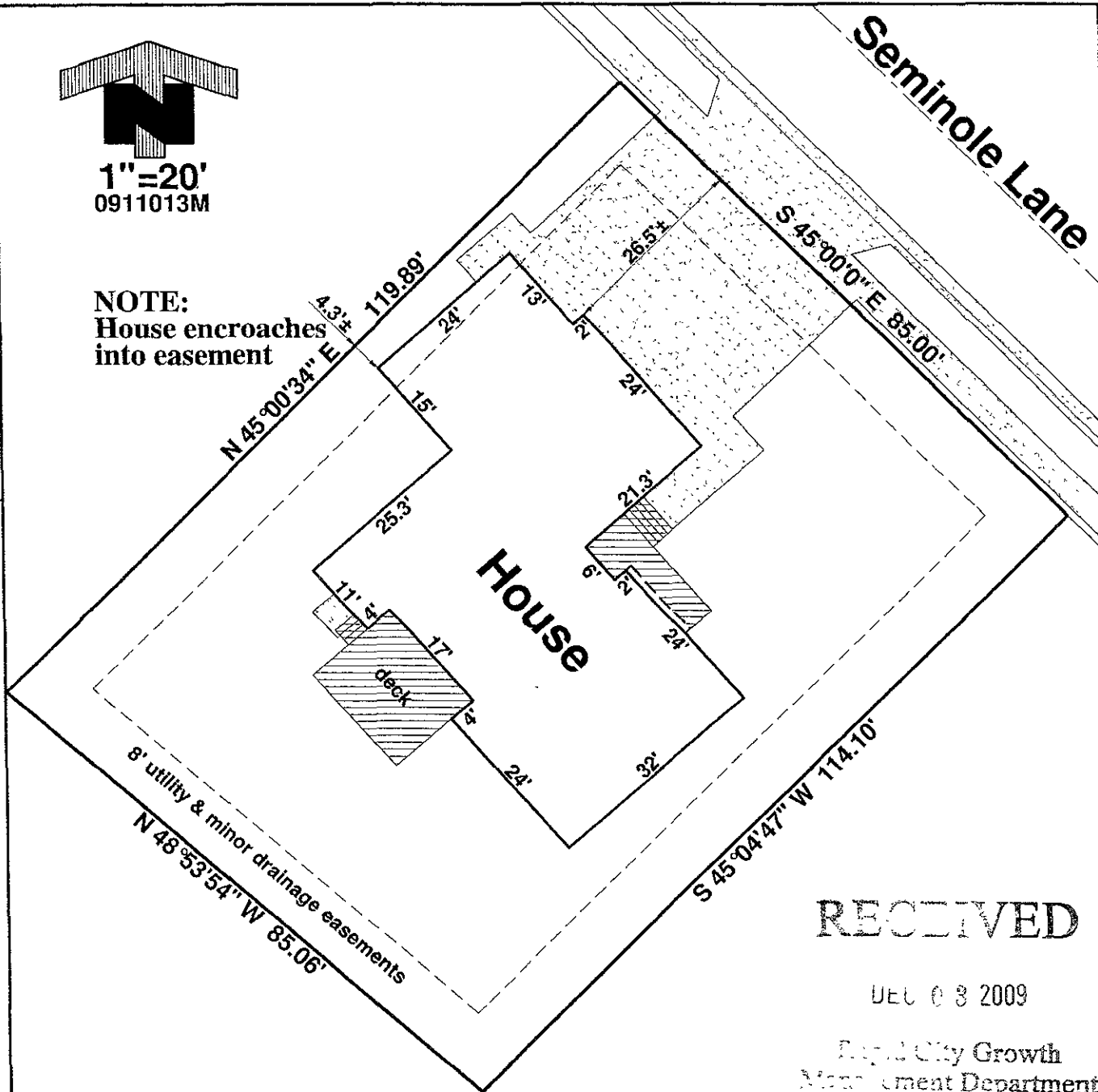

RECEIVED

DEC 08 2009

Rapid City Growth
Measurement Department