

- 1- 10e30" φ SHRUBS
- 2- 11" φ TREE @ ≈ 25' TALL
- 3- 7e 30" φ SHRUBS
- 4- 11" φ TREE @ ≈ 25' TALL
- 5- 12" φ TREE @ ≈ 25' TALL

#6 OWNER'S PARKING

Identify Results

Coordinate Position

NAD 1983 SP SD South FT: 1210070, 649677
 Geographic: 44° 4' 46.7" N, 103° 13' 12."

Tax Parcels

Parcel ID number: 3701208002
 Tax ID: 37477
 Property address: 201 MAIN ST
 Legal description: LOT 1-5 ORIGINAL TOWN OF RAPID CITY

Block: 88
 Subdivision: ORIGINAL TOWN OF RAPID CITY

Section: 1
 Township: 1
 Township direction: N
 Range: 7
 Range direction: E
 Acres: 0.4
 Property owner: TENSLEEP LLC
 Owner address: 201 MAIN ST STE 300
 Owner city: RAPID CITY
 Owner state: SD
 Owner zip: 57701

Land assessment: 262500
 Non-ag struct. assess.: 333700
 Ag structure assess.: 0
 Total assessment: 596200

Land use code: N
 Land type code: D
 Improvements code: 2
 Commercial use code: C

Tax districts code: 4D RC
 Subdivision code: 7480
 Deed type: DE

Deed recording month: 02
 Deed recording day: 28
 Deed recording year: 09



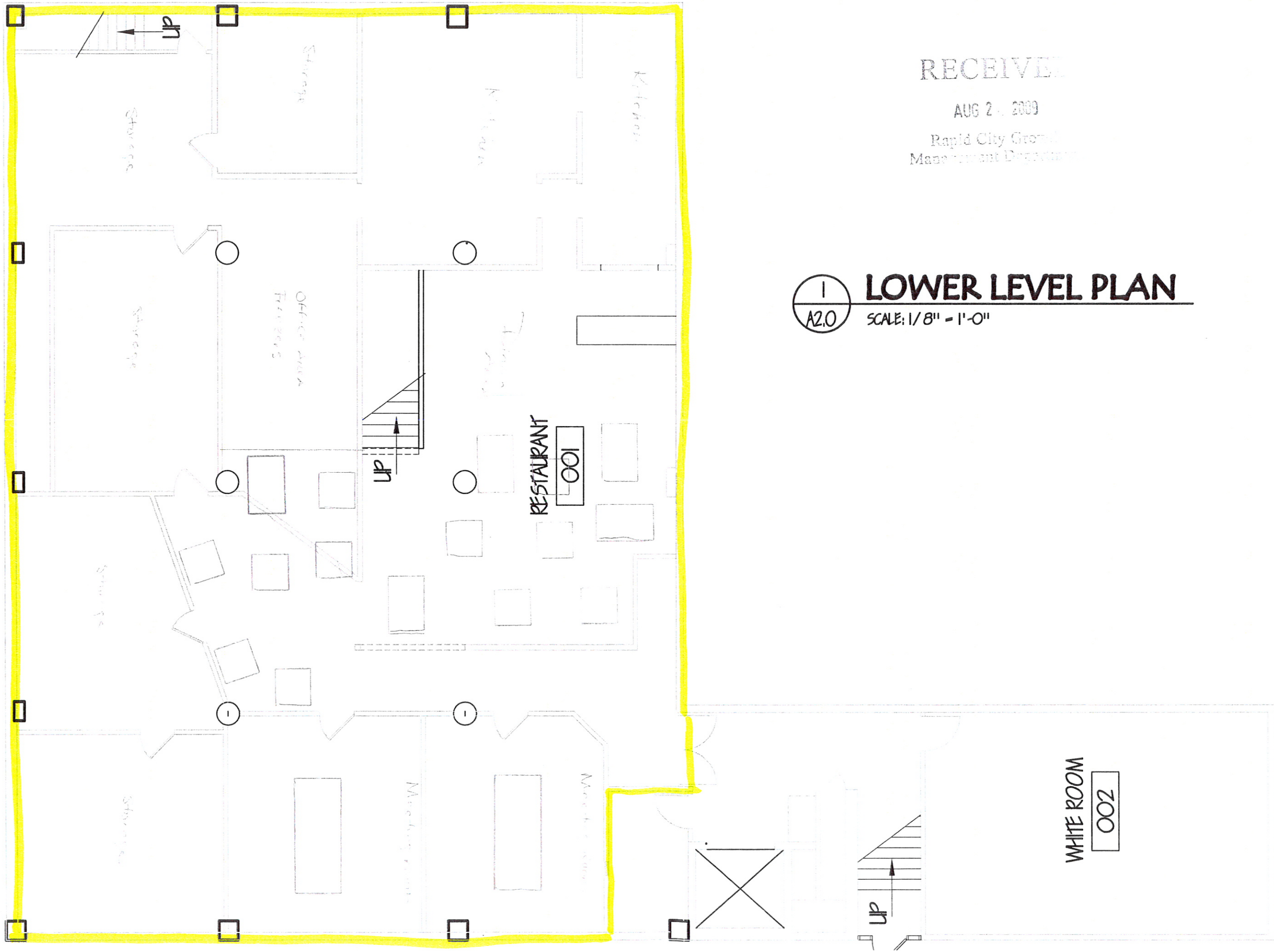

RECEIVED

AUG 24 2009

Rapid City Growth
Management Department

1
A2.0

LOWER LEVEL PLAN

SCALE: 1/8" = 1'-0"

HISTORIC FAIRMONT CREAMERY

RAPID CITY, SD

SHEET TITLE BASEMENT FLOOR PLAN

COMM. NO.	060115		
CADD FILE			
DATE	5-15-09		
DRAWN BY	FNL		
NO.	REVISIONS	DATE	BY

201 MAIN ST. STE. 301
RAPID CITY, SD 57701
(605) 714-0280
FAX 714-0281

201 N 6TH ST
RAPID CITY, SD 57701
(605) 673-6326

Fennell Design, Inc.
Architecture & Project Management

A 2.0