

OWNER: HUMANE SOCIETY OF BLACK HILLS

LEGAL: LOT 1 IN THE SE1/4 SW1/4 AND THE SW1/4 SE1/4 OF SECTION 5, T1N, R8E

NOTE: THE SITE PLAN SHOWS THE FLOOD PLAN (INFORMATION AS DEPICTED ON THE FLOOD INSURANCE RATE MAP (FIRM) PANEL NUMBER 485420 0008 F, MAP REVISED FEBRUARY 16, 1996)

REFERENCE MARK 12 - BRASS CAP LOCATED ON THE NE BRIDGE ABUTMENT, RAPID CREEK AND E. ST. PATRICK STREET, ELEV. 3146.81

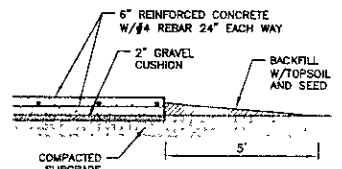
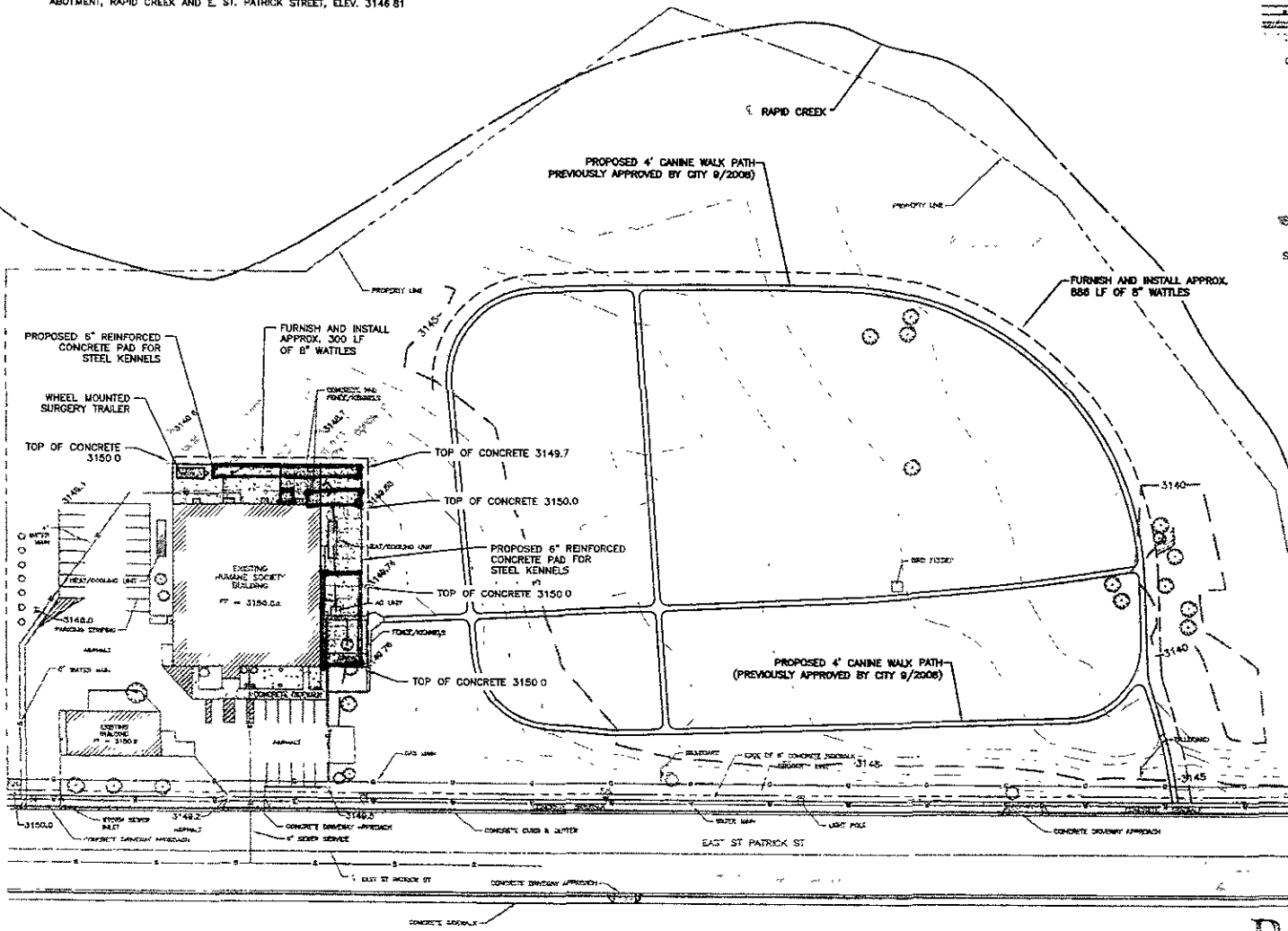

PLAN NOTES:

- 1. STRIP VEGETATION AND TOPSOIL
- 2. REMOVE FROM SITE ALL EXCESS MATERIAL

CONCRETE PAD DETAIL N.T.S.

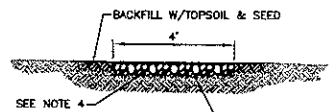

SEE NOTE 4

CANINE WALK PATH SECTION N.T.S.

WALK PATH NOTES

- 1. REMOVE FROM THE SITE ALL EXCESS MATERIAL
- 2. STRIP VEGETATION AND TOPSOIL
- 3. WALK PATH TO MATCH EXISTING GROUND
- 4. INSTALL SOIL STERILANT TO SUBGRADE BENEATH ASPHALT PATH PER MANUFACTURER'S RECOMMENDATIONS

HUMANE SOCIETY OF BLACK HILLS  
 1820 E. ST. PATRICK STREET  
 RAPID CITY, SOUTH DAKOTA  
 JOB NUMBER 081412.001  
 DATE 08/26/09

NO.	REVISIONS

SITE PLAN

SHEET 1

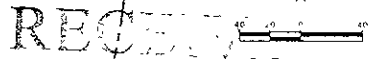

517 7th street rapid city sd 57101  
 ph 605 342 2470 fax 605 342 2377  
 www.hilltop.com

JD-GHEERING  
 361 SURVEYING

Copyright 2009 All rights reserved. No part of this document may be reproduced in any form or by any means without permission from FourFront Design, Inc.