



NORTH  
 1  
 P-4b

# MAIN FLOOR PLAN - REMODEL

SCALE: NTS

FOX RUN REMODEL FOR RCRH

RCRH RAPID CITY, SD

SHEET TITLE: SITE PLAN - PROPOSED

DRAWN BY: JM

DATE: 9-10-09

CADD FILE: SD/8-26-09

COMM. NO.: 06021.3

LUND ASSOCIATES LTD.

P-4b

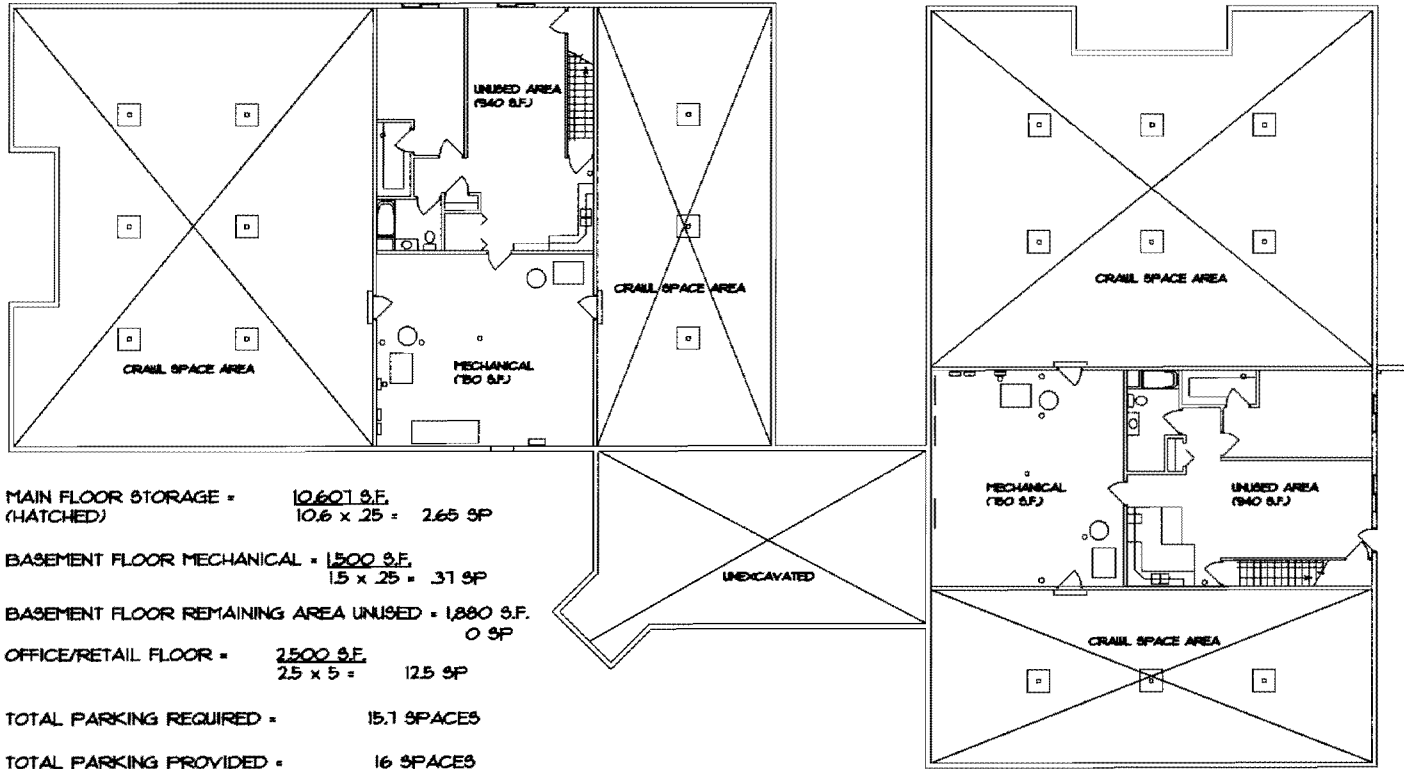

**MAIN FLOOR STORAGE = 10,601 S.F.**  
 (HATCHED) 10.6 x 25 = 2.65 SP  
**BASEMENT FLOOR MECHANICAL = 1,500 S.F.**  
 1.5 x 25 = 31 SP  
**BASEMENT FLOOR REMAINING AREA UNUSED = 1,880 S.F.**  
 0 SP  
**OFFICE/RETAIL FLOOR = 2,500 S.F.**  
 2.5 x 5 = 12.5 SP  
**TOTAL PARKING REQUIRED = 15.1 SPACES**  
**TOTAL PARKING PROVIDED = 16 SPACES**



NORTH

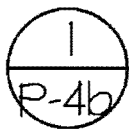

# BASEMENT FLOOR PLAN

SCALE: NTS



COMM. NO.: 06021.3  
 CADD FILE: SD/8-26-09

DATE: 9-10-09

DRAWN BY: JM

SHEET TITLE:

SITE PLAN - PROPOSED

**FOX RUN REMODEL FOR RCRH**  
 RCRH RAPID CITY, SD

