

PRELIMINARY FOR REVIEW ONLY

CITY OF RAPID CITY
 GROWTH MANAGEMENT DEPT
 DEVELOPMENT SERVICES

Plans are reviewed for general conformance with applicable governmental regulations, stipulations, design criteria and engineering standards. The City of Rapid City does not certify the suitability, adequacy or completeness of the plans or design, which are the responsibility of the engineer of record. All necessary permits shall be obtained prior to construction of the proposed public improvements.

Engineering Reviewer: _____ Date: _____
 COMMENTS: _____

Internal Job No	Designed By	Drawn By
09-0650	TC	MLS
Surveyed By	Survey Date	
RENNER & ASSOCIATES	07/2009	

NOTE
 DIMENSIONS ARE TO TOP BACK OF CURB UNLESS OTHERWISE NOTED.

ALL CURB AND GUTTER LOCATED WITHIN THE ROW SHALL BE RAPID CITY STANDARD 32" SEE DETAIL SHEET

ELEVATIONS ARE BASED ON CITY OF RAPID CITY BENCH MARK #2048, WITH PUBLISHED ELEVATION OF (NGVD 29) 3196.66'

PARKING INFORMATION
 REQUIRED 51 STALLS
 4550 SQ FT @ 11/1,000 SQ FT
 PROPOSED 71 STALLS TOTAL
 3 ADA ACCESSIBLE
 7 STACKING FOR DRIVE THRU

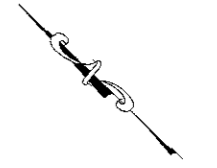
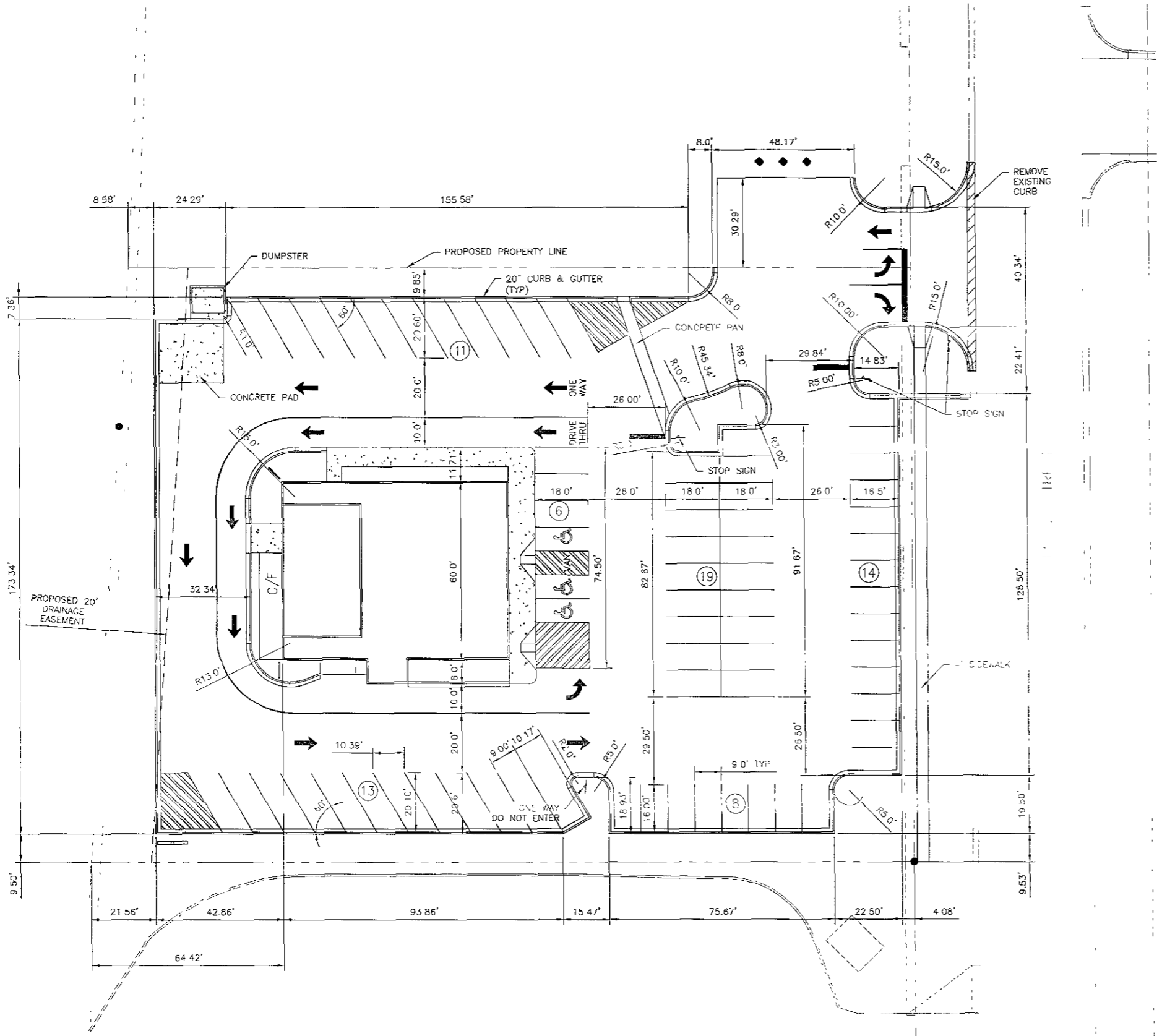

20' 10' 0' 20'
 SCALE 1" = 20'

Revised: _____
 Project Name
 Sheet Name
PIZZA RANCH
 SITE PLAN
 Sheet Number
3 of 15