

IRRIGATION LEGEND

- ☒ P.O.C. POINT OF CONNECTION
- ◀ BACKFLOW PREVENTER, METER, AND PRESSURE REDUCING VALVE (IF NEEDED)
- Ⓢ IRRIGATION CONTROLLER, SEE NOTES FOR BRAND, TYPE AND SPECIFICATIONS.
- ⊕ ELECTRIC CONTROL VALVE - RAINBIRD SERIES  
 MASTER VALVE 200-PGA  
 SPRAY AND ROTOR ZONES PGA-PRS-D, SIZED PER LINE  
 XERIGATION/LANDSCAPE DRIP XCZ-075-PRF-BF
- ⊙ POP-UP SPRAY HEAD- RAINBIRD 1804 SERIES WITH MATCHED PRECIPITATION RATE NOZZLES  
 IN TURF AREAS, SPRAY HEADS MUST BE FIELD ADJUSTED TO MINIMIZE OVERSPRAY AND TO ENSURE HEAD TO HEAD COVERAGE
- ◆ QUICK COUPLER - RAINBIRD 44LRC
- ✂ ISOLATION VALVE, LINE SIZED - SEE IRRIGATION SPECIFICATIONS FOR TYPE, TYP
- ⊗ AIR RELIEF VALVE KIT W/ VALVE BOX, MODEL. AR VALVE KIT

PIPE SCHEDULE

- 2" MAINLINE, CLASS 200 IPS PLASTIC PIPE
- 1" LATERAL LINE - CLASS 200 IPS PLASTIC PIPE
- ~ DRIP DISTRIBUTION PIPE: RAINBIRD XT-700
- - - LANDSCAPE DRIPLINE RAINBIRD XFD-09-18, LENGTH AS NEEDED

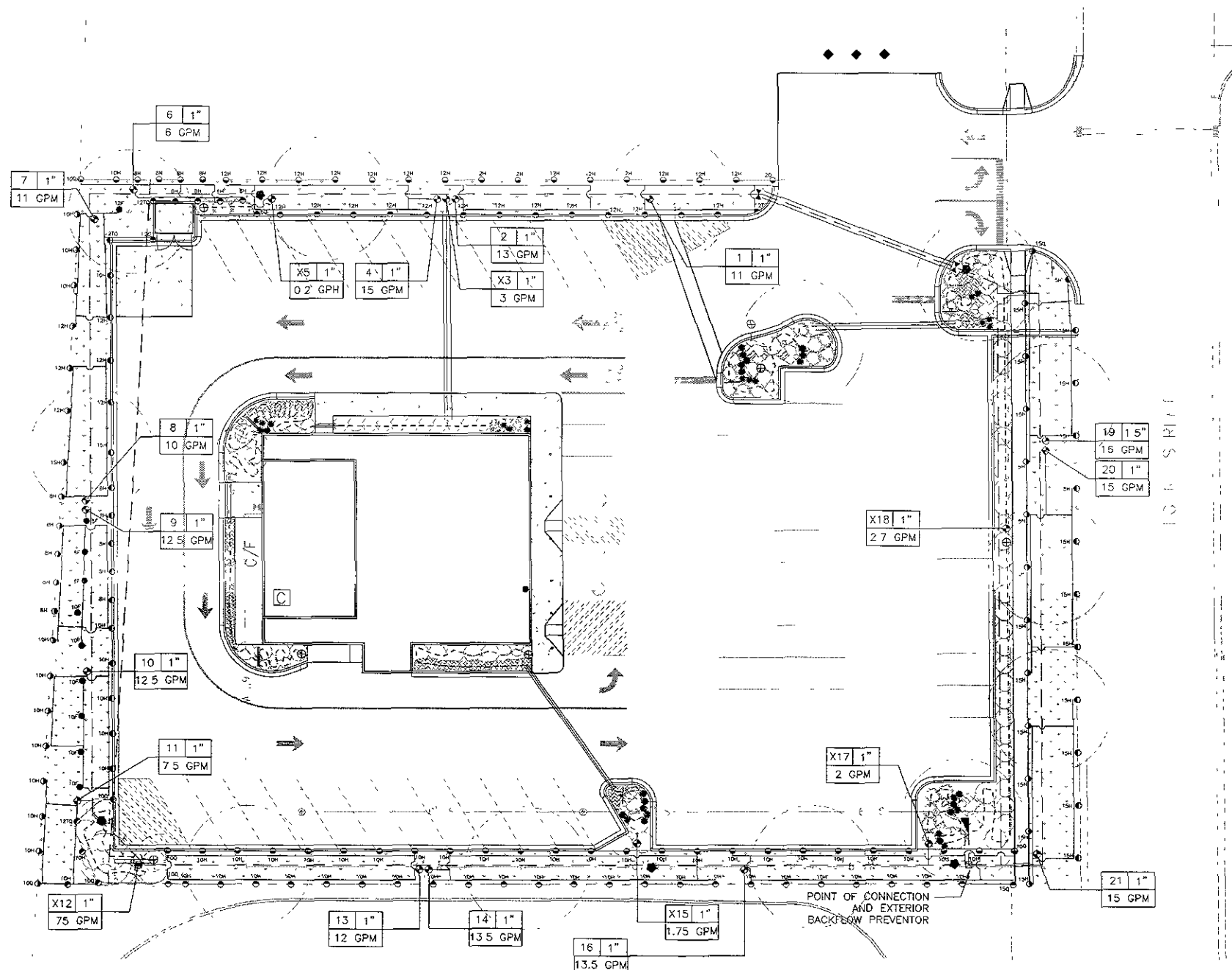

IRRIGATION NOTES

1. THIS SYSTEM IS DESIGNED TO OPERATE WITH A STATIC WATER PRESSURE OF 55 PSI AT THE POINT OF CONNECTION. THE CONTRACTOR SHALL VERIFY THE STATIC WATER PRESSURE PRIOR TO COMMENCING WORK. IF THE PRESSURE IS LESS THAN 50 PSI, THE CONTRACTOR SHALL NOTIFY THE PROJECT ENGINEER OR LANDSCAPE ARCHITECT IMMEDIATELY TO VERIFY THE SYSTEM WILL OPERATE AS DESIGNED.
2. THE CONTRACTOR SHALL REPAIR DAMAGE DONE TO THE SITE ELEMENTS, DUE TO CONTRACTOR WORK, AT NO ADDITIONAL EXPENSE TO THE OWNER. THE CONTRACTOR SHALL THOROUGHLY DOCUMENT EXISTING CONDITION OF THE SITE PRIOR TO COMMENCING WORK AND SUBMIT TO THE OWNER COPIES OF DOCUMENTATION
3. LOCATE HEADS 4" FROM ADJACENT CURB AND PAVED SURFACES AND 12" FROM ADJACENT BUILDINGS AND STRUCTURES.
4. THE CONTRACTOR SHALL USE FIELD LOCATOR SERVICE TO VERIFY THE LOCATION OF ALL UNDERGROUND UTILITIES. THE CONTRACTOR SHALL HAND TRENCH AROUND ALL UNDERGROUND UTILITIES AS REQUIRED BY LOCAL AUTHORITIES
5. THE VALVE LOCATIONS ARE DIAGRAMMATIC, THE CONTRACTOR SHALL LOCATE BOXES IN PLANTING BEDS WHERE POSSIBLE. ALL REMOTE VALVE BOXES SHALL BE SET FLUSH WITH FINISHED GRADE AND CONTAIN ONE CUBIC FOOT OF CLEAN GRAVEL BENEATH THE VALVE. LABEL REMOTE BOXES WITH ONE-INCH ALPHA NUMERIC NOTATION CORRESPONDING TO THE APPLICABLE ALPHA CONTROLLER AND NUMERIC STATION
6. MAINLINE AND LATERAL LINE LOCATIONS ARE DIAGRAMMATIC. THE CONTRACTOR SHALL KEEP LINES OUT OF PAVED AREAS AS MUCH AS POSSIBLE
7. IRRIGATION LINES UNDER ALL PAVEMENT SHALL BE IN A SCH 80 PVC SLEEVE SIZED 2X'S THE IRRIGATION LINE.
8. THE MINIMUM WIRE SIZE SHALL BE #18 GAUGE WIRE FOR ALL RUNS. ALL CONNECTIONS BELOW GRADE SHALL BE WATERPROOFED. THE IRRIGATION CABLE MAY BE DIRECT BURIAL, WITH EXCEPTION OF PAVED SURFACES
9. THE CONTRACTOR SHALL PROVIDE 1 (ONE) SEASONAL WINTERIZATION AND 1 (ONE) SPRING STARTUP.
10. THE CONTRACTOR SHALL PROVIDE A 1 (ONE) YEAR WARRANTY ON ALL ASPECTS OF THE IRRIGATION SYSTEM
11. EXTERIOR BACKFLOW PREVENTOR. THE CONTRACTOR SHALL COORDINATE THE INSTALLATION OF THE BACKFLOW PREVENTOR WITH THE OWNER'S CIVIL ENGINEERING CONSULTANT AND THE OWNER'S ON SITE REPRESENTATIVE. THE BACKFLOW PREVENTOR SHALL BE A 2" WATTS SERIES 007 DOUBLE CHECK VALVE ASSEMBLY. INSTALLATION SHALL BE AS PER MANUFACTURER'S INSTALLATION INSTRUCTION. BACKFLOW PREVENTOR LOCATION SHALL BE STACKED BY CONTRACTOR AND APPROVED BY OWNER'S ON SITE REPRESENTATIVE PRIOR TO INSTALLATION
- 11.1 ENCLOSURE BACKFLOW PREVENTOR ENCLOSURE SHALL BE A NON-INSULATED, 2 PIECE LOCKABLE FIBERGLASS ENCLOSURE BY HOT BOX, INC, MODEL NO LB2T. COLOR SHALL BE GREEN. ENCLOSURE SHALL BE INSTALLED AS PER MANUFACTURER'S WRITTEN INSTRUCTIONS. ENCLOSURE SHALL NOT CONTAIN HEAT OR INSULATION
12. ALL NOZZLES USED IN THIS SYSTEM SHALL BE MATCHED PRECIPITATION RATE NOZZLES
13. WATER VELOCITIES IN THIS IRRIGATION SYSTEM SHALL NOT EXCEED 5FPS
14. CONTROLLER RAINBIRD 24 STATION CONTROLLER, MODEL ESP-24LX PLUS. CONTRACTOR SHALL COORDINATE INSTALLATION LOCATION WITH ARCHITECT, BUILDING CONTRACTOR, AND MANUFACTURER'S WRITTEN INSTRUCTIONS.
15. RAIN SENSOR RAINBIRD RAIN SENSOR, MODEL NO RSD-BEX. CONTRACTOR SHALL COORDINATE INSTALLATION OF THE RAIN SENSOR WITH BUILDING CONTRACTOR AND MANUFACTURE INSTALLATION INSTRUCTIONS.

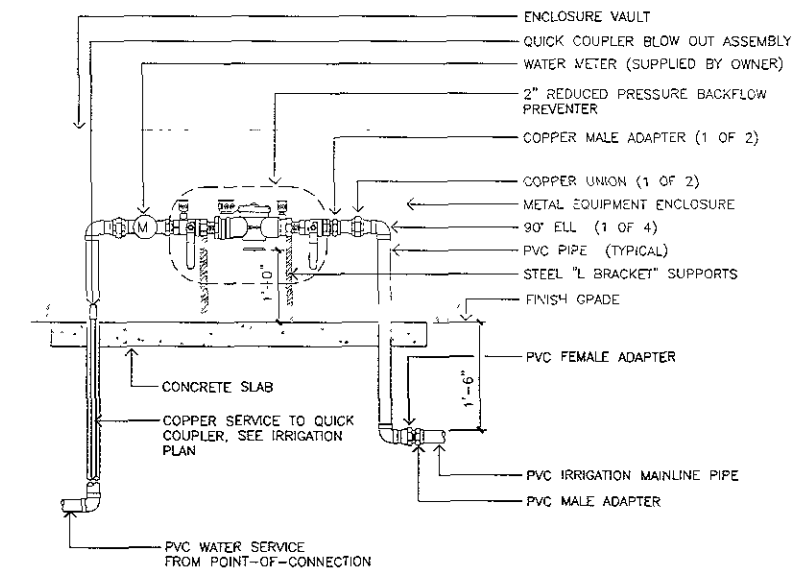

NOTE  
 1. INSTALL BACKFLOW PREVENTER AS REQUIRED BY LOCAL CODES AND HEALTH DEPARTMENT. VERIFY LOCAL REQUIREMENTS PRIOR TO INSTALLATION.

DETAIL: BACKFLOW PREVENTER WITH ENCLOSURE VAULT

NO SCALE

Three working days prior to the start of any excavation on this site the Contractor shall contact 1-800-781-7474 for utility location information

The contractor shall verify and implement all the required Federal Occupational Safety and Health Administration (OSHA) and/or OSHA approved state-plan regulations established for the type of construction required by these plans.



**PRELIMINARY FOR REVIEW ONLY**

CITY OF RAPID CITY  
 GROWTH MANAGEMENT DEPT.  
 DEVELOPMENT SERVICES

Plans are reviewed for general conformance with applicable governmental regulations, stipulations, design criteria and engineering standards. The City of Rapid City does not certify the suitability, adequacy or completeness of the plans or design which are the responsibility of the engineer of record. All necessary permits shall be obtained prior to construction of the proposed public improvements.

Engineering Reviewer	Date	
COMMENTS		
Internal Job No	Designed By	Drawn By
09-0550	MSS	MSS
Surveyed By	Survey Date	
RFKNER & ASSOCIATES	07/2009	
Submittals		

Revisions

PIZZA RANCH

Project Name

Sheet Name

IRRIGATION PLAN