

GRASS
GRASS
SECTION 2 OF 15
SECTION 1

HOUSE
727 FAIRVIEW STREET

REMOVE EXISTING
CHAIN LINK FENCE
FROM HERE,
SOUTH TO ALLEY.

EXTEND EXISTING
C-WALL SOUTH TO
EXISTING CONCRETE CURB

FURNISH AND INSTALL
PARKING CURB STOP (TYP.)

*Remove chain link fencing
replace with 6' wood fence.
Date 08/25/09*

ASPHALT SECTION
(NO TRUCK TRAFFIC)
PLACE 3" CL. G, TYPE 1
ASPHALT ON 4" AGGREGATE
BASE COURSE ON 8"
SCARIFIED & RECOMPACTED
SUBGRADE

STORMWATER DETENTION AND
TREATMENT POND.
BOTTOM ELEV. = 3288.34
STORAGE VOLUME = 160 ft³

ALL
DRAWING RECORD

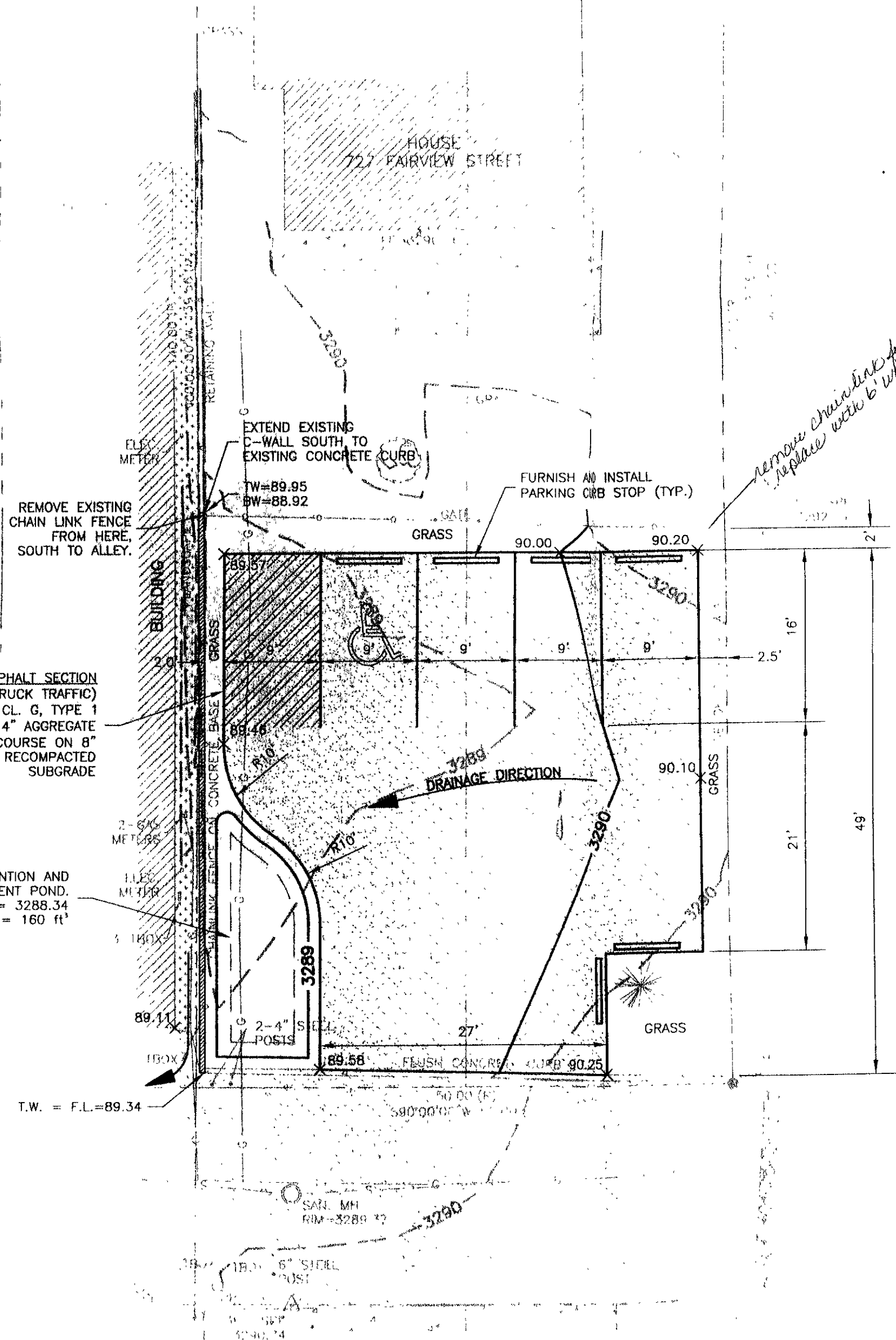

T.W. = F.L. = 89.34

SAN. MH
RIM = 3289.77

180' 6" STEEL
POST