

JUL 30 2009

Rapid City Growth Management Department

FAIRVIEW STREET  
90' WIDE ROW OF RECORD  
37x22' PARKING AREA  
(FOUR SPOTS)

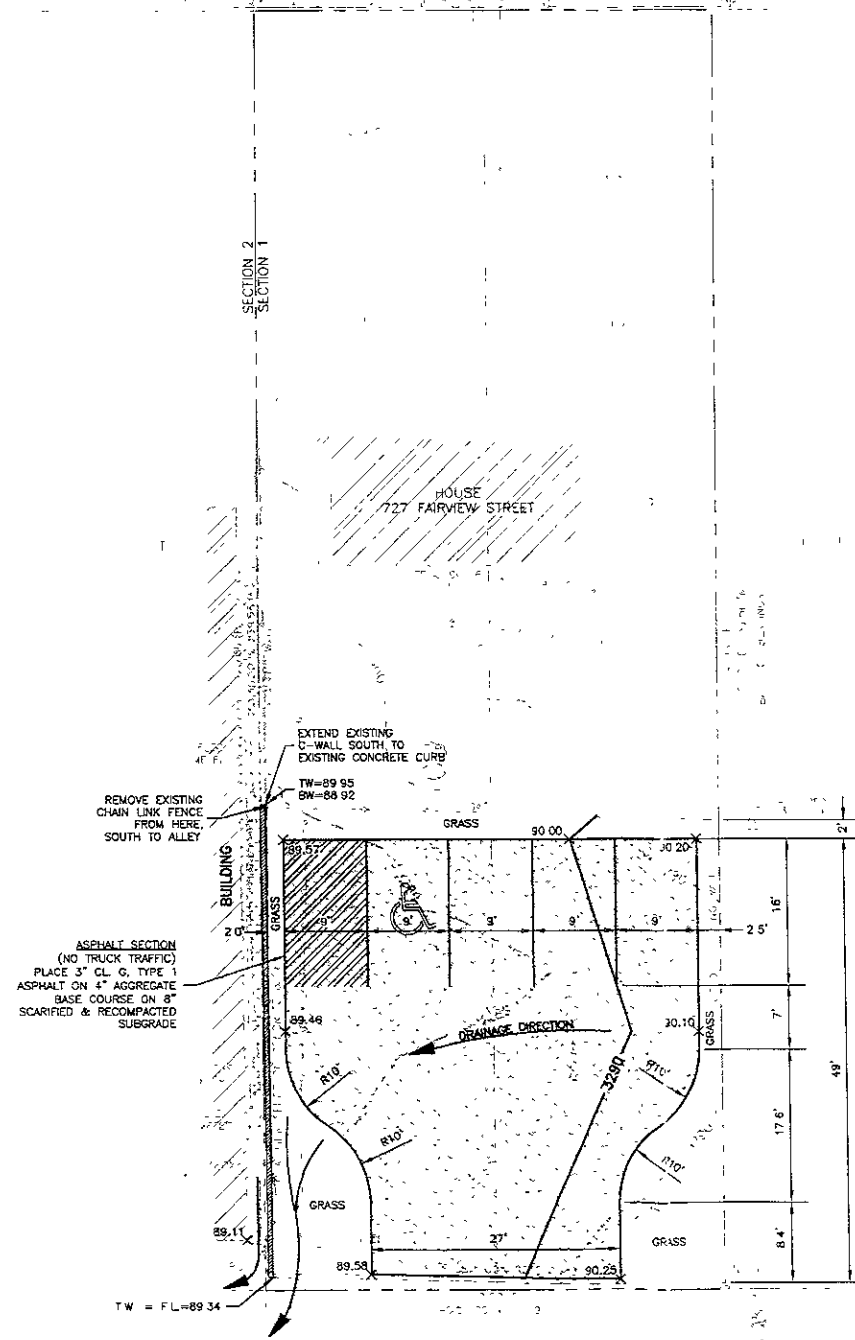

ALLEY  
20' WIDE ROW OF RECORD

TOTAL DISTURBED AREA = 2500 SF = 0.057 ACRES  
TOTAL IMPERVIOUS ADDED = 1854 SF = 0.042 ACRES

**STORMWATER QUALITY: (C O R C, SQM)**  
 1. INFILTRATION - NOT AN OPTION BUILDING FOOTINGS & SURROUNDING PAVING WOULD BE COMPROMISED  
 2. SAND FILTER BASIN - NOT AN OPTION NO STORM SEWER, NO OUTFALL LOCATION  
 3. GRASS BUFFER - ONLY OPTION  
 $S = 1.25$   
 $L_g = \frac{Q_p}{0.05}$   
 $Q_p = CIA = (0.87)(4.32)(0.047) = 0.18 \text{ CFS}$   
 $L_g = \frac{0.18}{0.05} = 3.6'$   
 $L_g \text{ PROVIDED} = 49'$   
 $W_g = 0.2L_g \text{ or } 10'$   
 $W_g \text{ PROVIDED} = 11'$   
 FLOW IS TRANSVERSE THROUGH THE GRASS SURFACE. BUFFER GEOMETRY APPROXIMATES THE REQUIREMENTS OF SQM 2.3.1

**STORMWATER QUANTITY**  
 $Q_1 = 0.18 \text{ cfs}$   
 $Q_2 = 0.27 \text{ cfs}$   
 $Q_{100} = 0.41 \text{ cfs}$   
 WHERE  $Q = CIA$   
 $C_1 = 0.87$   $I_1 = 4.32 \text{ in/hr}$   
 $C_{10} = 0.90$   $I_{10} = 6.36 \text{ in/hr}$   
 $C_{100} = 0.93$   $I_{100} = 9.48 \text{ in/hr}$   
 $A = 0.047 \text{ Acres}$

**CONSTRUCTION BMP**  
 INSTALL 6" WATTLE @ SOUTH EDGE OF GRASS PLANTING AREA. OR INSTALL SOD IF WATTLES ARE USED, MAINTAIN UNTIL GRASS IS ESTABLISHED

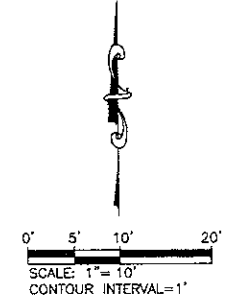

- LEGEND**
- ▲ CONTROL POINT
  - MANHOLE
  - POWER POLE
  - TREE
  - PINE
  - PROPERTY LINE
  - CHAIN LINK FENCE
  - SANITARY SEWER LINE
  - GAS LINE
  - MAJOR CONTOUR (1')
  - ASPHALT SURFACE
  - CONCRETE SURFACE
  - GRAVEL
  - LANDSCAPE
  - DENOTES FOUND SURVEY MONUMENT
  - (M) MEASURED THIS SURVEY
  - (R) RECORDED IN A PREVIOUS PLAT OR DESCRIPTION
  - DRAINAGE DIRECTION

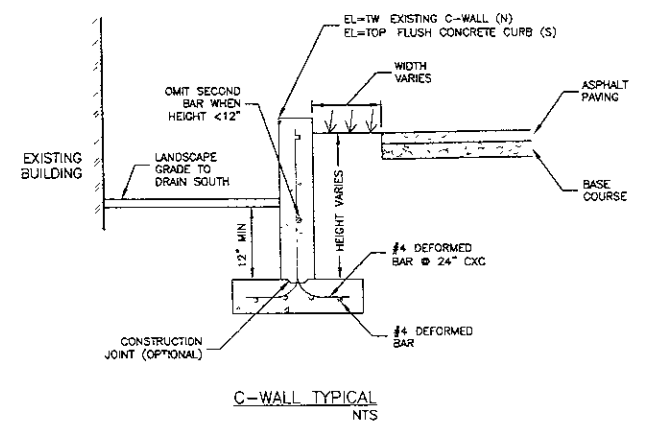
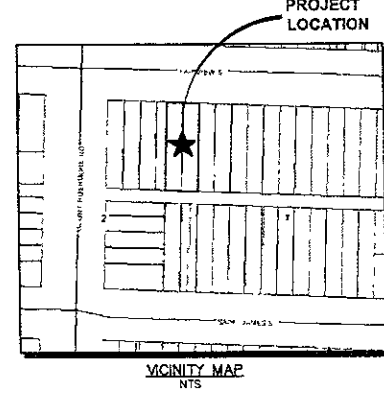

Prepared By  
**RENNER & ASSOCIATES, LLC.**  
 616 8TH ST., RAPID CITY, SD 57701  
 PHONE: 605/721-7310 FAX: 605/721-7313  
 BPEAR/FBI OFFICE: 605/717-0016  
 CITY HALL 1900



Scale: 1"=10'  
 Designed By: MBK  
 Drawn By: ADP  
 Design Date: 7/22/09  
 Print Date: 7/23/09  
 Surveyed By: JD, TJ  
 Survey Date: 7/15/09

Revisions:

**SITE PLAN**  
 727 FAIRVIEW STREET  
 LOTS 15 & 16 OF BLOCK 10, FLORMANN SUBDIVISION  
 LOCATED IN THE NW1/4 OF THE SW1/4,  
 SECTION 1, T1N, R7E, BHM  
 RAPID CITY, PENNINGTON COUNTY, SOUTH DAKOTA

Prepared For  
 RISING PROPERTIES, LLC  
 & THE MEDICINE SHOPPE  
 1304 MT. RUSHMORE ROAD  
 RAPID CITY, SD 57701  
 P-605/348-6305  
 ATTN: CURT & SHIRLEY RISING

Internal Job No:  
**#2439**

Sheet Title  
**SITE PLAN**