

TRACT 5-7 (ALSO IN 1N-7E
SEC 3, 4 & 10)
RAPID CITY GREENWAY TRACT
JACKSON BLVD
CITY OF RAPID CITY

TRACT 8 (ALSO IN 1N-7E
SEC 4 & 10)
RAPID CITY GREENWAY TRACT
2900 JACKSON BLVD
CITY OF RAPID CITY

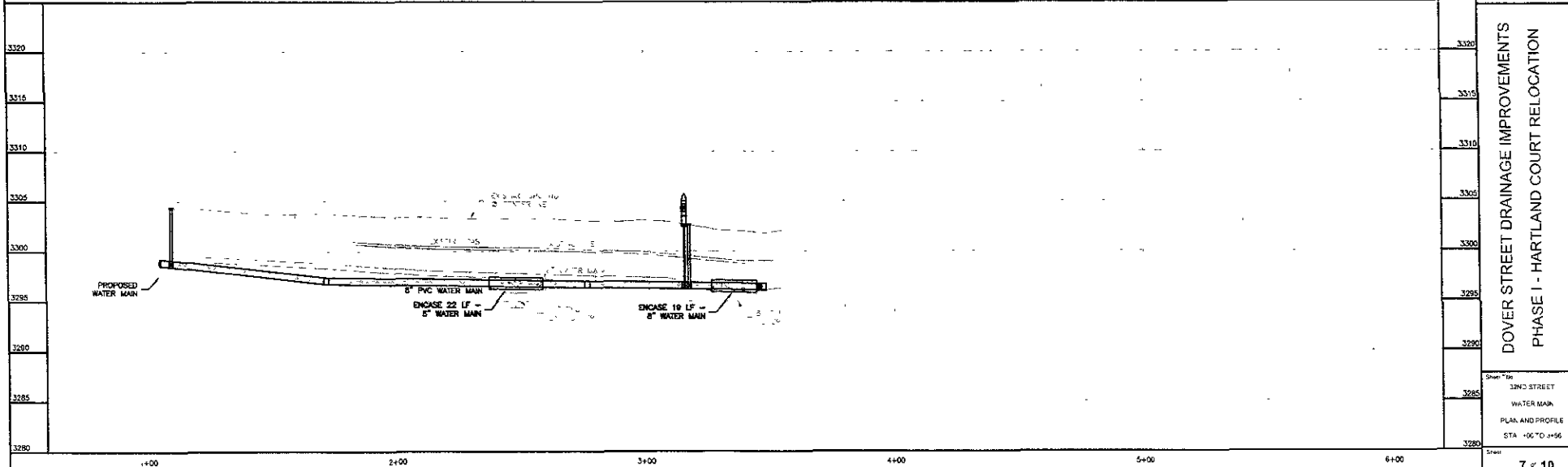
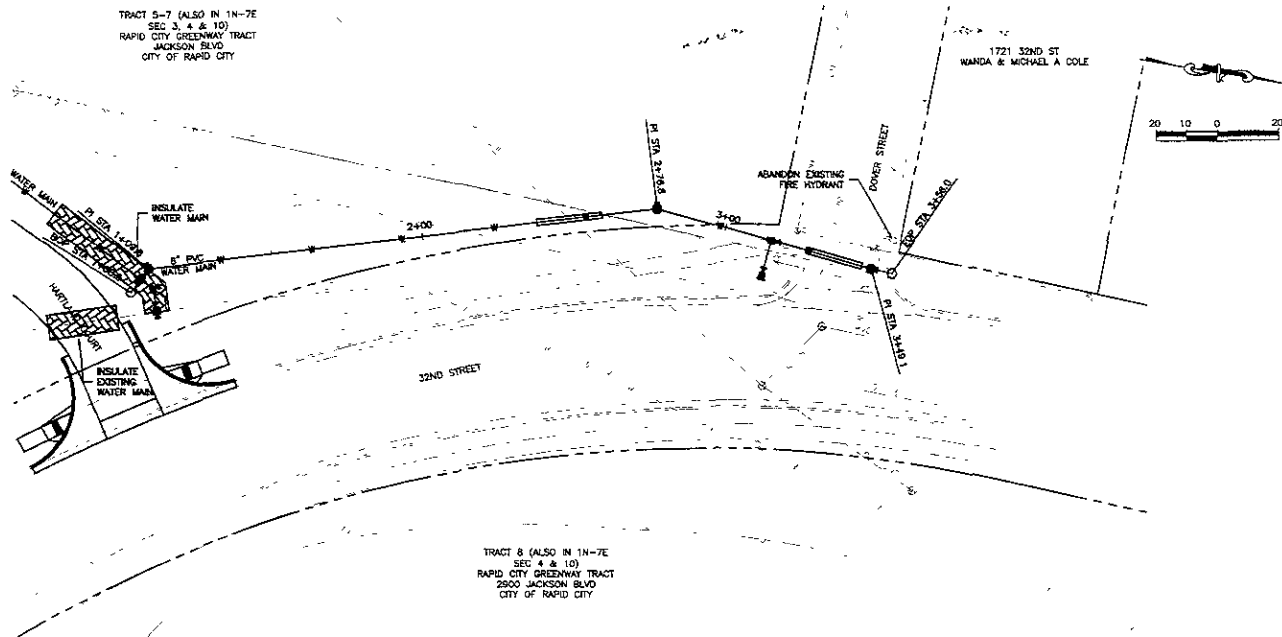

FERBER
Ferber Engineering Company, Inc.
1101 Engineering - White Sulphur Springs, SD 57155
1101 Engineering - Rapid City, SD 57701
1101 Engineering - Pierre, SD 57501

NOT FOR CONSTRUCTION

Scale: AS SHOWN
Designed By: DAL Down By: DRS
Design Date: FEB 2008 Print Date: 4/22/09
Worksheet No: 15.2-101
Reviewed by: SLAJUB Survey Date: FEB 2009
Reviewed by: [Signature]

DOVER STREET DRAINAGE IMPROVEMENTS
PHASE I - HARTLAND COURT RELOCATION
15.2-101

Sheet: 7 of 10
Show Title: 32ND STREET WATER MAIN
PLAN AND PROFILE
STA: +00 TO +56