

**INLET STRUCTURE:**  
STA 3400 MH #3

**APPLY PARKING STRIPS:**  
STA 2495, 6' LT TO STA 2408, 6' RT, 14.0 LF

**ONE 8' CURB WIDTH:**  
STA 2495, 7' LT & RT, 14 LF

**RECONSTRUCT MAINLINE:**  
STA 1498, 11' LT TO STA 1478, 10' RT, 20 SF  
STA 2497, 11' LT TO STA 2474, 10' RT, 110 SF

**TOP & REAR SEWERS:**  
5.5' DIA  
3.0' DIA  
2.0' DIA  
1.5' DIA  
1.0' DIA  
0.5' DIA  
0.25' DIA  
0.15' DIA  
0.10' DIA  
0.075' DIA  
0.05' DIA

**PROPOSED PROPERTY**

QUINCY ST

KANSAS CITY ST

EAST BLVD.

**CONSTRUCT SANITARY SEWER:**  
STA 0+11 (CENT BLVD)  
FM STD 4" MH #1, 1 SA  
STA 0+11 TO STA 1+16 (CENT BLVD)  
FM 3" PVC SANITARY SEWER MAIN, 100 LF  
STA 1+16 (CENT BLVD)  
FM STD 4" MH #2  
STA 1+16 TO STA 3+00 (CENT BLVD)  
FM 3" PVC SANITARY SEWER MAIN, 184 LF  
STA 3+00 (CENT BLVD)  
FM MH #3

**RECONSTRUCT APPLY PARKING STRIPS:**  
STA 0+01, LT (CENT BLVD)  
STA 0+78, LT (CENT BLVD)  
STA 1+71, LT (CENT BLVD)

**RECONSTRUCT APPLY PARKING:**  
STA 2495, 6' LT TO STA 2408, 6' RT, 14.0 LF  
APPROXIMATE SIDE CROWN, 4" THICK, 5.5' TYP  
GRADE 0. TYPE 1 ASPHALT, 3" THICK, 4.5' TYP

**RECONSTRUCT CURB & GUTTER:**  
STA 2495, 7' LT & RT, 14 LF

**RECONSTRUCT SIDEWALK:**  
STA 1498, 11' LT TO STA 1478, 10' RT, 20 SF  
STA 2497, 11' LT TO STA 2474, 10' RT, 110 SF

**RECONSTRUCT SIDE CROWN:**  
APPROXIMATE SIDE CROWN, 4" THICK, 5.5' TYP

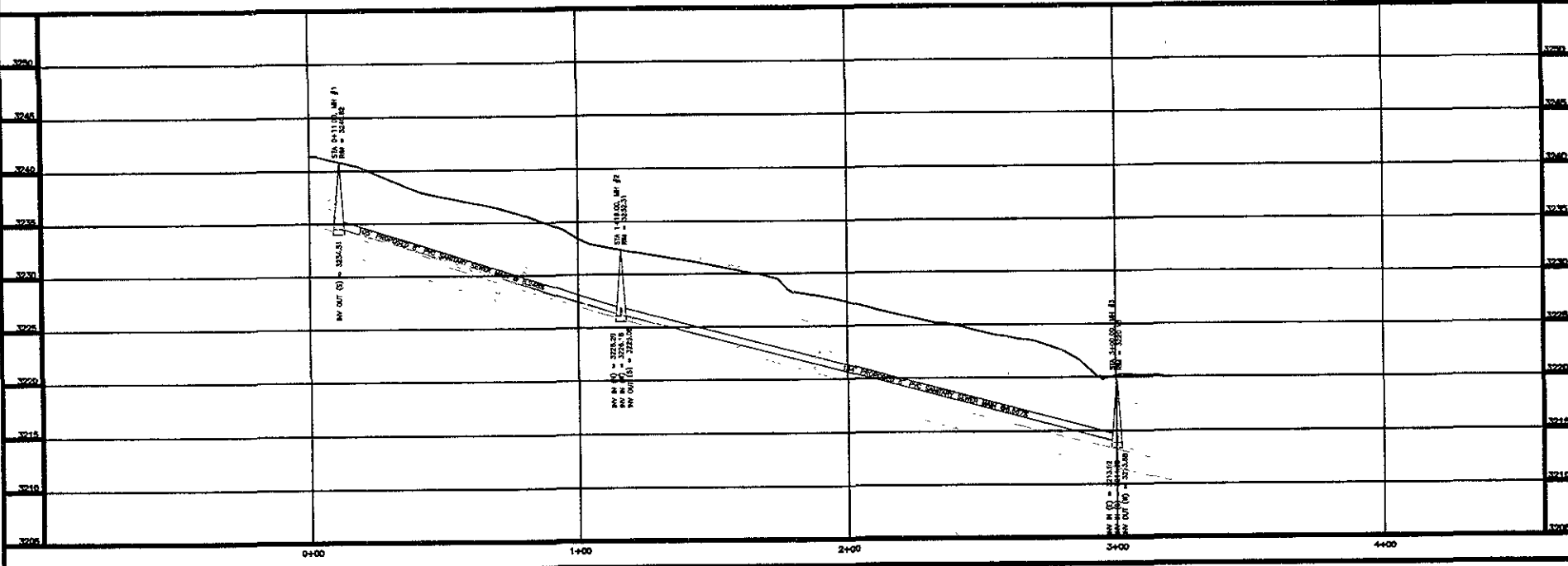
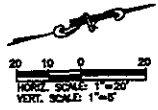

**CITY OF RAPID CITY**  
ENGINEERING SERVICES  
PUBLIC WORKS DEPARTMENT



Scale: 1" = 20'  
Designed By: DJS  
Check Date: \_\_\_\_\_  
Project Date: \_\_\_\_\_  
Reviewed and Approved: \_\_\_\_\_  
Date: \_\_\_\_\_  
Survey Date: \_\_\_\_\_

**SANITARY SEWER EXTENSION  
BLOCK 110 ORIGINAL TOWNSITE  
EAST BLVD FROM KANSAS CITY ST TO QUINCY ST**

Sheet Title:  
**E. BLVD.  
PLAN & PROFILE  
STA 0+00 TO 3+00**  
Sheet:  
**5 of 7**

CITY OF RAPID CITY PROJECT NO. 2509-1752

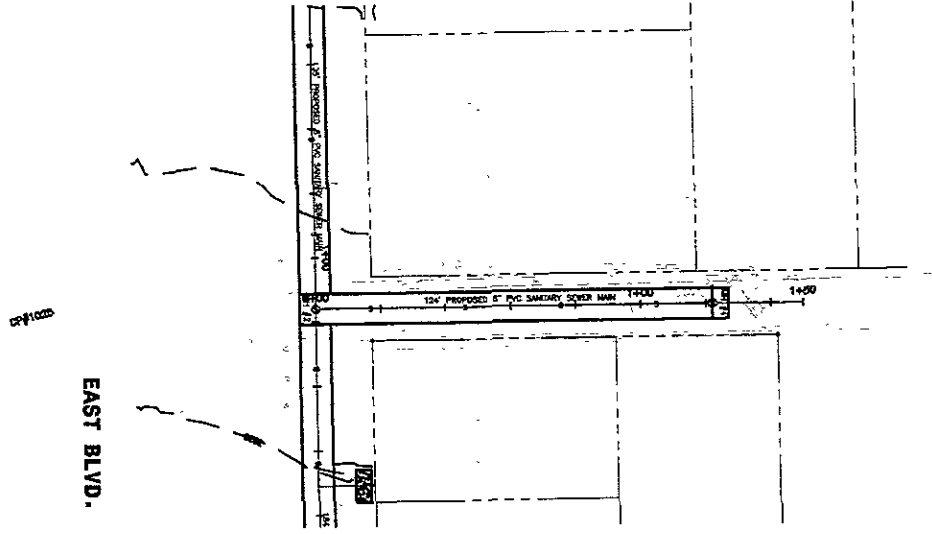

**EXPLANATION**

STA 0+00 (ALLEY) - STA 1+16 (EAST BLVD)	STA 0+00 (ALLEY) TO STA 1+16 (EAST BLVD) CONNECT 6\"/>	STA 0+00 (ALLEY) TO STA 1+22 (ALLEY) FBI 6\"/>	STA 1+22 (ALLEY) FBI MH #4, 1 EA
---	---	---	-------------------------------------

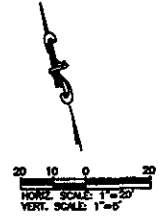

**CITY OF RAPID CITY**  
ENGINEERING SERVICES  
PUBLIC WORKS DEPARTMENT

Scale: 1" = 20'  
Designed by: DLJ  
Checked by: [blank]  
Drawn by: [blank]  
Inventor and Title: SGT/1752  
Reviewed by: [blank]

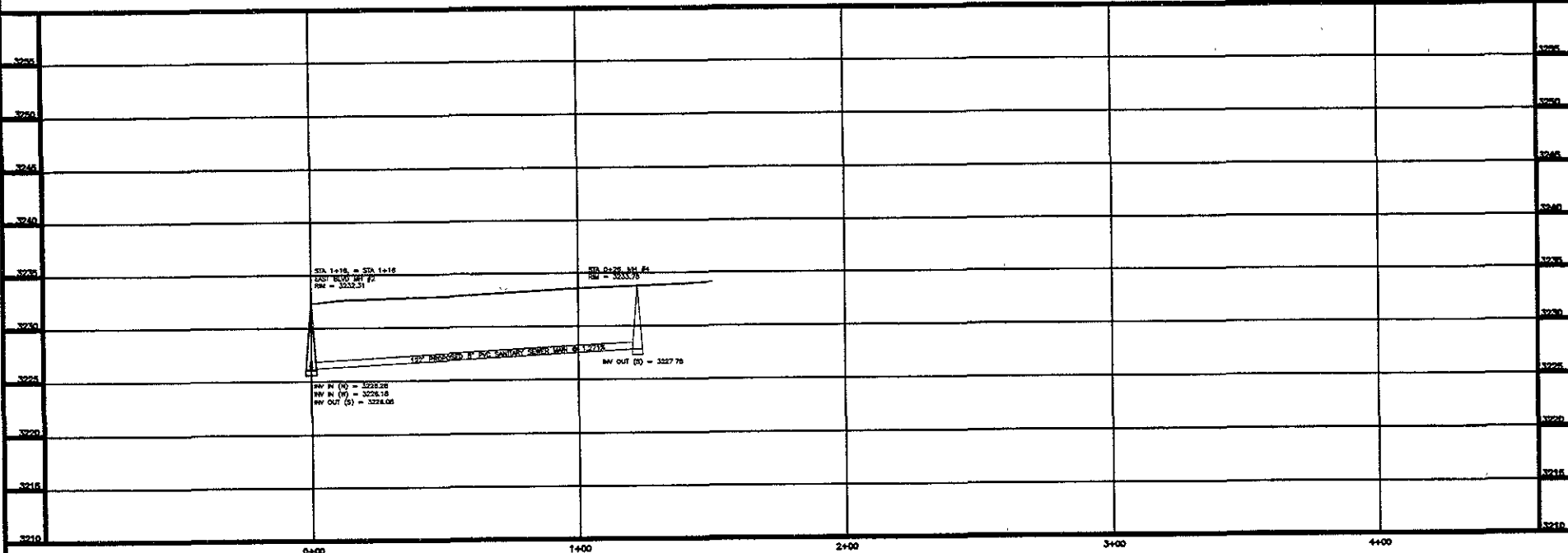

**SANITARY SEWER EXTENSION  
BLOCK 110 ORIGINAL TOWNSITE  
EAST BLVD FROM KANSAS CITY ST TO QUINCY ST**

CITY OF RAPID CITY PROJECT NO. 05561-1732

Sheet Title:  
**E. BLVD.  
PLAN & PROFILE  
STA 0+00 TO 3+20**

Drawn: **6 of 7**