

To Solve. To Excel. Together.

600 Kansas City Street  
Rapid City, SD  
57702

phone (605) 343-6102  
fax (605) 343-7159

www.teamtsp.com

Architecture

Engineering

Construction

April 13, 2009

**Reference: No. – SDCL 11-6-19 Review (April 23, 2009)**

To: Jared Ball, Planner – City of Rapid City

From: Claudia Murphy, Architectural technician

**Construction of 4667.5 S.F. Concrete Pad for Truck Parking:**

- Landscape – No Landscape Plan Required

There will be no landscaping done in this area due to the fact that this concrete pad is adjacent to the existing concrete apron and it is located on the AOA (Airport Operations Area) side of the fence. No landscaping can be done on the airside of the fence at the airport for safety reasons.

It might be that this area inside the AOA fence is exempt from the landscape requirements; therefore, no landscape points may be required. If, however, the City requires us to meet the landscape requirements as if this pad were outside the AOA, the following will apply:

According to the Master Plan Landscape Plan and the landscape plan for the Fire Station, there are 793,542 excess points. We will use 4,668 of these excess points.

Master Plan Area Information:

|                         |           |
|-------------------------|-----------|
| Master Plan Area Points | 3,361,391 |
| Developed Area          | 988,020   |
| Points Required         | 2,373,371 |

Points Earned:

|  |           |
|--|-----------|
| Existing Grass Areas                   | 2,309,003 |
| Landscaping (Existing & Proposed)      | 458,270   |
| Total Fire Station Points (Site 1 & 2) | 99,640    |

---

|              |           |
|--------------|-----------|
| Total Points | 3,166,913 |
|--------------|-----------|

|                              |        |
|------------------------------|--------|
| Concrete Pad Points Required | -4,668 |
|------------------------------|--------|

---

|                      |           |
|----------------------|-----------|
| Total Points Revised | 3,162,245 |
|----------------------|-----------|

**RECEIVED**

APR 16 2009

**Rapid City Growth  
Management Department**

Note: Landscaping at the airport was addressed as a campus within the 11-6-19 SDCL Review Approval process for the 2008 revenue parking lot expansion project and no landscaping will be required with this project.

Marshalltown, IA  
Marshall, MN  
Minneapolis, MN  
Rochester, MN  
Omaha, NE  
Rapid City, SD  
Sioux Falls, SD  
Sheridan, WY

| OVERALL DEVELOPED AREA POINTS TABLE    |           |
|--|-----------|
| TYPE                                   | AREA      |
| DEVELOPED AREA                         | 3,361,391 |
| PAVEMENT/LANDSCAPING IN DEVELOPED AREA | 988,020   |
| TOTAL POINTS REQUIRED                  | 2,373,371 |
| LANDSCAPE POINTS PROVIDED IN PROJECT   |           |
| EXISTING GRASS AREAS                   | 2,809,003 |
| LANDSCAPE (SEE SHEET C4)               | 458,270   |
| TOTAL POINTS PROVIDED                  | 3,067,273 |

SEE C4 FOR OVERALL  
LANDSCAPE PLAN AND  
POINTS TABLE

DEVELOPED AREA

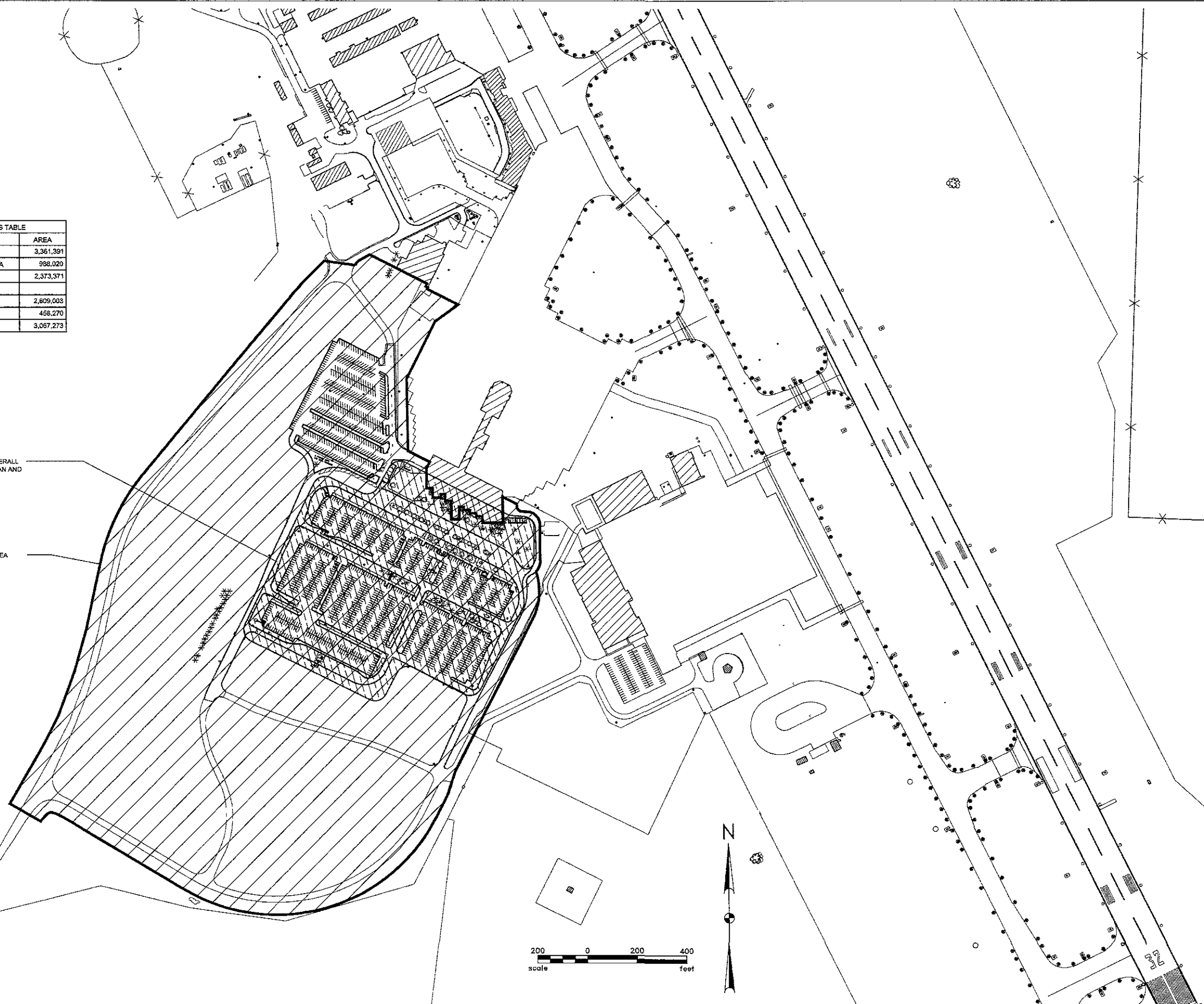

**Kadmas  
Lee &  
Jackson**  
Engineers Surveyors  
Planners

330 KNOLLWOOD DRIVE  
RAPID CITY, SD 57709  
605.721.5553  
WWW.KLJENG.COM

COPYRIGHT © 2008  
KADMAS, LEE & JACKSON, INC.  
ALL RIGHTS RESERVED

**RAPID CITY REGIONAL AIRPORT  
TERMINAL & PARKING LOT LANDSCAPE  
MASTER PLAN**  
RAPID CITY, SOUTH DAKOTA

| NO. | DATE | REVISIONS: |
|-----|------|------------|
| 1   |      |            |
| 2   |      |            |
| 3   |      |            |
| 4   |      |            |

Drawn By: DMM  
Checked By: RS  
Project #: 10508118  
Issued: 3/30/2009

OVERALL DEVELOPED AREA

**PLANTING NOTES:**

1. THESE NOTES ARE FOR GENERAL REFERENCE IN CONJUNCTION WITH, AND AS A SUPPLEMENT TO THE SPECIFICATIONS, DETAILS, ADDENDA AND CHANGE ORDERS ASSOCIATED WITH THE CONTRACT DOCUMENTS.
2. CONTRACTOR SHALL BECOME FAMILIAR WITH THE LOCATION OF ALL EXISTING AND FUTURE UNDERGROUND SERVICES AND IMPROVEMENTS WHICH MAY CONFLICT WITH WORK TO BE DONE.
3. PLANT LOCATIONS ARE DIAGRAMMATIC AND MAY BE ADJUSTED IN THE FIELD AT THE LANDSCAPE ARCHITECT'S REQUEST PRIOR TO INSTALLATION. OBTAIN APPROVAL OF PLANT LAYOUT FROM LANDSCAPE ARCHITECT PRIOR TO PLANTING.
4. CONTRACTOR SHALL LAY OUT PLANT MATERIAL PER PLAN AND FACE TO GIVE BEST APPEARANCE OR RELATION TO ADJACENT PLANTS, STRUCTURES OR VIEWS.
5. PLANT MATERIAL SHALL NOT BE INSTALLED IN AREA WHICH WILL CAUSE HARM TO ADJACENT STRUCTURES. NOTIFY THE LANDSCAPE ARCHITECT SHOULD CONFLICTS ARISE.
6. CONTRACTOR SHALL IMPORT CLEAN TOPSOIL FREE OF WEEDS, RHIZOMES, ROCKS, STICKS, AND OTHER DELETERIOUS MATERIAL. CONTRACTOR SHALL BRING TO FINISH GRADE WITH 6" MIN. OF TOPSOIL IN ALL LAWN AREAS, AND 18" MIN. TOPSOIL IN ALL PLANTING BEDS. FINE GRADING SHALL BE APPROVED BY LANDSCAPE ARCHITECT PRIOR TO PLANTING OPERATIONS.
7. ALL SUBSTITUTIONS OF PLANT MATERIALS SHALL BE SUBMITTED TO LANDSCAPE ARCHITECT IN WRITTEN FORM FOR APPROVAL PRIOR TO INSTALLATION.
8. ALL NEWLY PLANTED MATERIAL SHALL BE THOROUGHLY SOAKED WITH WATER WITHIN 3 HOURS OF PLANTING.
9. THIRTY DAYS AFTER PLANTING, CONTRACTOR SHALL RE-STAKE AND STRAIGHTEN TREES AS REQUIRED.
10. CONTRACTOR SHALL COORDINATE ALL WORK WITH OTHER TRADES PRIOR TO INSTALLATION.
11. CONTRACTOR SHALL LOOSEN COMPACTED SUBSOILS BY TILLING AND IMPORTING NEW TOPSOIL AS REQUIRED TO RESTORE GRADES AND MAINTAIN POSITIVE DRAINAGE AWAY FROM STRUCTURES.

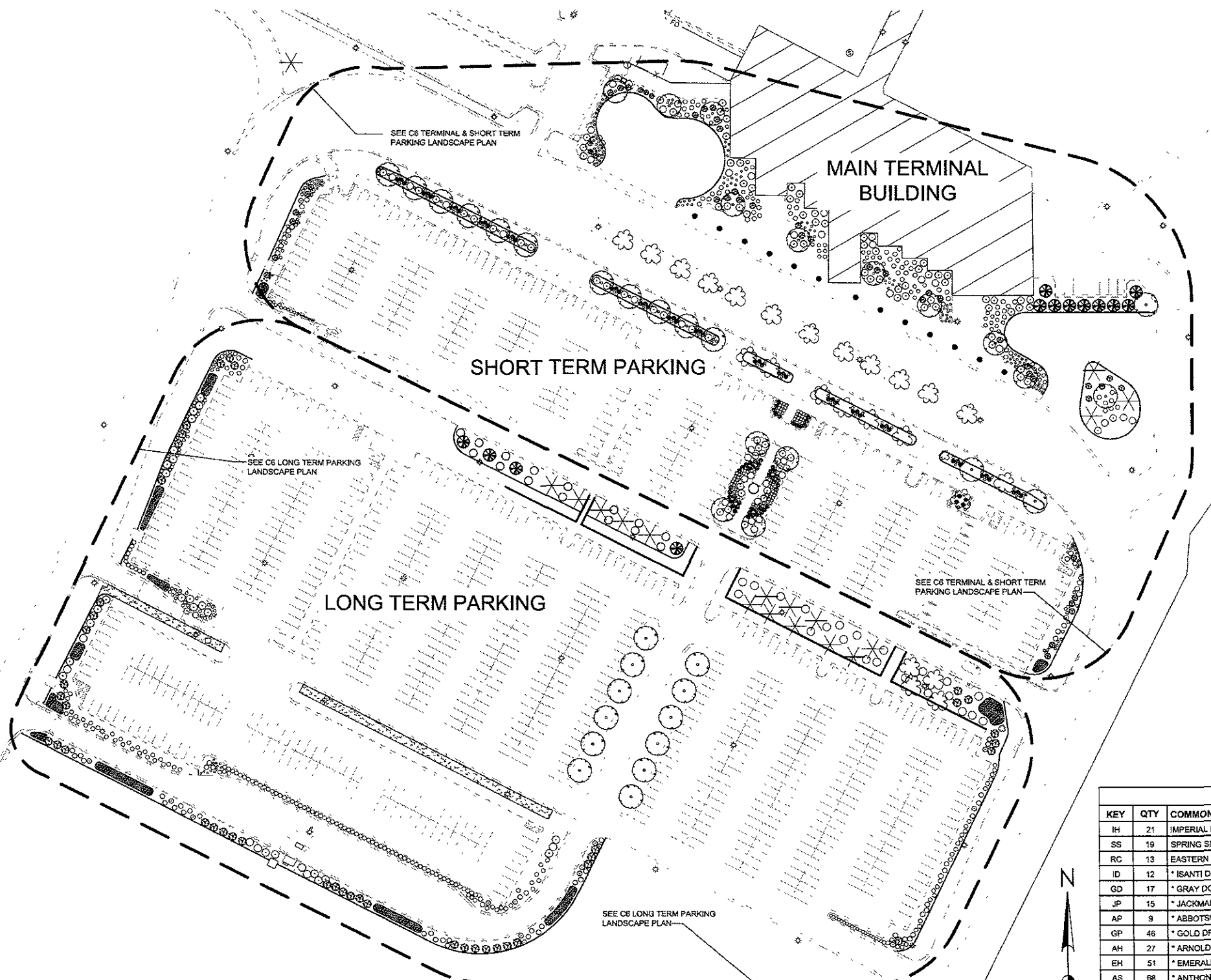

| PROPOSED LANDSCAPE MATERIALS POINTS TABLE   |         |        |               |
|---|---------|--------|---------------|
| TYPE  | QTY     | POINTS | TOTAL         |
| SMALL TREES<br>(19 SPRING SNOW CRAB)  | 19      | 500    | 9500          |
| MEDIUM TREES<br>(22 HONEYLOCUST)  | 21      | 1000   | 21000         |
| LARGE TREES<br>(15 EASTERN REDCEDAR)  | 13      | 2000   | 26000         |
| SHRUBS<br>(SEE PLANT SCHEDULE ITEMS WITH *)   | 855     | 250    | 221250        |
| GROUND COVER<br>(SWITCHGRASS, MAY NIGHT SALVIA, FEATHER REED GRASS, FOUNTAIN GRASS) | 460 SY  | 100    | 46000         |
| GRASS   | 584 SY  | 10     | 5840          |
| <b>TOTAL PROPOSED LANDSCAPE POINTS</b>  |         |        | <b>329590</b> |
| EXISTING LANDSCAPE MATERIALS POINTS TABLE   |         |        |               |
| TYPE  | QTY     | POINTS | TOTAL         |
| MEDIUM TREES<br>(22 HONEYLOCUST)  | 28      | 1000   | 28000         |
| LARGE TREES   | 17      | 2000   | 34000         |
| GRASS   | 6666 SY | 10     | 66660         |
| <b>TOTAL EXISTING LANDSCAPE POINTS</b>  |         |        | <b>128660</b> |
| <b>TOTAL COMBINED POINTS</b>  |         |        | <b>458270</b> |

| PLANT SCHEDULE |     |                                  |   |        |       |         |
|----------------|-----|----------------------------------|---|--------|-------|---------|
| KEY            | QTY | COMMON NAME                      | SCIENTIFIC NAME                               | SIZE   | TYPE  | REMARKS |
| IH             | 21  | IMPERIAL HONEYLOCUST             | GLEDITSIA TRIACANTHOS VAR. INERMIS 'IMPERIAL' | 1 1/2" | B&B   |         |
| SS             | 19  | SPRING SNOW CRAB                 | MALUS 'SPRING SNOW'                           | 1"     | B&B   |         |
| RC             | 13  | EASTERN REDCEDAR                 | JUNIPERUS VIRGINIANA                          | 6"     | B&B   |         |
| ID             | 12  | * ISANTI DOGWOOD                 | CORNUS SERVICEA 'ISANTI'                      | #2     | CONT. |         |
| GD             | 17  | * GRAY DOGWOOD                   | CORNUS RACEMOSA                               | #2     | CONT. |         |
| JP             | 15  | * JACKMANN POTENTILLA            | POTENTILLA FRUTICOSA 'JACKMANNI'              | #2     | CONT. |         |
| AP             | 9   | * ABBOTSWOOD POTENTILLA          | POTENTILLA FRUTICOSA 'ABBOTSWOOD'             | #2     | CONT. |         |
| GP             | 46  | * GOLD DROP POTENTILLA           | POTENTILLA FRUTICOSA 'GOLD DROP'              | #2     | CONT. |         |
| AH             | 27  | * ARNOLD RED HONEYSUCKLE         | LONICERA TATARICA 'ARNOLD RED'                | #2     | CONT. |         |
| EH             | 51  | * EMERALD MOUND HONEYSUCKLE      | LONICERA XYLOSTEUM 'EMERALD MOUND'            | #2     | CONT. |         |
| AS             | 68  | * ANTHONY WATERER SPIREA         | SPIRAEA X BUMALDA 'ANTHONY WATERER'           | #2     | CONT. |         |
| SM             | 75  | * SNOWMOUND SPIREA               | SPIRAEA NIPPONICA 'SNOWMOUND'                 | #2     | CONT. |         |
| ML             | 32  | * MAIDENS BLUSH LILAC            | SYRINGA X HYACINTHIFLORA 'MAIDENS BLUSH'      | #2     | CONT. |         |
| RB             | 70  | * RUBY CAROUSEL BARBERRY         | BERBERIS THUNBERGII 'BAILONE'                 | #2     | CONT. |         |
| DH             | 55  | * DWARF BUSH HONEYSUCKLE         | LONICERA DIERVILLA LONICERA                   | #2     | CONT. |         |
| GS             | 37  | * GRO-LOW FRAGRANT SUMAC         | RHUS AROMATICA 'GRO-LOW'                      | #2     | CONT. |         |
| PR             | 126 | * PURPLE PAVEMENT ROSE           | ROSA 'ROTESMEER'                              | #2     | CONT. |         |
| SJ             | 74  | * SAVIN JUNIPER                  | JUNIPERUS SABINA                              | #2     | CONT. |         |
| GO             | 39  | * GRAY OWL JUNIPER               | JUNIPERUS VIRGINIANA 'GREY OWL'               | #2     | CONT. |         |
| CJ             | 132 | * CREEPING JUNIPER               | JUNIPERUS HORIZONTALS                         | #2     | CONT. |         |
| KF             | 80  | KARL FOERSTER FEATHER REED GRASS | CALAMAGROSTIS ACUTIFLORA 'KARL FOESTER'       | #1     | CONT. |         |
| PG             | 68  | PURPLE FOUNTAIN GRASS            | PENNISETUM RUBRUM                             | #1     | CONT. |         |
| DI             | 113 | DWARF FALSE INDIGO               | AMORPHA NANA                                  | #1     | CONT. |         |
| MS             | 30  | MAY NIGHT SALVIA                 | SALVIA NEMOROSA 'MAINACHT'                    | #1     | CONT. |         |



| NO. | DATE | REVISIONS |
|-----|------|-----------|
| 1   |      |           |
| 2   |      |           |
| 3   |      |           |
| 4   |      |           |

Drawn By: DMM  
Checked By: RS  
Project #: 10508118  
Issued: 3/23/2009

OVERALL LANDSCAPE PLAN

C4



| LEGEND & KEYNOTES |  |
|-------------------|--|
| SYMBOL            | DESCRIPTION  |
|                   | PROPOSED   |
|                   | EXISTING   |
|                   | (12) QUANTITY<br>(C) SPECIES SEE SCHEDULE  |
|                   | 8"x6" P+P CONCRETE LANDSCAPE EDGING, SEE DETAIL  |
|                   | PRECAST CONCRETE BLOCK RETAINING WALL - BID ALT #1   |
|                   | INSTALL LANDSCAPE FABRIC AND PENDELTON BROWN FROM FRONTIER STONE CO. OR AUTUMN FLAME COLOR AS SOLD BY DAKOTA STONE (OR APPROVED EQUAL) 1 1/2" LANDSCAPE ROCK TO A DEPTH OF 2" IN ALL PLANTING BEDS |
|                   | SEED ALL OTHER OPEN AREAS NOT PLANTED WITH LANDSCAPE MATERIALS PER CITY OF RAPID CITY SEEDING SPECIFICATION  |
|                   | SEED AREA WITH SWITCHGRASS (PANICUM VIRGATUM) AT A RATE OF 1LB/1000 SF.  |
|                   | PRECAST CONCRETE PLANTER - WAUSAU TILE CO - TF4115 B3, 48" DIA X 28" PLANTER SAND COLOR WEATHERSTONE FINISH OR APPROVED EQUAL - BID ALTERNATE #2   |

| C5 PLANT LIST |     |                                  |
|---------------|-----|----------------------------------|
| IH            | 21  | IMPERIAL HONEYLOCUST             |
| SS            | 7   | SPRING SNOW CRAB                 |
| RC            | 9   | EASTERN REDCEDAR                 |
| ID            | 12  | ISANTI DOGWOOD                   |
| JP            | 12  | JACKMANN POTENTILLA              |
| AP            | 9   | ABBOTSWOOD POTENTILLA            |
| GP            | 15  | GOLD DROP POTENTILLA             |
| EH            | 51  | EMERALD MOUND HONEYSUCKLE        |
| AS            | 68  | ANTHONY WATERER SPIREA           |
| ML            | 32  | MAIDENS BLUSH LILAC              |
| RB            | 70  | RUBY CAROUSEL BARBERRY           |
| DH            | 55  | DWARF BUSH HONEYSUCKLE           |
| PR            | 27  | PURPLE PAVEMENT ROSE             |
| SJ            | 10  | SAVIN JUNIPER                    |
| GO            | 9   | GRAY OWL JUNIPER                 |
| CJ            | 132 | CREEPING JUNIPER                 |
| KF            | 80  | KARL FOERSTER FEATHER REED GRASS |
| PG            | 68  | PURPLE FOUNTAIN GRASS            |
| DI            | 74  | DWARF FALSE INDIGO               |
| MS            | 30  | MAY NIGHT SALVIA                 |

\* SEE SHEET C4 FOR COMPLETE PLANT SCHEDULE

**Kadmas Lee & Jackson**  
 Engineers Surveyors  
 Planners  
 330 KENDALLWOOD DRIVE  
 RAPID CITY, SD 57709  
 605.721.5553  
 WWW.KLJENR.COM

COPYRIGHT © 2008  
 KADMAS, LEE & JACKSON, INC.  
 ALL RIGHTS RESERVED

**RAPID CITY REGIONAL AIRPORT  
 COMMERCIAL TERMINAL & REVENUES PARKING  
 AREA LANDSCAPE REDEVELOPMENT**  
 RAPID CITY, SOUTH DAKOTA

| NO. | DATE | REVISIONS: |
|-----|------|------------|
| 1   |      |            |
| 2   |      |            |
| 3   |      |            |
| 4   |      |            |

Drawn By: DMM  
 Checked By: RS  
 Project #: 10508118  
 Issued: 3/23/2009

TERMINAL & SHORT TERM  
 PARKING LANDSCAPE PLAN

**C5**

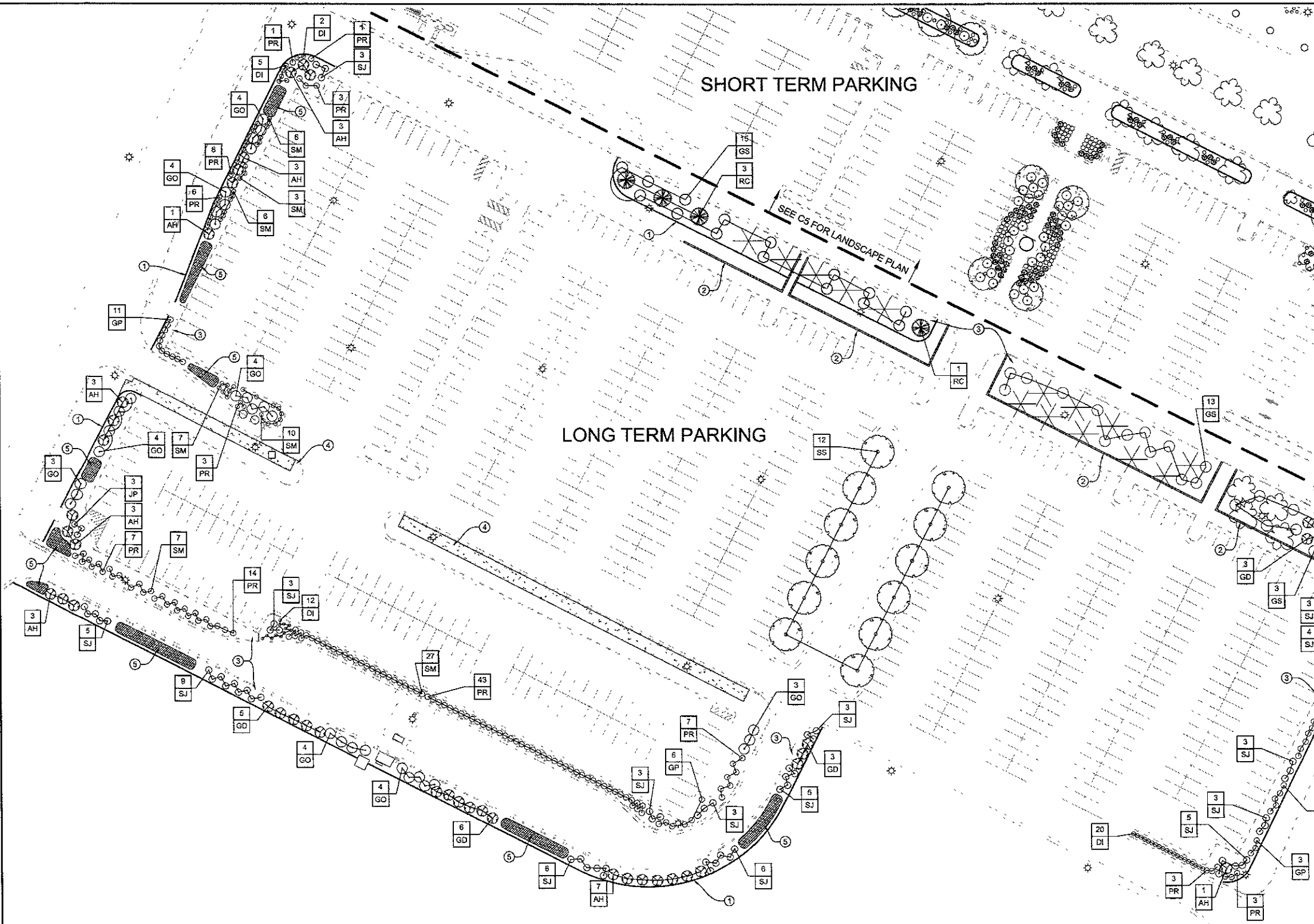

SHORT TERM PARKING

LONG TERM PARKING

SEE C5 FOR LANDSCAPE PLAN

| LEGEND & KEYNOTES |  |
|-------------------|--|
| SYMBOL            | DESCRIPTION  |
|                   | PROPOSED   |
|                   | EXISTING   |
|                   | (12) QUANTITY<br>(C) SPECIES, SEE SCHEDULE   |
|                   | 6"x6" P-I-P CONCRETE LANDSCAPE EDGING, SEE DETAIL  |
|                   | PRECAST CONCRETE BLOCK RETAINING WALL - BID ALT #1   |
|                   | INSTALL LANDSCAPE FABRIC AND PENDELTON BROWN FROM FRONTIER STONE CO. OR AUTUMN FLAME COLOR AS SOLD BY DAKOTA STONE (OR APPROVED EQUAL) 1 1/2" LANDSCAPE ROCK TO A DEPTH OF 2" IN ALL PLANTING BEDS |
|                   | SEED ALL OTHER OPEN AREAS NOT PLANTED WITH LANDSCAPE MATERIALS PER CITY OF RAPID CITY SEEDING SPECIFICATION.   |
|                   | SEED AREA WITH SWITCHGRASS (PANICUM VIRGATUM) AT A RATE OF 1LB./1000 SF  |
|                   | PRECAST CONCRETE PLANTER - WAUSAU TILE CO - TF4115 B3, 48" DIA X 26" PLANTER SAND COLOR WEATHERSTONE FINISH OR APPROVED EQUAL - BID ALTERNATE #2   |

| C6 PLANT LIST |    |                        |
|---------------|----|------------------------|
| SS            | 12 | SPRING SNOW CRAB       |
| RC            | 4  | EASTERN REDCEDAR       |
| GD            | 17 | GRAY DOGWOOD           |
| JP            | 3  | JACKMANN POTENTILLA    |
| GP            | 31 | GOLD DROP POTENTILLA   |
| AH            | 27 | ARNOLD RED HONEYSUCKLE |
| SM            | 75 | SNOWMOUND SPIREA       |
| GS            | 37 | GRO-LOW FRAGRANT SUMAC |
| PR            | 99 | PURPLE PAVEMENT ROSE   |
| SJ            | 64 | SAVIN JUNIPER          |
| GO            | 30 | GRAY OWL JUNIPER       |
| DI            | 39 | DWARF FALSE INDIGO     |

\* SEE SHEET C4 FOR COMPLETE PLANT SCHEDULE.

**Kadrmas Lee & Jackson**  
 Engineers Surveyors Planners  
 330 KNOLLWOOD DRIVE  
 RAPID CITY, SD 57709  
 605 721 5553  
 WWW.KLJENR.COM

COPYRIGHT © 2008  
 KADRMAS, LEE & JACKSON, INC.  
 ALL RIGHTS RESERVED

**RAPID CITY REGIONAL AIRPORT  
 COMMERCIAL TERMINAL & REVENUE PARKING  
 AREA LANDSCAPE REDEVELOPMENT**  
 RAPID CITY, SOUTH DAKOTA

| REV. | DATE | REVISIONS: |
|------|------|------------|
| 1    |      |            |
| 2    |      |            |
| 3    |      |            |
| 4    |      |            |

Drawn By: DMM  
 Checked By: RS  
 Project #: 10508118  
 Issued: 3/23/2009

LONG TERM PARKING  
 LANDSCAPE PLAN