



CITY OF RAPID CITY
ENGINEERING SERVICES
PUBLIC WORKS DEPARTMENT



Scale: 1" = 20'
Designed By: [blank]
Checked By: [blank]
Drawn By: [blank]
Project No.: [blank]
Project Name: [blank]
Date: [blank]

SANITARY SEWER EXTENSION
BLOCK 110 ORIGINAL TOWNSITE
EAST BLVD FROM KANSAS CITY ST TO QUINCY ST

E. BLVD.
PLAN & PROFILE
STA 0+00 TO 3+20

ADJACENT PROPERTY:
STA 3+00 84 FT

ADJACENT PROPERTY:
STA 2+40, 6' LT TO STA 2+08, 6' RT, 14.0 LF

EXIST. CURB RECORD:
STA 2+40, 7' LT & RT, 14 LF

EXIST. RECORD:
STA 1+08, 11' LT TO STA 1+78, 10' RT, 80 SF
STA 2+02, 11' LT TO STA 2+74, 10' RT, 110 SF

EXIST. RECORD:
STA 3+00
STA 3+00
STA 3+00
STA 3+00
STA 3+00
STA 3+00
STA 3+00
STA 3+00
STA 3+00
STA 3+00

ADJACENT PROPERTY

QUINCY ST

KANSAS CITY ST

EAST BLVD.

CONSTRUCT SANITARY SEWER:
STA 0+11 (CENT BLVD)
FM STD 4" 84 FT, 1 SA
STA 0+11 TO STA 1+16 (CENT BLVD)
FM 2" PVC SANITARY SEWER MAIN, 100 LF
STA 1+16 (CENT BLVD)
FM STD 4" 84 FT
STA 1+16 TO STA 3+00 (CENT BLVD)
FM 2" PVC SANITARY SEWER MAIN, 184 LF
STA 3+00 (CENT BLVD)
FM 84 FT

ADJACENT PROPERTY RECORD:
STA 0+42, LT (CENT BLVD)
STA 0+78, LT (CENT BLVD)
STA 1+71, LT (CENT BLVD)

ADJACENT PROPERTY RECORD:
STA 2+40, 6' LT TO STA 2+08, 6' RT, 14.0 LF
ADJACENT SIDE CURB, 4" THICK, 6.6 TON
CLASS 5, TYPE 1 ASPHALT, 3" THICK, 4.3 TON

RECONSTRUCT CURB & GUTTER:
STA 2+40, 7' LT & RT, 14 LF

RECONSTRUCT SIDEWALK:
STA 1+08, 11' LT TO STA 1+78, 10' RT, 80 SF
STA 2+02, 11' LT TO STA 2+74, 10' RT, 110 SF

RECONSTRUCT SIDEWALK RECORD:
ADJACENT SIDE CURB, 4" THICK, 6.6 TON

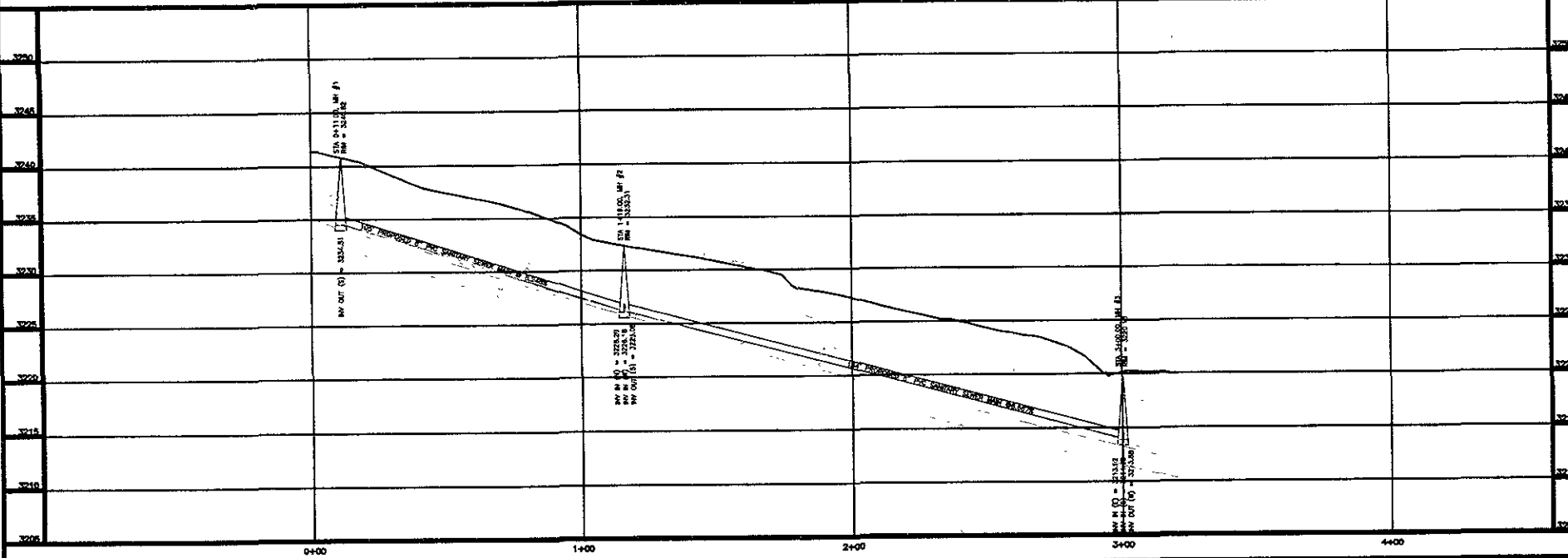
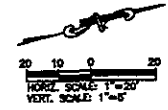



CITY OF RAPID CITY
ENGINEERING SERVICES
PUBLIC WORKS DEPARTMENT



Scale: 1" = 20'
Designed by: DLJ
Drawn by: [blank]
Design Date: [blank]
Print Date: [blank]
Material and Job: S&P 1752
Checked by: [blank]
Reviewed by: [blank]

SANITARY SEWER EXTENSION
BLOCK 110 ORIGINAL TOWNSITE
EAST BLVD FROM KANSAS CITY ST TO QUINCY ST

Sheet Title:
E. BLVD.
PLAN & PROFILE
STA 0+00 TO 3+20

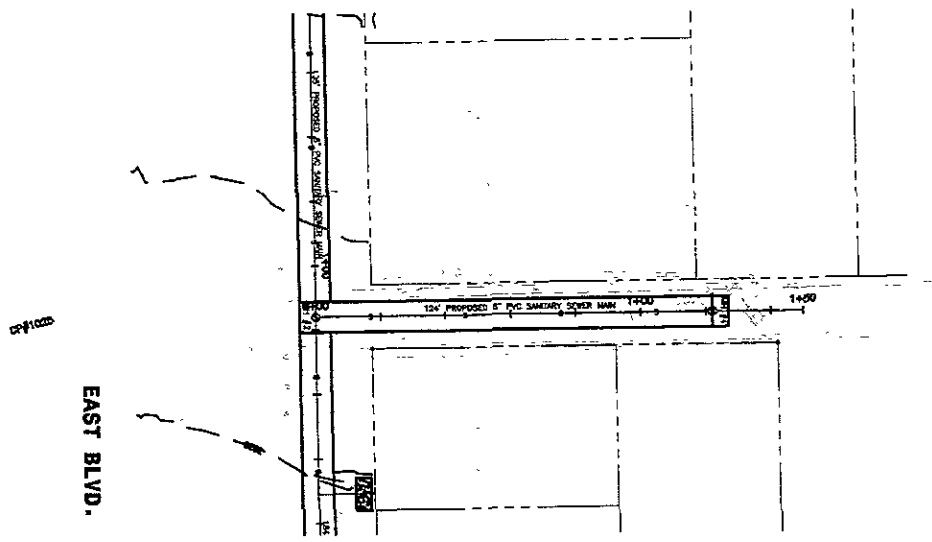

SECTION
STA 0+00 (ALLEY) - STA 1+16 (EAST BLVD) STA 0+00 (ALLEY) TO STA 1+22 (ALLEY) STA 1+22 (ALLEY)
CONNECT 6\"/>

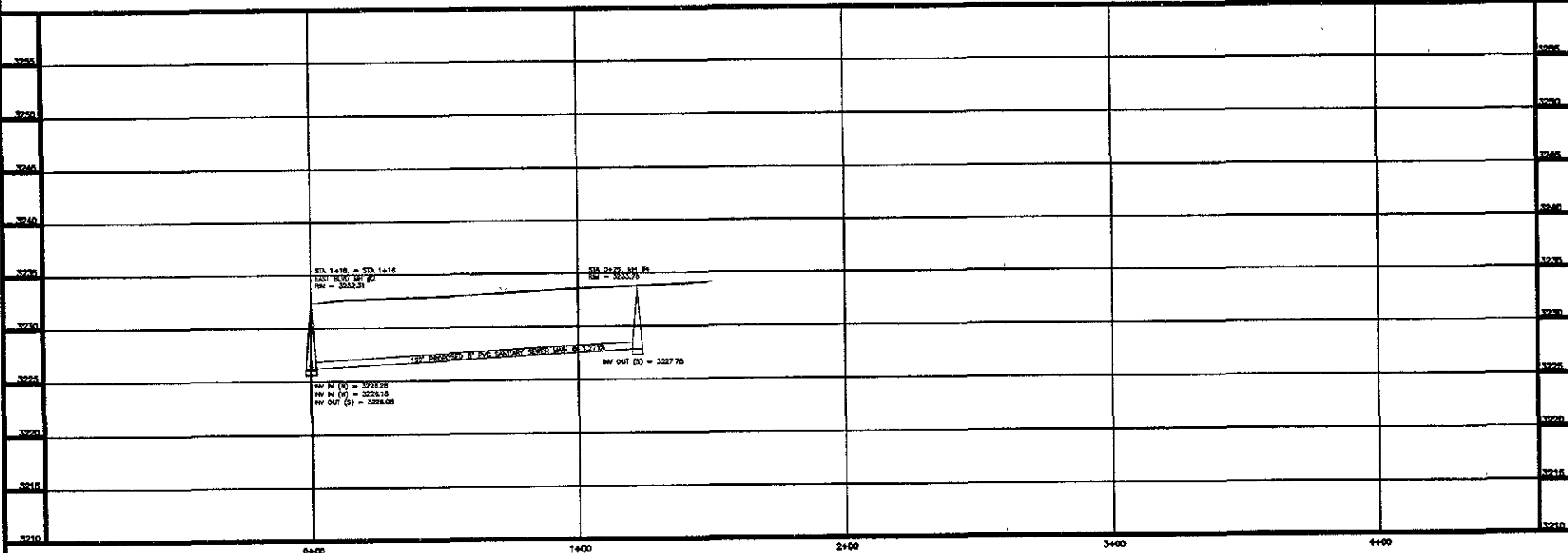
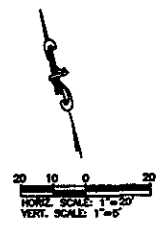

CITY OF RAPID CITY PROJECT NO. 8586 1752