

TRUE NORTH

N

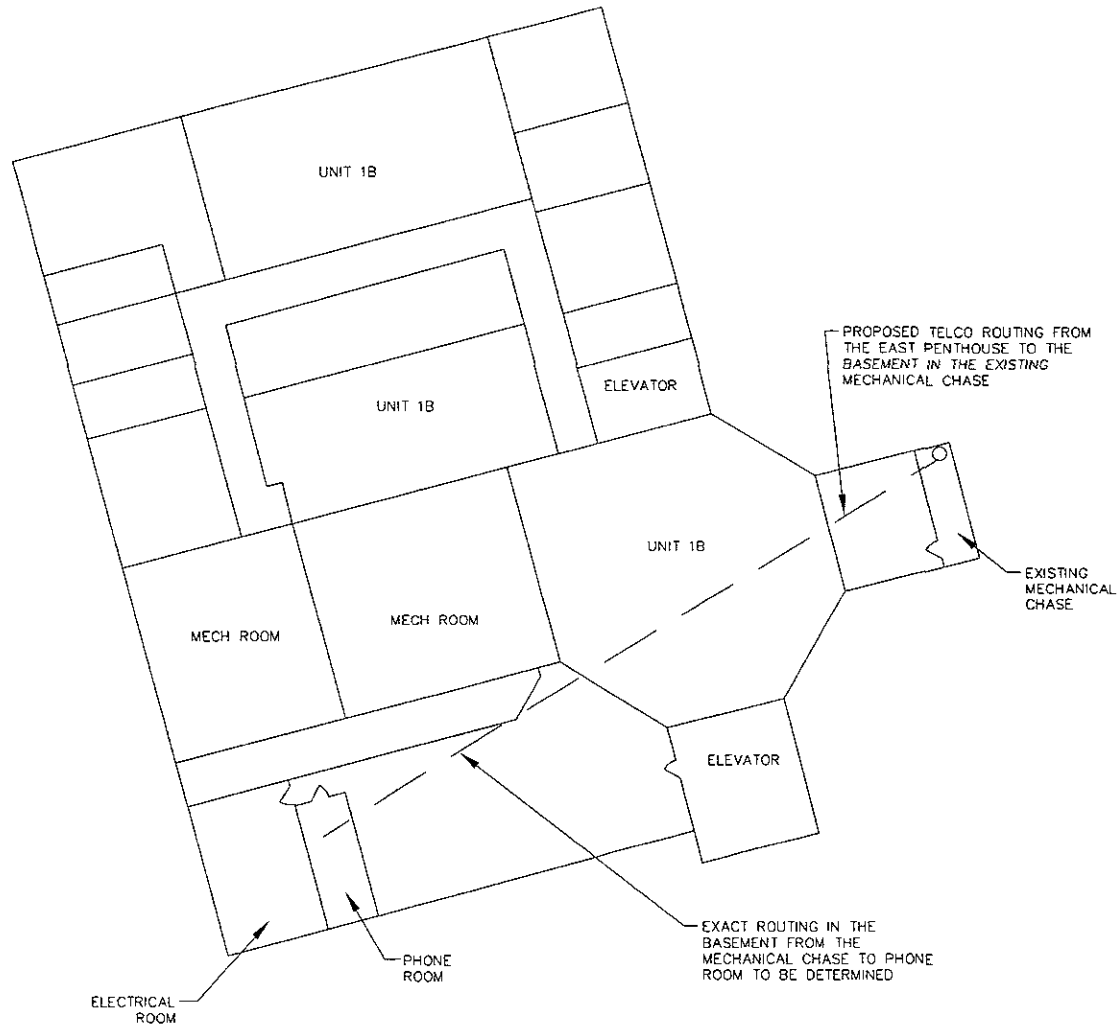

1 TELCO ROUTING BASEMENT FLOOR (INTERIOR)

SCALE: NONE

**Landmark**  
ENGINEERING GROUP  
455 EIGHTH OF THE CITIES EAST WYOMING, WY 82001  
7800 780-5400 FAX 7800 780-5400  
CIVIL ENGINEERING AND LAND SURVEYING  
DESIGN FIRM REGISTRATION NUMBER 164-001811

I HEREBY CERTIFY THAT THIS ENGINEERING DOCUMENT WAS PREPARED BY ME OR UNDER MY DIRECT SUPERVISION AND THAT I AM A FULLY LICENSED PROFESSIONAL ENGINEER UNDER THE LAWS OF THE STATE OF SOUTH DAKOTA.

MICHAEL R. SHAMSE DATE  
MY LICENSE RENEWAL DATE IS MARCH 31 2010

PROJECT MANAGER

**i wireless**  
4125 N. UNIVERSITY DR. S.W.  
MINNEAPOLIS, MN 55412

APPLICANT/OWNER

SWS LLC  
120 EAST 1st STREET  
PO BOX 48  
KIMBALL SD 57355

DRAWN BY: CHK BY: APV BY:

KJM BCH MRS

SITE NAME:

FIRST NATIONAL BANK  
ROOF TOP

IWIRELESS SITE NUMBER

SD0258

SUBMITTALS

REV	DATE	DESCRIPTION

DRAWING TITLE

ELECTRICAL  
DETAILS

DRAWING NUMBER

E-2

JOB NUMBER

01-08-682