

08PL088

NOTES

1. OWNER TO COORDINATE WITH THE CITY OF RAPID CITY ALL FUTURE OPTIONS CONCERNING THE FUTURE GREENWAY TRACT AND DETENTION FACILITY.
2. OWNER TO COORDINATE WITH SDDOT ANY ACCESS FROM HIGHWAY 16 FOR FUTURE ACCESS TO GREENWAY TRACT.
3. CONTOUR ELEVATIONS ARE BASED ON CURRENT GRADING PROJECT AND PREVIOUSLY SURVEYED CONTOURS.
4. UTILITIES SHOWN ALONG TOWER ROAD, US HIGHWAY 16 & SANDSTONE LANE ARE BASED ON THE PROPOSED UTILITIES INCLUDED WITH THIS SET OF PLANS.
5. SITE GRADING FOR THE TOWER ROAD RECONSTRUCTION PROJECT ARE NOT SHOWN ON THIS DRAWING.

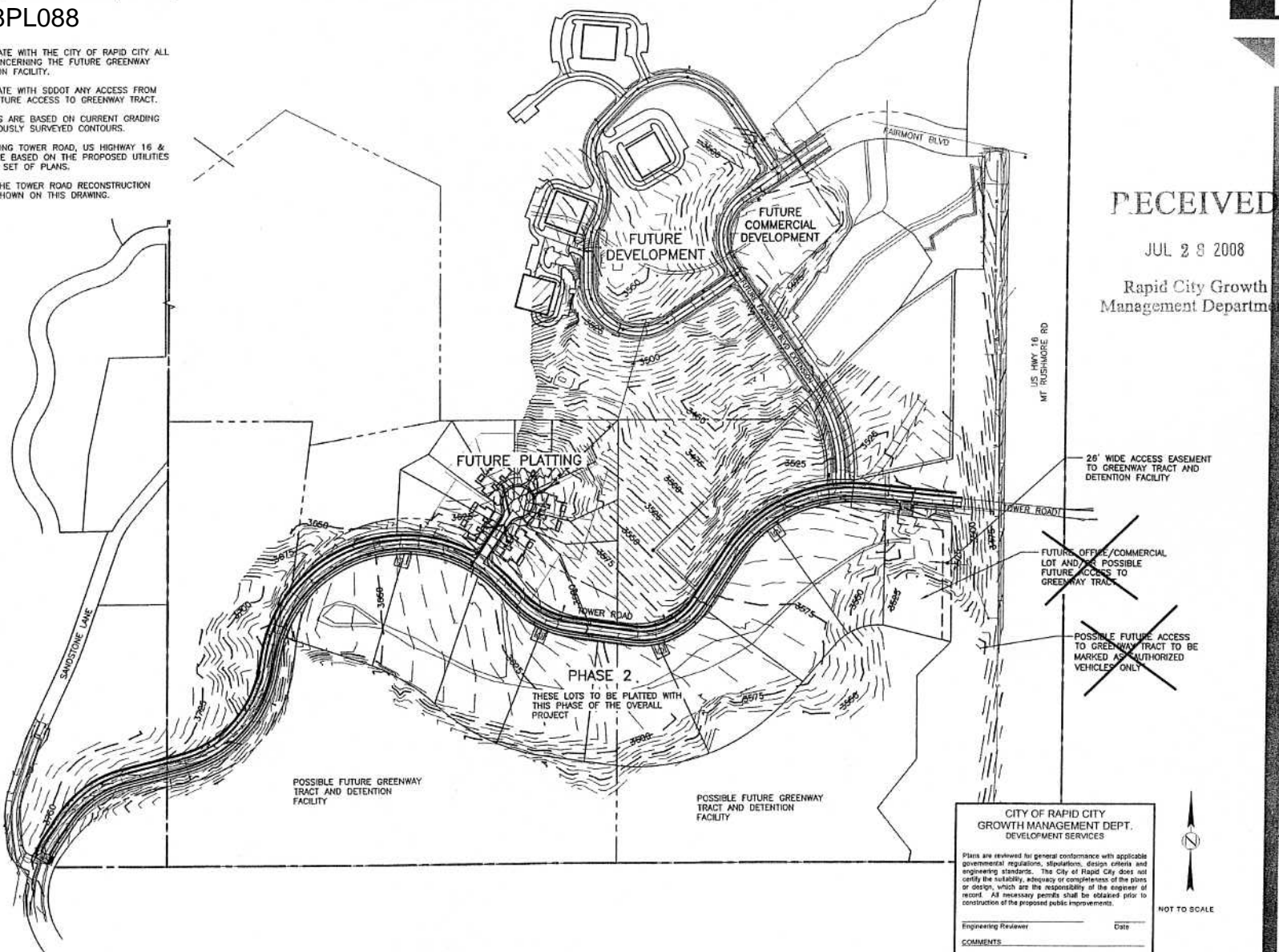

RECEIVED

JUL 28 2008

Rapid City Growth Management Department

CITY OF RAPID CITY
GROWTH MANAGEMENT DEPT.
DEVELOPMENT SERVICES

Plans are reviewed for general conformance with applicable governmental regulations, stipulations, design criteria and engineering standards. The City of Rapid City does not certify the suitability, adequacy or completeness of the plans or design, which are the responsibility of the engineer of record. All necessary permits shall be obtained prior to construction of the proposed public improvements.

Engineering Reviewer: _____ Date: _____

COMMENTS:

TOWER ROAD
RECONSTRUCTION PROJECT

JOB NUMBER: 07.1373.001
DATE: 03/20/08

REVISIONS

MASTER PLAN
SHEET MP-1

FOURFRON DESIGN, INC.
517 7th street rapid city sd 57701
ph: 605.342.9470 fax: 605.342.2327
www.frontrib.com
ARCHITECTURE | ENGINEERING | GIS | SURVEYING
RAPID CITY, SOUTH DAKOTA
NO part of this document may be reproduced in any form or by any means without permission from FourFront Design, Inc. Copyright 2008.