

08PD043

LEGEND

- EXISTING WATER VALVE / WATER LINE
- UNDERGROUND ELECTRIC
- ELECTRICAL BOX
- GAS LINE
- EXISTING SAN SEWER MANHOLE
- EXISTING SANITARY SEWER
- EXISTING SURFACE MAJOR CONTOUR
- EXISTING CONCRETE
- NEW WATER LINE
- NEW FIRE HYDRANT ASSEMBLY
- NEW WATER LINE ELBOW / FITTINGS
- NEW SANITARY SEWER LINE
- NEW SANITARY SEWER MANHOLE
- NEW SANITARY SEWER PIPE
- NEW STORM SEWER CATCH BASIN

REVISIONS

1. REFERENCE GENERAL NOTES
2. REFERENCE DETAIL SHEETS FOR CONSTRUCTION DETAILS
3. ALL WORK IS TO BE DONE TO THE CITY STANDARDS AND SPECIFICATIONS.
4. REFERENCE ARCHITECTURAL PLANS FOR ALL BUILDING SERVICES AND DOMESTIC SERVICE CONNECTION LOCATIONS.
5. COORDINATE AND DIMENSIONS ARE SHOWN TO CENTERLINE OF PIPE OR FITTINGS.
6. CONTRACTOR SHALL VERIFY ALL TRENCH DEPTHS TO MEET PRESSURE AND VACUUM REQUIREMENTS. CONTRACTOR SHALL VERIFY ALL TRENCH DEPTHS TO MEET PRESSURE AND VACUUM REQUIREMENTS.
7. THE CONTRACTOR IS RESPONSIBLE FOR EXTENDING SERVICE LINES TO THE WATER AND SANITARY SEWER MAINS.
8. CONTRACTOR SHALL COORDINATE PROPOSED RECONNECTION OF ALL UTILITIES WITH ARCHITECTURAL PLANS AS WELL AS UTILITY COMPANIES AND RECORDING OFFICES.
9. CONTRACTOR SHALL COMPLY FULLY WITH THE LATEST STANDARDS OF OTHER AGENCIES HAVING JURISDICTION FOR DESIGN AND CONSTRUCTION. THE CONTRACTOR SHALL USE SUPPORT SYSTEMS, SLOPING, RECORDING, AND OTHER STANDARDS OF OTHER AGENCIES. THE CONTRACTOR SHALL BE RESPONSIBLE FOR OBTAINING ALL NECESSARY PERMITS AND INSURANCE FROM THE CITY OF RAPID CITY.
10. CONTRACTOR IS RESPONSIBLE FOR VERIFYING THE LOCATION AND ELEVATION OF THE EXISTING UTILITIES AS SHOWN ON THESE PLANS BEFORE ANY CONSTRUCTION.
11. THE CONTRACTOR IS SPECIFICALLY NOTIFIED THAT THE LOCATION AND ELEVATION OF THE EXISTING UTILITIES AS SHOWN ON THESE PLANS IS BASED ON RECORDS OF THE VARIOUS UTILITY COMPANIES AND WHERE POSSIBLE, MEASUREMENTS TAKEN IN THE FIELD. THE CONTRACTOR SHALL BE RESPONSIBLE FOR VERIFYING THE LOCATION AND ELEVATION OF THE EXISTING UTILITIES AS SHOWN ON THESE PLANS BEFORE ANY CONSTRUCTION. THE CONTRACTOR SHALL BE RESPONSIBLE FOR OBTAINING ALL NECESSARY PERMITS AND INSURANCE FROM THE CITY OF RAPID CITY.
12. CONTRACTOR SHALL VERIFY THE HORIZONTAL AND VERTICAL LOCATION OF ALL EXISTING ABOVE GROUND STRUCTURES, PIPES, AND ALL UTILITIES BEFORE CONSTRUCTION.
13. CONTRACTOR TO REMOVE OR RELocate, WHEN APPLICABLE, ALL EXISTING BUILDINGS, FOUNDATIONS, EMBANKMENTS, AND CONNECTING IMPROVEMENTS, DRAIN PIPES, SANITARY SEWER PIPES, POWER POLES AND OUTLINES, WATER METERS AND WATER LINES, WELLS, BODYPANS, AND OTHER STRUCTURES AND SERVICES THAT ARE NOT SHOWN ON THE CONSTRUCTION PLANS AND WHERE NEEDED TO ALLOW FOR FULL MATERIAL, UNIFORM DIMENSIONS, TO BE RELOCATED AS NECESSARY.
14. CONTRACTOR IS RESPONSIBLE FOR REMOVAL OF DAMAGE TO ANY EXISTING IMPROVEMENTS DURING CONSTRUCTION, SUCH AS, BUT NOT LIMITED TO, UTILITIES, PAVEMENT, STORMING, CONCRETE, REPAIRS SHALL BE EQUAL TO BETTER THAN EXISTING CONDITIONS.
15. CONTRACTOR SHALL DESIGN TO ARCHITECTURAL PLANS AND SPECIFICATIONS FOR ACTUAL LOCATION OF ALL UTILITY ENTRANCES TO INCLUDE SANITARY SEWER LATERALS, CONCRETE AND THE PROTECTION WATER SERVICE, ELECTRICAL, TELEPHONE, CABLE, AND AIR CONDITIONING. CONTRACTOR SHALL COORDINATE THE INSTALLATION OF UTILITIES IN SUCH A MANNER AS TO AVOID CONFLICTS AND ASSURE PROPER LOCATIONS AND ANCHORS AS WELL AS ALL UTILITY REQUIREMENTS AS TO LOCATIONS AND SCHEDULING RE-AND CONNECTIONS PRIOR TO COMMENCING CONSTRUCTION.
16. CONTRACTOR SHALL COORDINATE WITH ARCHITECTURAL PLANS, POWER COMPANY, AND TELEPHONE COMPANY FOR ACTUAL LOCATION OF POWER AND TELEPHONE SERVICE TAPPING.
17. CONTRACTOR SHALL PAY ALL FEES AND CHARGES PERTAINING TO UTILITY CONSTRUCTION AND SHALL COORDINATE WITH ALL UTILITIES TO OBTAIN RECORDS FOR THE WORK.
18. SITE GEOGRAPHICAL INVESTIGATION IS RECOMMENDED FOR BACKFILLING AND COMPACTOR REQUIREMENTS ON UTILITY TRENCHES.
19. CONTRACTOR SHALL COORDINATE WITH OTHER UTILITIES TO AVOID CONFLICTS AND PREVENT ANY CONFLICT OF UTILITIES.
20. THE MINIMUM VERTICAL SEPARATION BETWEEN THE CLOSEST HORIZONTAL CENTERLINE OF THE WATER AND SANITARY SEWER LINE IS 18 INCHES. MINIMUM VERTICAL SEPARATION BETWEEN THE CLOSEST HORIZONTAL CENTERLINE OF THE WATER AND SANITARY SEWER LINE IS 18 INCHES.
21. CONTRACTOR SHALL VERIFY THE LOCATION AND ELEVATION OF ALL UTILITIES WITH THE APPROPRIATE AUTHORITIES BEFORE CONSTRUCTION.
22. ALL EXCAVATIONS SHOULD BE SHOWN OR INDICATED BY OTHER PLANS TO REMOVE EXISTING PIPES AND SERVICES WORKING UNDERGROUND. CONTRACTOR SHALL VERIFY THE LOCATION AND ELEVATION OF ALL UTILITIES BEFORE CONSTRUCTION. CONTRACTOR SHALL VERIFY THE LOCATION AND ELEVATION OF ALL UTILITIES BEFORE CONSTRUCTION. CONTRACTOR SHALL VERIFY THE LOCATION AND ELEVATION OF ALL UTILITIES BEFORE CONSTRUCTION.
23. CONTRACTOR SHALL VERIFY THE LOCATION AND ELEVATION OF ALL UTILITIES BEFORE CONSTRUCTION. CONTRACTOR SHALL VERIFY THE LOCATION AND ELEVATION OF ALL UTILITIES BEFORE CONSTRUCTION. CONTRACTOR SHALL VERIFY THE LOCATION AND ELEVATION OF ALL UTILITIES BEFORE CONSTRUCTION.

REVISIONS

1. REFERENCE UTILITY NOTES
2. REFERENCE DETAIL SHEETS FOR CONSTRUCTION DETAILS
3. ALL WORK IS TO BE DONE TO THE CITY STANDARDS AND SPECIFICATIONS.
4. REFERENCE ARCHITECTURAL PLANS FOR ALL BUILDING SERVICES AND DOMESTIC SERVICE CONNECTION LOCATIONS.
5. COORDINATE AND DIMENSIONS ARE SHOWN TO CENTERLINE OF PIPE OR FITTINGS.
6. CONTRACTOR SHALL VERIFY ALL TRENCH DEPTHS TO MEET PRESSURE AND VACUUM REQUIREMENTS. CONTRACTOR SHALL VERIFY ALL TRENCH DEPTHS TO MEET PRESSURE AND VACUUM REQUIREMENTS.
7. SANITARY SEWER PIPE OF DIFFERENT MATERIALS SHALL BE JOINED BY A LONG BOND.
8. SANITARY SEWER PIPE JOINTS SHALL BE MADE FOR TRENCHES FROM PIPING MATERIAL TO PROVIDE.
9. THE TOP ELEVATION OF ALL MANHOLES IN GRADED AREAS SHALL BE 18 INCHES ABOVE FINISHED GRADE.
10. THE SANITARY SEWER PIPE SHALL BE 18 INCHES ABOVE FINISHED GRADE.
11. CONTRACTOR SHALL VERIFY ALL TRENCH DEPTHS TO MEET PRESSURE AND VACUUM REQUIREMENTS.
12. CONTRACTOR SHALL VERIFY ALL TRENCH DEPTHS TO MEET PRESSURE AND VACUUM REQUIREMENTS.

REVISIONS

1. CONTRACTOR SHALL VERIFY ALL TRENCH DEPTHS TO MEET PRESSURE AND VACUUM REQUIREMENTS.

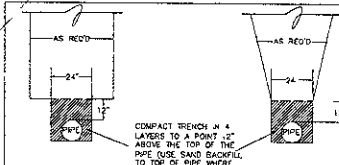
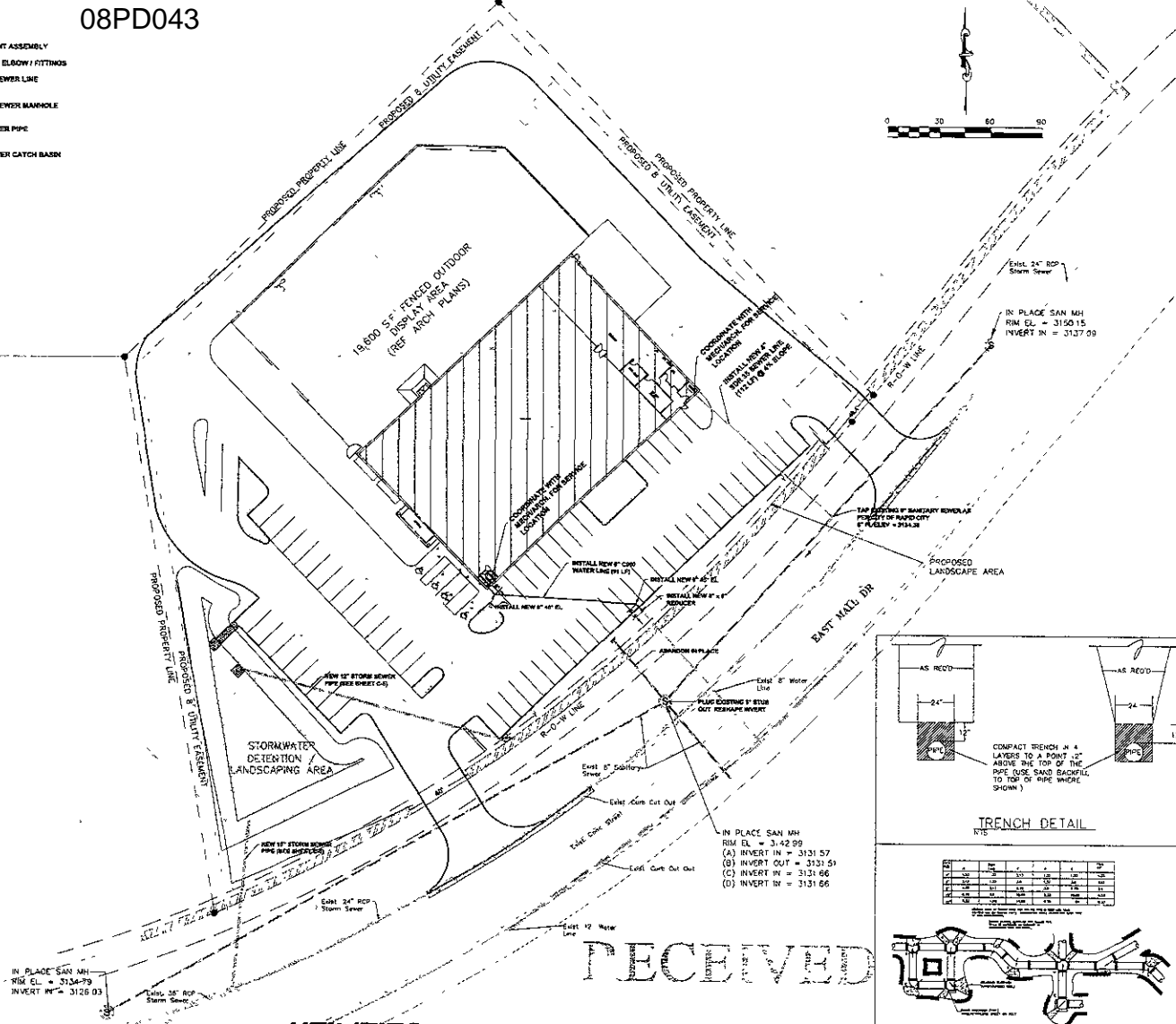

TRENCH DETAIL

NO.	DATE	BY	CHKD.	APP.	REV.
1	11/11/08	BRB	BRB		

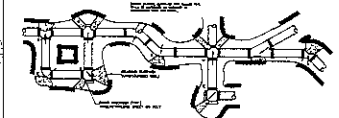

RECEIVED

1118 9 52000

T. C. ENGINEERING INC.  
North Platte, Nebraska

TRACTOR SUPPLY COMPANY  
Rapid City, South Dakota

SCALE  
As Shown