

**RECEIVED**  
 DEC 14 2007  
 Rapid City Growth  
 Management Department

**LANDSCAPE MATERIAL POINTS:**

TOTAL AREA OF LOT B (ASHLAND) (SQ. FT.)	= 63,780.0
TOTAL AREA OF EXISTING BUILDING COVERAGE (SQ. FT.)	= 14,670.0
TOTAL LANDSCAPE MATERIAL POINTS REQUIRED	= 78,450.0

27 LARGE TREES @ 2,000 P.M.P.A.	= 74,000.0
13 MEDIUM TREES @ 1,000 P.M.P.A.	= 13,000.0
200 SHRUBS @ 250 P.M.P.A.	= 50,000.0
500 1" BOLL TREES @ 12 P.M.P.A.	= 6,000.0
NEW VEGETATION NOT BILLED	= 0.0
TOTAL LANDSCAPE MATERIAL POINTS PROVIDED	= 170,000.0

**PARKING REQUIREMENTS:**

24 LOT SPACES	= 24 SPACES
FRONT RECEPTION AREA	= 10 SPACES
RECEPTION	= 5 SPACES
STORAGE #1 & #2 motel office	= 1 SPACE
TOTAL PARKING SPACES REQUIRED	= 40 SPACES
TOTAL PARKING SPACES PROVIDED	= 34 SPACES

*2 spots removed #12 + #39*

**SITE PLAN**  
 1" = 20'-0"

395 sq. (conference store)  
 120 sq. (motel office)



OWNER: DERBY ADVERTISING, INC.  
 ARCHITECTURE AND PLANNING (REG. 381-780)  
 4725 BRANSTATER BL.  
 RAPID CITY, SD 57702  
 CANYON LAKE RESORT  
 2720 CHAPEL LAKE  
 RAPID CITY, SD 57702  
 SITE PLAN  
 DATE: 12/14/07  
 PERM: 12/14/07  
 NEW: 12/24/07  
 A1

*Proposed*

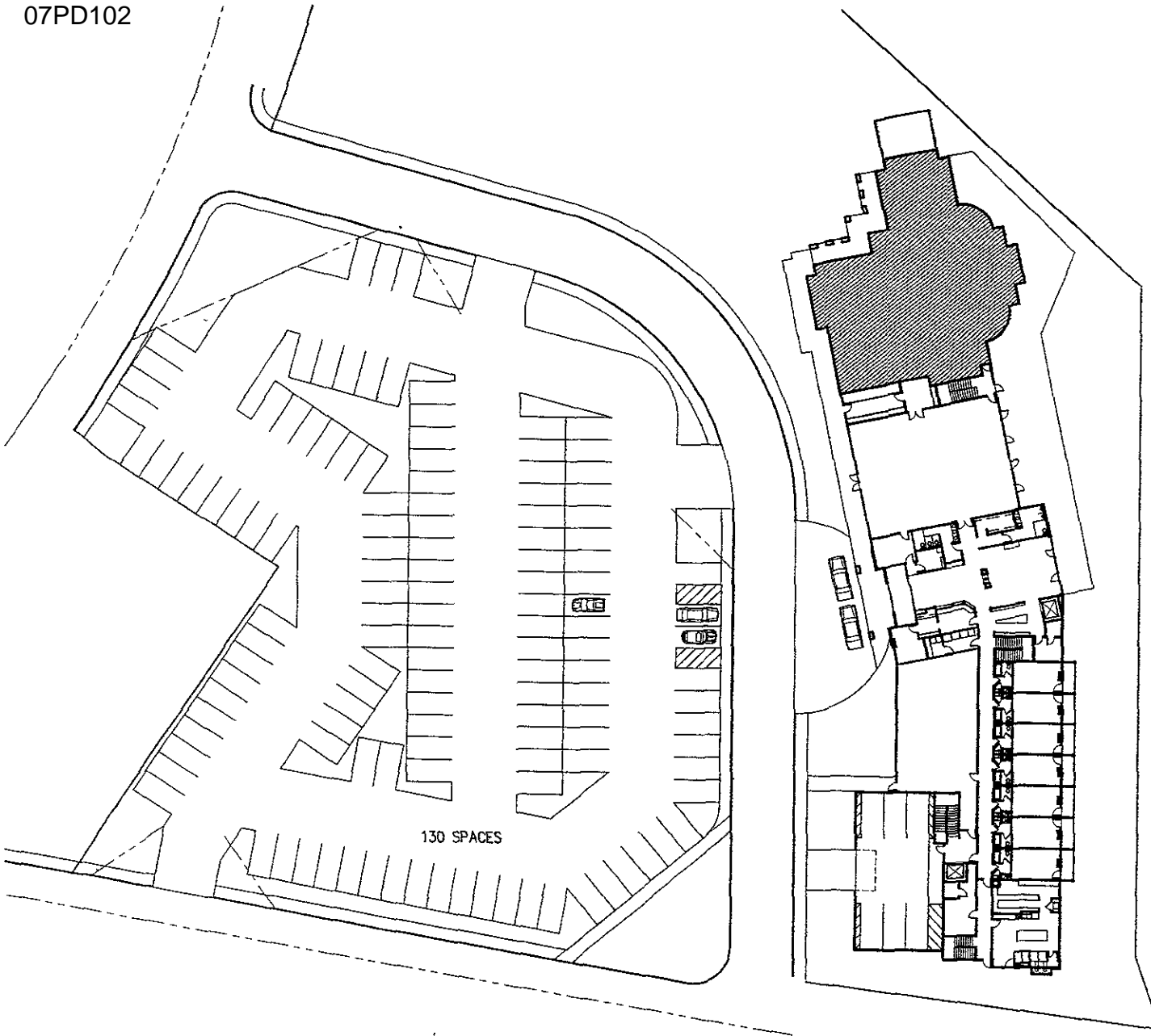

RECEIVED

DEC 14 2007

Rapid City Growth  
Management Department

RESORT SITE PLAN #3

1" = 40'-0"  
20'-0"



PRELIMINARY NOT FOR CONSTRUCTION  
NOV. 21, 2006