

PARCEL "A" OF SE 1/4 OF SW 1/4 OF SEC. 3, T1N, R7E, B,H,M.

RAPID CITY, PENNINGTON COUNTY, SOUTH DAKOTA.

RECEIVED

JUN 20 2008

Rapid City Growth Management Department

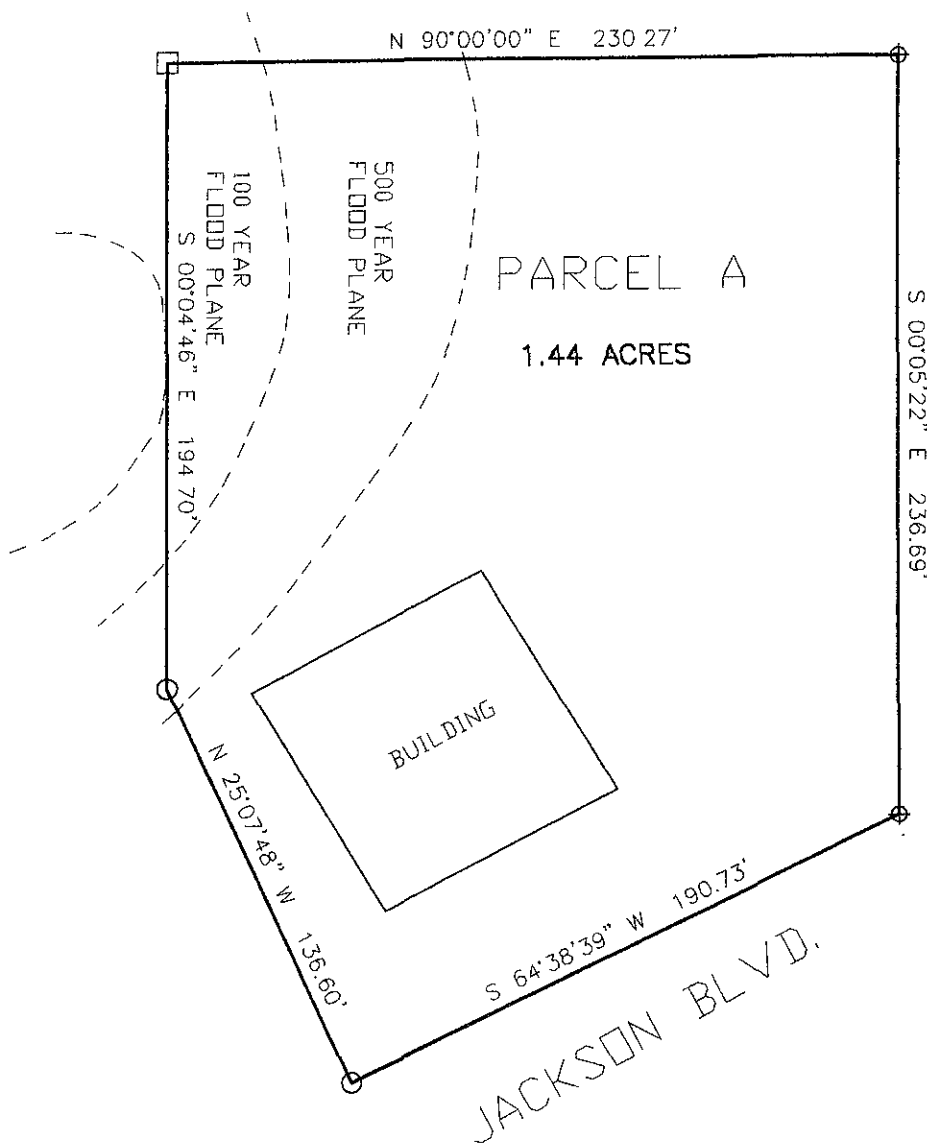

- NOTE:
- ⊕ FOUND SPERLICH PIN & CAP
 - FOUND 5/8 INCH REBAR
 - FOUND 1/2 INCH REBAR



SCALE: 1" = 60' JUNE 7, 2004

SURVEYOR'S CERTIFICATE

I, JOHN M. ARLETH, P.L.S., 3977, DEADWOOD, SD, DO HEREBY CERTIFY THAT THE PROPERTY SHOWN HEREON WAS SURVEYED AND STAKED UNDER MY SUPERVISION AND THAT ALL DIMENSIONS ARE TRUE AND CORRECT TO THE BEST OF MY KNOWLEDGE AND BELIEF DATED THIS 30 DAY OF JUNE, 2004.

JOHN M. ARLETH, P.L.S. 3977
 SOUTH DAKOTA

ARLETH & ASSOCIATES
 382 MAIN STREET
 DEADWOOD, SD 57732
 605-578-1637

PROJECT:
 RECORD OF SURVEY,
 2700 JACKSON BLVD,
 RAPID CITY, SD.

DATE: JUNE 7, 2004
 SCALE: 1" = 60'
 DRAWN BY: JM
 JOB NO: 8642