

RECOMMENDED PLANT MATERIAL

Large Trees

1. Summit Ash
2. Skyline Honey-Locust
3. American Linden
4. Weeping Willow
5. Black Hills Spruce

Medium Trees

1. Cutleaf Weeping Birch
2. Russian Olive
3. European Mountain Ash
4. Canadian Red Cherry
5. Quaking Aspen

Small Trees

1. Washington Hawthorn
2. Radiant Crabapple
3. Newport Plum
4. Common Chokecherry
5. Western Red Cedar

Shrubs

1. Japanese Barberry
2. Winged Euonymus
3. Red-Twig Dogwood
4. Potentilla
5. Spiraea
6. Mugho Pine
7. Arcadia Juniper
8. Scandia Juniper
9. Savin Juniper
10. Sea Green Juniper

PROHIBITED PLANT MATERIAL

1. Cottonwood (cotton producing)
2. Elm

LANDSCAPE MATERIAL POINTS TABLE

LARGE TREES	A minimum mature spread of 45 feet. Also, evergreen trees which reach a mature height of at least 20 feet.	2,000
MEDIUM TREES	A minimum mature spread of 25 feet.	1,000
SMALL TREES	A minimum mature spread of 15 feet.	500
SHRUBS	A minimum mature height of 2 feet.	250
GRASS AND GROUND COVER	1 square yard	10

PROPOSED LOCATION FOR SATELLITE DISH

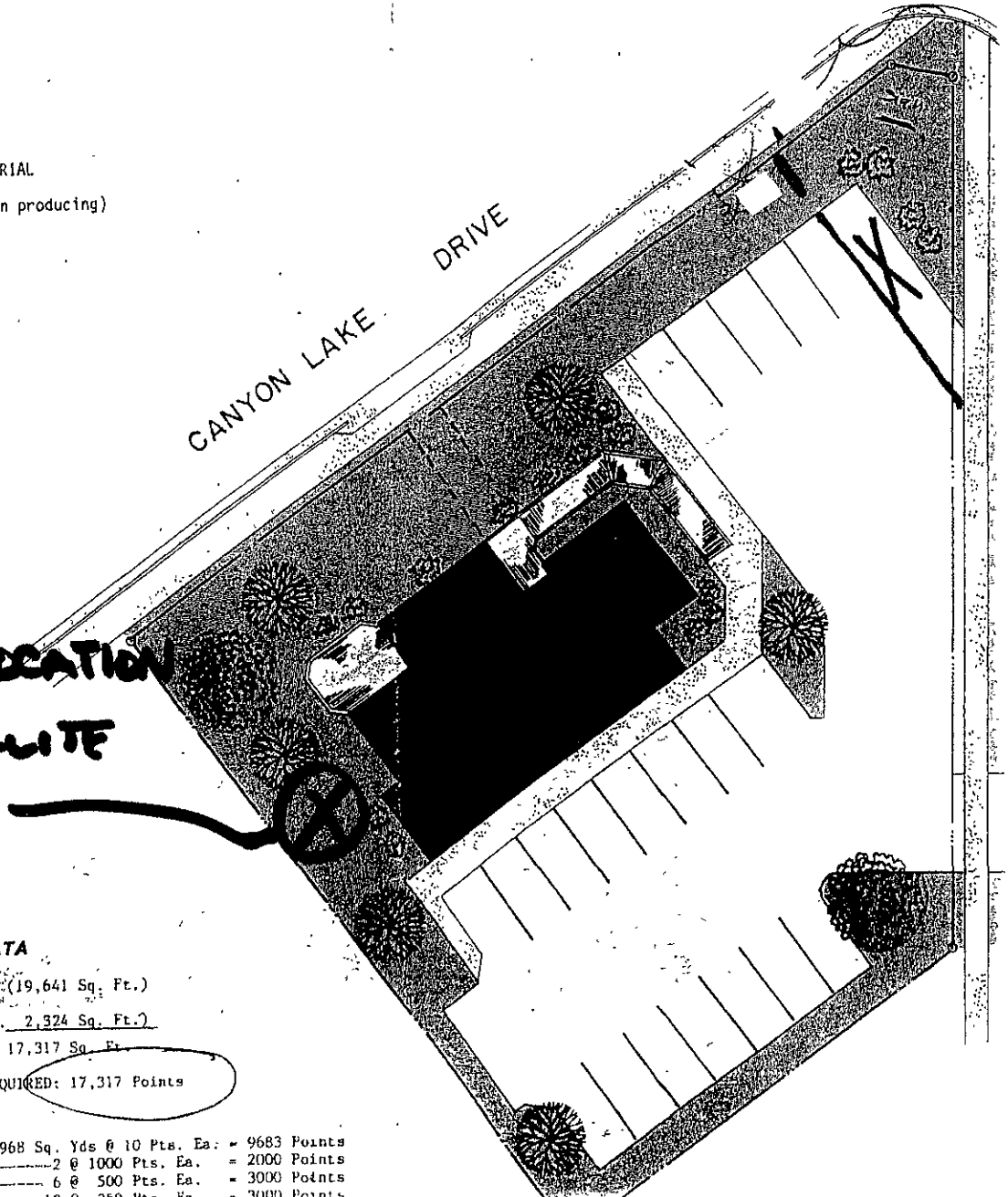

LANDSCAPING DATA

LOT SIZE: .4509 Ac. (19,641 Sq. Ft.)

DWELLING..... 2,324 Sq. Ft.)

17,317 Sq. Ft.

LANDSCAPE POINTS REQUIRED: 17,317 Points

LANDSCAPING:

Grass area ----- 968 Sq. Yds @ 10 Pts. Ea. = 9683 Points
 Medium Size trees-----2 @ 1000 Pts. Ea. = 2000 Points
 Small Size Trees-----6 @ 500 Pts. Ea. = 3000 Points
 Shrubs-----12 @ 250 Pts. Ea. = 3000 Points