

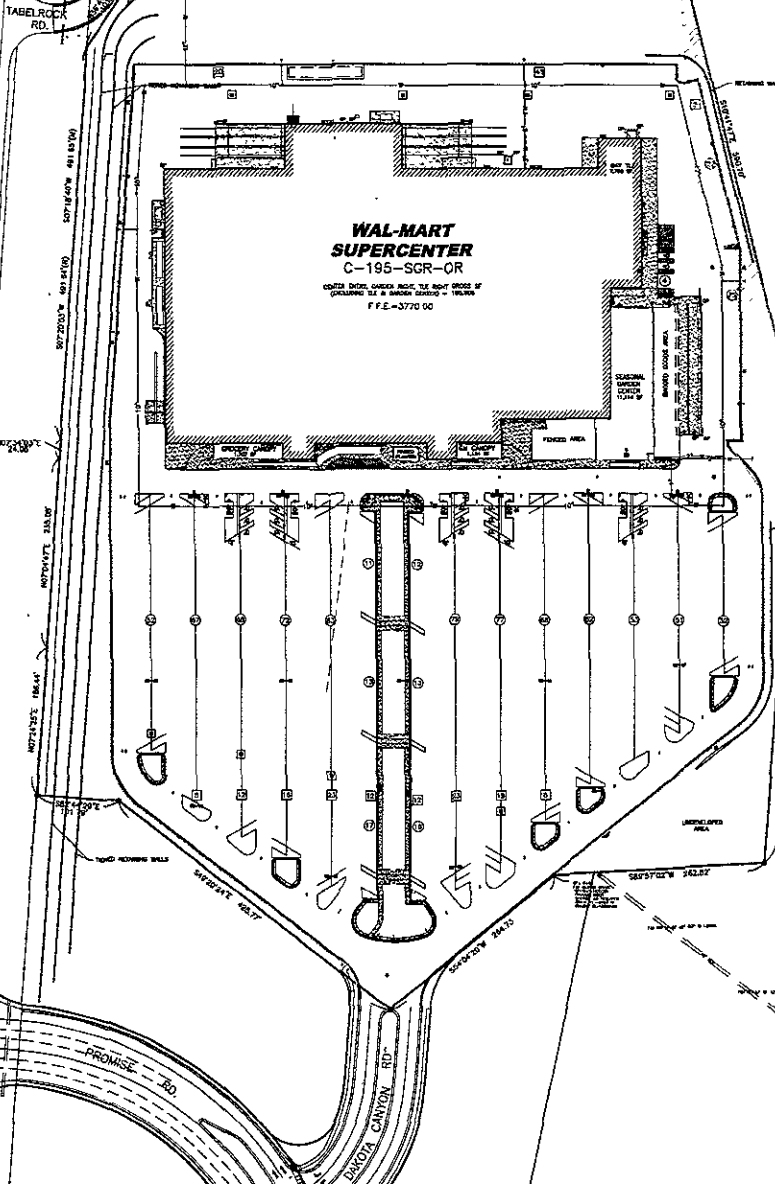

LANDSCAPE NOTES:

1. Contractor shall place a minimum of 18" of soil along all backs of curb, streets and concrete walks. Grasses grass that drain leaves curbs, sidewalks and concrete walks shall have 10 feet of soil placed. All other landscaper areas shall be seeded, mulched, fertilized and maintained until a healthy stand of grass is achieved.
2. After a stand of grass is established and no more erosion and sediment is expected, concrete walks shall be finished out.
3. The site work for this project shall meet or exceed the "Red-Bart Standard Sitework Specifications".
4. The Contractor shall provide the best a two-year maintenance contract for all landscaping and all irrigation system.
5. The greater areas shall have a weed barrier and be covered with a hardwood mulch of 4" in minimum depth. A steel edge shall be used on all landscaped areas within grass areas.
6. The Contractor is specifically cautioned that the locations and/or elevation of existing utilities are shown on these plans is based on records of the various utility companies and, where possible, measurements taken in the field. The information is not to be relied on as being exact or complete. The Contractor must call the appropriate utility company to request exact field location of utilities. It shall be the responsibility of the Contractor to resolve all existing utilities when conflict with the proposed improvements shown on plans.
7. All landscaped areas are to receive six inches of topsoil. Contractor to seed, mulch, fertilize, and maintain all areas outside of paved areas that were disturbed during construction and in accordance with the "Standard Specifications for Highway Construction and the Red-Bart Standard Sitework Specifications".
8. Soil shall be well-aerated and be completely free from noxious weeds and reasonably free from other objectionable grasses, weeds, and stones. Seeding and seeding shall be done in accordance with the "Standard Specifications for Highway Construction and the Red-Bart Standard Sitework Specifications".
9. All plants must be healthy, vigorous material, free of pest and disease.
10. All plants that be container grown or balled and burlapped as specified on the plans.
11. All trees must be straight trunked and full headed and meet all requirements specified.
12. All plants are subject to the approval of the Landscape Architect and/or Wal-Mart Construction Manager before, during and after installation.
13. Prior to construction, the Contractor shall be responsible for locating all underground utilities and shall avoid damage to all utilities during the course of the work. The Contractor is responsible for repairing and/or restoring to utility, structures, etc. as required, which occur as a result of the landscape and irrigation construction.
14. Contractor is responsible for verifying all quantities shown on these plans before pricing the work.
15. All planter borders and planter areas shall be formed with a 2% IV slope and seeded to meet all seeding specifications, unless otherwise indicated on these plans.



**PLANTING LEGEND**

COMMON NAME (PLANT LABEL)	SYMBOL	QUANTITIES	UNITS/NO. PLANTS	SCIENTIFIC NAME	PLANT SIZE
IMPATIENS (2)	(Symbol)	10	2000	OLEARIA TRICANTHOS "NIPALUS"	2" CALIPER
RED OAK (2)	(Symbol)	20	2000	QUERCUS RUBRA	2" CALIPER
SHED SHELL LINDEN (2)	(Symbol)	20	2000	TILIA CORDATA "SOLDEN SPICE"	2" CALIPER
SHAW SPICE OAK (2)	(Symbol)	100	2000	QUERCUS ALBA	2" CALIPER
SLIP OAK (2)	(Symbol)	20	2000	QUERCUS MICROCARPA	2" CALIPER
HORNED WATTLE (2)	(Symbol)	10	2000	ACER FLAMMULOIDES	2" CALIPER
WHITE SPRUCE (2)	(Symbol)	10	2000	PICEA CANADENSIS	6" TALL
BLACK HILLS SPRUCE (2)	(Symbol)	10	2000	PICEA MARIA MICHXIIANA	6" TALL
ROCKY MOUNTAIN SPRUCE (2)	(Symbol)	20	2000	PICEA MURICATA	6" TALL
ORIENTAL BURNING BUSH	(Symbol)	20	2000	EUONYMUS ALATUS	24 IN.
BLUE HIC. LAMPYR (2)	(Symbol)	20	2000	WILLOW	3 IN.
MORNING HOLLY (2)	(Symbol)	10	2000	ILEX NEROLATA	2 1/2 IN.
RED	(Symbol)	10	2000		1 1/2" WIDE
MULCH	(Symbol)	10	2000		4" DEEP

NOTE: ALL QUANTITIES HAVE BEEN PROVIDED FOR CONFORMANCE ONLY. CONTRACTOR TO VERIFY ALL QUANTITIES.

**LANDSCAPE PLAN LEGEND**

SYMBOL	DESCRIPTION	SYMBOL	DESCRIPTION
(Symbol)	AREA ELECTRIC	(Symbol)	IRRIGATION
(Symbol)	UNDERGROUND ELECTRIC	(Symbol)	IRRIGATION VALVE
(Symbol)	UTILITY MARKER	(Symbol)	IRRIGATION LINE
(Symbol)	4.5" PIPE	(Symbol)	IRRIGATION CONTROL VALVE
(Symbol)	GUARD POST	(Symbol)	IRRIGATION BACKFLOW PREVENTER
(Symbol)	EMERGENCY SIGN	(Symbol)	IRRIGATION MAIN
(Symbol)	EMERGENCY SIGN	(Symbol)	IRRIGATION BRANCH
(Symbol)	EMERGENCY SIGN	(Symbol)	IRRIGATION DRAIN
(Symbol)	EMERGENCY SIGN	(Symbol)	IRRIGATION END
(Symbol)	EMERGENCY SIGN	(Symbol)	IRRIGATION STOP
(Symbol)	EMERGENCY SIGN	(Symbol)	IRRIGATION START
(Symbol)	EMERGENCY SIGN	(Symbol)	IRRIGATION TEE
(Symbol)	EMERGENCY SIGN	(Symbol)	IRRIGATION JUNCTION
(Symbol)	EMERGENCY SIGN	(Symbol)	IRRIGATION CROSSING
(Symbol)	EMERGENCY SIGN	(Symbol)	IRRIGATION VALVE
(Symbol)	EMERGENCY SIGN	(Symbol)	IRRIGATION CONTROL VALVE
(Symbol)	EMERGENCY SIGN	(Symbol)	IRRIGATION BACKFLOW PREVENTER
(Symbol)	EMERGENCY SIGN	(Symbol)	IRRIGATION MAIN
(Symbol)	EMERGENCY SIGN	(Symbol)	IRRIGATION BRANCH
(Symbol)	EMERGENCY SIGN	(Symbol)	IRRIGATION DRAIN
(Symbol)	EMERGENCY SIGN	(Symbol)	IRRIGATION END
(Symbol)	EMERGENCY SIGN	(Symbol)	IRRIGATION STOP
(Symbol)	EMERGENCY SIGN	(Symbol)	IRRIGATION START
(Symbol)	EMERGENCY SIGN	(Symbol)	IRRIGATION TEE
(Symbol)	EMERGENCY SIGN	(Symbol)	IRRIGATION JUNCTION
(Symbol)	EMERGENCY SIGN	(Symbol)	IRRIGATION CROSSING

**BFA**  
CONSULTING ENGINEERS & ARCHITECTS  
1001 WEST 10TH AVENUE  
DENVER, CO 80202  
TELEPHONE: (303) 733-1121  
FAX: (303) 733-1122

PRELIMINARY DRAWING

WAL-MART SUPERCENTER #3872-02  
RAPID CITY, PENNINGTON COUNTY, S.D.  
WAL-MART STORES, INC. 2001 SE 10TH ST.,  
BENTONVILLE, AR 72716

DRAWN BY: J.L.M.  
CHECKED BY: G.C.  
DATE: 02/25/03  
SCALE: 1" = 60'  
SHEET NO: 08-2855  
SHEET NAME: LANDSCAPE PLAN