

CITY OF RAPID CITY
GROWTH MANAGEMENT DEPT.
DEVELOPMENT SERVICES

There are intended for general information and are not to be used for legal purposes. The City will not be liable for any damages or liability arising out of the use of these drawings. The user assumes all responsibility for the accuracy of the information provided. The user agrees to hold the City harmless for any and all damages or liability arising out of the use of these drawings.

DATE: _____
DRAWN BY: _____

COPPERFIELD VISTAS, PHASE I

ROCKY MOUNTAIN PIPELINE RELOCATION

PROJECT LOCATION

INDEX OF SHEETS

- 1 COVER SHEET
- 2 OVERALL SITE AND SURVEY CONTROL
- 3-9 PLAN & PROFILES

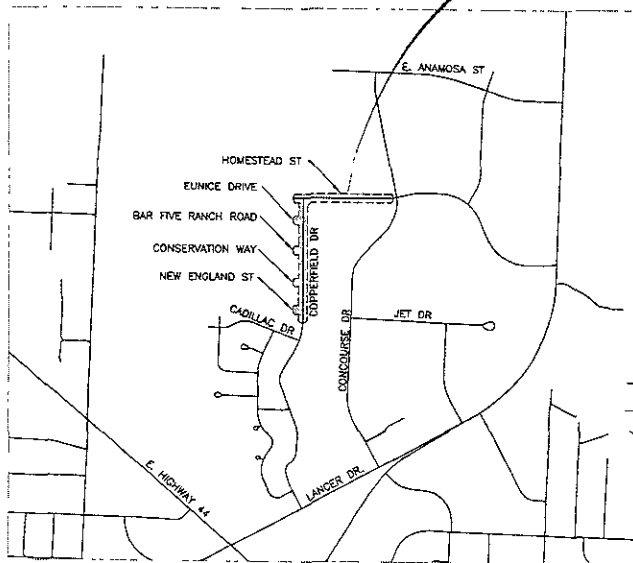

PROJECT LOCATION MAP NOT TO SCALE

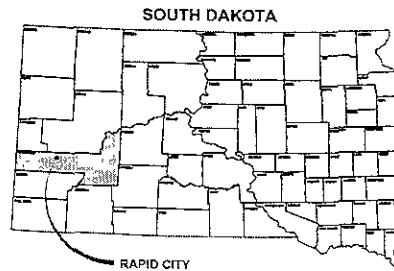

RAPID CITY

ONE CALL
BEFORE DIGGING
1-800-781-7474

REF.-ITL	REF.-NO	TITLE OF REFERENCE DRAWING	DRAWING NO

ROONEY ENGINEERING
CENTENNIAL COLORADO

PC	DATE	PG	DATE	RWB	DATE	NO	ISSUED FOR REVIEW
NAME	DATE	NAME	DATE	NAME	DATE	REV. NO	REVISION
OPERATIONS		ENGINEERING		DRAFTING			

PLAINS PIPELINE, L.P.

COPPERFIELD VISTAS, PHASE I
ROCKY MOUNTAIN PIPELINE RELOCATION
COVER SHEET

DRAWN BY: RWB	CHECKED BY: PG	DATE: 04/24/08	SCALE: AS NOTED	DATE: 04/24/08	SCALE: AS NOTED
---------------	----------------	----------------	-----------------	----------------	-----------------

2556M0101

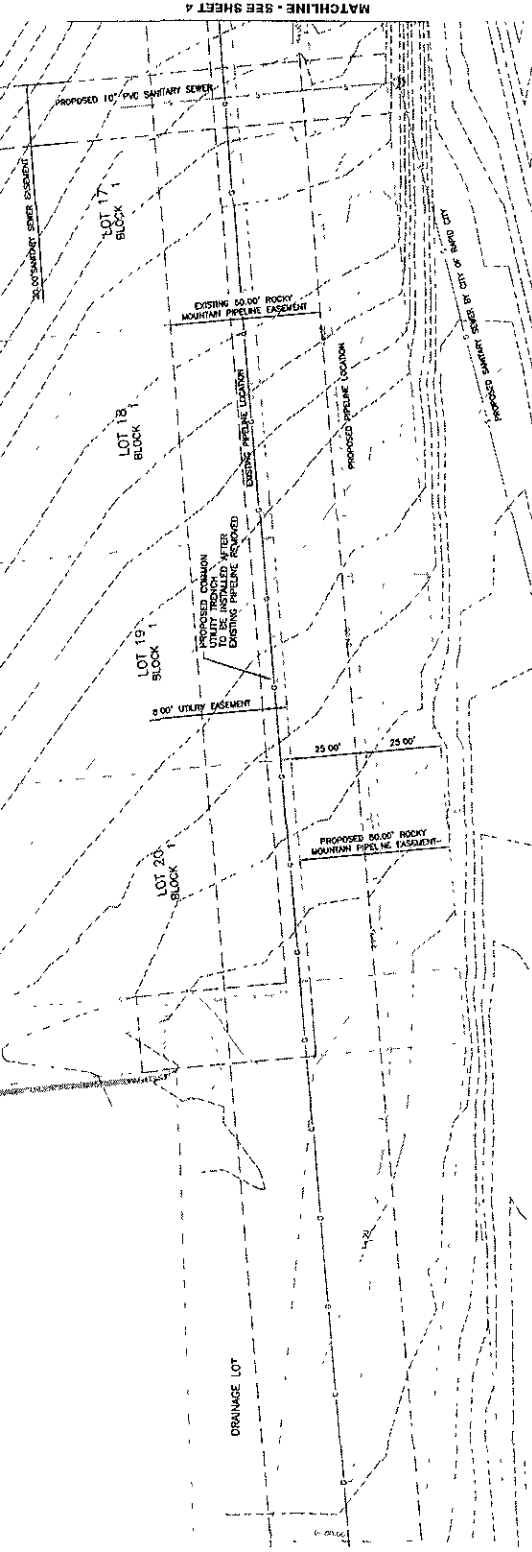

MATCHLINE - SEE SHEET A



DATE	DESCRIPTION	BY	CHKD.	APP'D.
11/27/22	PRELIMINARY DESIGN			
12/14	REVISIONS			
1/10	REVISIONS			
3/25	REVISIONS			
3/26	REVISIONS			
1/12	REVISIONS			
1/9	REVISIONS			
1/1	REVISIONS			

CITY OF RAPID CITY
 GREAT PLAINS ENVIRONMENTAL SERVICES
 PROJECT: ROCKY MOUNTAIN PIPELINE RELOCATION
 SHEET: 04/22/03
 SCALE: AS NOTED
 DRAWN BY: []
 CHECKED BY: []
 DATE: 04/22/03

PLAINS
 PIPELINE, L.P.
 COPPERFIELD MISTAS, PHASE I
 ROCKY MOUNTAIN PIPELINE RELOCATION
 PLAN / PROFILE FROM 10+00 TO 5+00
 SHEET: 04/22/03
 SCALE: AS NOTED
 DRAWN BY: []
 CHECKED BY: []
 DATE: 04/22/03

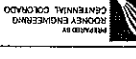

NO.	DATE	BY	CHKD.	APP'D.	REVISION
1					ISSUE FOR REVIEW
2					
3					
4					
5					
6					
7					
8					
9					
10					

TITLE OF REFERENCE DRAWING: []
 DRAWING NO: []

DATE

REVISION

ISSUED FOR REVIEW

DATE

NO.

DRAWN

DATE

NO.

OPERATIONS

DATE

NO.

ENGINEERING

DATE

NO.

DRAFTING

DATE

NO.

OPERATIONS

DATE

NO.

ENGINEERING

DATE

NO.

DRAFTING

DATE

NO.

OPERATIONS

DATE

NO.

ENGINEERING

DATE

NO.

DRAFTING

DATE

NO.

OPERATIONS

DATE

NO.

ENGINEERING

DATE

NO.

DRAFTING

REF-NO
DRAWING NO.

REDAK
CENTRAL ENGINEERING
DENVER, COLORADO



CITY OF RAPID CITY
GROWTH AND DEVELOPMENT
DEPARTMENT SERVICES

This is a technical drawing prepared by a professional engineer for the City of Rapid City. It is intended for use in the planning and design of public works. It is not to be used for any other purpose without the written consent of the City of Rapid City. The City of Rapid City is not responsible for any errors or omissions in this drawing. It is the responsibility of the engineer to ensure that all information is accurate and complete.

PROJECT: _____
SHEET: 40 OF 40
DATE: _____

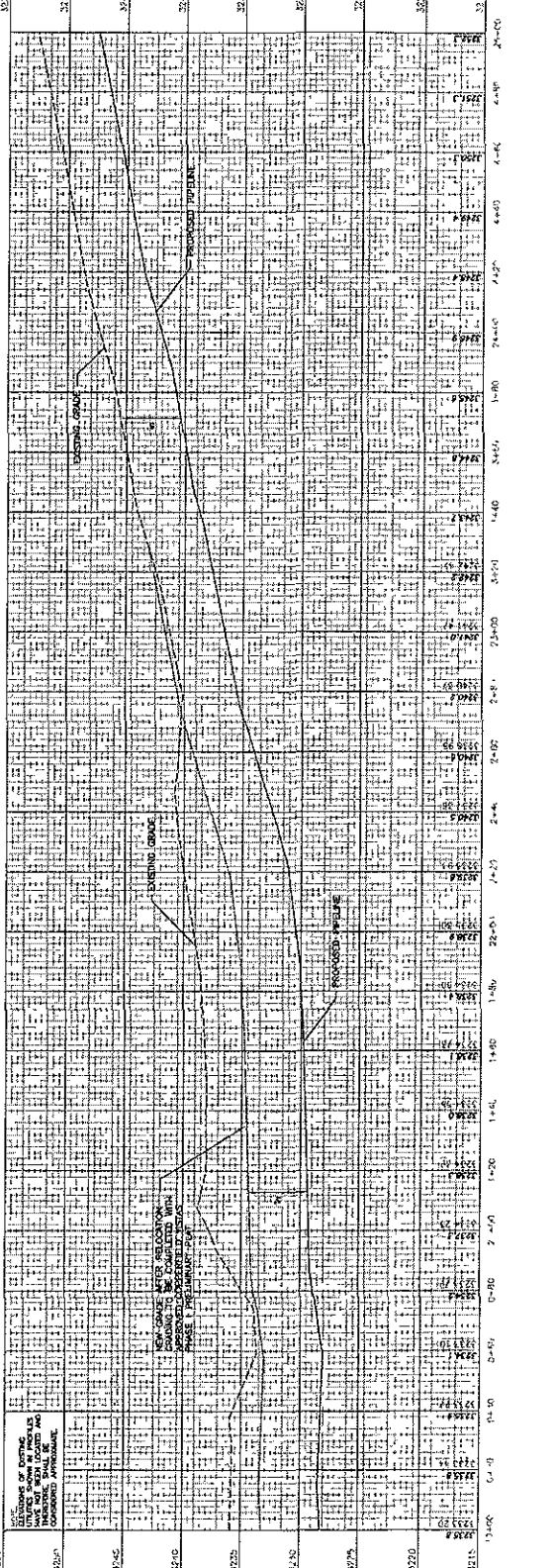
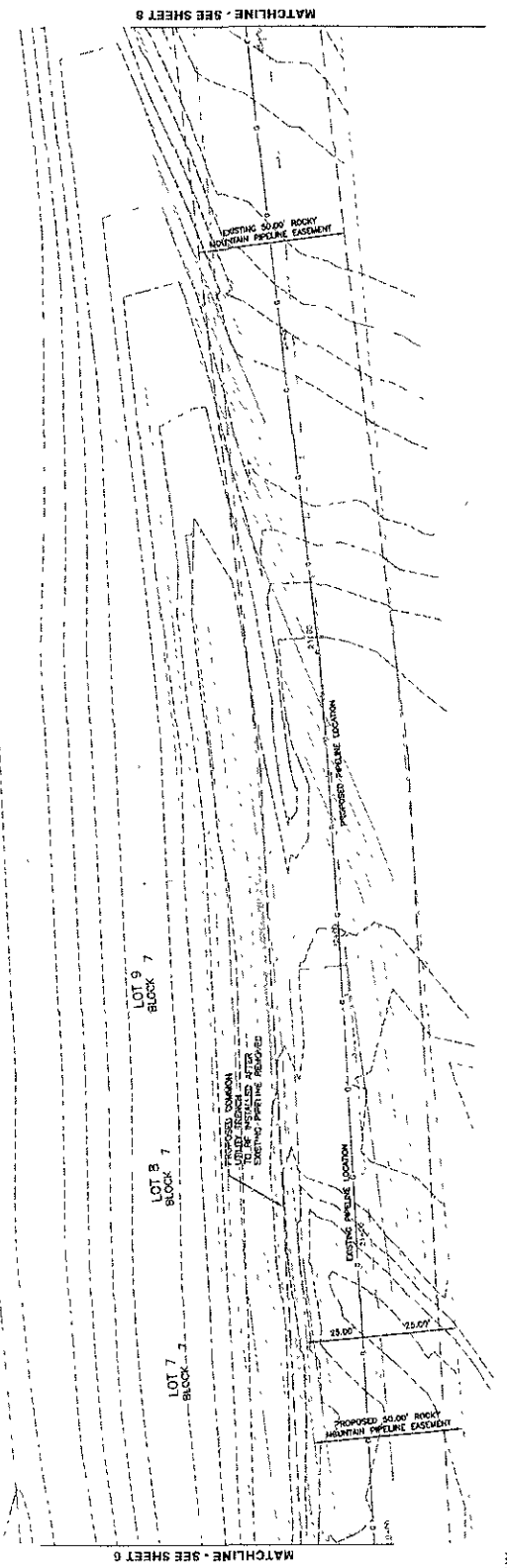

MATCHLINE - SEE SHEET 6

MATCHLINE - SEE SHEET 8

LOT 9
BLOCK 7

LOT 8
BLOCK 7

LOT 7
BLOCK 7

MATCHLINE - SEE SHEET 6

MATCHLINE - SEE SHEET 8

LOT 9
BLOCK 7

LOT 8
BLOCK 7

LOT 7
BLOCK 7

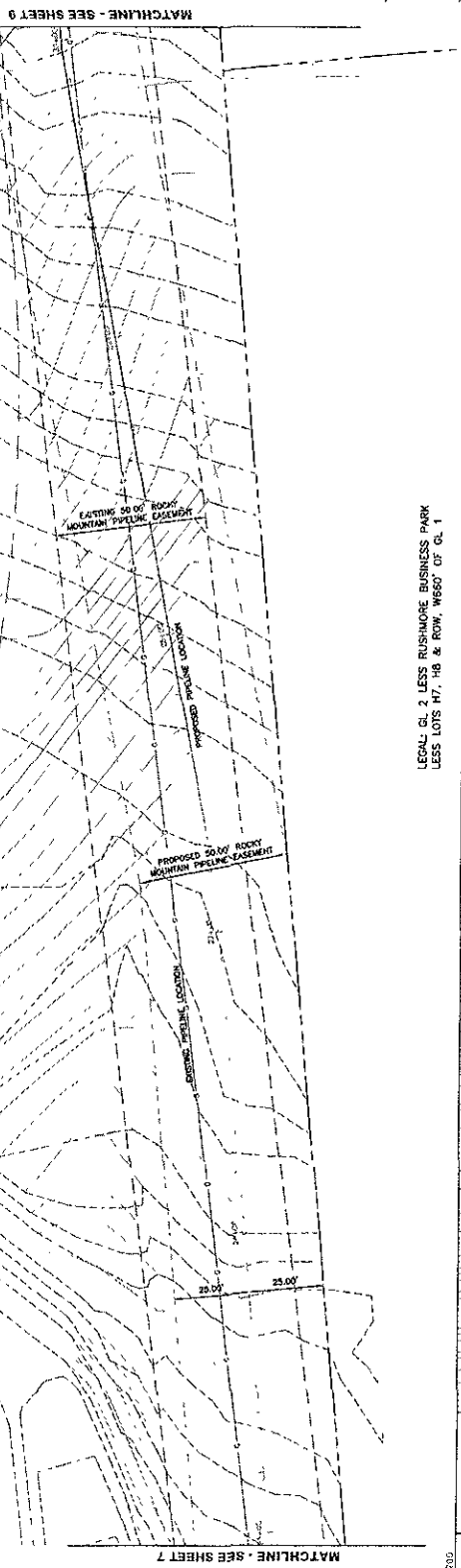

LEGAL: CL 2 LESS RUSHMORE BUSINESS PARK
 LESS LOTS M7, H8 & ROW, W850' OF CL 1

CITY OF RAPID CITY
 DEVELOPMENT SERVICES
 These are intended for general information only. They are not intended to be used for any other purpose. The City of Rapid City is not responsible for the accuracy or completeness of the information provided. The City of Rapid City is not responsible for the accuracy or completeness of the information provided. The City of Rapid City is not responsible for the accuracy or completeness of the information provided.

KEY MAP
 A14

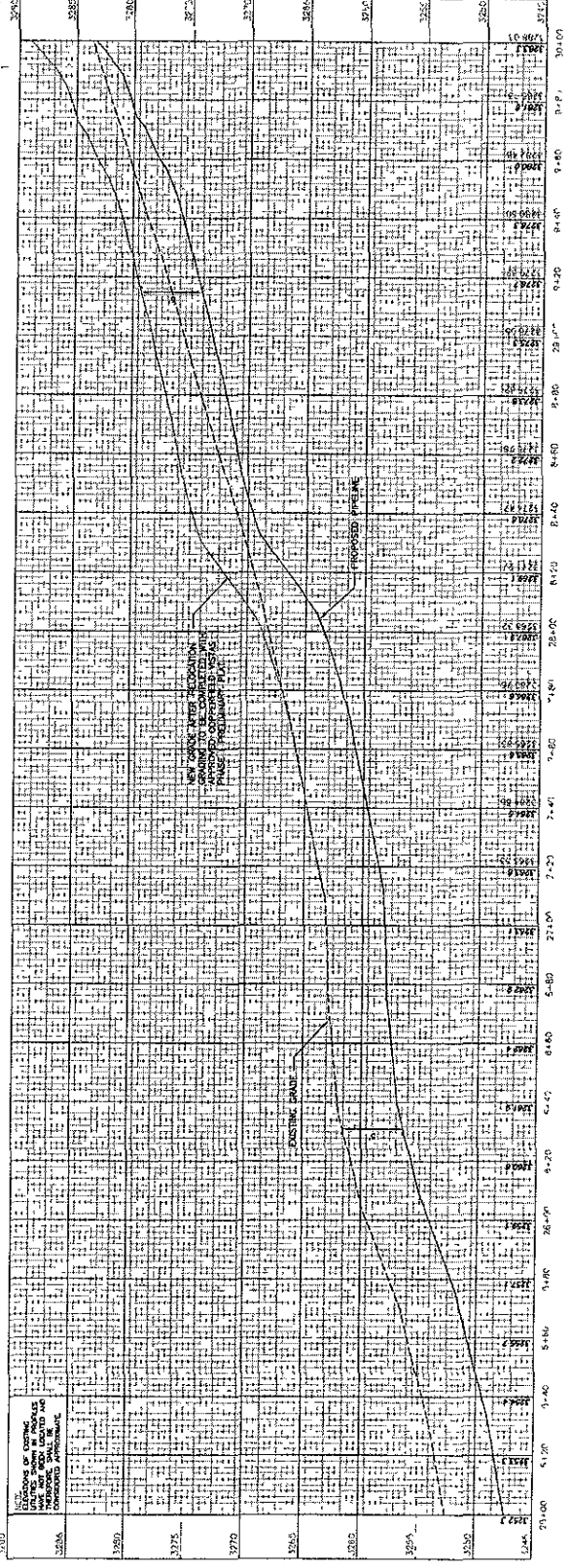

NO.	DATE	BY	CHKD.	REVISED FOR	NO.	NO.
1	05/24/08	PG	PG	DESIGNED FOR REVIEW	1	1
2					2	2
3					3	3
4					4	4
5					5	5
6					6	6
7					7	7
8					8	8
9					9	9
10					10	10
11					11	11
12					12	12
13					13	13
14					14	14
15					15	15
16					16	16
17					17	17
18					18	18
19					19	19
20					20	20
21					21	21
22					22	22
23					23	23
24					24	24
25					25	25
26					26	26
27					27	27
28					28	28
29					29	29
30					30	30
31					31	31
32					32	32
33					33	33
34					34	34
35					35	35
36					36	36
37					37	37
38					38	38
39					39	39
40					40	40
41					41	41
42					42	42
43					43	43
44					44	44
45					45	45
46					46	46
47					47	47
48					48	48
49					49	49
50					50	50
51					51	51
52					52	52
53					53	53
54					54	54
55					55	55
56					56	56
57					57	57
58					58	58
59					59	59
60					60	60
61					61	61
62					62	62
63					63	63
64					64	64
65					65	65
66					66	66
67					67	67
68					68	68
69					69	69
70					70	70
71					71	71
72					72	72
73					73	73
74					74	74
75					75	75
76					76	76
77					77	77
78					78	78
79					79	79
80					80	80
81					81	81
82					82	82
83					83	83
84					84	84
85					85	85
86					86	86
87					87	87
88					88	88
89					89	89
90					90	90
91					91	91
92					92	92
93					93	93
94					94	94
95					95	95
96					96	96
97					97	97
98					98	98
99					99	99
100					100	100

TITLE OF REFERENCE DRAWING
 DRAWING NO.
 REF-NO.

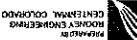

PLAINFIELD PIPELINE, L.P.
 COPPERFIELD VISTAS, PHASE I
 ROCKY MOUNTAIN PIPELINE RELOCATION
 PLAN / PROFILE 38+00 TO 35+00

2556M0109

DATE	DATE	DATE	DATE	DATE	DATE	DATE
1/24/08	1/24/08	1/24/08	1/24/08	1/24/08	1/24/08	1/24/08
DATE	DATE	DATE	DATE	DATE	DATE	DATE

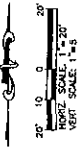

CITY OF RABBIT CITY
 GROWTH MANAGEMENT DEPT.
 DEVELOPMENT / PERMIT

Have any related or ground conditions been identified and existing conditions. The City of Rabbit City hereby certifies that the above information is true and correct and that the same are true and correct as of the date of this permit and are hereby certified by the City of Rabbit City.

REVISION NO. 1
 DATE 1/24/08
 DRAWN BY: [Name]
 CHECKED BY: [Name]
 COMMENTS:

END OF PROJECT

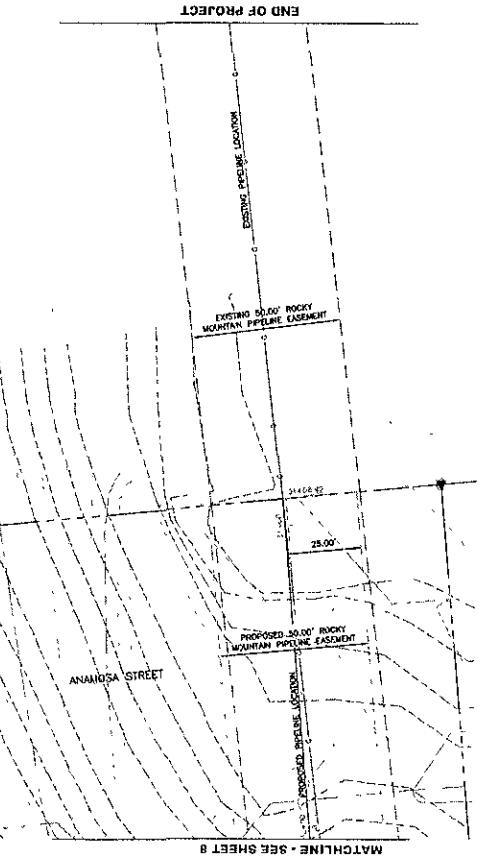

PC DATE	PC NAME	PC DATE	PC NAME	PC DATE	PC NAME	PC DATE	PC NAME	PC DATE	PC NAME	PC DATE	PC NAME
1/24/08	JANIS	1/24/08	JANIS	1/24/08	JANIS	1/24/08	JANIS	1/24/08	JANIS	1/24/08	JANIS
1/24/08	JANIS	1/24/08	JANIS	1/24/08	JANIS	1/24/08	JANIS	1/24/08	JANIS	1/24/08	JANIS
1/24/08	JANIS	1/24/08	JANIS	1/24/08	JANIS	1/24/08	JANIS	1/24/08	JANIS	1/24/08	JANIS
1/24/08	JANIS	1/24/08	JANIS	1/24/08	JANIS	1/24/08	JANIS	1/24/08	JANIS	1/24/08	JANIS

CENTRAL ENGINEERING
 CENTRAL, COLORADO

TITLE OF REFERENCE DRAWING

RES-140 DRAWING NO

DATE

REVISION

ANAMOSA STREET

PROPOSED 30.00' ROCKY MOUNTAIN PIPELINE EASEMENT

EXISTING 50.00' ROCKY MOUNTAIN PIPELINE EASEMENT

EXISTING PIPELINE LOCATION

NEW PIPELINE AT EXISTING LOCATION
 APPROVED SUPPLEMENTAL DRIVING
 PLUS 1' FREE BINARY PLAN

EXISTING EASEMENT

PROPOSED PIPELINE

MATCHLINE - SEE SHEET B

EXISTING 50.00' ROCKY MOUNTAIN PIPELINE EASEMENT

PROPOSED 30.00' ROCKY MOUNTAIN PIPELINE EASEMENT

EXISTING PIPELINE LOCATION

NEW PIPELINE AT EXISTING LOCATION
 APPROVED SUPPLEMENTAL DRIVING
 PLUS 1' FREE BINARY PLAN

EXISTING EASEMENT

PROPOSED PIPELINE