

PHASE I

EROSION AND SEDIMENTATION CONTROL PLAN / SITE MAP

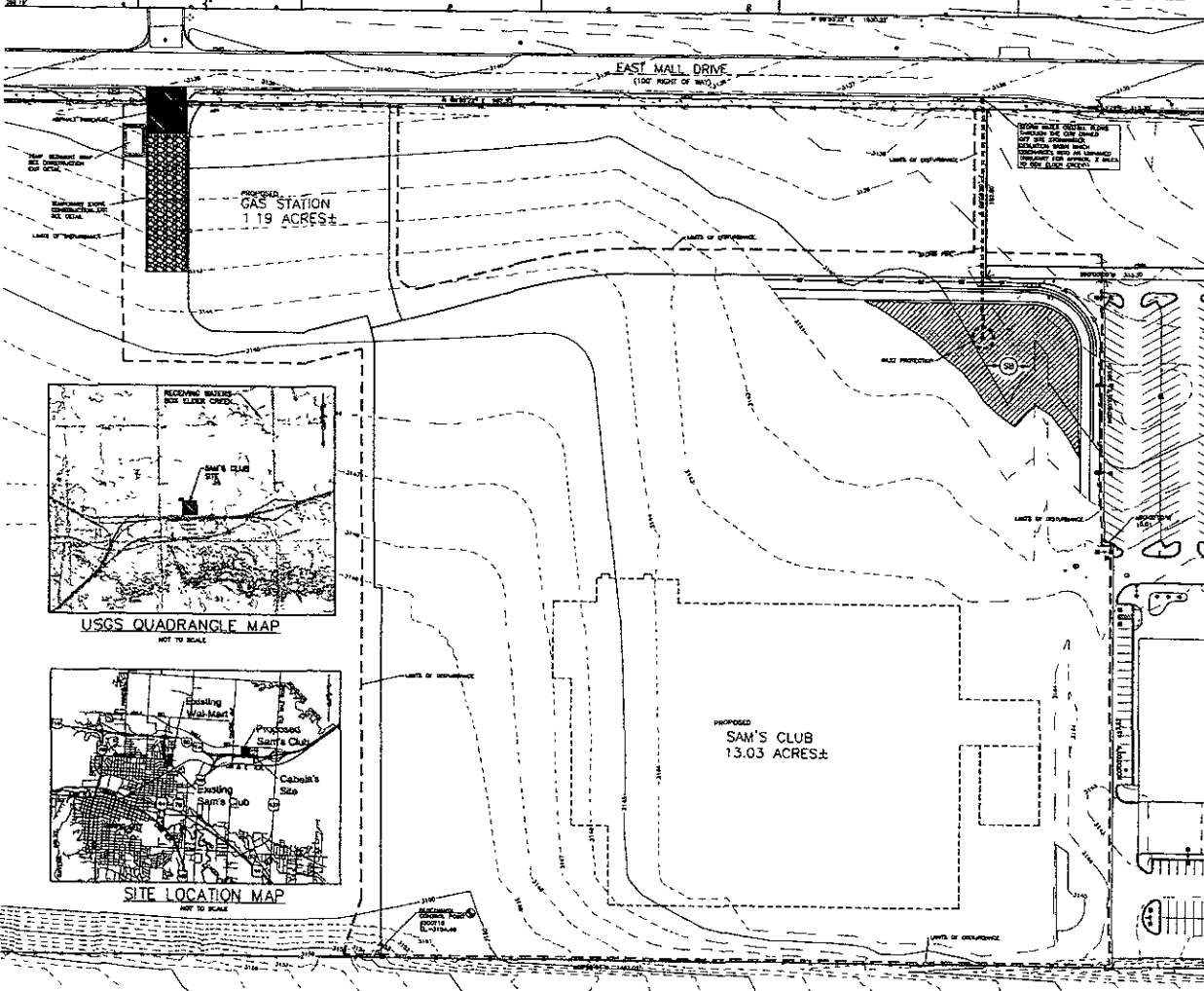

REVISIONS table with columns for No., Description, and Date.



- LEGEND
SITE FEATURES
EROSION DETAILS
EROSION NOTES

- GENERAL EROSION AND SEDIMENT CONTROL NOTES
BMP MAINTENANCE EROSION NOTES

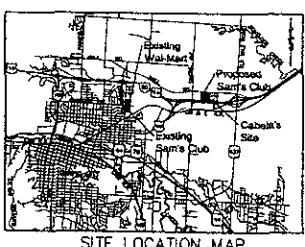
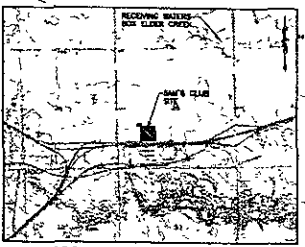

- SEDIMENT CONTROL LEGEND
DEVELOPER/OWNER: SAM'S WEST INC.
SITE OPERATOR/GENERAL CONTRACTOR

AGREEMENT SUMMARY (IN ACRES) table with columns for Site Area, Off-Site Detention Area, Total Detention Area, and Other areas.

SOIL EROSION/SEDIMENTATION CONTROL OPERATION TIME SCHEDULE table with columns for Construction Measure, Start/End Dates, and Responsible Party.

- BEST MANAGEMENT PRACTICES SEQUENCE
1. INITIAL BEST MANAGEMENT PRACTICES...
2. INITIAL BEST MANAGEMENT PRACTICES...
3. INITIAL BEST MANAGEMENT PRACTICES...

PRELIMINARY DRAWING
FOR REVIEW PURPOSES ONLY
NOT TO BE USED FOR CONSTRUCTION
SAM'S CLUB #6565-09
RAPID CITY, PENNINGTON COUNTY, SD
SAM'S WEST, INC. 2001 SE 10TH STREET,
BENTONVILLE, AR 72716

EROSION AND SEDIMENTATION CONTROL PLAN / SITE MAP

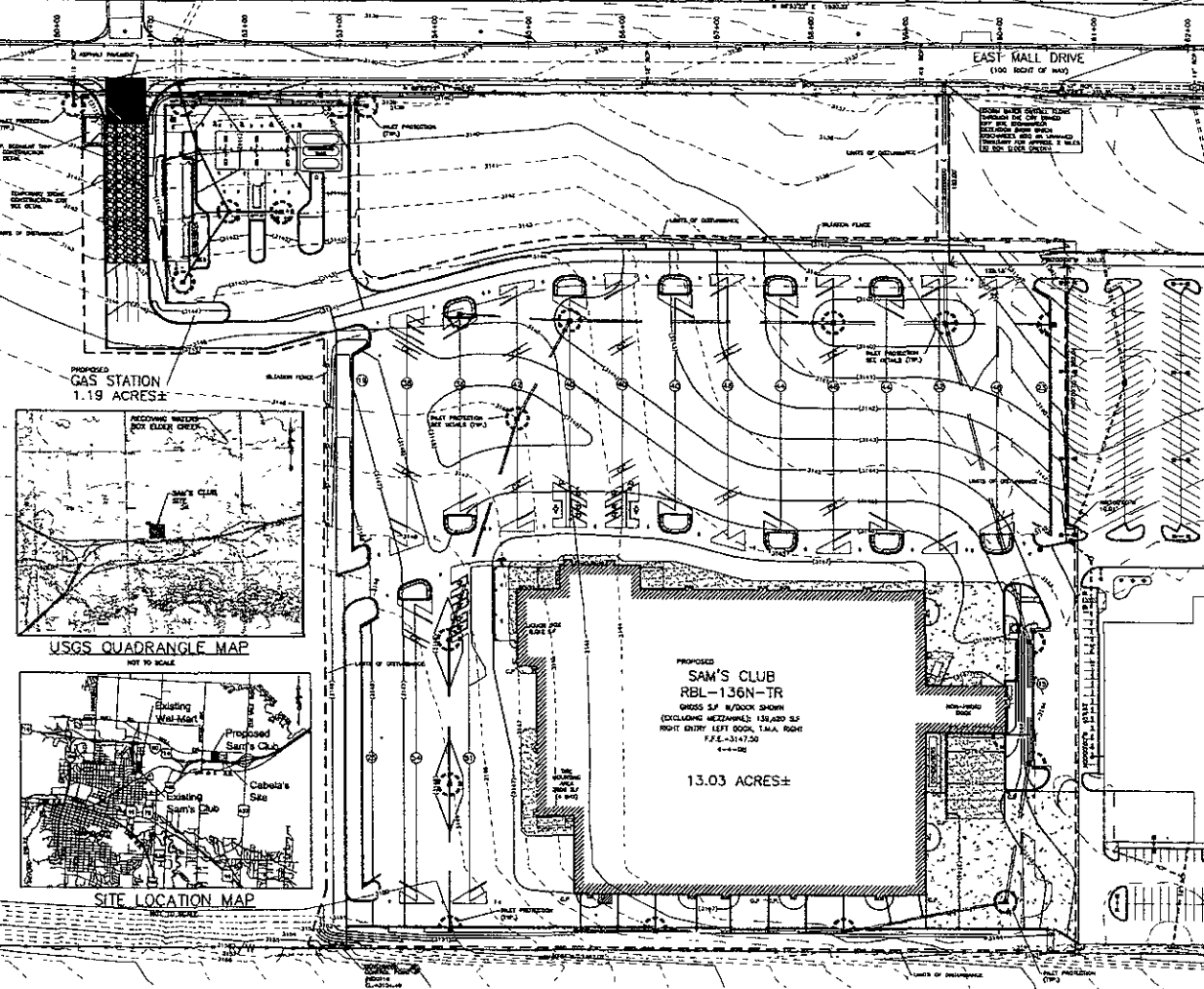
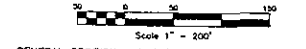

LEGEND
SITE FEATURES
UNPAVED AREA
PAVED AREA
CONCRETE CURB
FURNISHED DRIVEWAY
ROADS, DRIVEWAYS, SIDEWALKS
SLOPE INDICATIONS
PROPOSED CONSTRUCTION
EXISTING CONSTRUCTION
EAST MALL DRIVE
1400' ROAD (W/O)

GENERAL EROSION AND SEDIMENT CONTROL NOTES
1. THE EROSION AND SEDIMENTATION CONTROL PLAN IS DESIGNED TO PREVENT EROSION AND SEDIMENTATION FROM THE DEVELOPMENT AND CONSTRUCTION OF THE PROJECT.

EROSION DETAILS
TEMPORARY EROSION CONTROL MAT
SLOTTED CURB
SILT FENCE
CONCRETE CURB WITH SLOTTED JOINTS
CONCRETE CURB WITH SLOTTED JOINTS AND SLOTTED CURB

- 2. SEDIMENTATION CONTROL MEASURES SHALL BE INSTALLED PRIOR TO THE START OF CONSTRUCTION AND MAINTAINED THROUGHOUT CONSTRUCTION.
3. THE CONSTRUCTION SITE SHALL BE MAINTAINED AS MUCH AS POSSIBLE TO PREVENT EROSION AND SEDIMENTATION.

EROSION NOTES
PERMANENT BARRIERS
PERMANENT BARRIERS

SEEDING AND SOIL STABILIZATION
1. SEEDING AND SOIL STABILIZATION SHALL BE INSTALLED IMMEDIATELY UPON COMPLETION OF CONSTRUCTION.

SEDIMENT CONTROL LEGEND
SEDIMENT BASIN
SEDIMENT BASIN WITH SLOTTED CURB

- 2. THE SEDIMENTATION CONTROL MEASURES SHALL BE MAINTAINED THROUGHOUT CONSTRUCTION AND SHALL BE INSTALLED IMMEDIATELY UPON COMPLETION OF CONSTRUCTION.

DEVELOPER/OWNER
SAM'S WEST, INC
2001 SE 10TH STREET
BOYNTON BEACH, FL 33416
979-273-4000
SITE OPERATOR/GENERAL CONTRACTOR
SUPERINTENDENT

ACREAGE SUMMARY (IN ACRES)
TABLE with columns: SITE CLASS, ACRES, TOTAL ACRES

OFF-SITE RUN-ON ACREAGE SUMMARY
TABLE with columns: OFF-SITE DRAINAGE AREA, ACRES

ACREAGE SUMMARY (IN ACRES)
TABLE with columns: SITE CLASS, ACRES, TOTAL ACRES

OFF-SITE MATERIAL AREA(S) INFORMATION
TABLE with columns: OFF-SITE DRAINAGE AREA, ACRES

SOIL EROSION/SEDIMENTATION CONTROL OPERATION TIME SCHEDULE
TABLE with columns: CONSTRUCTION PHASE, DATE, TIME

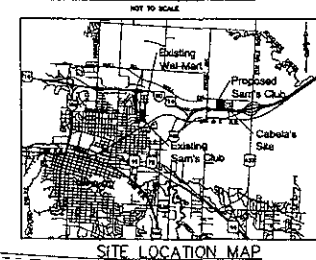
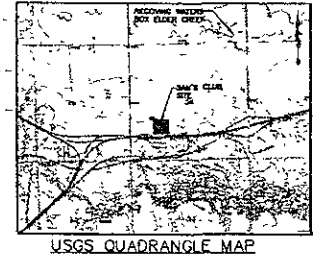

- BEST MANAGEMENT PRACTICES SEQUENCE
1. CONDUCT A PRELIMINARY ASSESSMENT OF THE CONSTRUCTION SITE TO IDENTIFY POTENTIAL EROSION AND SEDIMENTATION PROBLEMS.
2. DEVELOP AND IMPLEMENT EROSION AND SEDIMENTATION CONTROL MEASURES TO MINIMIZE SOIL EROSION AND SEDIMENTATION.

REVISIONS table and BFA logo and address: BFA ENGINEERING & ARCHITECTURE, 4801 W. UNIVERSITY BLVD., SUITE 1000, BOYNTON BEACH, FL 33416. PRELIMINARY DRAWING FOR REVIEW PURPOSES ONLY. NOT TO BE USED FOR CONSTRUCTION. SAM'S CLUB #8465-09, 2001 SE 10TH STREET, BOYNTON BEACH, FL 33416. DRAWN BY: [Name], CHECKED BY: [Name], DATE: [Date], SCALE: AS SHOWN, SHEET NO.: 1 OF 2.