

**LANDSCAPE SUMMARY (ENTIRE LANDSCAPE)**

SITE AREA	421,659 SF
BUILDING AREA	30,022 SF
LANDSCAPE POINTS REQUIRED	341,632 POINTS
<b>LANDSCAPE POINTS PROVIDED</b>	
CONIFEROUS TREES	0 @ 2000 PTS = 0 PTS
DECIDUOUS TREES (MED)	57 @ 1000 PTS = 57,000 PTS
DECIDUOUS TREES (SM)	0 @ 500 PTS = 0 PTS
DECIDUOUS SHRUBS	746 @ 250 PTS = 186,500 PTS
GROUNDCOVERS (SY)	530 @ 100 PTS = 53,000 PTS
TURFGRASS (SY)	6990 @ 10 PTS = 69,904 PTS
<b>TOTAL POINTS PROVIDED</b>	<b>365,404 PTS</b>

**PLANTING SCHEDULE (SITE CONTRACT ONLY)**

CONIFEROUS TREES		KEY COMMON NAME	BOTANICAL NAME	SIZE	NOTES/SPACING
<b>DECIDUOUS TREES</b>					
5	17CA	FALLEGOLD ASH	FRAXINUS NIGRA 'FALLEGOLD'	2" CAL.	B&B/SPECIMEN
31	14A	SUMMIT ASH	FRAXINUS PENNSYLVANICA 'SUMMIT'	2" CAL.	B&B/SPECIMEN
12	15HL	SHADEMASTER HONEY-LOCUST	GLENTZIA TRICANTYOS VARI INERMIS 'SHADEMASTER'	2" CAL.	B&B/SPECIMEN
<b>CONIFEROUS SHRUBS</b>					
52	1ACJ	LANDORA COMPACT JUNIPER	JUNIPERUS HORIZONTALIS 'COMACTA'	#2 CONTAINER	4'-0" O.C.
-	BQJ	BLUE CHIP JUNIPER	JUNIPERUS HORIZONTALIS 'BLUE CHIP'	#2 CONTAINER	4'-0" O.C.
53	B1	BUFFALO JUNIPER	JUNIPERUS SABINA 'BUFFALO'	#2 CONTAINER	4'-0" O.C.
26	1S1	SABIN JUNIPER	JUNIPERUS SABINA	#2 CONTAINER	5'-0" O.C.
<b>DECIDUOUS SHRUBS</b>					
-	1AD	ALLEMAN'S COMPACT DOGWOOD	CORNUS SERICEA 'ALLEMAN'S COMPACT'	#5 CONTAINER	AS SHOWN
37	AMS	ANTHONY WATERER SPIREA	SPIRAEA X BUNALDII 'ANTHONY WATERER'	#2 CONTAINER	3'-6" O.C.
18	18D	BILZARD WICKBOURNE	PHILADELPHIA 'BILZARD'	#2 CONTAINER	3'-6" O.C.
30	EMH	EMERALD MOUND HONEYSUCKLE	LONICERA XYLOSTEM 'EMERALD MOUND'	#2 CONTAINER	4'-0" O.C.
94	GGP	GOLD DROP POTENTILLA	POTENTILLA FRUTICOSA 'GOLD DROP'	#2 CONTAINER	3'-0" O.C.
58	GLS	GR0-LOW FRAGRANT SUMAC	RHUS AROMATICA 'GR0-LOW'	#2 CONTAINER	5'-0" O.C.
16	NWR	NEARBY WILD ROSE	ROSA 'NEARBY WILD'	#2 CONTAINER	3'-0" O.C.
170	PEP	PINK BEAUTY POTENTILLA	POTENTILLA FRUTICOSA 'PKK BEAUTY'	#2 CONTAINER	3'-0" O.C.
-	1SWN	SUMMER WINE NINEBARK	PHYSOCARPUS OPALESCENS 'SEWARD'	#5 CONTAINER	4'-0" O.C.
-	1WSC	WESTERN SAND CHERRY	PRUNUS BESSEYI	#5 CONTAINER	4'-0" O.C.
<b>PERENNIALS/ORNAMENTAL GRASSES</b>					
4	AFC	AVALANCHE FEATHER REED GRASS	CALAMAGROSTIS ACUTIFLORA 'AVALANCHE'	#1 CONTAINER	2'-6" O.C.
5	BQG	BLUE GAT GRASS	HELIOTRICHON SEMPERVIRENS	#1 CONTAINER	2'-6" O.C.
25	LBS	LITTLE BLUESTEM GRASS	SCORPACHRYLUM SCOPARIUM	#1 CONTAINER	2'-0" O.C.

DREAM DESIGN INTERNATIONAL, INC.  
 CIVIL ENGINEERING LANDSCAPE ARCHITECTURE  
 LAND DEVELOPMENT CONTRACT REGISTRATION

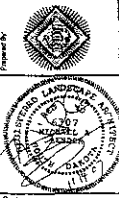

Project No. 08PD00703  
 Drawing No. 07-0451  
 Date: 11/14/07  
 Scale: 1" = 40'

RAPID CENTER PHASE I

RECEIVED

APR 28 2008

Rapid City Growth  
 Management Department

LATE SUBMITTAL

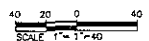

Overall Landscape Plan  
 L1 of L5

EXISTING POD #3

08PD016

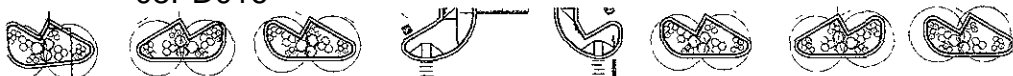

LANDSCAPE SUMMARY (ENTIRE LANDSCAPE)

SITE AREA 431,539 SF  
 10,000 S.F. PER TREE  
 LANDSCAPE POINTS REQUIRED 311,832 POINTS  
 LANDSCAPE POINTS PROVIDED

CONIFEROUS TREES (6" DB)	0 @ 2000 PTS	0 PTS
DECIDUOUS TREES (6" DB)	51 @ 1000 PTS	51,000 PTS
DECIDUOUS TREES (8" DB)	9 @ 500 PTS	4,500 PTS
DECIDUOUS TREES (10" DB)	0 @ 1000 PTS	0 PTS
DECIDUOUS TREES (12" DB)	745 @ 250 PTS	186,250 PTS
CONIFEROUS SHRUBS (6")	8,300 @ 100 PTS	830,000 PTS
TURFCOVER (5")	4860 @ 10 PTS	48,600 PTS
TOTAL POINTS PROVIDED		1,069,750 PTS

PLANTING SCHEDULE (BUILDING CONTRACT ONLY)

CONIFEROUS TREES	COMMON NAME	BOTANICAL NAME	SIZE	INTROQUANTITY
1	FRANCIS SPAHR PINE	FRAXINUS SPICATA	2" CAL.	180/2000PTS
2	FRANCIS SPAHR PINE	FRAXINUS SPICATA	2" CAL.	180/2000PTS
3	FRANCIS SPAHR PINE	FRAXINUS SPICATA	2" CAL.	180/2000PTS
4	FRANCIS SPAHR PINE	FRAXINUS SPICATA	2" CAL.	180/2000PTS
5	FRANCIS SPAHR PINE	FRAXINUS SPICATA	2" CAL.	180/2000PTS
6	FRANCIS SPAHR PINE	FRAXINUS SPICATA	2" CAL.	180/2000PTS
7	FRANCIS SPAHR PINE	FRAXINUS SPICATA	2" CAL.	180/2000PTS
8	FRANCIS SPAHR PINE	FRAXINUS SPICATA	2" CAL.	180/2000PTS
9	FRANCIS SPAHR PINE	FRAXINUS SPICATA	2" CAL.	180/2000PTS
10	FRANCIS SPAHR PINE	FRAXINUS SPICATA	2" CAL.	180/2000PTS

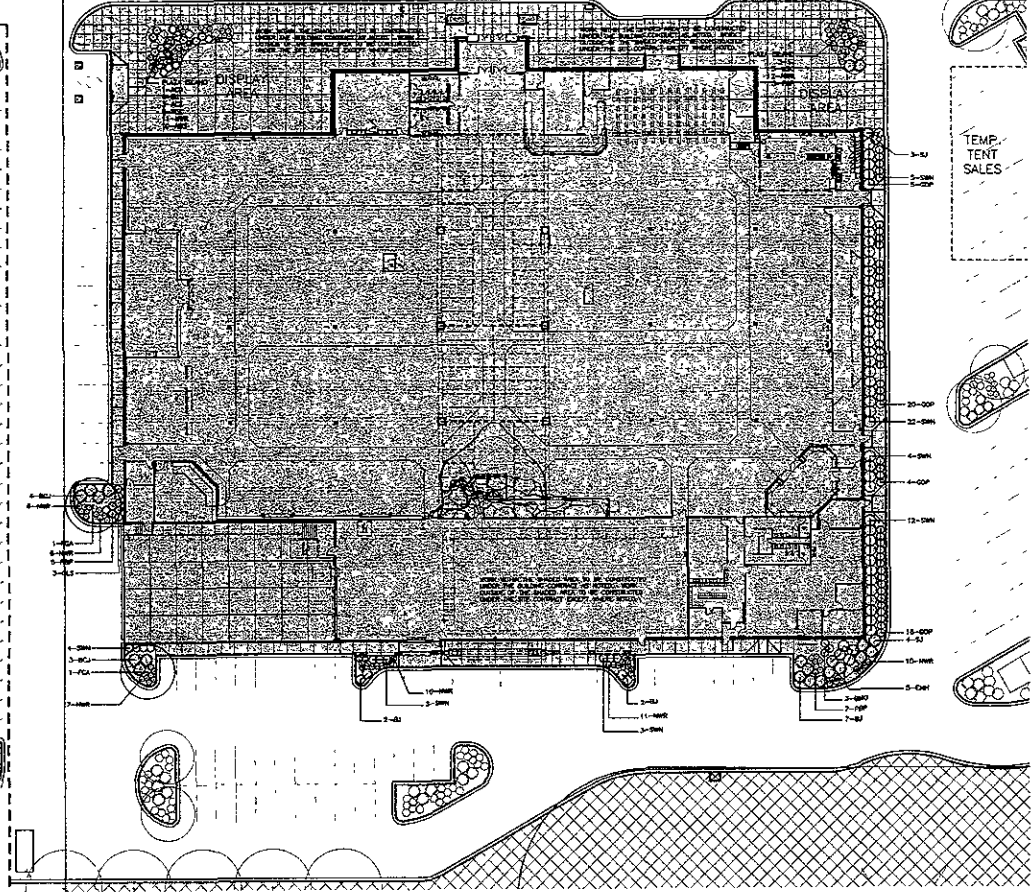

PLANTING NOTES

- 1. THE CONTRACTOR SHALL COORDINATE PLANTING INSTALLATION WITH OTHER CONTRACTORS PERFORMING WORK ON SITE.
- 2. THE CONTRACTOR SHALL VERIFY ALL SPECIAL INSTRUCTIONS/DRAWING NOTICES AND COORDINATE WITH THE PLANTING SPECIALIST, AND REPORT IN WRITING ANY DISCREPANCIES TO LANDSCAPE ARCHITECT BY PROJECT COMMENCEMENT.
- 3. NO WORK OR OTHER OBSTRUCTION WILL BE ACCEPTABLE UNLESS WRITTEN APPROVAL BY THE LANDSCAPE ARCHITECT OR PROJECT ARCHITECT.
- 4. ALL PLANTED SPECIES SHALL BE SAVED OR SET ASAP BY THE CONTRACTOR FOR THE PROTECTION OF LANDSCAPE ARCHITECT'S DESIGN.
- 5. ALL TREES AND SHRUBS SHALL BE PLANTED IN ACCORDANCE TO PLANTING GUIDE #1 IN THE MANUAL & ALL SPACING INTERVALS FROM BOUNDARY TO BOUNDARY SHALL BE MAINTAINED AND SHALL BE MAINTAINED UNTIL THE SPECIALIST HAS BEEN ADVISED. EXCESSIVE SOIL, RUBBER, STAMPING, AND OTHER MATERIALS SHALL BE REMOVED AS THE WORK SHALL BE PROCEEDED BY PLANTING.
- 6. THE CONTRACTOR SHALL SUBMIT ALL PLANTING APPROVALS AND PLANTING SCHEDULES TO THE ARCHITECT FOR APPROVAL. ALL PLANTING SHALL BE COMPLETED BY THE DATE OF FINAL ACCEPTANCE OF THE PROJECT.
- 7. ALL PLANTING MATERIAL SHALL BE FROM THE FOLLOWING SOURCES: THE MANUFACTURER FOR ALL CONIFEROUS TREES AND SHRUBS; OR (2) FROM ALL OTHERS AND SUBSTITUTES SHALL BE ONE (1) YEAR OLD. ALL TREES SHALL BE ONE (1) YEAR OLD. ALL SHRUBS SHALL BE ONE (1) YEAR OLD. ALL PLANTING MATERIAL SHALL BE FROM THE DATE OF FINAL ACCEPTANCE OF THE PROJECT.
- 8. ALL TREES SHALL BE FROM THE FOLLOWING SOURCES: THE MANUFACTURER FOR ALL CONIFEROUS TREES AND SHRUBS; OR (2) FROM ALL OTHERS AND SUBSTITUTES SHALL BE ONE (1) YEAR OLD. ALL TREES SHALL BE ONE (1) YEAR OLD. ALL SHRUBS SHALL BE ONE (1) YEAR OLD. ALL PLANTING MATERIAL SHALL BE FROM THE DATE OF FINAL ACCEPTANCE OF THE PROJECT.
- 9. ALL TREES SHALL BE SAVED WITH AN ANTI-DESICCATION TREATMENT OR POLYETHYLENE PLASTIC AND PROTECTED FROM DRYING BEFORE PLANTING.
- 10. ALL PLANTING MATERIAL SHALL BE FROM THE FOLLOWING SOURCES: THE MANUFACTURER FOR ALL CONIFEROUS TREES AND SHRUBS; OR (2) FROM ALL OTHERS AND SUBSTITUTES SHALL BE ONE (1) YEAR OLD. ALL TREES SHALL BE ONE (1) YEAR OLD. ALL SHRUBS SHALL BE ONE (1) YEAR OLD. ALL PLANTING MATERIAL SHALL BE FROM THE DATE OF FINAL ACCEPTANCE OF THE PROJECT.
- 11. ALL PLANTING MATERIAL SHALL BE FROM THE FOLLOWING SOURCES: THE MANUFACTURER FOR ALL CONIFEROUS TREES AND SHRUBS; OR (2) FROM ALL OTHERS AND SUBSTITUTES SHALL BE ONE (1) YEAR OLD. ALL TREES SHALL BE ONE (1) YEAR OLD. ALL SHRUBS SHALL BE ONE (1) YEAR OLD. ALL PLANTING MATERIAL SHALL BE FROM THE DATE OF FINAL ACCEPTANCE OF THE PROJECT.
- 12. ALL PLANTING MATERIAL SHALL BE FROM THE FOLLOWING SOURCES: THE MANUFACTURER FOR ALL CONIFEROUS TREES AND SHRUBS; OR (2) FROM ALL OTHERS AND SUBSTITUTES SHALL BE ONE (1) YEAR OLD. ALL TREES SHALL BE ONE (1) YEAR OLD. ALL SHRUBS SHALL BE ONE (1) YEAR OLD. ALL PLANTING MATERIAL SHALL BE FROM THE DATE OF FINAL ACCEPTANCE OF THE PROJECT.
- 13. ALL PLANTING MATERIAL SHALL BE FROM THE FOLLOWING SOURCES: THE MANUFACTURER FOR ALL CONIFEROUS TREES AND SHRUBS; OR (2) FROM ALL OTHERS AND SUBSTITUTES SHALL BE ONE (1) YEAR OLD. ALL TREES SHALL BE ONE (1) YEAR OLD. ALL SHRUBS SHALL BE ONE (1) YEAR OLD. ALL PLANTING MATERIAL SHALL BE FROM THE DATE OF FINAL ACCEPTANCE OF THE PROJECT.
- 14. ALL PLANTING MATERIAL SHALL BE FROM THE FOLLOWING SOURCES: THE MANUFACTURER FOR ALL CONIFEROUS TREES AND SHRUBS; OR (2) FROM ALL OTHERS AND SUBSTITUTES SHALL BE ONE (1) YEAR OLD. ALL TREES SHALL BE ONE (1) YEAR OLD. ALL SHRUBS SHALL BE ONE (1) YEAR OLD. ALL PLANTING MATERIAL SHALL BE FROM THE DATE OF FINAL ACCEPTANCE OF THE PROJECT.
- 15. ALL TREES SHALL BE SAVED WITH AN ANTI-DESICCATION TREATMENT OR POLYETHYLENE PLASTIC AND PROTECTED FROM DRYING BEFORE PLANTING.
- 16. ALL PLANTING MATERIAL SHALL BE FROM THE FOLLOWING SOURCES: THE MANUFACTURER FOR ALL CONIFEROUS TREES AND SHRUBS; OR (2) FROM ALL OTHERS AND SUBSTITUTES SHALL BE ONE (1) YEAR OLD. ALL TREES SHALL BE ONE (1) YEAR OLD. ALL SHRUBS SHALL BE ONE (1) YEAR OLD. ALL PLANTING MATERIAL SHALL BE FROM THE DATE OF FINAL ACCEPTANCE OF THE PROJECT.
- 17. ALL PLANTING MATERIAL SHALL BE FROM THE FOLLOWING SOURCES: THE MANUFACTURER FOR ALL CONIFEROUS TREES AND SHRUBS; OR (2) FROM ALL OTHERS AND SUBSTITUTES SHALL BE ONE (1) YEAR OLD. ALL TREES SHALL BE ONE (1) YEAR OLD. ALL SHRUBS SHALL BE ONE (1) YEAR OLD. ALL PLANTING MATERIAL SHALL BE FROM THE DATE OF FINAL ACCEPTANCE OF THE PROJECT.
- 18. ALL PLANTING MATERIAL SHALL BE FROM THE FOLLOWING SOURCES: THE MANUFACTURER FOR ALL CONIFEROUS TREES AND SHRUBS; OR (2) FROM ALL OTHERS AND SUBSTITUTES SHALL BE ONE (1) YEAR OLD. ALL TREES SHALL BE ONE (1) YEAR OLD. ALL SHRUBS SHALL BE ONE (1) YEAR OLD. ALL PLANTING MATERIAL SHALL BE FROM THE DATE OF FINAL ACCEPTANCE OF THE PROJECT.

**CR**  
 CRABTREE, ROXBOROUGH & ASSOCIATES  
 ARCHITECTS  
 410 W. BENTLEY, SUITE 200, SIOUX FALLS, SD 57105  
 TEL: 605-339-1111 FAX: 605-339-1112  
 www.crabtree.com

DREAM DESIGN INTERNATIONAL INC.  
 10101 S. UNIVERSITY AVE. SUITE 100  
 LITTLETON, CO 80120

**Cabela's**  
 CABELA'S RETAIL, INCORPORATED  
 RAPID CITY, SOUTH DAKOTA

KEY PLAN

CONSTRUCTION DOCUMENTS

LANDSCAPE PLANTING PLAN

Submissions

No.	Date	Description
1	10/20/08	PROVISIONAL SCHEDULE
2	10/20/08	PROVISIONAL SCHEDULE
3	10/20/08	CONSTRUCTION DOCUMENTS
4		
5		
6		
7		
8		
9		
10		
11		
12		

Revisions

No.	Date	Description
1		
2		
3		
4		
5		
6		
7		
8		
9		
10		

PROJECT No. 07-0278 Sheet  
 L1.0  
 Date: 10/20/08

LATE SUBMITTAL

EXISTING PCP #2

RECEIVED  
 APR 29 2008  
 Rapid City Growth  
 Management

LATE SUBMITTA

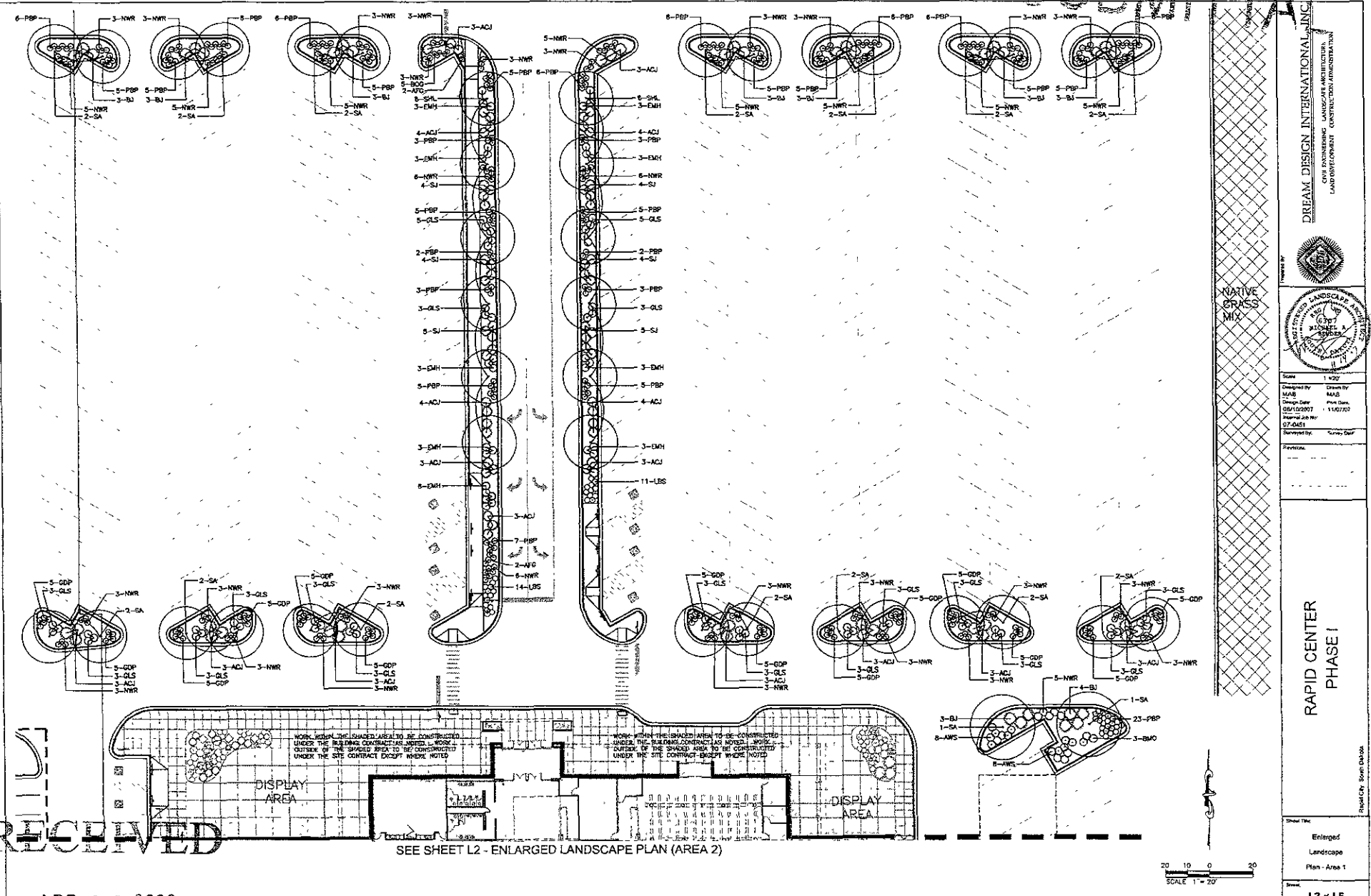

DREAM DESIGN INTERNATIONAL, INC.  
 1001 W. BROADWAY, SUITE 300, DENVER, CO 80202  
 LAND DEVELOPMENT - CONSTRUCTION ADMINISTRATION

SCALE 1" = 20'  
 Designed By: MAB Drawn By: MAB  
 Design Date: 05/12/2007 Plot Date: 11/07/07  
 Printed Job No: 07-0451 Surveyed By: Survey Date:  
 Revision:

RAPID CENTER PHASE I  
 Plan - Area 1  
 L2 of L5

Prepared By: Steven Dabala

RECEIVED

APR 29 2008

SEE SHEET L2 - ENLARGED LANDSCAPE PLAN (AREA 2)

EXISTING PCD #4

08PD016

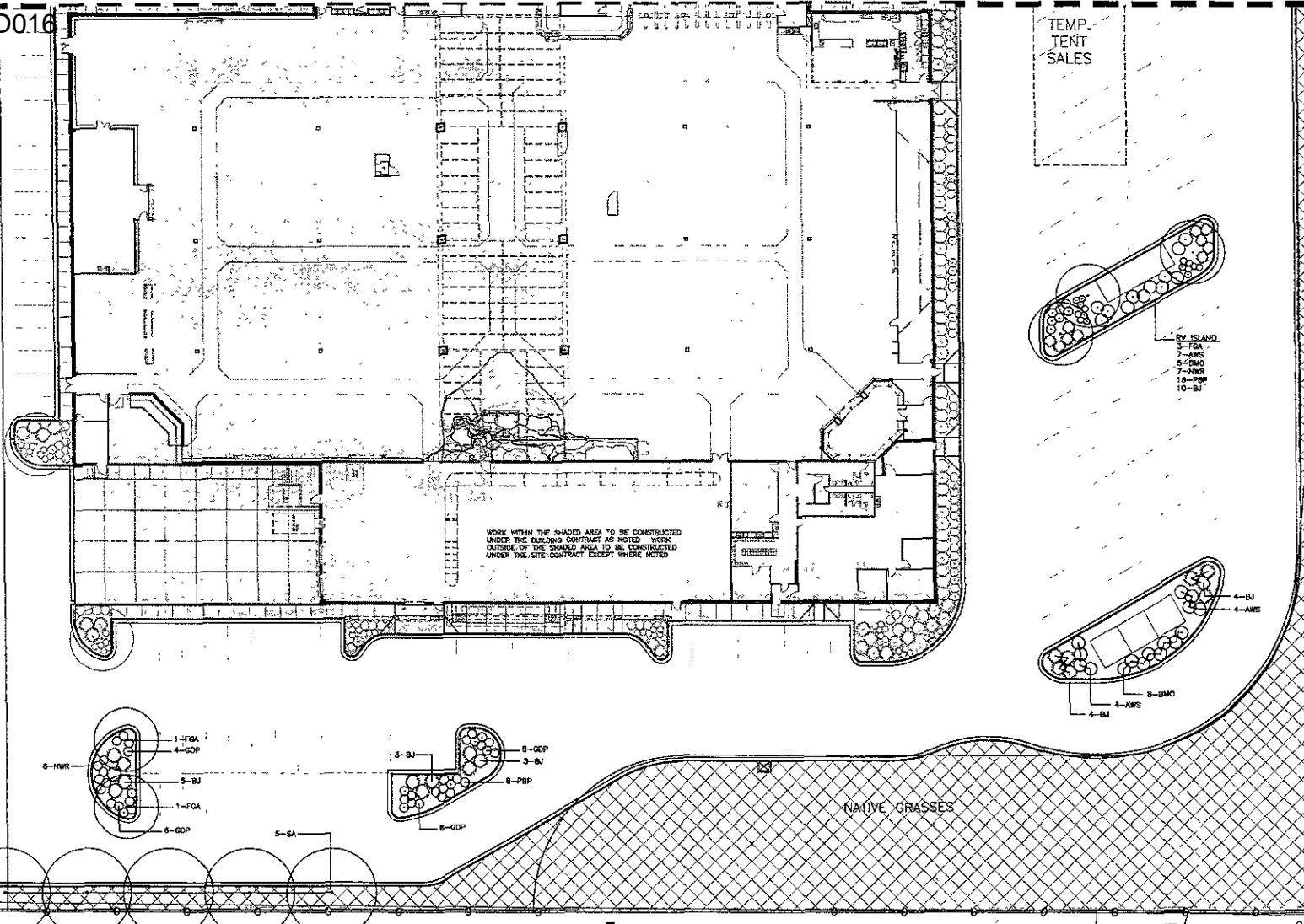

DREAM DESIGN INTERNATIONAL, INC.  
 CIVIL ENGINEERING LANDSCAPE ARCHITECTURE  
 LAND DEVELOPMENT CONSTRUCTION ADMINISTRATION



Designed By: MAB  
 Checked By: MAB  
 Drawn By: MAB  
 Date: 08/10/2008  
 Internal Job No: 07-0451  
 Approved By: Surveyor

RAPID CENTER  
 PHASE I

Sheet Title:  
 Enlarged  
 Landscape  
 Plan - Area 2

Drawn:  
 L3 of L5



EXISTING PCD #5

RECEIVED

APR 23 2008

LATE  
 SUBMITTAL

Rapid City Growth  
 Management Department