

MASTER UTILITY PLAN 07PL147

LOTS 2, 3 AND 4 OF LJS SUBDIVISION

(FORMERLY A PORTION OF THE UNPLATTED BALANCE OF THE NW1/4 OF SECTION 30, T2N, R8E, BHM)
LOCATED IN THE NW1/4 OF SECTION 30, T2N, R8E, BHM,
RAPID CITY, PENNINGTON COUNTY, SOUTH DAKOTA

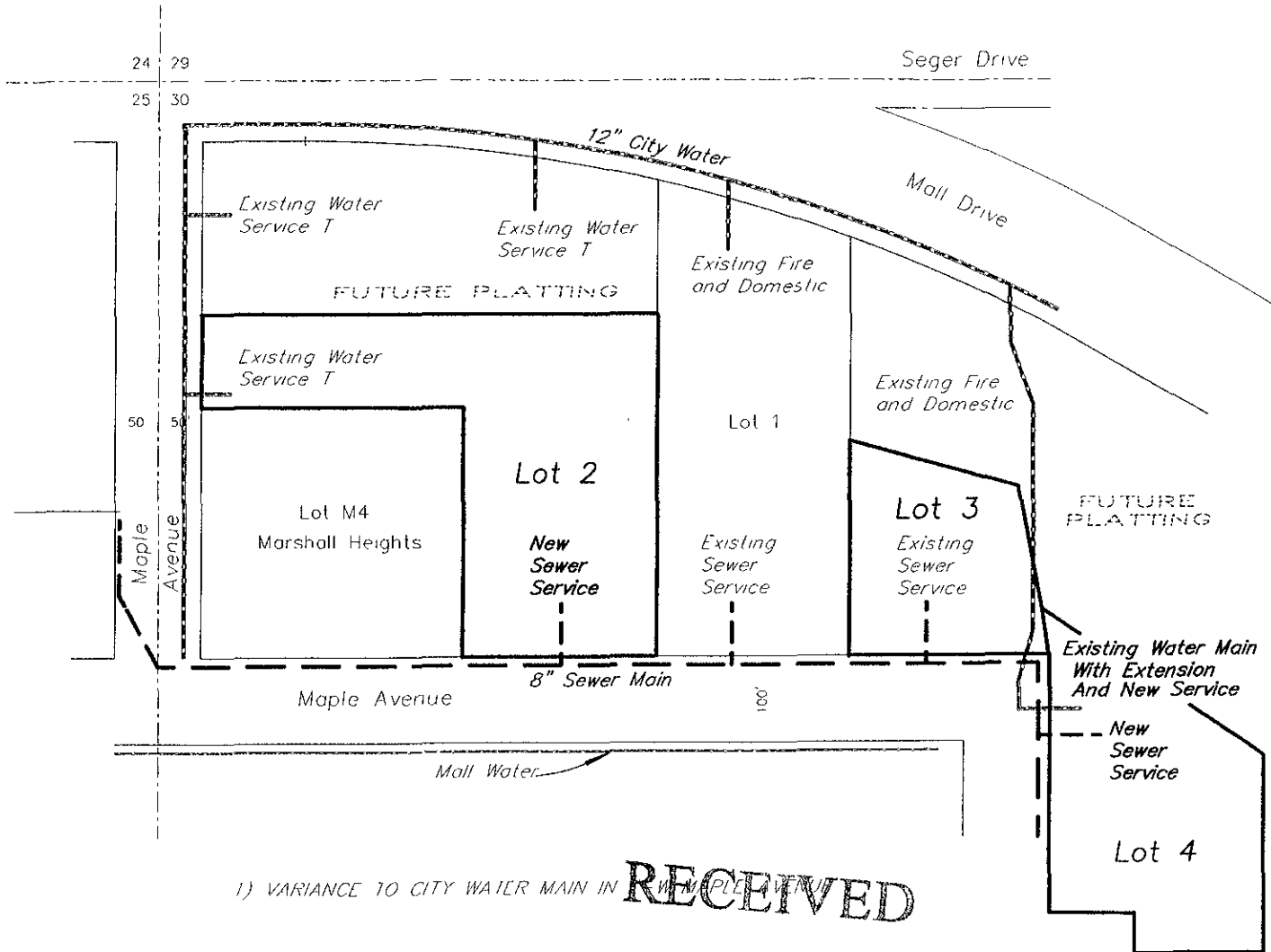
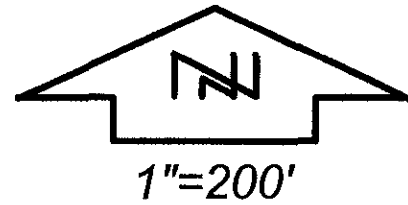

1) VARIANCE TO CITY WATER MAIN IN MAPLE AVENUE

RECEIVED
OCT 26 2007
Rapid City Growth
Management Department