

07SR043

LOT 10

LOT 11

BALANCE OF TRACT A
OF OUTLOT 'B'

LOT 1 OF HORIZONS SUBDIVISION

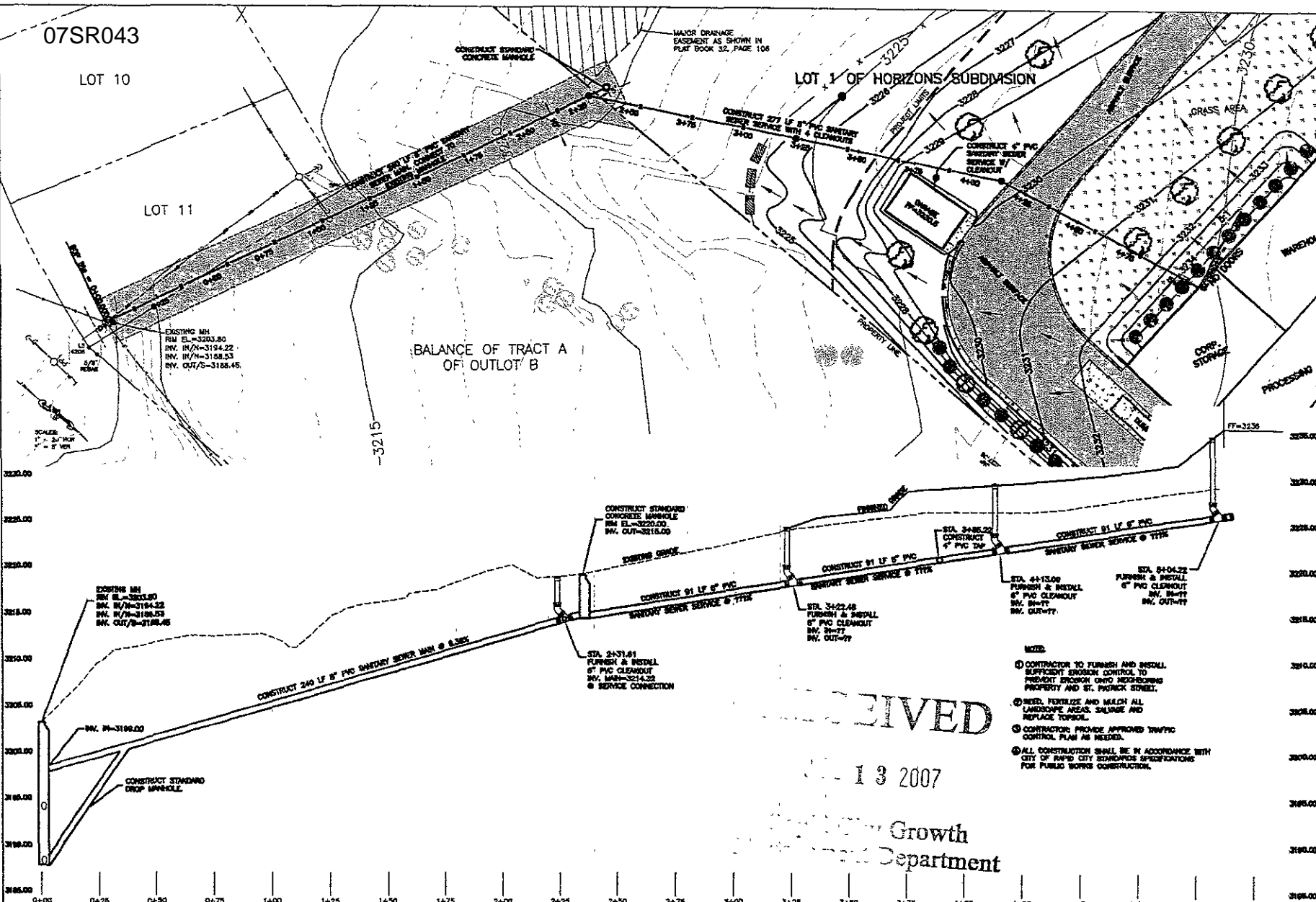

RECEIVED

APR 13 2007

Rapid City Growth
Department

- NOTES:
- CONTRACTOR TO FURNISH AND INSTALL APPROPRIATE EROSION CONTROL TO PREVENT SEDIMENT ONTO NEIGHBORING PROPERTY AND ST. PROXER STREET.
 - SEED, FERTILIZE AND MOW ALL LANDSCAPE AREAS SALVAGE AND REPLACE TOPSOIL.
 - CONTRACTOR PROVIDE APPROVED TRAFFIC CONTROL PLAN AS NEEDED.
 - ALL CONSTRUCTION SHALL BE IN ACCORDANCE WITH CITY OF RAPID CITY STANDARD SPECIFICATIONS FOR PUBLIC WORKS CONSTRUCTION.

Remter Associates, LLC.
111 South St. • Rapid City, SD 57701 • 605/771-7339
FAX: 605/771-7313 • E-MAIL: REMTER@REMTERASSOCIATES.COM
Professional Engineer
Registration Number: 005771-0018

Scale: 1" = 20' HORIZ
1" = 4' VERT

Project: 07SR043 TA 3007

Drawn By: JCP
Design Date: 7/10/07
Checked By: JCP
Issue Date: 7/10/07

Salvation Army
Family Enrichment Center
LOT 1 OF HORIZONS SUBDIVISION
LOCATED IN THE NE1/4 OF THE NW1/4,
SECTION 7, T1N, R8E, B1M,
RAPID CITY, PENNINGTON COUNTY, SOUTH DAKOTA

Project For:
CUSTAFSON BUILDERS
PO BOX 1375
RAPID CITY, SD 57708
ATTN: PLETC REHMAN

Project No.:
#2145.08

Sheet Title:
PROPOSED SANITARY
SEWER PLAN & PROFILE
0+00 - 5+11.24