

SITE PLAN FURNITURE ROW

CITY OF RAPID CITY
COUNTY OF PENNINGTON
STATE OF SOUTH DAKOTA

SHEET 2 OF 8

LOT 4
B
L
O
C
K
LOT 3

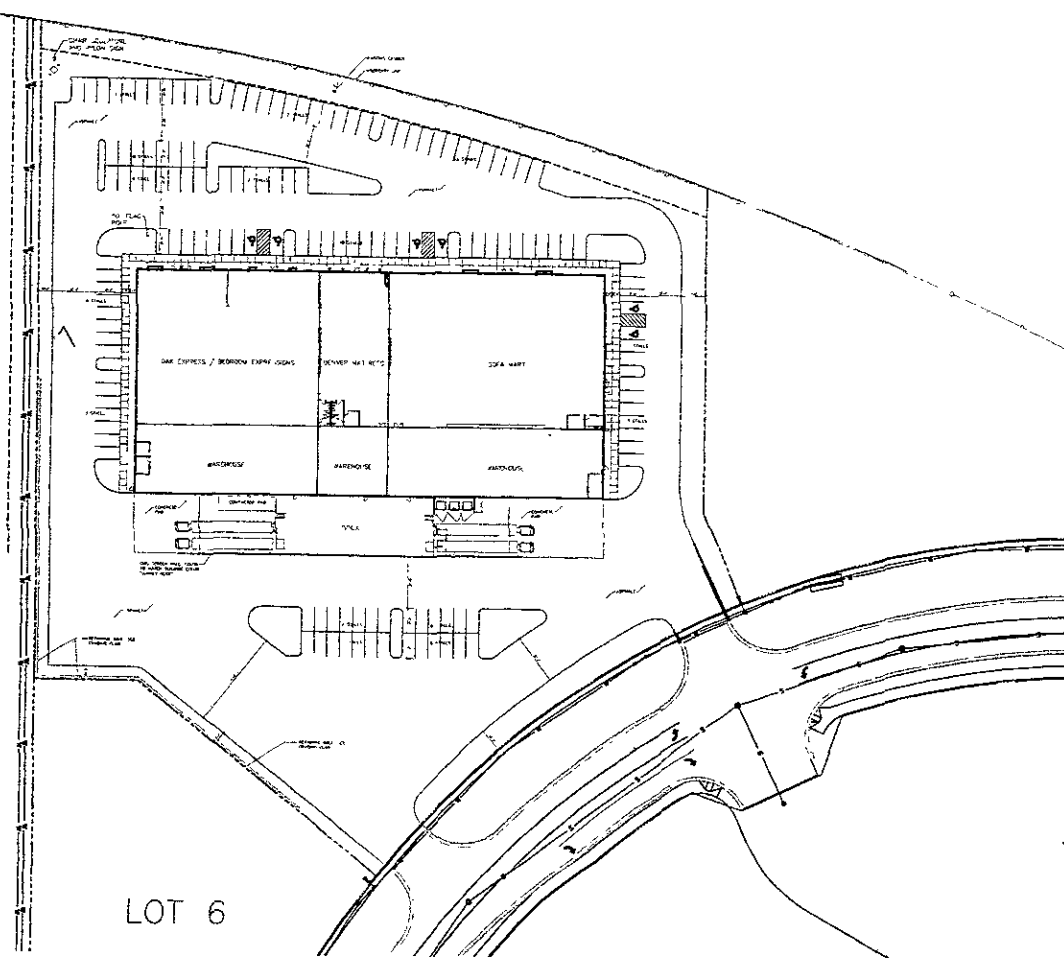

PARKING CALCS	
DATA WARE SPRINGS	18,802 SF
DRIVEWAY SURFACES (SP. AREA)	5,148 SF
REG. EXP. & D. EXP. (PLANK)	14,471 SF
TOTAL REGAL SQUARE FEET	38,421 SF
TOTAL STORAGE ST. #	15,078 #
TOTAL STORAGE ST. (NET)	52,732 SF
SPACES REQ'D FOR RETAIL = 35,454 / 1000 SF x 1.5	53
SPACES REQ'D FOR STORAGE = 7,4275 / 1000 SF x 1.5	5
TOTAL SPACES = (PROVIDED)	160
TOTAL SPACES = (PROVIDED)	146

SITE AREA CALCS.	
TOTAL SITE AREA = 2,9307	2,046 AC
LANDSCAPE AREA = 36,000 SF	0.816 AC
LANDSCAPE S. = 30,932 / 213.00'	14.505
MINIMUM DRIVEWAY / SIDEWALK AREA = 1.5 X 30' X 11'	2,643 AC
MINIMUM DRIVEWAY / SIDEWALK S. = 4' X 2072' X 9.807'	92.46
LOADING DOCK / ACCESS = 40' X 14'	314 AC
LOADING DOCK / ACCESS = 14' X 107' X 9.807'	6.48
TRUCKING AREA = 33,375 X 100(0.05)	1,231 AC
SPILLWAY S. = 50,452 X 9.807'	24.45
FLOOR AREA (RAC. (RAC)) = 33,015 / 21,000'	24
SUBMITTED ACRES AND SF = 3,246 AC (SF) = 139,207 SF	1,000'

GENERAL NOTES
 1. SEE LANDSCAPE PLAN A-3 FOR ADDITIONAL INFORMATION
 2. SEE SHEET A-1 FOR TOPOGRAPHIC AND EASEMENT INFORMATION

RECEIVED
 MAY 1 1 2007
 Rapid City Growth
 Management Department

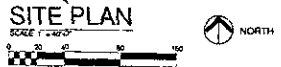

FURNITURE ROW

924 EGLIN STREET
 RAPID CITY, SD 57701

SERVICE DESIGN

A New Design Group Company
 1600 Invention Street, Suite 100
 Denver, Colorado 80202
 Phone 720.804.0943 Fax 720.932.7561

NO REVISION / SUBMISSIONS DATE
 1 PLANNED DEVELOPMENT REVIEW 5-11-07

PROJECT NUMBER DATE
 207-003.00 5-11-07
 DRAWING TITLE

SITE PLAN - ARCHITECTURAL

DRAWING NUMBER

A-2