

07PD002

January 11, 2007

Mr. Travis Tegethoff  
Planner II  
City of Rapid City Growth Management Department  
300 6<sup>th</sup> Street  
Rapid City, SD 57701

RE: Rapid City Regional Hospital – Major Amendment Submittal

Dear Mr. Tegethoff:

Please find attached our Major Amendment submittal for the Rapid City Regional Hospital. This submittal includes three projects. The first project is a renovation to the 9<sup>th</sup> floor of the hospital. Rooms are being modified and the change will consist of a reduction of beds from 48 to 32. The second project included is a new central utility plant. The proposed plant will replace the current plant on site and will include 3,544 square feet of office space. The third project is a new 2,400 square foot grounds (storage) building.

Parking tabulations have been included on the attached drawings. As the tabulations indicate, the hospital has provided 286 spaces over the required amount for the campus. Landscape tabulations have also been included and show that the new projects will increase our overall landscape points by 4400.

We hope to have this plan approved soon as we plan to begin construction in the near future. Please let us know if you have questions or require additional information.

Sincerely yours,

HDR Architecture, Inc.



Trey Heaton  
Site Development Section Manager

Enclosure

cc: Steve Sedlacek, Donovan Wattier

RECEIVED

JAN 11 2007

M:



# Rapid City Regional Hospital Grounds Building/Central Utility Plant

## City of Rapid City Major Amendment Review Set

DATE: 01-12-2007

### INDEX OF DRAWINGS

#### GENERAL

DWG#	DWG NAME
G-100	COVER SHEET
MA-100	MAJOR AMENDMENT SITE PLAN

#### GROUNDS BUILDING EARLY SITE PACKAGE

DWG #	DWG NAME
GEC-100	SITE ORIENTATION PLAN
GEC-101	SITE CONSTRUCTION PLANS

#### GROUNDS BUILDING CONSTRUCTION DOCUMENTS

DWG #	DWG NAME
GC-100	SITE ORIENTATION PLAN
GC-101	SITE CONSTRUCTION PLANS
GL-101	SITE LANDSCAPE PLAN

#### CENTRAL UTILITY PLANT

DWG #	DWG NAME
C-000	SITE ORIENTATION PLAN
C-101	EXISTING CONDITIONS PLAN - AREA A
C-102	EXISTING CONDITIONS PLAN - AREA B AND C
C-201	SITE PREPARATION PLAN - AREA A
C-202	SITE PREPARATION PLAN - AREA B AND C
C-301	SITE LAYOUT PLAN - AREA A
C-302	SITE LAYOUT PLAN - AREA B AND C
C-401	SITE PAVEMENTS PLAN - AREA A
C-402	SITE PAVEMENTS PLAN - AREA B AND C
C-403	PRE/POST DEVELOPMENT DRAINAGE AREAS
C-501	SITE GRADING PLAN - AREA A
C-502	SITE GRADING PLAN - AREA B AND C
C-601	SITE UTILITIES PLAN - AREA A
C-602	SITE UTILITIES PLAN - AREA B AND C
C-701	SITE DETAILS
C-702	SITE DETAILS
L-101	SITE LANDSCAPE PLAN - AREA A
L-102	SITE LANDSCAPE PLAN - AREA B

THE DRAWING IS FOR REVIEW  
PURPOSES ONLY AND IS NOT  
TO BE USED FOR BIDDING,  
PLANNING, OR CONSTRUCTION,  
OR FOR RECORDS.  
SOUTH DAKOTA REG. NO. 2387  
DATE: 01/12/07

RECEIVED

JAN 17 2007

2007



HDR Architecture, Inc.  
500 West  
1711 Prairie Street  
Rapid City, South Dakota  
57501-5000



SKYLINE ENGINEERING LLC  
115 12th Street  
Rapid City, SD 57501  
Tel: 605.737.3600  
Fax: 605.737.3500

Albertson Engineering Inc.











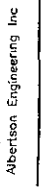
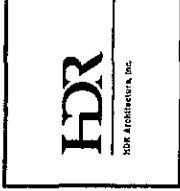

**RAPID CITY REGIONAL HOSPITAL**  
RAPID CITY, SOUTH DAKOTA

**CENTRAL UTILITY PLANT**

NO.	DATE	BY	DESCRIPTION
1	10-18-07	SG	ISSUED FOR PERMIT
2	11-16-07	SG	REVISIONS
3	12-11-07	SG	REVISIONS
4	01-10-08	SG	REVISIONS
5	02-14-08	SG	REVISIONS
6	03-11-08	SG	REVISIONS
7	04-08-08	SG	REVISIONS
8	05-06-08	SG	REVISIONS
9	06-03-08	SG	REVISIONS
10	07-01-08	SG	REVISIONS
11	07-29-08	SG	REVISIONS
12	08-26-08	SG	REVISIONS
13	09-23-08	SG	REVISIONS
14	10-20-08	SG	REVISIONS
15	11-17-08	SG	REVISIONS
16	12-14-08	SG	REVISIONS
17	01-11-09	SG	REVISIONS
18	02-08-09	SG	REVISIONS
19	03-05-09	SG	REVISIONS
20	04-02-09	SG	REVISIONS
21	05-01-09	SG	REVISIONS
22	05-29-09	SG	REVISIONS
23	06-26-09	SG	REVISIONS
24	07-23-09	SG	REVISIONS
25	08-20-09	SG	REVISIONS
26	09-17-09	SG	REVISIONS
27	10-14-09	SG	REVISIONS
28	11-11-09	SG	REVISIONS
29	12-08-09	SG	REVISIONS
30	01-05-10	SG	REVISIONS
31	02-02-10	SG	REVISIONS
32	03-01-10	SG	REVISIONS
33	03-29-10	SG	REVISIONS
34	04-26-10	SG	REVISIONS
35	05-23-10	SG	REVISIONS
36	06-20-10	SG	REVISIONS
37	07-17-10	SG	REVISIONS
38	08-14-10	SG	REVISIONS
39	09-11-10	SG	REVISIONS
40	10-09-10	SG	REVISIONS
41	11-06-10	SG	REVISIONS
42	12-04-10	SG	REVISIONS
43	01-01-11	SG	REVISIONS
44	01-29-11	SG	REVISIONS
45	02-26-11	SG	REVISIONS
46	03-23-11	SG	REVISIONS
47	04-20-11	SG	REVISIONS
48	05-17-11	SG	REVISIONS
49	06-14-11	SG	REVISIONS
50	07-11-11	SG	REVISIONS
51	08-08-11	SG	REVISIONS
52	09-05-11	SG	REVISIONS
53	10-02-11	SG	REVISIONS
54	10-30-11	SG	REVISIONS
55	11-27-11	SG	REVISIONS
56	12-24-11	SG	REVISIONS
57	01-21-12	SG	REVISIONS
58	02-18-12	SG	REVISIONS
59	03-15-12	SG	REVISIONS
60	04-12-12	SG	REVISIONS
61	05-09-12	SG	REVISIONS
62	06-06-12	SG	REVISIONS
63	07-03-12	SG	REVISIONS
64	07-31-12	SG	REVISIONS
65	08-28-12	SG	REVISIONS
66	09-25-12	SG	REVISIONS
67	10-22-12	SG	REVISIONS
68	11-19-12	SG	REVISIONS
69	12-16-12	SG	REVISIONS
70	01-13-13	SG	REVISIONS
71	02-10-13	SG	REVISIONS
72	03-09-13	SG	REVISIONS
73	04-06-13	SG	REVISIONS
74	05-03-13	SG	REVISIONS
75	05-31-13	SG	REVISIONS
76	06-28-13	SG	REVISIONS
77	07-25-13	SG	REVISIONS
78	08-22-13	SG	REVISIONS
79	09-19-13	SG	REVISIONS
80	10-16-13	SG	REVISIONS
81	11-13-13	SG	REVISIONS
82	12-10-13	SG	REVISIONS
83	01-07-14	SG	REVISIONS
84	02-04-14	SG	REVISIONS
85	03-03-14	SG	REVISIONS
86	03-31-14	SG	REVISIONS
87	04-28-14	SG	REVISIONS
88	05-25-14	SG	REVISIONS
89	06-22-14	SG	REVISIONS
90	07-19-14	SG	REVISIONS
91	08-16-14	SG	REVISIONS
92	09-13-14	SG	REVISIONS
93	10-10-14	SG	REVISIONS
94	11-07-14	SG	REVISIONS
95	12-04-14	SG	REVISIONS
96	01-01-15	SG	REVISIONS
97	01-29-15	SG	REVISIONS
98	02-26-15	SG	REVISIONS
99	03-23-15	SG	REVISIONS
100	04-20-15	SG	REVISIONS

THIS PLAN IS THE PROPERTY OF SKYLINE CONSULTING, INC. AND IS NOT TO BE REPRODUCED OR TRANSMITTED IN ANY FORM OR BY ANY MEANS, ELECTRONIC OR MECHANICAL, INCLUDING PHOTOCOPYING, RECORDING, OR BY ANY INFORMATION STORAGE AND RETRIEVAL SYSTEM, WITHOUT THE WRITTEN PERMISSION OF SKYLINE CONSULTING, INC.

**SITE ORIENTATION PLAN**

SCALE: 1" = 50'  
**C-000**

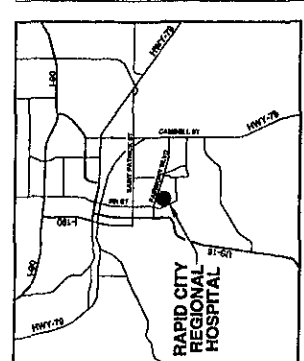
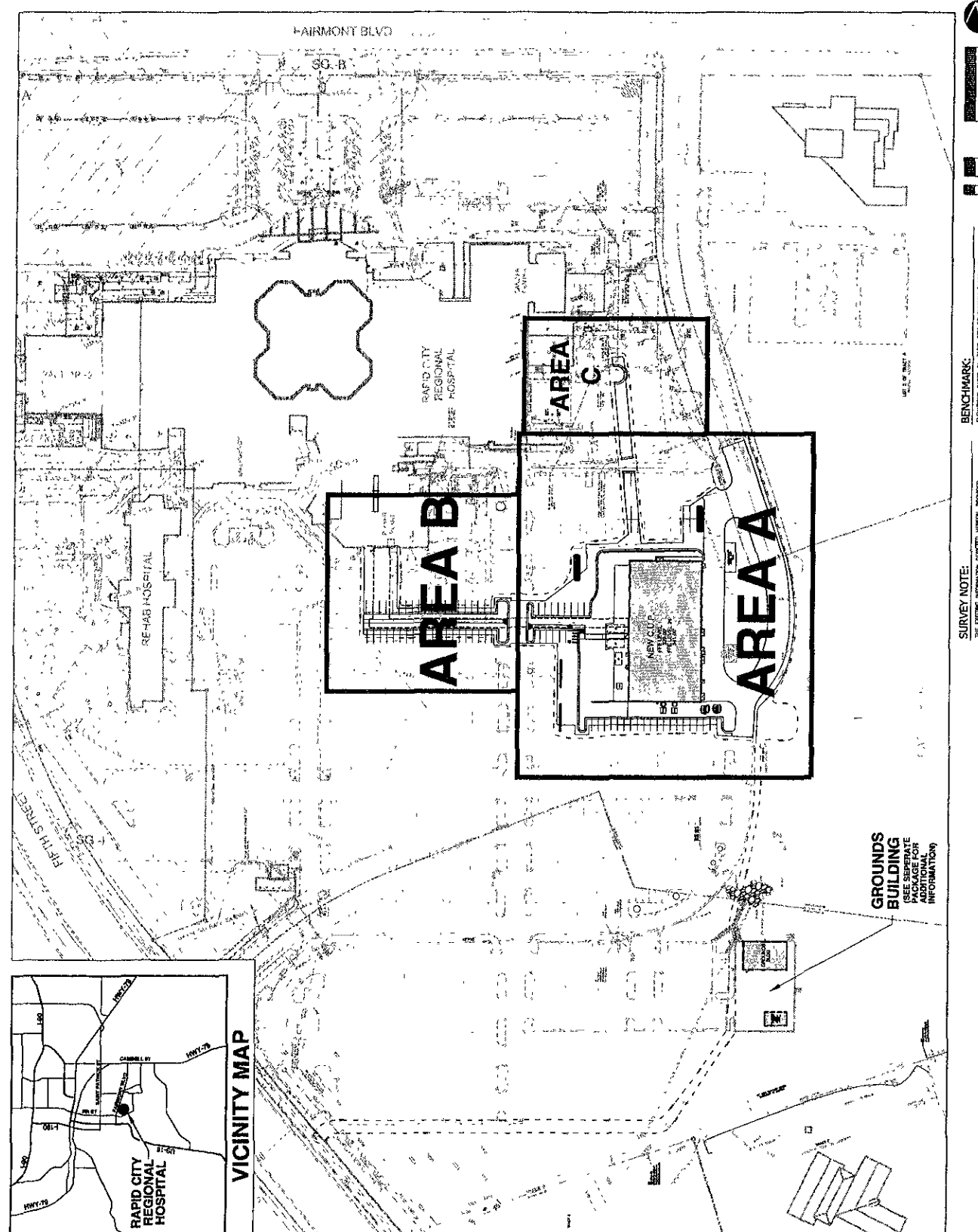

**GROUNDS BUILDING**  
(SEE SEPARATE DRAWING FOR ADDITIONAL INFORMATION)

**BENCHMARK:**  
ELEVATION BASED ON RAPID CITY BENCHMARK (FLOOR 201) AT INTERSECTION OF FAIRMONT BLVD AND 5TH STREET. MARKED CENTER OF 6th STREET AND 5th STREET.

**SURVEY NOTE:**  
THIS SURVEY WAS CONDUCTED IN ACCORDANCE WITH THE SURVEYING ACT OF 1947 AND THE SURVEYING REGULATIONS OF THE SOUTH DAKOTA BOARD OF SURVEYING AND MAPPING. THE SURVEY WAS CONDUCTED BY SKYLINE CONSULTING, INC. AND THE RESULTS ARE HEREBY CERTIFIED TO BE TRUE AND CORRECT TO THE BEST OF OUR KNOWLEDGE AND BELIEF. THIS SURVEY WAS CONDUCTED IN ACCORDANCE WITH THE SURVEYING ACT OF 1947 AND THE SURVEYING REGULATIONS OF THE SOUTH DAKOTA BOARD OF SURVEYING AND MAPPING.









**RAPID CITY REGIONAL HOSPITAL**  
RAPID CITY, SOUTH DAKOTA

### CENTRAL UTILITY PLANT

NO.	DATE	BY	DESCRIPTION
1	10-28-21	WJ	ISSUE FOR PERMITS
2	11-11-21	WJ	ISSUE FOR CONSTRUCTION
3	10-14-22	WJ	ISSUE FOR CONSTRUCTION
REVISIONS		BY	DESCRIPTION

THE DESIGN IS FOR THE  
EXISTING ONLY. THE USE OF  
EXISTING UTILITY INFORMATION  
IS SUBJECT TO VERIFICATION.  
BY THE CLIENT'S REPRESENTATIVE  
DATE: 07/15/23

### EXISTING CONDITIONS PLAN - AREA B & C

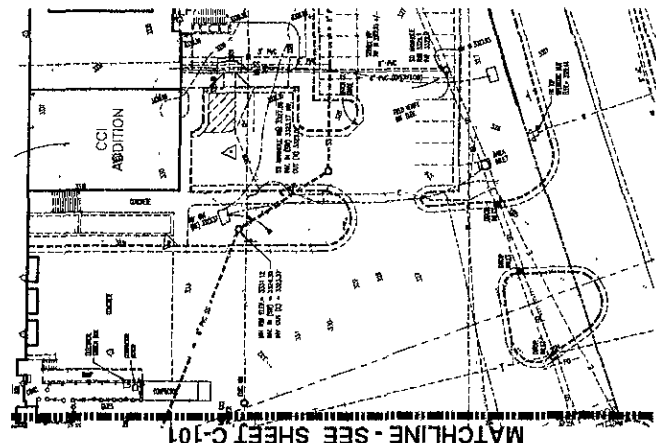

### AREA C

MATCHLINE - SEE SHEET C-101

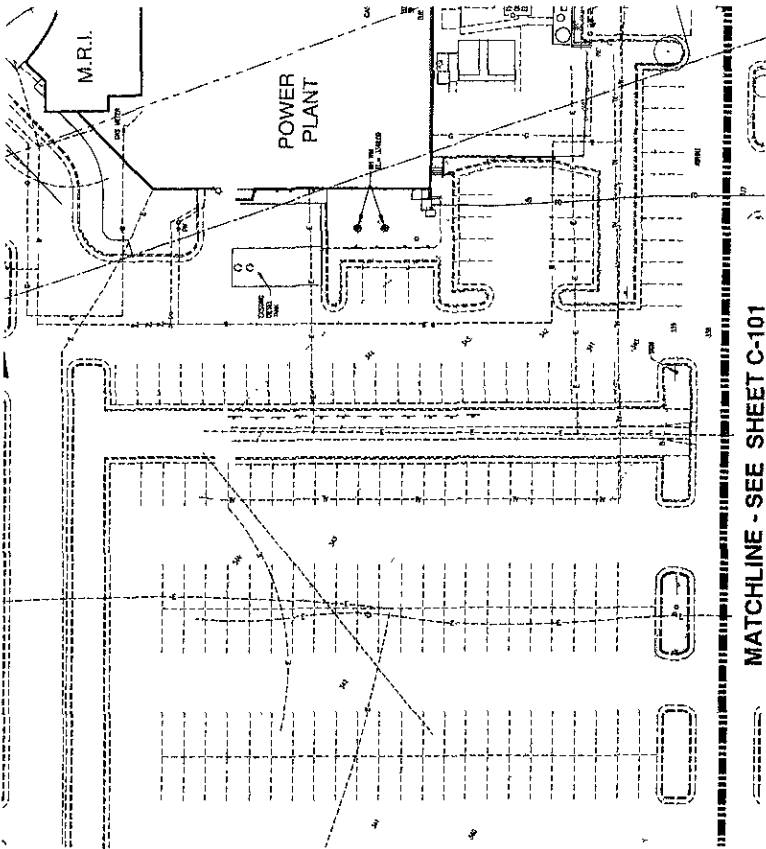

### AREA B

MATCHLINE - SEE SHEET C-101

#### LEGEND

- SOLID LINE: UTILITY LINE
- DASHED LINE: EXISTING CURB AND/OR CONC. CURB
- DOTTED LINE: EXISTING SIDEWALK
- DOTTED LINE: EXISTING DRIVE
- DOTTED LINE: EXISTING SIDEWALK
- DOTTED LINE: EXISTING GAS LINE
- DOTTED LINE: EXISTING SANITARY LINE
- DOTTED LINE: EXISTING WATER MAIN
- DOTTED LINE: EXISTING ELECTRICAL MAIN
- DOTTED LINE: EXISTING TELEPHONE LINE
- DOTTED LINE: EXISTING CABLE TV LINE
- DOTTED LINE: EXISTING FIBER OPTIC LINE
- DOTTED LINE: EXISTING DRAIN/SEWER
- DOTTED LINE: EXISTING FURF
- DOTTED LINE: EXISTING FIRE MAIN
- DOTTED LINE: EXISTING LIGHT POLE
- DOTTED LINE: EXISTING FENCE
- DOTTED LINE: EXISTING TREE

#### SURVEY NOTE:

THE INFORMATION ON THIS PLAN WAS OBTAINED BY MEANS OF A SURVEY MADE BY HDR ARCHITECTURE, INC. THE SURVEY WAS MADE TO VERIFY THE ACCURACY OF ALL EXISTING INFORMATION SHOWN HEREON PRIOR TO COMMENCEMENT OF CONSTRUCTION.

#### BENCHMARK:

A BENCHMARK OF THE CORNER OF 5TH STREET AND 5TH STREET IS LOCATED AT THE INTERSECTION OF 5TH STREET AND 5TH STREET.









NO.	DESCRIPTION
1	PROJECT MANAGER: PAUL HOFFMANN
2	PROJECT ARCHITECT: SKYLINE ENGINEERS & ARCHITECTS, P.C.
3	PROJECT ENGINEER: ALBERTSON ENGINEERING, INC.
4	DATE: 09/20/05
5	SCALE: AS SHOWN
6	DRAWN BY: J.P. BUCHHEIT
7	CHECKED BY: J.P. BUCHHEIT
8	APPROVED BY: J.P. BUCHHEIT
9	DATE: 09/20/05

REVISIONS TO BE MADE TO THIS PLAN AS SHOWN ON SHEET C-301  
DATE: 09/20/05

**SITE**  
LAYOUT  
PLAN -  
AREA A

**LEGEND:**

PROPERTY LINE	(---)
SEWERING LINE	(- - - -)
CONCRETE DRIVE AND GUTTER	(- - - -)
SEWERING TRENCH TO TRAIN	(- - - -)
EXISTING DRAINAGE	(- - - -)
SEWERING TRENCH TO TRAIN	(- - - -)
EXISTING STORM DRAIN USE	(- - - -)
EXISTING SANITARY SEWER LINE	(- - - -)
EXISTING COLLECTION LINE	(- - - -)
EXISTING WATER LINE	(- - - -)
EXISTING GAS LINE	(- - - -)
EXISTING FIBER OPTIC LINE	(- - - -)
EXISTING TELEPHONE LINE	(- - - -)
EXISTING CABLE TELEVISION	(- - - -)
EXISTING FIRE HYDRANT	(- - - -)
EXISTING WATER VALVE	(- - - -)
EXISTING LIGHT FIXTURE	(- - - -)
EXISTING POWER POLE	(- - - -)
EXISTING POWER POLE	(- - - -)
EXISTING TREE	(- - - -)
NEW CONCRETE DRIVE AND GUTTER	(- - - -)
NEW CURB	(- - - -)
NEW SIDEWALK	(- - - -)
NEW SIGN	(- - - -)
NEW SIGN	(- - - -)
NEW SIGN	(- - - -)
NEW SIGN	(- - - -)
NEW SIGN	(- - - -)

**NOTES:**

- CONFORM TO ALL CITY, COUNTY AND STATE REQUIREMENTS.
- ALL DIMENSIONS ARE TO FACE OF CURB UNLESS NOTED OTHERWISE.
- SEE ARCHITECTURAL PLANS FOR BUILDING DIMENSIONS.

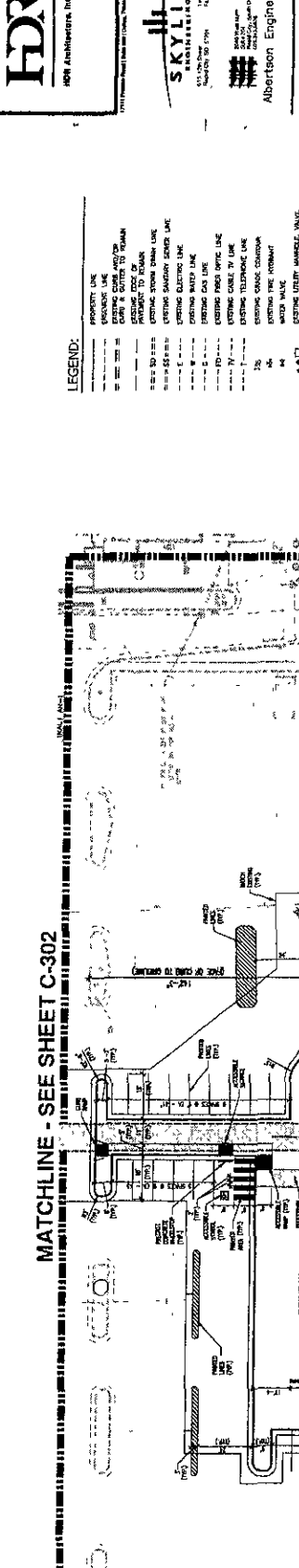

MATCHLINE - SEE SHEET C-302

MATCHLINE - SEE SHEET C-302

THIRD STREET  
WINDSCREEN  
WINDSCREEN  
WINDSCREEN

**NEW C.J.P.**  
FFE LEVEL 1  
329.00'  
FFE LEVEL 2  
341.00'



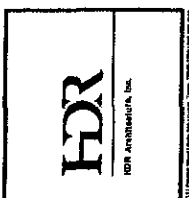

**CENTRAL  
UTILITY PLANT**

NO.	DATE	DESCRIPTION
1	11-16-11	ISSUE FOR PERMITS
2	11-16-11	ISSUE FOR PERMITS
3	11-16-11	ISSUE FOR PERMITS
4	11-16-11	ISSUE FOR PERMITS
5	11-16-11	ISSUE FOR PERMITS
6	11-16-11	ISSUE FOR PERMITS
7	11-16-11	ISSUE FOR PERMITS
8	11-16-11	ISSUE FOR PERMITS
9	11-16-11	ISSUE FOR PERMITS
10	11-16-11	ISSUE FOR PERMITS
11	11-16-11	ISSUE FOR PERMITS
12	11-16-11	ISSUE FOR PERMITS
13	11-16-11	ISSUE FOR PERMITS
14	11-16-11	ISSUE FOR PERMITS
15	11-16-11	ISSUE FOR PERMITS
16	11-16-11	ISSUE FOR PERMITS
17	11-16-11	ISSUE FOR PERMITS
18	11-16-11	ISSUE FOR PERMITS
19	11-16-11	ISSUE FOR PERMITS
20	11-16-11	ISSUE FOR PERMITS

PROJECT: RAPID CITY REGIONAL HOSPITAL  
 SHEET: C-301  
 DATE: 11/16/11

**SITE  
LAYOUT  
PLAN -  
AREA B & C**

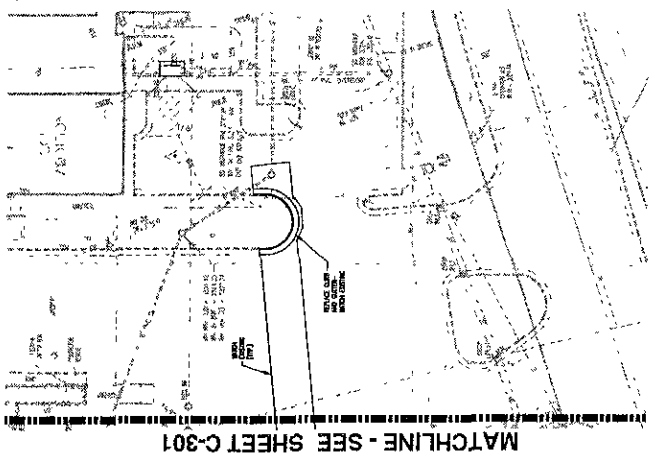

MATCHLINE - SEE SHEET C-301

**AREA C**

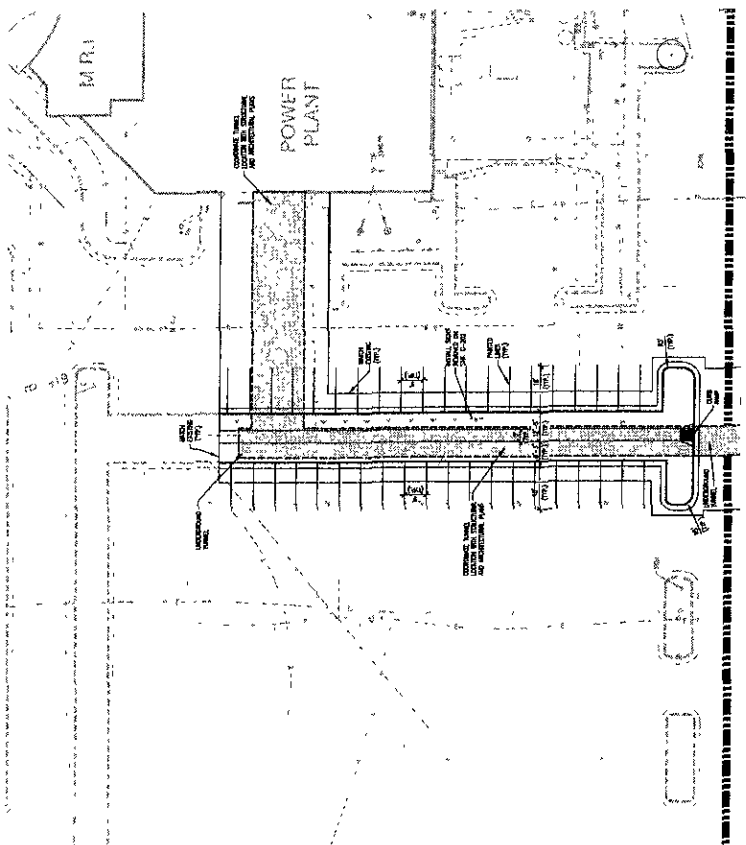

MATCHLINE - SEE C.U.P. SHEET C-301

**AREA B**

- NOTES:**
1. CONTRACTOR TO COORDINATE AND INSTALL FIRE LINE
  2. ALL DIMENSIONS ARE TO FACE OF CURB UNLESS NOTED OTHERWISE.
  3. SEE ARCHITECTURAL PLANS FOR BUILDING DIMENSIONS

**LEGEND:**

---	PROPERTY LINE
---	EXISTING UTILITY
---	EXISTING WATER LINE
---	EXISTING SANITARY SEWER LINE
---	EXISTING GAS LINE
---	EXISTING FIBER OPTIC LINE
---	EXISTING TELEPHONE LINE
---	EXISTING CABLE TV LINE
---	EXISTING POWER LINE
---	EXISTING LIGHT POLE
---	EXISTING STREET LIGHT POLE
---	EXISTING TREE
---	NEW CONCRETE CURB AND GUTTER
---	NEW ASPHALT DRIVEWAY
---	NEW EDGE OF PAVING
---	ACCESSIBLE STAIRS
---	WHEELSTOP
---	ACCESSIBLE SIGN

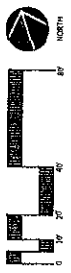

MATCHLINE - SEE SHEET C-402

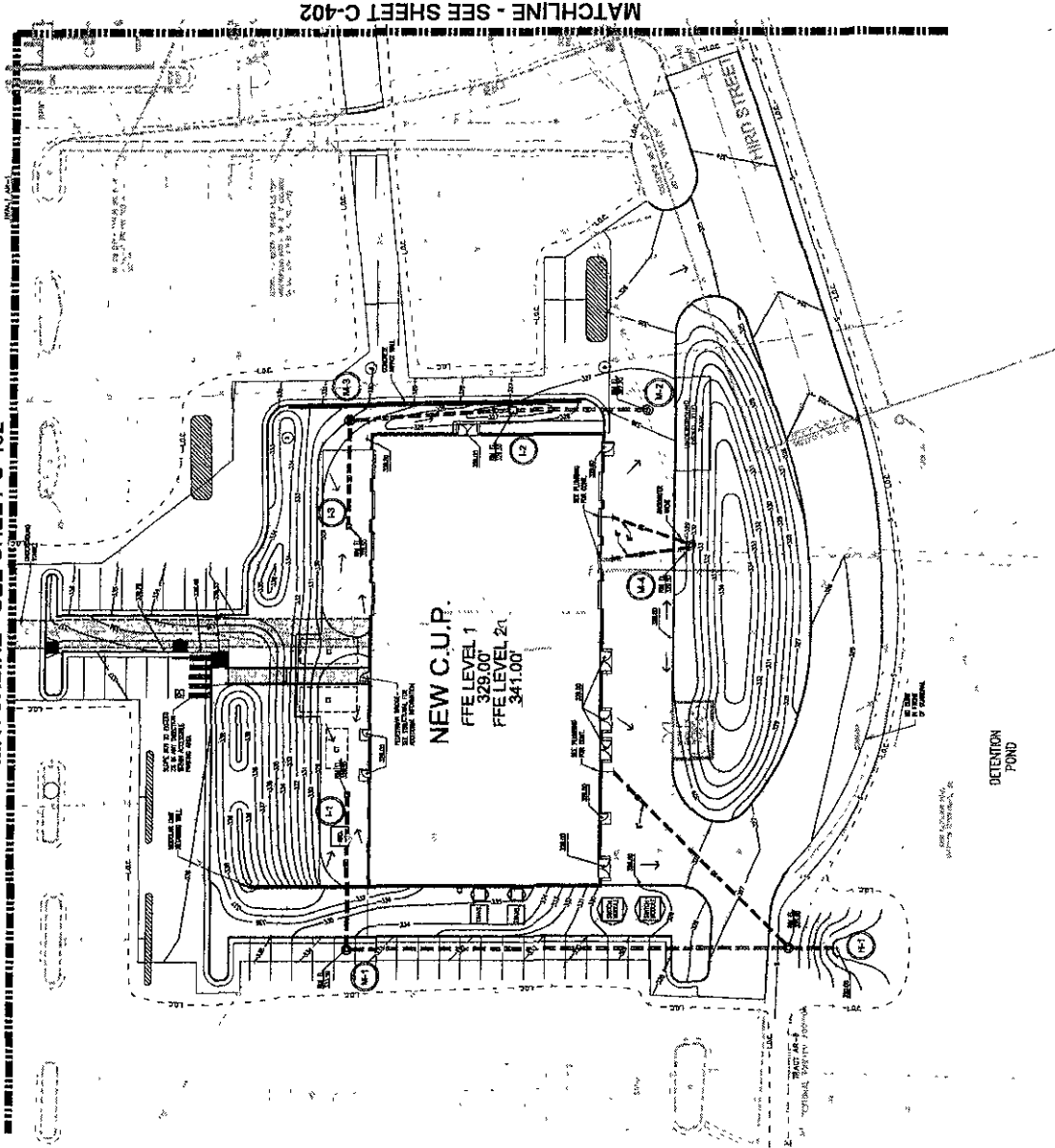

MATCHLINE - SEE SHEET C-402

**NEW C.U.R.**  
 FFE LEVEL 1  
 329.00'  
 FFE LEVEL 2  
 341.00'

DETENTION POND

**LEGEND:**

- PROPERTY LINE
- EXISTING CURB AND/OR DRIVE
- EXISTING SIDEWALK
- EXISTING UTILITY LINE
- EXISTING STORM DRAIN LINE
- EXISTING SANITARY SEWER LINE
- EXISTING WATER MAIN LINE
- EXISTING GAS LINE
- EXISTING FIBER OPTIC LINE
- EXISTING CABLE TV LINE
- EXISTING TELEPHONE LINE
- EXISTING SMOKE CHIMNEY
- EXISTING FIRE HYDRANT
- EXISTING SIGN
- EXISTING LIGHT POLE
- EXISTING POWER POLE
- EXISTING TREE
- PROPOSED DRIVE CENTERLINE
- PROPOSED SPOT ELEVATION
- PROPOSED ACCESSIBLE SYMBOL
- PROPOSED ACCESSIBLE SIGN
- PROPOSED CONCRETE CURB AND GUTTER
- PROPOSED CONCRETE DRIVE AND DRIVEWAY
- PROPOSED SIDE OF PAVING
- PROPOSED SYMBOL
- PROPOSED SIGN
- PROPOSED STORM DRAIN LINE
- PROPOSED STORM DRAIN INLET OR MANHOLE

**NOTES:**

1. SITE ELEVATIONS LOCATED IN PARALLEL AND PERPENDICULAR TO CURB ELEVATIONS.
2. EXISTING ELEVATIONS OF CURB ELEVATIONS TO BE MAINTAINED.
3. CURB ELEVATION 302.26' - ARCHITECTURAL ELEVATION 303.00'

**HDR**  
HDR ARCHITECTURE, INC.

**SKYLINE**  
 ARCHITECTS  
 111179th Ave  
 Suite 100  
 Rapid City, SD 57701  
 Phone: (605) 373-2000  
 Fax: (605) 373-2001  
 www.skylinearchitects.com

**RAPID CITY REGIONAL HOSPITAL**  
 RAPID CITY, SOUTH DAKOTA

CENTRAL  
UTILITY PLANT

NO.	DATE	BY	DESCRIPTION
1	10/15/10	JM	ISSUE FOR PERMITS
2	11/15/10	JM	ISSUE FOR PERMITS
3	08/11/11	JM	ISSUE FOR PERMITS

NO. OF SHEETS: 4  
 SHEET NO.: C-401  
 PROJECT NO.: 10-10-10-10  
 DATE: 8/11/11

**SITE GRADING PLAN - AREA A**

CENTRAL  
UTILITY PLANT

NO.	DATE	DESCRIPTION
1	11-12-09	ISSUE FOR PERMIT
2	09-13-08	ISSUE FOR CONSTRUCTION
3	01-14-08	ISSUE FOR BIDDING

NOTES:  
1. SEE SHEETS C-100, C-101, C-102, C-103, C-104, C-105, C-106, C-107, C-108, C-109, C-110, C-111, C-112, C-113, C-114, C-115, C-116, C-117, C-118, C-119, C-120, C-121, C-122, C-123, C-124, C-125, C-126, C-127, C-128, C-129, C-130, C-131, C-132, C-133, C-134, C-135, C-136, C-137, C-138, C-139, C-140, C-141, C-142, C-143, C-144, C-145, C-146, C-147, C-148, C-149, C-150, C-151, C-152, C-153, C-154, C-155, C-156, C-157, C-158, C-159, C-160, C-161, C-162, C-163, C-164, C-165, C-166, C-167, C-168, C-169, C-170, C-171, C-172, C-173, C-174, C-175, C-176, C-177, C-178, C-179, C-180, C-181, C-182, C-183, C-184, C-185, C-186, C-187, C-188, C-189, C-190, C-191, C-192, C-193, C-194, C-195, C-196, C-197, C-198, C-199, C-200, C-201, C-202, C-203, C-204, C-205, C-206, C-207, C-208, C-209, C-210, C-211, C-212, C-213, C-214, C-215, C-216, C-217, C-218, C-219, C-220, C-221, C-222, C-223, C-224, C-225, C-226, C-227, C-228, C-229, C-230, C-231, C-232, C-233, C-234, C-235, C-236, C-237, C-238, C-239, C-240, C-241, C-242, C-243, C-244, C-245, C-246, C-247, C-248, C-249, C-250, C-251, C-252, C-253, C-254, C-255, C-256, C-257, C-258, C-259, C-260, C-261, C-262, C-263, C-264, C-265, C-266, C-267, C-268, C-269, C-270, C-271, C-272, C-273, C-274, C-275, C-276, C-277, C-278, C-279, C-280, C-281, C-282, C-283, C-284, C-285, C-286, C-287, C-288, C-289, C-290, C-291, C-292, C-293, C-294, C-295, C-296, C-297, C-298, C-299, C-300, C-301, C-302, C-303, C-304, C-305, C-306, C-307, C-308, C-309, C-310, C-311, C-312, C-313, C-314, C-315, C-316, C-317, C-318, C-319, C-320, C-321, C-322, C-323, C-324, C-325, C-326, C-327, C-328, C-329, C-330, C-331, C-332, C-333, C-334, C-335, C-336, C-337, C-338, C-339, C-340, C-341, C-342, C-343, C-344, C-345, C-346, C-347, C-348, C-349, C-350, C-351, C-352, C-353, C-354, C-355, C-356, C-357, C-358, C-359, C-360, C-361, C-362, C-363, C-364, C-365, C-366, C-367, C-368, C-369, C-370, C-371, C-372, C-373, C-374, C-375, C-376, C-377, C-378, C-379, C-380, C-381, C-382, C-383, C-384, C-385, C-386, C-387, C-388, C-389, C-390, C-391, C-392, C-393, C-394, C-395, C-396, C-397, C-398, C-399, C-400, C-401, C-402, C-403, C-404, C-405, C-406, C-407, C-408, C-409, C-410, C-411, C-412, C-413, C-414, C-415, C-416, C-417, C-418, C-419, C-420, C-421, C-422, C-423, C-424, C-425, C-426, C-427, C-428, C-429, C-430, C-431, C-432, C-433, C-434, C-435, C-436, C-437, C-438, C-439, C-440, C-441, C-442, C-443, C-444, C-445, C-446, C-447, C-448, C-449, C-450, C-451, C-452, C-453, C-454, C-455, C-456, C-457, C-458, C-459, C-460, C-461, C-462, C-463, C-464, C-465, C-466, C-467, C-468, C-469, C-470, C-471, C-472, C-473, C-474, C-475, C-476, C-477, C-478, C-479, C-480, C-481, C-482, C-483, C-484, C-485, C-486, C-487, C-488, C-489, C-490, C-491, C-492, C-493, C-494, C-495, C-496, C-497, C-498, C-499, C-500, C-501, C-502, C-503, C-504, C-505, C-506, C-507, C-508, C-509, C-510, C-511, C-512, C-513, C-514, C-515, C-516, C-517, C-518, C-519, C-520, C-521, C-522, C-523, C-524, C-525, C-526, C-527, C-528, C-529, C-530, C-531, C-532, C-533, C-534, C-535, C-536, C-537, C-538, C-539, C-540, C-541, C-542, C-543, C-544, C-545, C-546, C-547, C-548, C-549, C-550, C-551, C-552, C-553, C-554, C-555, C-556, C-557, C-558, C-559, C-560, C-561, C-562, C-563, C-564, C-565, C-566, C-567, C-568, C-569, C-570, C-571, C-572, C-573, C-574, C-575, C-576, C-577, C-578, C-579, C-580, C-581, C-582, C-583, C-584, C-585, C-586, C-587, C-588, C-589, C-590, C-591, C-592, C-593, C-594, C-595, C-596, C-597, C-598, C-599, C-600, C-601, C-602, C-603, C-604, C-605, C-606, C-607, C-608, C-609, C-610, C-611, C-612, C-613, C-614, C-615, C-616, C-617, C-618, C-619, C-620, C-621, C-622, C-623, C-624, C-625, C-626, C-627, C-628, C-629, C-630, C-631, C-632, C-633, C-634, C-635, C-636, C-637, C-638, C-639, C-640, C-641, C-642, C-643, C-644, C-645, C-646, C-647, C-648, C-649, C-650, C-651, C-652, C-653, C-654, C-655, C-656, C-657, C-658, C-659, C-660, C-661, C-662, C-663, C-664, C-665, C-666, C-667, C-668, C-669, C-670, C-671, C-672, C-673, C-674, C-675, C-676, C-677, C-678, C-679, C-680, C-681, C-682, C-683, C-684, C-685, C-686, C-687, C-688, C-689, C-690, C-691, C-692, C-693, C-694, C-695, C-696, C-697, C-698, C-699, C-700, C-701, C-702, C-703, C-704, C-705, C-706, C-707, C-708, C-709, C-710, C-711, C-712, C-713, C-714, C-715, C-716, C-717, C-718, C-719, C-720, C-721, C-722, C-723, C-724, C-725, C-726, C-727, C-728, C-729, C-730, C-731, C-732, C-733, C-734, C-735, C-736, C-737, C-738, C-739, C-740, C-741, C-742, C-743, C-744, C-745, C-746, C-747, C-748, C-749, C-750, C-751, C-752, C-753, C-754, C-755, C-756, C-757, C-758, C-759, C-760, C-761, C-762, C-763, C-764, C-765, C-766, C-767, C-768, C-769, C-770, C-771, C-772, C-773, C-774, C-775, C-776, C-777, C-778, C-779, C-780, C-781, C-782, C-783, C-784, C-785, C-786, C-787, C-788, C-789, C-790, C-791, C-792, C-793, C-794, C-795, C-796, C-797, C-798, C-799, C-800, C-801, C-802, C-803, C-804, C-805, C-806, C-807, C-808, C-809, C-810, C-811, C-812, C-813, C-814, C-815, C-816, C-817, C-818, C-819, C-820, C-821, C-822, C-823, C-824, C-825, C-826, C-827, C-828, C-829, C-830, C-831, C-832, C-833, C-834, C-835, C-836, C-837, C-838, C-839, C-840, C-841, C-842, C-843, C-844, C-845, C-846, C-847, C-848, C-849, C-850, C-851, C-852, C-853, C-854, C-855, C-856, C-857, C-858, C-859, C-860, C-861, C-862, C-863, C-864, C-865, C-866, C-867, C-868, C-869, C-870, C-871, C-872, C-873, C-874, C-875, C-876, C-877, C-878, C-879, C-880, C-881, C-882, C-883, C-884, C-885, C-886, C-887, C-888, C-889, C-890, C-891, C-892, C-893, C-894, C-895, C-896, C-897, C-898, C-899, C-900, C-901, C-902, C-903, C-904, C-905, C-906, C-907, C-908, C-909, C-910, C-911, C-912, C-913, C-914, C-915, C-916, C-917, C-918, C-919, C-920, C-921, C-922, C-923, C-924, C-925, C-926, C-927, C-928, C-929, C-930, C-931, C-932, C-933, C-934, C-935, C-936, C-937, C-938, C-939, C-940, C-941, C-942, C-943, C-944, C-945, C-946, C-947, C-948, C-949, C-950, C-951, C-952, C-953, C-954, C-955, C-956, C-957, C-958, C-959, C-960, C-961, C-962, C-963, C-964, C-965, C-966, C-967, C-968, C-969, C-970, C-971, C-972, C-973, C-974, C-975, C-976, C-977, C-978, C-979, C-980, C-981, C-982, C-983, C-984, C-985, C-986, C-987, C-988, C-989, C-990, C-991, C-992, C-993, C-994, C-995, C-996, C-997, C-998, C-999, C-1000.

SITE  
GRADING  
PLAN -  
AREA B & C

SCALE: 1" = 20'  
C-402

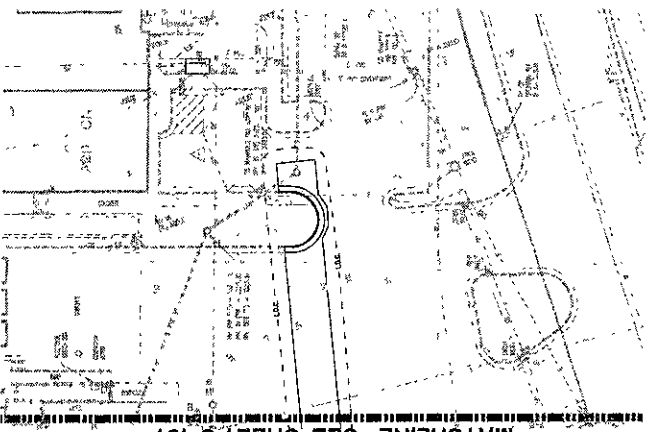

MATCHLINE - SEE SHEET C-401

AREA C

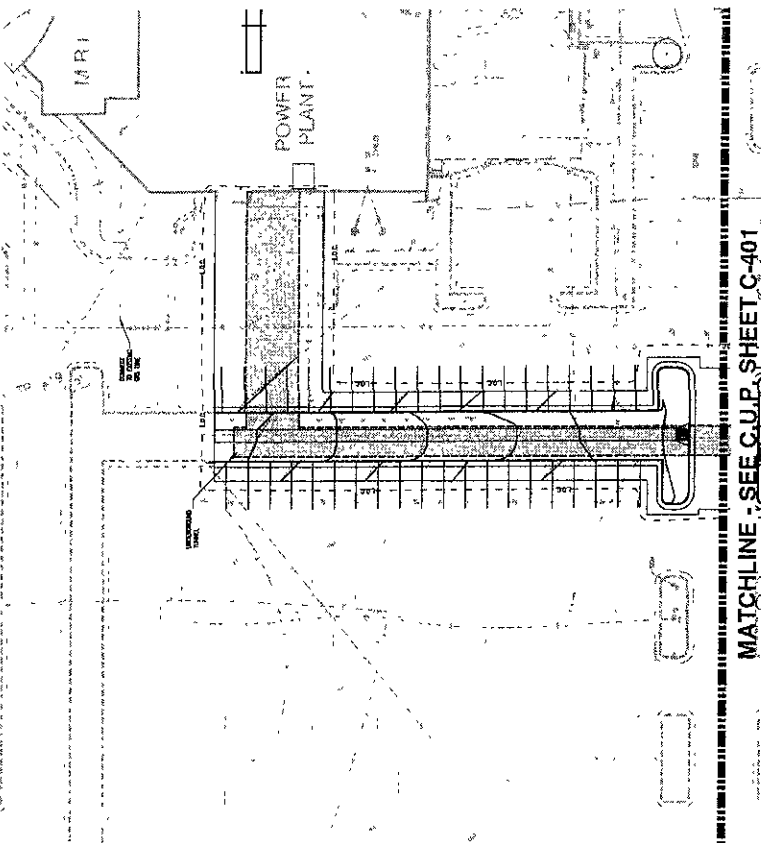

MATCHLINE - SEE C.U.P. SHEET C-401

AREA B

- NOTES:
- 1. ALL UTILITIES LOCATED UNLESS OTHERWISE NOTED.
  - 2. SEE SHEET C-100 FOR SURVEY MONUMENTS AND BENCHMARKS.
  - 3. SITE CLOSURE 50' x 100' - ADMINISTRATIVE UTILITIES TOWER.

**LEGEND:**

- PROPERTY LINE
- EXISTING CURBS AND/OR CURB & GUTTER TO STREET
- PROPOSED TO REMAIN
- EXISTING STORM DRAIN LINE
- EXISTING SANITARY SEWER LINE
- EXISTING WATER LINE
- EXISTING GAS LINE
- EXISTING FIBER OPTIC LINE
- EXISTING CABLE TV LINE
- EXISTING TELEPHONE LINE
- EXISTING FIRE HYDRANT
- METER VALVE
- CLEAN OUT FOR MANHOLE, VALVE, CLEAN OUT, OR SERVICE BOX
- EXISTING LIGHT POLE
- EXISTING POWER POLE
- EXISTING TREE
- FINISHED GRADE CONTOUR
- PROPOSED STREET GRADE
- EXISTING ACCESSIBLE SURFACE
- PROPOSED ACCESSIBLE SURFACE
- EXISTING ACCESSIBLE SIDEWALK
- PROPOSED ACCESSIBLE SIDEWALK
- NEW CONCRETE CURB AND GUTTER
- NEW CONCRETE CURB
- NEW EDGE OF PAVING
- ACCESSIBLE PATHWAY
- PROPOSED PATHWAY
- NEW STORM DRAIN LINE
- NEW STORM DRAIN INLET OR MANHOLE



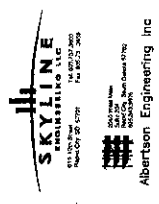

**CENTRAL  
UTILITY PLANT**

NO.	DATE	BY	DESCRIPTION
1	11-10-08	W.D.	ISSUE FOR PERMITS
2	11-10-08	W.D.	ISSUE FOR PERMITS
3	04-10-09	W.D.	ISSUE FOR PERMITS
4	04-10-09	W.D.	ISSUE FOR PERMITS
5	04-10-09	W.D.	ISSUE FOR PERMITS
6	04-10-09	W.D.	ISSUE FOR PERMITS
7	04-10-09	W.D.	ISSUE FOR PERMITS
8	04-10-09	W.D.	ISSUE FOR PERMITS
9	04-10-09	W.D.	ISSUE FOR PERMITS
10	04-10-09	W.D.	ISSUE FOR PERMITS
11	04-10-09	W.D.	ISSUE FOR PERMITS
12	04-10-09	W.D.	ISSUE FOR PERMITS
13	04-10-09	W.D.	ISSUE FOR PERMITS
14	04-10-09	W.D.	ISSUE FOR PERMITS
15	04-10-09	W.D.	ISSUE FOR PERMITS
16	04-10-09	W.D.	ISSUE FOR PERMITS
17	04-10-09	W.D.	ISSUE FOR PERMITS
18	04-10-09	W.D.	ISSUE FOR PERMITS
19	04-10-09	W.D.	ISSUE FOR PERMITS
20	04-10-09	W.D.	ISSUE FOR PERMITS
21	04-10-09	W.D.	ISSUE FOR PERMITS
22	04-10-09	W.D.	ISSUE FOR PERMITS
23	04-10-09	W.D.	ISSUE FOR PERMITS
24	04-10-09	W.D.	ISSUE FOR PERMITS
25	04-10-09	W.D.	ISSUE FOR PERMITS
26	04-10-09	W.D.	ISSUE FOR PERMITS
27	04-10-09	W.D.	ISSUE FOR PERMITS
28	04-10-09	W.D.	ISSUE FOR PERMITS
29	04-10-09	W.D.	ISSUE FOR PERMITS
30	04-10-09	W.D.	ISSUE FOR PERMITS
31	04-10-09	W.D.	ISSUE FOR PERMITS
32	04-10-09	W.D.	ISSUE FOR PERMITS
33	04-10-09	W.D.	ISSUE FOR PERMITS
34	04-10-09	W.D.	ISSUE FOR PERMITS
35	04-10-09	W.D.	ISSUE FOR PERMITS
36	04-10-09	W.D.	ISSUE FOR PERMITS
37	04-10-09	W.D.	ISSUE FOR PERMITS
38	04-10-09	W.D.	ISSUE FOR PERMITS
39	04-10-09	W.D.	ISSUE FOR PERMITS
40	04-10-09	W.D.	ISSUE FOR PERMITS
41	04-10-09	W.D.	ISSUE FOR PERMITS
42	04-10-09	W.D.	ISSUE FOR PERMITS
43	04-10-09	W.D.	ISSUE FOR PERMITS
44	04-10-09	W.D.	ISSUE FOR PERMITS
45	04-10-09	W.D.	ISSUE FOR PERMITS
46	04-10-09	W.D.	ISSUE FOR PERMITS
47	04-10-09	W.D.	ISSUE FOR PERMITS
48	04-10-09	W.D.	ISSUE FOR PERMITS
49	04-10-09	W.D.	ISSUE FOR PERMITS
50	04-10-09	W.D.	ISSUE FOR PERMITS
51	04-10-09	W.D.	ISSUE FOR PERMITS
52	04-10-09	W.D.	ISSUE FOR PERMITS
53	04-10-09	W.D.	ISSUE FOR PERMITS
54	04-10-09	W.D.	ISSUE FOR PERMITS
55	04-10-09	W.D.	ISSUE FOR PERMITS
56	04-10-09	W.D.	ISSUE FOR PERMITS
57	04-10-09	W.D.	ISSUE FOR PERMITS
58	04-10-09	W.D.	ISSUE FOR PERMITS
59	04-10-09	W.D.	ISSUE FOR PERMITS
60	04-10-09	W.D.	ISSUE FOR PERMITS
61	04-10-09	W.D.	ISSUE FOR PERMITS
62	04-10-09	W.D.	ISSUE FOR PERMITS
63	04-10-09	W.D.	ISSUE FOR PERMITS
64	04-10-09	W.D.	ISSUE FOR PERMITS
65	04-10-09	W.D.	ISSUE FOR PERMITS
66	04-10-09	W.D.	ISSUE FOR PERMITS
67	04-10-09	W.D.	ISSUE FOR PERMITS
68	04-10-09	W.D.	ISSUE FOR PERMITS
69	04-10-09	W.D.	ISSUE FOR PERMITS
70	04-10-09	W.D.	ISSUE FOR PERMITS
71	04-10-09	W.D.	ISSUE FOR PERMITS
72	04-10-09	W.D.	ISSUE FOR PERMITS
73	04-10-09	W.D.	ISSUE FOR PERMITS
74	04-10-09	W.D.	ISSUE FOR PERMITS
75	04-10-09	W.D.	ISSUE FOR PERMITS
76	04-10-09	W.D.	ISSUE FOR PERMITS
77	04-10-09	W.D.	ISSUE FOR PERMITS
78	04-10-09	W.D.	ISSUE FOR PERMITS
79	04-10-09	W.D.	ISSUE FOR PERMITS
80	04-10-09	W.D.	ISSUE FOR PERMITS
81	04-10-09	W.D.	ISSUE FOR PERMITS
82	04-10-09	W.D.	ISSUE FOR PERMITS
83	04-10-09	W.D.	ISSUE FOR PERMITS
84	04-10-09	W.D.	ISSUE FOR PERMITS
85	04-10-09	W.D.	ISSUE FOR PERMITS
86	04-10-09	W.D.	ISSUE FOR PERMITS
87	04-10-09	W.D.	ISSUE FOR PERMITS
88	04-10-09	W.D.	ISSUE FOR PERMITS
89	04-10-09	W.D.	ISSUE FOR PERMITS
90	04-10-09	W.D.	ISSUE FOR PERMITS
91	04-10-09	W.D.	ISSUE FOR PERMITS
92	04-10-09	W.D.	ISSUE FOR PERMITS
93	04-10-09	W.D.	ISSUE FOR PERMITS
94	04-10-09	W.D.	ISSUE FOR PERMITS
95	04-10-09	W.D.	ISSUE FOR PERMITS
96	04-10-09	W.D.	ISSUE FOR PERMITS
97	04-10-09	W.D.	ISSUE FOR PERMITS
98	04-10-09	W.D.	ISSUE FOR PERMITS
99	04-10-09	W.D.	ISSUE FOR PERMITS
100	04-10-09	W.D.	ISSUE FOR PERMITS

NO WORK IS TO BE DONE IN THESE AREAS UNTIL THE PERMITS ARE OBTAINED FROM THE CITY OF RAPID CITY. THIS PLAN IS NOT TO BE USED FOR CONSTRUCTION OF ANY WORK IN THESE AREAS WITHOUT THE WRITTEN APPROVAL OF HDR, INC. 11/10/08

**PRE/POST  
DEVELOPMENT  
DRAINAGE  
AREAS**

**PRE-DEVELOPMENT CONDITION**

TOTAL IMPERVIOUS	52.0 Acres
TOTAL PERVIOUS	82.0 Acres
PERVIOUS COEFFICIENT - 0.15	12.3 Acres
IMPERVIOUS AREA	52.0 Acres
PERVIOUS COEFFICIENT - 0.15	7.8 Acres
AREAS TOTAL IMPERVIOUS COEFFICIENT - 0.15	60.0 Acres

**POST-DEVELOPMENT CONDITION**

TOTAL IMPERVIOUS	52.0 Acres
TOTAL PERVIOUS	82.0 Acres
PERVIOUS COEFFICIENT - 0.15	12.3 Acres
IMPERVIOUS AREA	52.0 Acres
PERVIOUS COEFFICIENT - 0.15	7.8 Acres
AREAS TOTAL IMPERVIOUS COEFFICIENT - 0.15	60.0 Acres

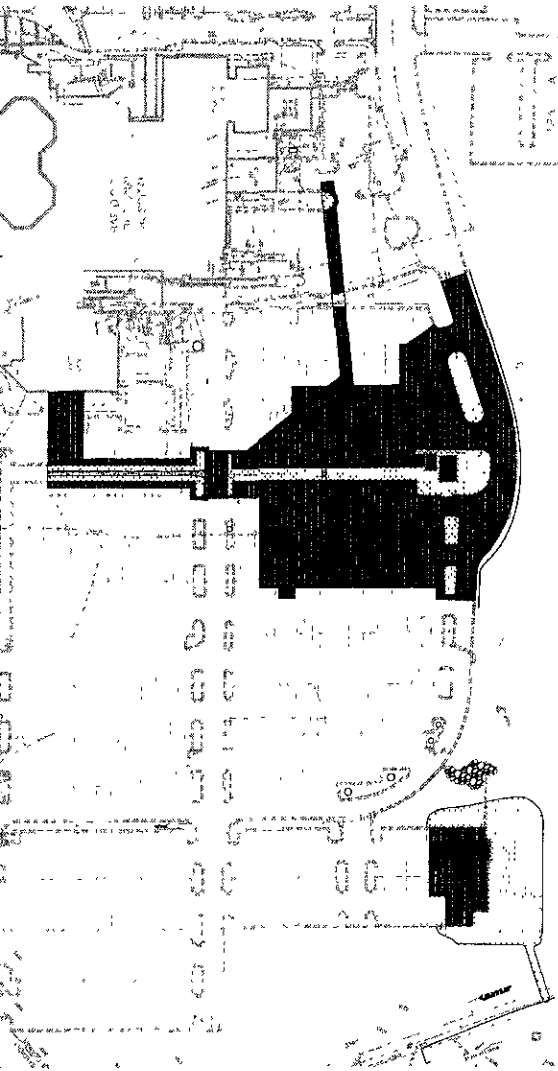

**PRE-DEVELOPMENT CONDITION**

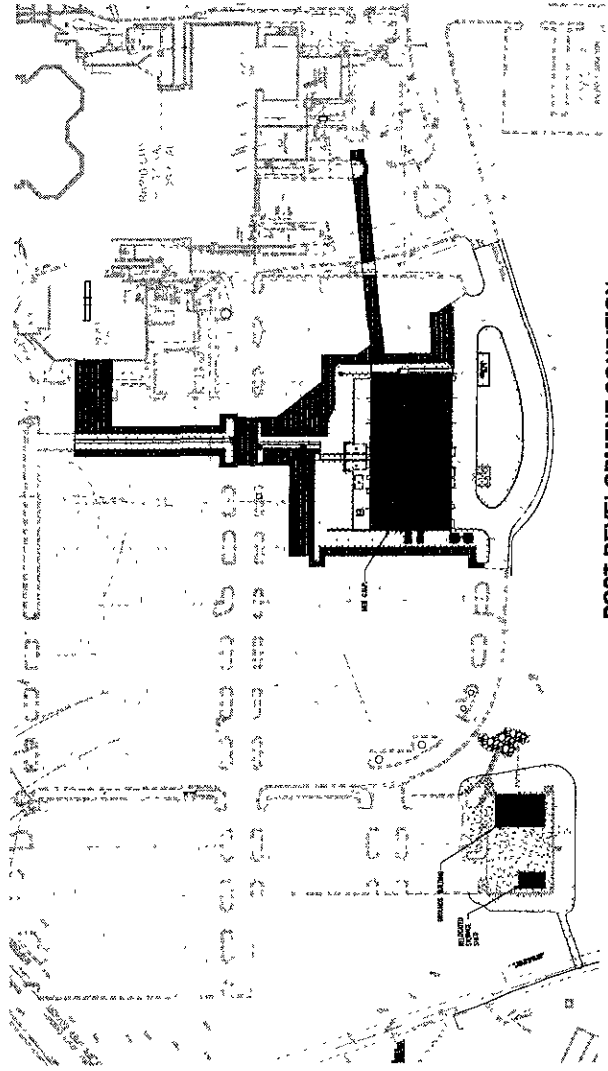

**POST-DEVELOPMENT CONDITION**



**HDR**

HDR CONSULTANTS, INC.

**SKYLINE**  
ENGINEERING & ARCHITECTURE, INC.

Albertson Engineering Inc.



**RAPID CITY REGIONAL HOSPITAL**  
RAPID CITY, SOUTH DAKOTA

**CENTRAL UTILITY PLANT**

NO.	DATE	DESCRIPTION
1	11-19-97	10' RIVER 82
2	11-13-98	BOOK ENLARGEMENT
3	09-10-98	REVISIONS
4	08-10-98	REVISIONS
5	08-10-98	REVISIONS
6	08-10-98	REVISIONS
7	08-10-98	REVISIONS
8	08-10-98	REVISIONS
9	08-10-98	REVISIONS
10	08-10-98	REVISIONS
11	08-10-98	REVISIONS
12	08-10-98	REVISIONS
13	08-10-98	REVISIONS
14	08-10-98	REVISIONS
15	08-10-98	REVISIONS
16	08-10-98	REVISIONS
17	08-10-98	REVISIONS
18	08-10-98	REVISIONS
19	08-10-98	REVISIONS
20	08-10-98	REVISIONS
21	08-10-98	REVISIONS
22	08-10-98	REVISIONS
23	08-10-98	REVISIONS
24	08-10-98	REVISIONS
25	08-10-98	REVISIONS
26	08-10-98	REVISIONS
27	08-10-98	REVISIONS
28	08-10-98	REVISIONS
29	08-10-98	REVISIONS
30	08-10-98	REVISIONS
31	08-10-98	REVISIONS
32	08-10-98	REVISIONS
33	08-10-98	REVISIONS
34	08-10-98	REVISIONS
35	08-10-98	REVISIONS
36	08-10-98	REVISIONS
37	08-10-98	REVISIONS
38	08-10-98	REVISIONS
39	08-10-98	REVISIONS
40	08-10-98	REVISIONS
41	08-10-98	REVISIONS
42	08-10-98	REVISIONS
43	08-10-98	REVISIONS
44	08-10-98	REVISIONS
45	08-10-98	REVISIONS
46	08-10-98	REVISIONS
47	08-10-98	REVISIONS
48	08-10-98	REVISIONS
49	08-10-98	REVISIONS
50	08-10-98	REVISIONS

THIS DRAWING IS THE PROPERTY OF HDR CONSULTANTS, INC. AND IS NOT TO BE REPRODUCED OR TRANSMITTED IN ANY FORM OR BY ANY MEANS, ELECTRONIC OR MECHANICAL, INCLUDING PHOTOCOPYING, RECORDING, OR BY ANY INFORMATION STORAGE AND RETRIEVAL SYSTEM.

**SITE PAVEMENTS PLAN - AREA A**

Scale: 1" = 20'  
**C-501**

**LEGEND:**

- PROPERTY LINE
- EXISTING CURB AND/GUT
- EXISTING CENTER TO CENTER
- EXISTING SIDEWALK
- EXISTING STATION SIGNAL LINE
- EXISTING SIGNAL SERVICE LINE
- EXISTING ELECTRIC LINE
- EXISTING WATER LINE
- EXISTING GAS LINE
- EXISTING FIBER OPTIC LINE
- EXISTING TELEPHONE LINE
- EXISTING CHASE CONDUIT
- EXISTING FIRE HYDRANT
- WATER MAIN
- EXISTING UTILITY MANHOLE, WALK, CLEAN OUT OR SERVICE BOX
- EXISTING LIGHT POLE
- EXISTING POWER POLE
- EXISTING ACCESSIBLE SYMBOL
- EXISTING ACCESSIBLE SIDEWALK
- EXISTING ACCESSIBLE SIDEWALK
- NEW CONCRETE CURB AND GUTTER
- NEW CONCRETE DRIVE
- NEW EDGE OF PAVING
- ACCESSIBLE SYMBOL
- ACCESSIBLE SIDEWALK
- ACCESSIBLE SIDEWALK
- ASPHALT CONCRETE PAVING
- ACCESSIBLE SYMBOL
- CONCRETE WALK PAVING
- CONTROL OR CONSTRUCTION JOINT
- EXTENSION JOINT

**NOTES:**  
1 ALL CONCRETE WALK PAVING TO HAVE BROOK FINISH PATTER.

**MATCHLINE - SEE SHEET C-502**

**MATCHLINE - SEE SHEET C-502**

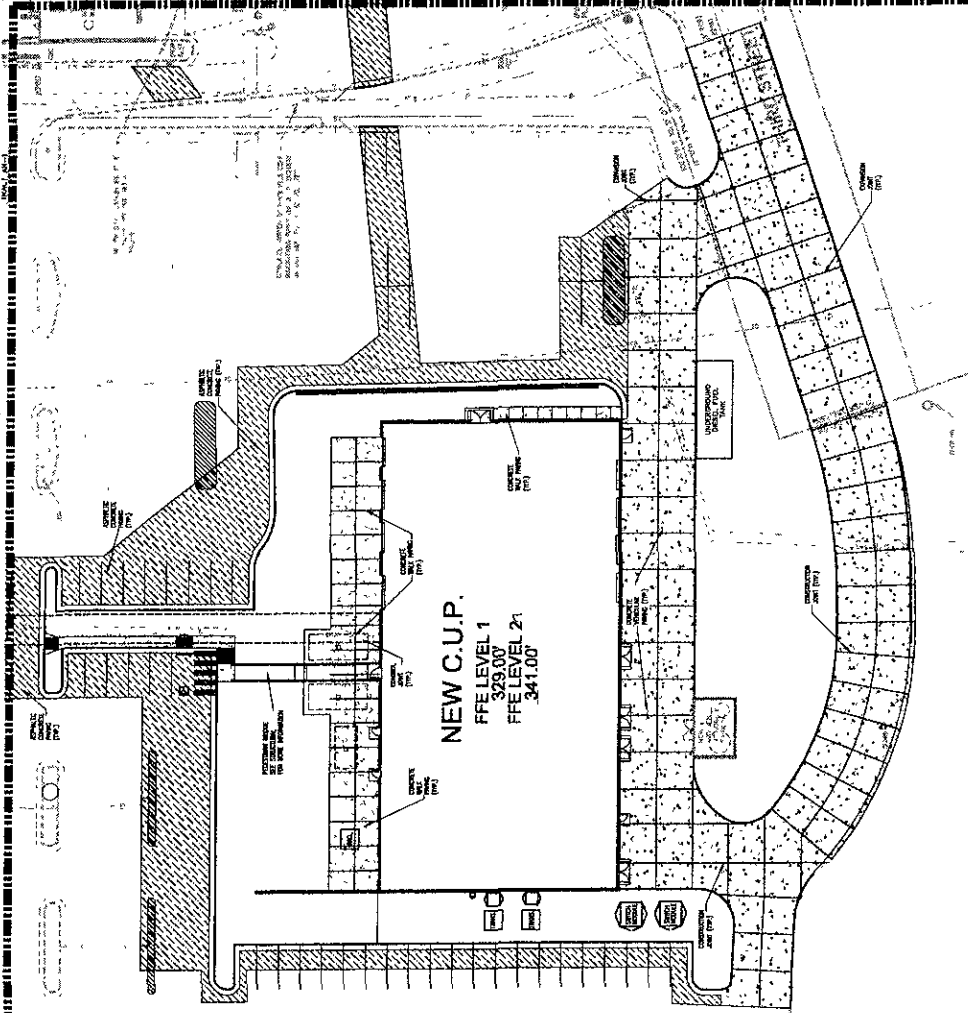

TRACT A4-3  
PROPERTY, TRACT A4-3, SECTION 10

**HDR**  
 HOYT ARBUTHNOT & ASSOCIATES, INC.

**SKYLINE**  
 ENGINEERING, INC.  
 1100 UNIVERSITY AVENUE  
 SUITE 200  
 ANN ARBOR, MI 48106-0208  
 TEL: 734.769.8300  
 FAX: 734.769.8305  
 www.skyline-engineering.com



**RAPID CITY REGIONAL  
 HOSPITAL**  
 RAPID CITY, SOUTH DAKOTA

**CENTRAL  
 UTILITY PLANT**

NO.	DATE	BY	DESCRIPTION
1	09-16-09	WJ	ISSUE FOR PERMITS
2	01-12-10	WJ	REVISED TO REFLECT PERMITS
3	03-18-10	WJ	REVISED TO REFLECT PERMITS

NO.	DATE	BY	DESCRIPTION
1	01-12-10	WJ	ISSUE FOR PERMITS
2	03-18-10	WJ	REVISED TO REFLECT PERMITS
3	09-16-09	WJ	ISSUE FOR PERMITS

NO.	DATE	BY	DESCRIPTION
1	01-12-10	WJ	ISSUE FOR PERMITS
2	03-18-10	WJ	REVISED TO REFLECT PERMITS

NO.	DATE	BY	DESCRIPTION
1	01-12-10	WJ	ISSUE FOR PERMITS
2	03-18-10	WJ	REVISED TO REFLECT PERMITS
3	09-16-09	WJ	ISSUE FOR PERMITS

FOR NAME & JOB NO.  
 PLEASE REFER TO SET OF  
 CONTRACT DOCUMENTS  
 DRAWING NO. 1121  
 DATE: 01/12/10

**SITE  
 PAVEMENTS  
 PLAN -  
 AREA B & C**

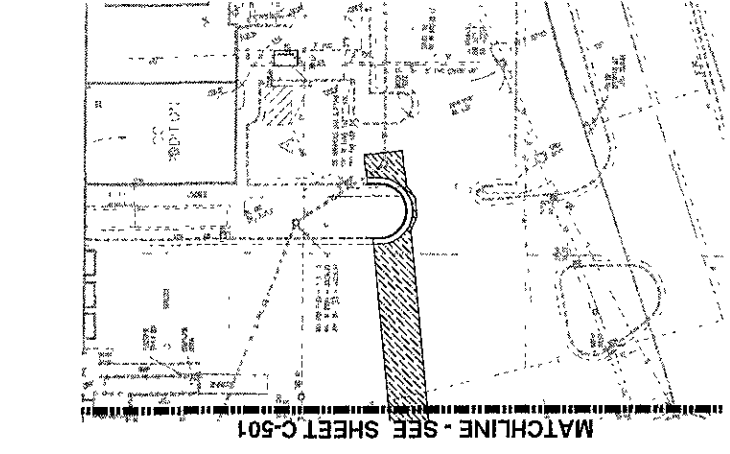

MATCHLINE - SEE SHEET C-501

**AREA C**

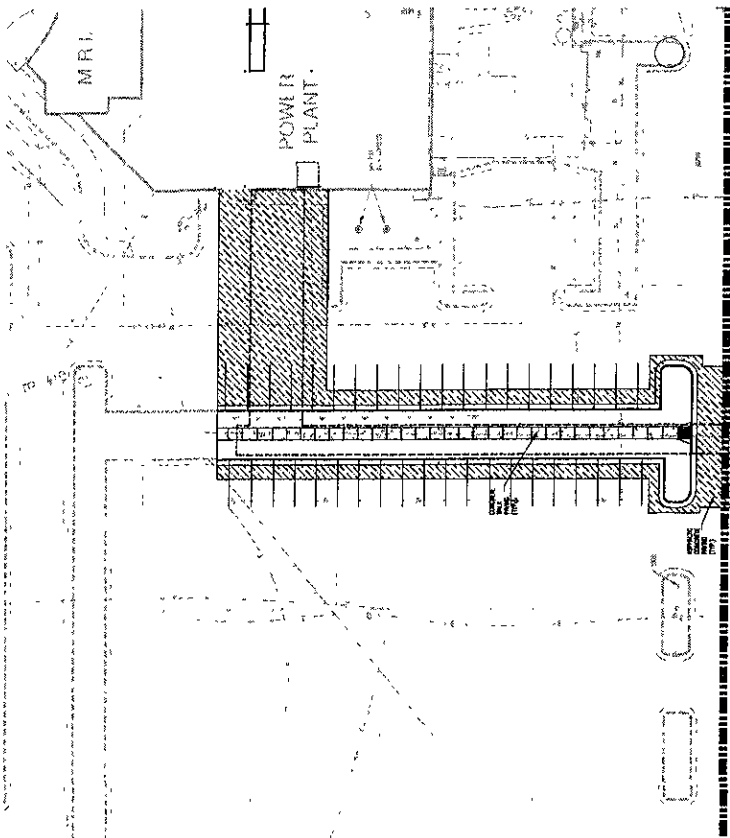

MATCHLINE - SEE C.U.P. SHEET C-501

**AREA B**

**NOTES:**  
 1. ALL CONCRETE WALK PAVING TO BE BROOM FINISH.

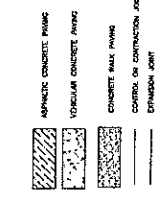

- LEGEND:**
- PROPERTY LINE
  - ADJACENT LINE
  - ASBESTOS ABANDONED
  - CURB & GUTTER TO PLUMB
  - PROPOSED DRIVE
  - PROPOSED SIDEWALK
  - EXISTING SIGNAL CABLE LINE
  - EXISTING SANITARY SEWER LINE
  - EXISTING OVERHEAD ELECTRIC LINE
  - EXISTING WATER LINE
  - EXISTING GAS LINE
  - EXISTING FIBER OPTIC LINE
  - EXISTING RAINCATCHER
  - EXISTING FENCE
  - EXISTING CONCRETE
  - EXISTING DRIVE
  - EXISTING SIDEWALK
  - EXISTING LIGHT POLE
  - EXISTING POWER POLE
  - EXISTING ACCESSIBLE PAVEMENT
  - EXISTING CURB & GUTTER
  - EXISTING CONCRETE DRIVE AND DRIVE
  - NEW CONCRETE DRIVE
  - NEW CONCRETE DRIVE
  - NEW EDGE OF PAVING
  - ACCESSIBLE STAIRS
  - ACCESSIBLE DRIVE
  - ACCESSIBLE DRIVE





NO.	DESCRIPTION	DATE
1	ISSUED FOR PERMIT	08/11/10
2	ISSUED FOR PERMIT	08/11/10
3	ISSUED FOR PERMIT	08/11/10
4	ISSUED FOR PERMIT	08/11/10
5	ISSUED FOR PERMIT	08/11/10
6	ISSUED FOR PERMIT	08/11/10
7	ISSUED FOR PERMIT	08/11/10
8	ISSUED FOR PERMIT	08/11/10
9	ISSUED FOR PERMIT	08/11/10
10	ISSUED FOR PERMIT	08/11/10
11	ISSUED FOR PERMIT	08/11/10
12	ISSUED FOR PERMIT	08/11/10
13	ISSUED FOR PERMIT	08/11/10
14	ISSUED FOR PERMIT	08/11/10
15	ISSUED FOR PERMIT	08/11/10
16	ISSUED FOR PERMIT	08/11/10
17	ISSUED FOR PERMIT	08/11/10
18	ISSUED FOR PERMIT	08/11/10
19	ISSUED FOR PERMIT	08/11/10
20	ISSUED FOR PERMIT	08/11/10
21	ISSUED FOR PERMIT	08/11/10
22	ISSUED FOR PERMIT	08/11/10
23	ISSUED FOR PERMIT	08/11/10
24	ISSUED FOR PERMIT	08/11/10
25	ISSUED FOR PERMIT	08/11/10
26	ISSUED FOR PERMIT	08/11/10
27	ISSUED FOR PERMIT	08/11/10
28	ISSUED FOR PERMIT	08/11/10
29	ISSUED FOR PERMIT	08/11/10
30	ISSUED FOR PERMIT	08/11/10
31	ISSUED FOR PERMIT	08/11/10
32	ISSUED FOR PERMIT	08/11/10
33	ISSUED FOR PERMIT	08/11/10
34	ISSUED FOR PERMIT	08/11/10
35	ISSUED FOR PERMIT	08/11/10
36	ISSUED FOR PERMIT	08/11/10
37	ISSUED FOR PERMIT	08/11/10
38	ISSUED FOR PERMIT	08/11/10
39	ISSUED FOR PERMIT	08/11/10
40	ISSUED FOR PERMIT	08/11/10
41	ISSUED FOR PERMIT	08/11/10
42	ISSUED FOR PERMIT	08/11/10
43	ISSUED FOR PERMIT	08/11/10
44	ISSUED FOR PERMIT	08/11/10
45	ISSUED FOR PERMIT	08/11/10
46	ISSUED FOR PERMIT	08/11/10
47	ISSUED FOR PERMIT	08/11/10
48	ISSUED FOR PERMIT	08/11/10
49	ISSUED FOR PERMIT	08/11/10
50	ISSUED FOR PERMIT	08/11/10

SCALE: 1" = 20'  
DATE: 08/11/10

**SITE UTILITIES PLAN - AREA A**

**LEGEND:**

- PROPOSED LINE
- EXISTENT LINE
- EXISTING CHASE AND/OR CONDUIT
- EXISTING CHASE AND/OR CONDUIT TO BE REMOVED
- EXISTING CHASE AND/OR CONDUIT TO BE REMOVED TO REMAIN
- EXISTING STORM DRAIN LINE
- EXISTING SANITARY SEWER LINE
- EXISTING PROPOSED ELECTRIC LINE
- EXISTING PROPOSED GAS LINE
- EXISTING OVERHEAD UTIL. LINE
- EXISTING FIRE HYDRANT
- EXISTING FIRE HYDRANT
- WATER VALVE
- EXISTING LIGHT POLE
- EXISTING POWER POLE
- EXISTING ACCESSIBLE STAND
- EXISTING WHEELWELL
- NEW CONCRETE CURB
- NEW ROCK OF MASONRY
- ACCESSIBLE STAND
- WHEELWELL
- ACCESSIBLE SIGN
- PROPOSED SANITARY SEWER LINE
- PROPOSED WATER LINE
- PROPOSED FIRE LINE
- PROPOSED ELECTRIC LINE
- PROPOSED GAS LINE
- PROPOSED OVERHEAD UTIL. LINE
- PROPOSED FIRE LINE - BY GRADE

**NOTE:**

1. THE CONTRACTOR SHALL VERIFY THE LOCATION AND DEPTH OF ALL EXISTING UTILITIES PRIOR TO THE START OF CONSTRUCTION. THE CONTRACTOR SHALL BE RESPONSIBLE FOR OBTAINING ALL NECESSARY PERMITS AND APPROVALS FROM THE LOCAL GOVERNMENT AND UTILITIES COMPANIES. THE CONTRACTOR SHALL BE RESPONSIBLE FOR OBTAINING ALL NECESSARY PERMITS AND APPROVALS FROM THE LOCAL GOVERNMENT AND UTILITIES COMPANIES. THE CONTRACTOR SHALL BE RESPONSIBLE FOR OBTAINING ALL NECESSARY PERMITS AND APPROVALS FROM THE LOCAL GOVERNMENT AND UTILITIES COMPANIES.
2. THE CONTRACTOR SHALL VERIFY THE LOCATION AND DEPTH OF ALL EXISTING UTILITIES PRIOR TO THE START OF CONSTRUCTION. THE CONTRACTOR SHALL BE RESPONSIBLE FOR OBTAINING ALL NECESSARY PERMITS AND APPROVALS FROM THE LOCAL GOVERNMENT AND UTILITIES COMPANIES. THE CONTRACTOR SHALL BE RESPONSIBLE FOR OBTAINING ALL NECESSARY PERMITS AND APPROVALS FROM THE LOCAL GOVERNMENT AND UTILITIES COMPANIES.
3. THE CONTRACTOR SHALL VERIFY THE LOCATION AND DEPTH OF ALL EXISTING UTILITIES PRIOR TO THE START OF CONSTRUCTION. THE CONTRACTOR SHALL BE RESPONSIBLE FOR OBTAINING ALL NECESSARY PERMITS AND APPROVALS FROM THE LOCAL GOVERNMENT AND UTILITIES COMPANIES. THE CONTRACTOR SHALL BE RESPONSIBLE FOR OBTAINING ALL NECESSARY PERMITS AND APPROVALS FROM THE LOCAL GOVERNMENT AND UTILITIES COMPANIES.
4. UTILITIES ARE APPROXIMATE. CONTRACTORS SHALL VERIFY UTILITIES TO CONFIRMATION.
5. APPROXIMATE SHOWN UTILITIES.
6. WATER LINE TO HAVE A MINIMUM DEPTH TO TOP OF PIPE OF 5' FROM FINISHED GRADE.

MATCHLINE - SEE SHEET C-602

MATCHLINE - SEE SHEET C-602

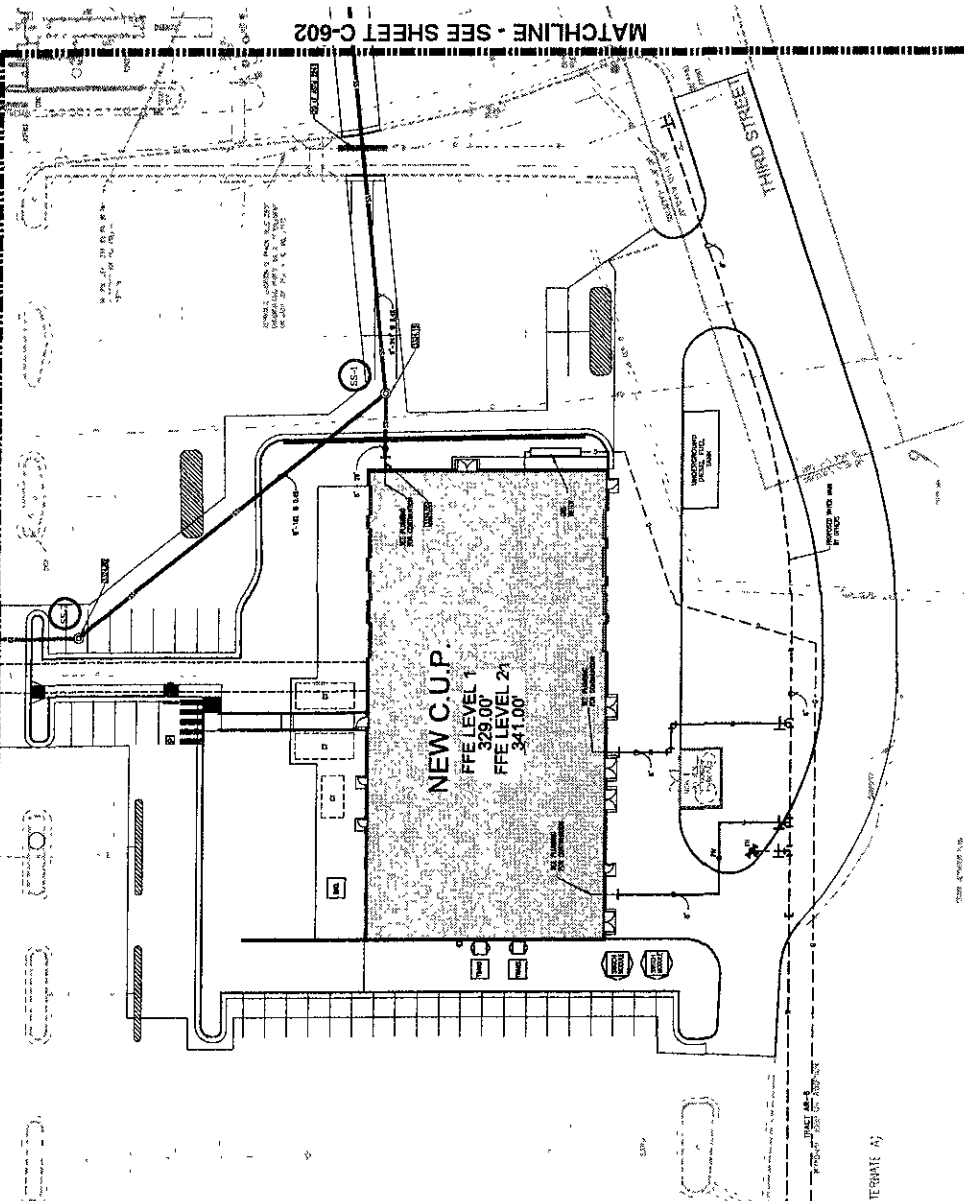

DATE: 08/11/10



**HDR**  
HDR Engineering, Inc.  
1000 17th Street, NW  
Washington, DC 20036  
Tel: 202-777-0800  
Fax: 202-777-0801

**SKYLINE**  
ENGINEERING INC.  
1115 15th Street, NW  
Washington, DC 20005  
Tel: 202-777-0800  
Fax: 202-777-0801

SKYLINE Engineering Inc. is an Equal Opportunity Employer  
M/F/V/D

SKYLINE Engineering Inc.  
1115 15th Street, NW  
Washington, DC 20005  
Tel: 202-777-0800  
Fax: 202-777-0801

**RAPID CITY REGIONAL HOSPITAL**  
RAPID CITY, SOUTH DAKOTA

**CENTRAL UTILITY PLANT**

NO.	DATE	DESCRIPTION
1	11-11-09	ISSUE FOR PERMITS
2	01-14-10	ISSUE FOR CONSTRUCTION
3	01-14-10	ISSUE FOR CONSTRUCTION
4	01-14-10	ISSUE FOR CONSTRUCTION
5	01-14-10	ISSUE FOR CONSTRUCTION
6	01-14-10	ISSUE FOR CONSTRUCTION
7	01-14-10	ISSUE FOR CONSTRUCTION
8	01-14-10	ISSUE FOR CONSTRUCTION
9	01-14-10	ISSUE FOR CONSTRUCTION
10	01-14-10	ISSUE FOR CONSTRUCTION

THIS DRAWING IS THE PROPERTY OF HDR ENGINEERING, INC. AND IS NOT TO BE REPRODUCED OR TRANSMITTED IN ANY FORM OR BY ANY MEANS, ELECTRONIC OR MECHANICAL, WITHOUT THE WRITTEN PERMISSION OF HDR ENGINEERING, INC.

**SITE UTILITIES PLAN - AREA B**

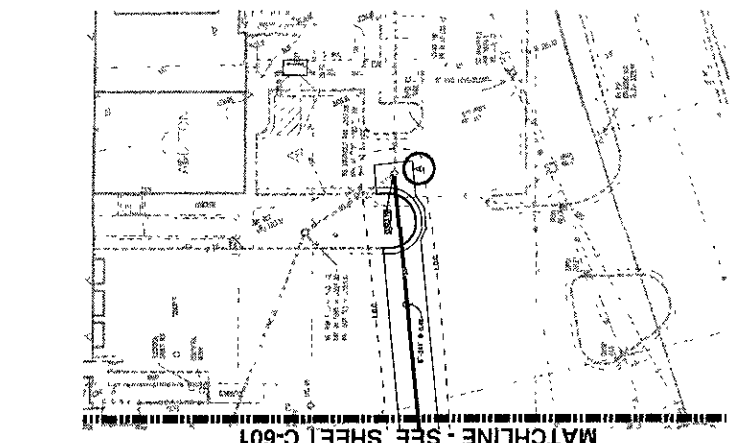

**MATCHLINE - SEE SHEET C-601**

**AREA C**

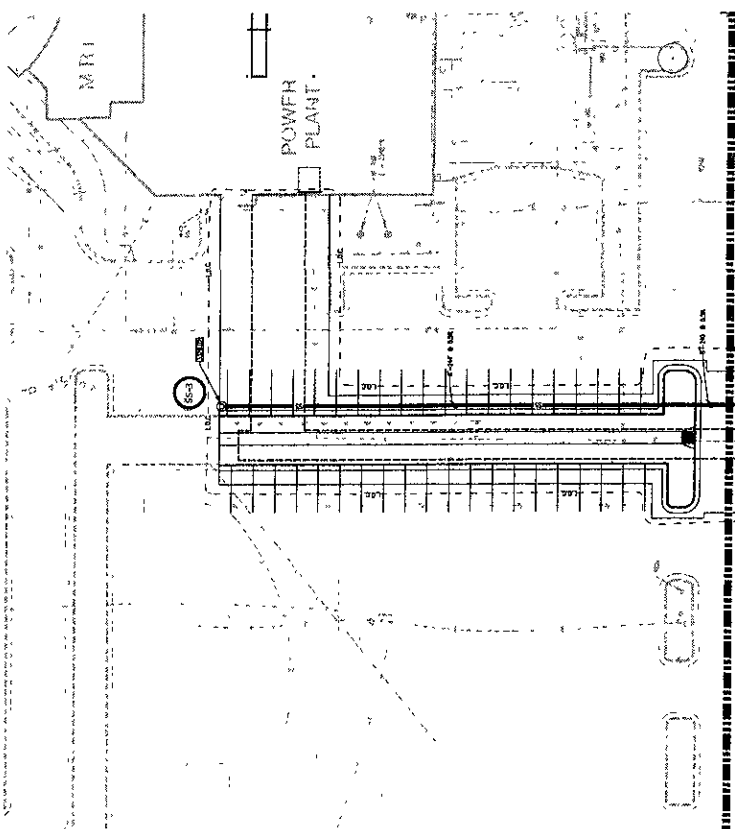

**MATCHLINE - SEE C.U.P. SHEET C-601**

**AREA B**

**LEGEND:**

---	PROPERTY LINE
---	EXISTING CONDUIT AND/OR CABLE & UTILITY TO REMAIN
---	PROPOSED CONDUIT AND/OR CABLE & UTILITY TO REMAIN
---	EXISTING WATER LINE
---	PROPOSED WATER LINE
---	EXISTING OVERHEAD ELECTRIC LINE
---	PROPOSED OVERHEAD ELECTRIC LINE
---	EXISTING SANITARY SEWER LINE
---	PROPOSED SANITARY SEWER LINE
---	EXISTING GAS LINE
---	PROPOSED GAS LINE
---	EXISTING FIBER OPTIC CABLE
---	PROPOSED FIBER OPTIC CABLE
---	EXISTING LIGHT POLE
---	PROPOSED LIGHT POLE
---	EXISTING ACCESSIBLE PAVEMENT
---	PROPOSED ACCESSIBLE PAVEMENT
---	EXISTING CONCRETE CURB AND GUTTER
---	PROPOSED CONCRETE CURB AND GUTTER
---	NEW EDGE OF PAVING
---	PROPOSED NEW EDGE OF PAVING
---	EXISTING DRIVEWAY
---	PROPOSED DRIVEWAY
---	EXISTING SIDEWALK
---	PROPOSED SIDEWALK
---	EXISTING BIKEWAY
---	PROPOSED BIKEWAY
---	EXISTING BIKEWAY
---	PROPOSED BIKEWAY
---	EXISTING BIKEWAY
---	PROPOSED BIKEWAY

**NOTES**

1. THE EXISTENCE AND LOCATION OF ALL UNDERGROUND UTILITIES, INCLUDING BUT NOT LIMITED TO, WATER, GAS, FIBER OPTIC, SANITARY SEWER, AND OVERHEAD ELECTRIC, SHALL BE DETERMINED BY THE CONTRACTOR PRIOR TO CONSTRUCTION. THE CONTRACTOR SHALL BE RESPONSIBLE FOR VERIFYING THE LOCATION AND DEPTH OF ALL UTILITIES PRIOR TO CONSTRUCTION. THE CONTRACTOR SHALL BE RESPONSIBLE FOR OBTAINING ALL NECESSARY PERMITS AND APPROVALS FROM THE CITY OF RAPID CITY AND THE SOUTH DAKOTA DEPARTMENT OF REVENUE PRIOR TO CONSTRUCTION.
2. ALL CONSTRUCTION/RECONSTRUCTION WORK SHALL BE DONE IN ACCORDANCE WITH THE CITY OF RAPID CITY STANDARD SPECIFICATIONS FOR UTILITIES. THE CONTRACTOR SHALL BE RESPONSIBLE FOR OBTAINING ALL NECESSARY PERMITS AND APPROVALS FROM THE CITY OF RAPID CITY AND THE SOUTH DAKOTA DEPARTMENT OF REVENUE PRIOR TO CONSTRUCTION.
3. IF SMALL, BE THE CONTRACTOR'S RESPONSIBILITY TO VERIFY THE LOCATION AND DEPTH OF ALL UTILITIES PRIOR TO CONSTRUCTION. THE CONTRACTOR SHALL BE RESPONSIBLE FOR OBTAINING ALL NECESSARY PERMITS AND APPROVALS FROM THE CITY OF RAPID CITY AND THE SOUTH DAKOTA DEPARTMENT OF REVENUE PRIOR TO CONSTRUCTION.
4. THE CONTRACTOR SHALL BE RESPONSIBLE FOR OBTAINING ALL NECESSARY PERMITS AND APPROVALS FROM THE CITY OF RAPID CITY AND THE SOUTH DAKOTA DEPARTMENT OF REVENUE PRIOR TO CONSTRUCTION.
5. CONDUIT LOCATION OF ONE LINE TO BE CONFORMED WITH THE CITY OF RAPID CITY STANDARD SPECIFICATIONS FOR UTILITIES.
6. WHERE LINES DO NOT CROSS, THE CONTRACTOR SHALL BE RESPONSIBLE FOR OBTAINING ALL NECESSARY PERMITS AND APPROVALS FROM THE CITY OF RAPID CITY AND THE SOUTH DAKOTA DEPARTMENT OF REVENUE PRIOR TO CONSTRUCTION.



NO.	DATE	BY	DESCRIPTION
1	11-14-08	SK	ISSUE FOR PERMITS
2	11-14-08	SK	ISSUE FOR PERMITS
3	08-20-08	SK	ISSUE FOR PERMITS
4	08-20-08	SK	ISSUE FOR PERMITS
5	08-20-08	SK	ISSUE FOR PERMITS
6	08-20-08	SK	ISSUE FOR PERMITS
7	08-20-08	SK	ISSUE FOR PERMITS
8	08-20-08	SK	ISSUE FOR PERMITS
9	08-20-08	SK	ISSUE FOR PERMITS
10	08-20-08	SK	ISSUE FOR PERMITS
11	08-20-08	SK	ISSUE FOR PERMITS
12	08-20-08	SK	ISSUE FOR PERMITS
13	08-20-08	SK	ISSUE FOR PERMITS
14	08-20-08	SK	ISSUE FOR PERMITS
15	08-20-08	SK	ISSUE FOR PERMITS
16	08-20-08	SK	ISSUE FOR PERMITS
17	08-20-08	SK	ISSUE FOR PERMITS
18	08-20-08	SK	ISSUE FOR PERMITS
19	08-20-08	SK	ISSUE FOR PERMITS
20	08-20-08	SK	ISSUE FOR PERMITS

IN ACCORDANCE WITH THE  
PROVISIONS OF THE  
UNIFORM CONSTRUCTION  
CODE, SOUTH DAKOTA, THE  
DATE OF THIS PERMIT  
IS 07/14/09

**SITE DETAILS**

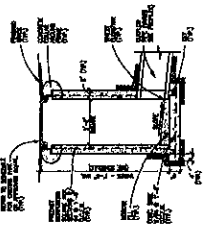

**1**  
**GRATE INLET**  
NOT TO SCALE  
**C-701**

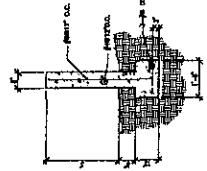

**2**  
**IMPACT WALL**  
NOT TO SCALE  
**C-701**

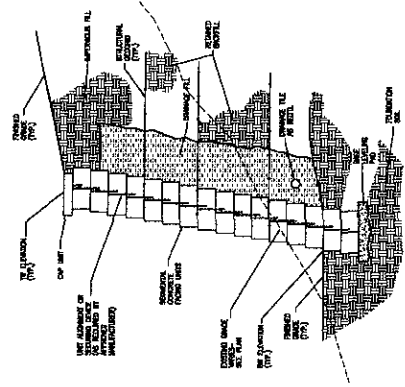

**3**  
**MODULAR UNIT RETAINING WALL**  
NOT TO SCALE  
**C-701**

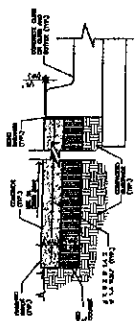

**7**  
**CONCRETE WALK PAVING**  
NOT TO SCALE  
**C-701**

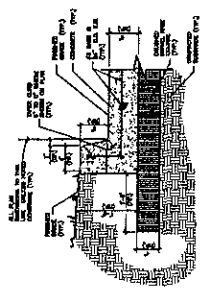

**8**  
**CONCRETE VEHICULAR PAVING  
W/ INTEGRAL CURB - HEAVY DUTY**  
NOT TO SCALE  
**C-701**

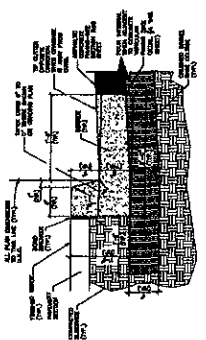

**5**  
**CONCRETE CURB AND GUTTER**  
NOT TO SCALE  
**C-701**

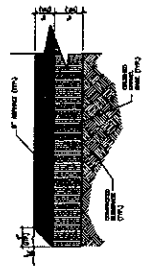

**6**  
**ASPHALTIC CONCRETE PAVING - LIGHT DUTY**  
NOT TO SCALE  
**C-701**

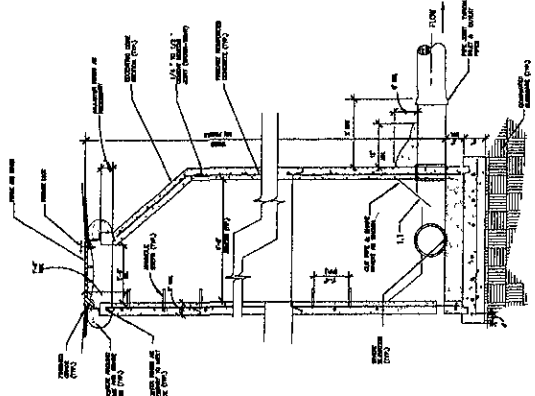

**9**  
**SANITARY SEWER MANHOLE**  
NOT TO SCALE  
**C-701**

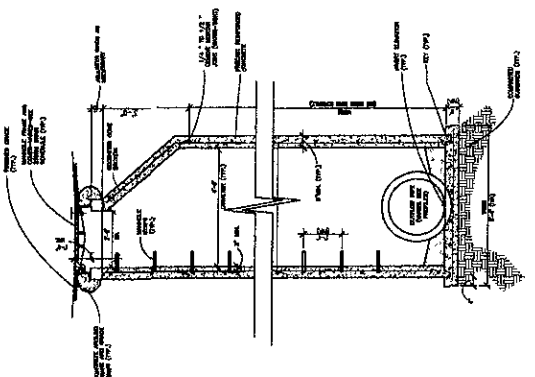

**8**  
**STORM DRAIN MANHOLE**  
NOT TO SCALE  
**C-701**



3  
2-702  
PRECAST CONCRETE WHEELSTOP  
NOT TO SCALE

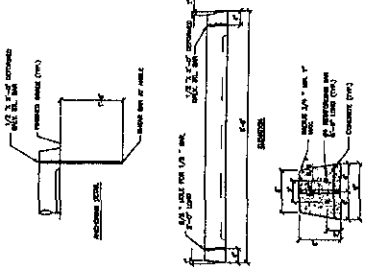

3  
2-702  
BROOM FINISH  
NOT TO SCALE

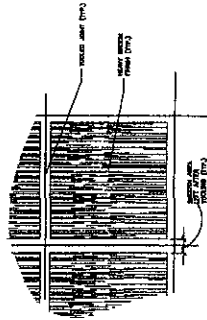

6  
2-702  
ACCESSIBLE RAMP - TYPE II  
NOT TO SCALE

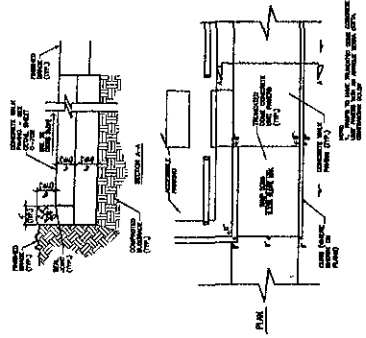

6  
2-702  
ACCESSIBLE RAMP - TYPE I  
NOT TO SCALE

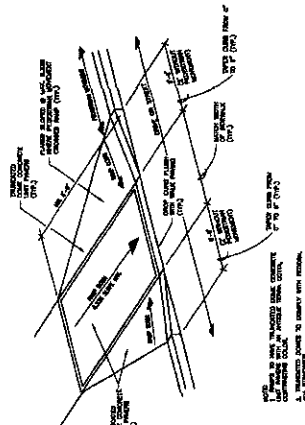

7  
2-702  
ACCESSIBLE PARKING SYMBOL  
NOT TO SCALE

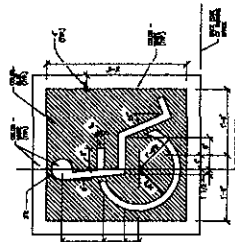

7  
2-702  
ACCESSIBLE PARKING SIGN  
NOT TO SCALE

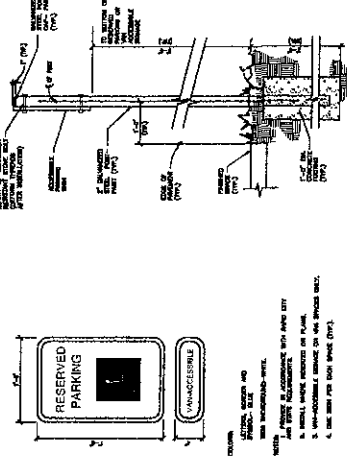

1  
2-702  
INLET PROTECTION (CATCH BASIN)  
NOT TO SCALE

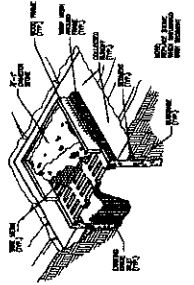

6  
2-702  
SILT FENCE  
NOT TO SCALE

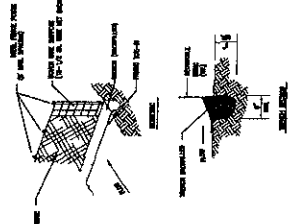

7  
2-702  
ACCESSIBLE PARKING SIGN  
NOT TO SCALE

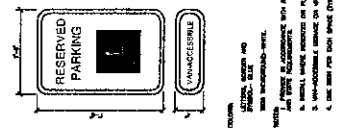



**SKYLINE**  
ARCHITECTS  
543 East 1st Avenue  
Portland, OR 97214  
Tel: 503.222.5500  
Fax: 503.222.5505

**Albertson Engineering Inc.**  
543 East 1st Avenue  
Portland, OR 97214  
Tel: 503.222.5500  
Fax: 503.222.5505

**RAPID CITY REGIONAL HOSPITAL**  
RAPID CITY, SOUTH DAKOTA

**CENTRAL UTILITY PLANT**

NO.	DATE	DESCRIPTION
1		PRELIMINARY (P) - 12/14/10
2		REVISED (R) - 02/04/11
3		REVISED (R) - 03/04/11
4		REVISED (R) - 03/24/11
5		REVISED (R) - 04/01/11
6		REVISED (R) - 04/20/11
7		REVISED (R) - 05/03/11
8		REVISED (R) - 05/10/11
9		REVISED (R) - 05/17/11
10		REVISED (R) - 05/24/11
11		REVISED (R) - 06/07/11
12		REVISED (R) - 06/14/11
13		REVISED (R) - 06/21/11
14		REVISED (R) - 06/28/11
15		REVISED (R) - 07/05/11
16		REVISED (R) - 07/12/11
17		REVISED (R) - 07/19/11
18		REVISED (R) - 07/26/11
19		REVISED (R) - 08/02/11
20		REVISED (R) - 08/09/11
21		REVISED (R) - 08/16/11
22		REVISED (R) - 08/23/11
23		REVISED (R) - 08/30/11
24		REVISED (R) - 09/06/11
25		REVISED (R) - 09/13/11
26		REVISED (R) - 09/20/11
27		REVISED (R) - 09/27/11
28		REVISED (R) - 10/04/11
29		REVISED (R) - 10/11/11
30		REVISED (R) - 10/18/11
31		REVISED (R) - 10/25/11
32		REVISED (R) - 11/01/11
33		REVISED (R) - 11/08/11
34		REVISED (R) - 11/15/11
35		REVISED (R) - 11/22/11
36		REVISED (R) - 11/29/11
37		REVISED (R) - 12/06/11
38		REVISED (R) - 12/13/11
39		REVISED (R) - 12/20/11
40		REVISED (R) - 12/27/11
41		REVISED (R) - 01/03/12
42		REVISED (R) - 01/10/12
43		REVISED (R) - 01/17/12
44		REVISED (R) - 01/24/12
45		REVISED (R) - 01/31/12
46		REVISED (R) - 02/07/12
47		REVISED (R) - 02/14/12
48		REVISED (R) - 02/21/12
49		REVISED (R) - 02/28/12
50		REVISED (R) - 03/06/12

NOT FOR CONSTRUCTION

**SITE LANDSCAPE PLAN - AREA A**

- LEGEND:**
- PROPOSED LINE
  - EXISTING DRIVE AND/OR DRIVE & UTILITY TO REMAIN
  - EXISTING STORM SEWER LINE
  - EXISTING STORM DRAIN LINE
  - EXISTING SANITARY SEWER LINE
  - EXISTING OVERHEAD ELECTRIC LINE
  - EXISTING WATER LINE
  - EXISTING OVERHEAD STREET LIGHT
  - EXISTING SIDE CONDUIT
  - EXISTING FIRE HYDRANT
  - WATER VALVE
  - WATER VALVE, HANDLE & HANDLE CLEAR OUT ON SERVICE BOX
  - EXISTING LIGHT POLE
  - EXISTING POWER POLE
  - NEW CONCRETE CURB
  - NEW EDGE OF PAVING
  - NEW CONCRETE DRIVE AND GUTTER
  - SEASONS
- NOTES:**
1. SEE SHEET L-102 FOR MATCHLINE LEFT AND RIGHT
  2. ALL DIMENSIONS AREAS TO BE INDICATED
  3. ALL DIMENSIONS AREAS TO BE INDICATED
  4. ALL DIMENSIONS AREAS TO BE INDICATED
  5. ALL DIMENSIONS AREAS TO BE INDICATED
  6. ALL DIMENSIONS AREAS TO BE INDICATED
  7. ALL DIMENSIONS AREAS TO BE INDICATED
  8. ALL DIMENSIONS AREAS TO BE INDICATED
  9. ALL DIMENSIONS AREAS TO BE INDICATED
  10. ALL DIMENSIONS AREAS TO BE INDICATED
  11. ALL DIMENSIONS AREAS TO BE INDICATED
  12. ALL DIMENSIONS AREAS TO BE INDICATED
  13. ALL DIMENSIONS AREAS TO BE INDICATED
  14. ALL DIMENSIONS AREAS TO BE INDICATED
  15. ALL DIMENSIONS AREAS TO BE INDICATED
  16. ALL DIMENSIONS AREAS TO BE INDICATED
  17. ALL DIMENSIONS AREAS TO BE INDICATED
  18. ALL DIMENSIONS AREAS TO BE INDICATED
  19. ALL DIMENSIONS AREAS TO BE INDICATED
  20. ALL DIMENSIONS AREAS TO BE INDICATED
  21. ALL DIMENSIONS AREAS TO BE INDICATED
  22. ALL DIMENSIONS AREAS TO BE INDICATED
  23. ALL DIMENSIONS AREAS TO BE INDICATED
  24. ALL DIMENSIONS AREAS TO BE INDICATED
  25. ALL DIMENSIONS AREAS TO BE INDICATED
  26. ALL DIMENSIONS AREAS TO BE INDICATED
  27. ALL DIMENSIONS AREAS TO BE INDICATED
  28. ALL DIMENSIONS AREAS TO BE INDICATED
  29. ALL DIMENSIONS AREAS TO BE INDICATED
  30. ALL DIMENSIONS AREAS TO BE INDICATED
  31. ALL DIMENSIONS AREAS TO BE INDICATED
  32. ALL DIMENSIONS AREAS TO BE INDICATED
  33. ALL DIMENSIONS AREAS TO BE INDICATED
  34. ALL DIMENSIONS AREAS TO BE INDICATED
  35. ALL DIMENSIONS AREAS TO BE INDICATED
  36. ALL DIMENSIONS AREAS TO BE INDICATED
  37. ALL DIMENSIONS AREAS TO BE INDICATED
  38. ALL DIMENSIONS AREAS TO BE INDICATED
  39. ALL DIMENSIONS AREAS TO BE INDICATED
  40. ALL DIMENSIONS AREAS TO BE INDICATED
  41. ALL DIMENSIONS AREAS TO BE INDICATED
  42. ALL DIMENSIONS AREAS TO BE INDICATED
  43. ALL DIMENSIONS AREAS TO BE INDICATED
  44. ALL DIMENSIONS AREAS TO BE INDICATED
  45. ALL DIMENSIONS AREAS TO BE INDICATED
  46. ALL DIMENSIONS AREAS TO BE INDICATED
  47. ALL DIMENSIONS AREAS TO BE INDICATED
  48. ALL DIMENSIONS AREAS TO BE INDICATED
  49. ALL DIMENSIONS AREAS TO BE INDICATED
  50. ALL DIMENSIONS AREAS TO BE INDICATED

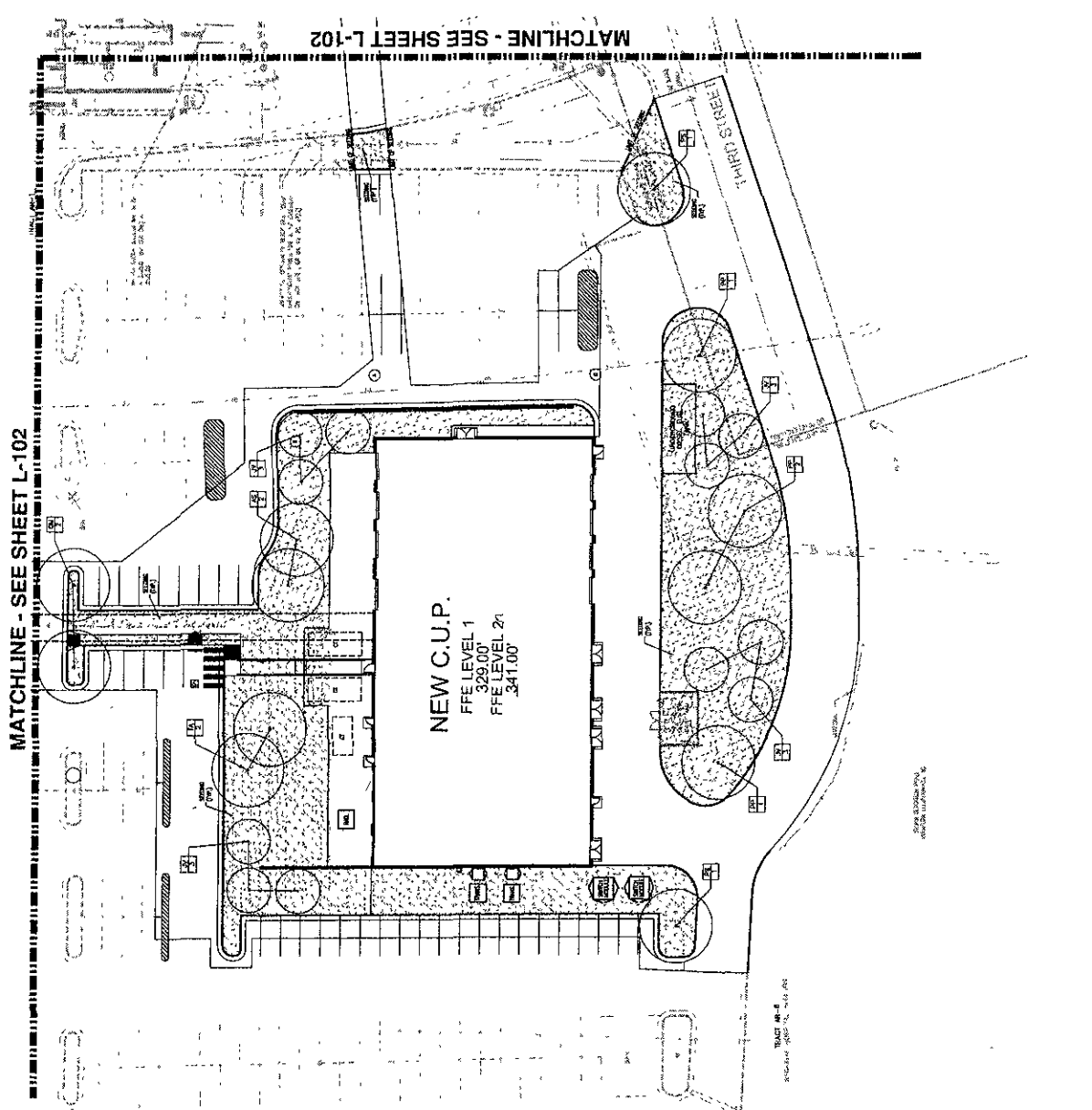



NO.	DATE	DESCRIPTION
1	10-26-24	PRELIMINARY DESIGN
2	11-18-24	SCHEMATIC DESIGN
3	08-18-25	SCHEMATIC DESIGN
4		
5		
6		
7		
8		
9		
10		
11		
12		
13		
14		
15		
16		
17		
18		
19		
20		
21		
22		
23		
24		
25		
26		
27		
28		
29		
30		
31		
32		
33		
34		
35		
36		
37		
38		
39		
40		

NOT FOR CONSTRUCTION  
**SITE  
LANDSCAPE  
PLAN -  
AREA B AND C**

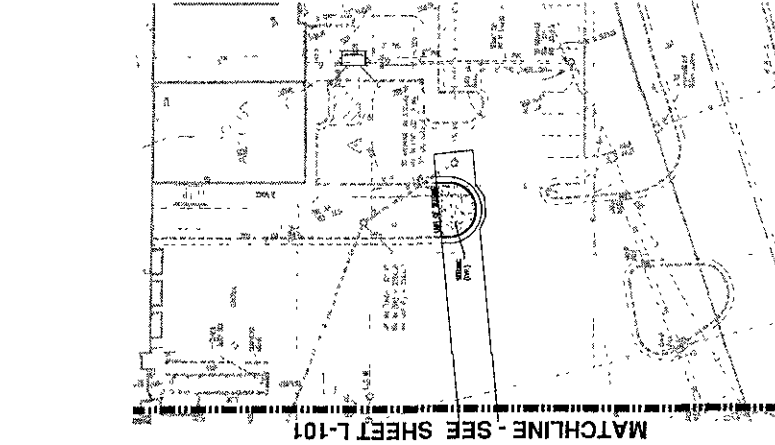

MATCHLINE - SEE SHEET L-101

**SITE LANDSCAPE PLAN - AREA C**

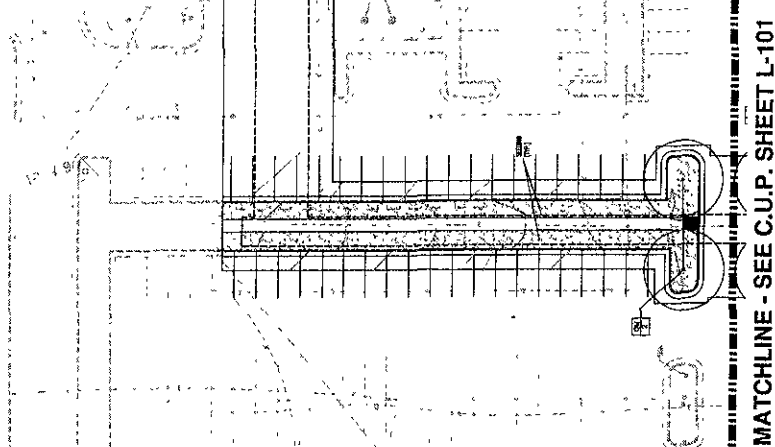

MATCHLINE - SEE C.U.P. SHEET L-101

**SITE LANDSCAPE PLAN - AREA B**

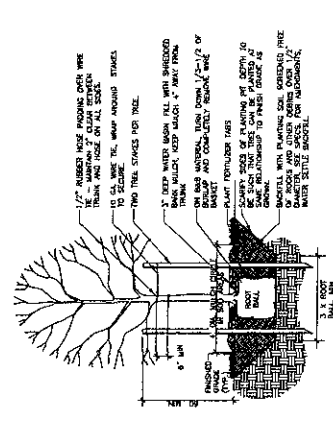

DECIDUOUS TREE PLANTING DETAIL  
NOT TO SCALE

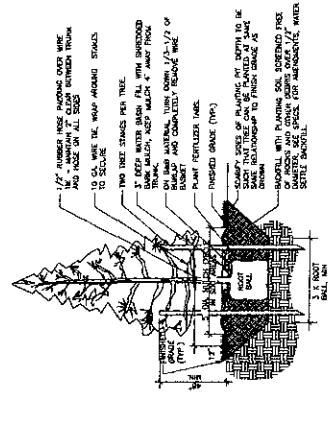

EVERGREEN TREE PLANTING DETAIL  
NOT TO SCALE

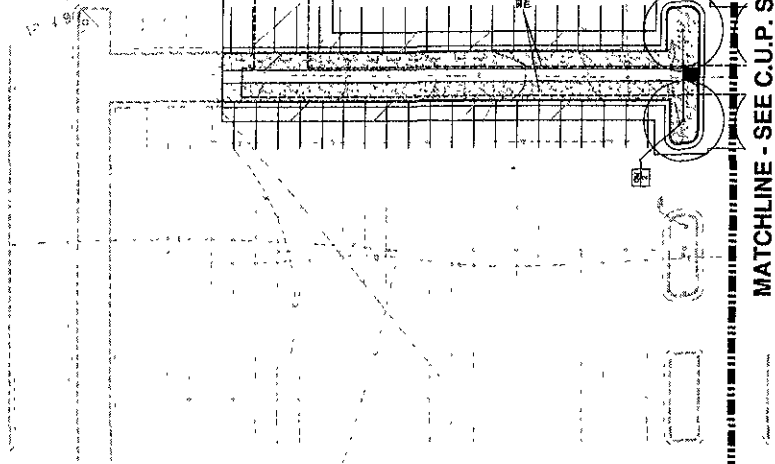

MATCHLINE - SEE SHEET L-101

MATCHLINE - SEE C.U.P. SHEET L-101

KEY	CITY	SCIENTIFIC NAME	COMMON NAME	NOTES
1	1	ALBANY	ALBANY	SEE FORMAL ASSISTING DRAWINGS
2	2	ALBANY	ALBANY	SEE FORMAL ASSISTING DRAWINGS
3	3	ALBANY	ALBANY	SEE FORMAL ASSISTING DRAWINGS
4	4	ALBANY	ALBANY	SEE FORMAL ASSISTING DRAWINGS
5	5	ALBANY	ALBANY	SEE FORMAL ASSISTING DRAWINGS
6	6	ALBANY	ALBANY	SEE FORMAL ASSISTING DRAWINGS
7	7	ALBANY	ALBANY	SEE FORMAL ASSISTING DRAWINGS
8	8	ALBANY	ALBANY	SEE FORMAL ASSISTING DRAWINGS
9	9	ALBANY	ALBANY	SEE FORMAL ASSISTING DRAWINGS
10	10	ALBANY	ALBANY	SEE FORMAL ASSISTING DRAWINGS
11	11	ALBANY	ALBANY	SEE FORMAL ASSISTING DRAWINGS
12	12	ALBANY	ALBANY	SEE FORMAL ASSISTING DRAWINGS
13	13	ALBANY	ALBANY	SEE FORMAL ASSISTING DRAWINGS
14	14	ALBANY	ALBANY	SEE FORMAL ASSISTING DRAWINGS
15	15	ALBANY	ALBANY	SEE FORMAL ASSISTING DRAWINGS
16	16	ALBANY	ALBANY	SEE FORMAL ASSISTING DRAWINGS
17	17	ALBANY	ALBANY	SEE FORMAL ASSISTING DRAWINGS
18	18	ALBANY	ALBANY	SEE FORMAL ASSISTING DRAWINGS
19	19	ALBANY	ALBANY	SEE FORMAL ASSISTING DRAWINGS
20	20	ALBANY	ALBANY	SEE FORMAL ASSISTING DRAWINGS
21	21	ALBANY	ALBANY	SEE FORMAL ASSISTING DRAWINGS
22	22	ALBANY	ALBANY	SEE FORMAL ASSISTING DRAWINGS
23	23	ALBANY	ALBANY	SEE FORMAL ASSISTING DRAWINGS
24	24	ALBANY	ALBANY	SEE FORMAL ASSISTING DRAWINGS
25	25	ALBANY	ALBANY	SEE FORMAL ASSISTING DRAWINGS
26	26	ALBANY	ALBANY	SEE FORMAL ASSISTING DRAWINGS
27	27	ALBANY	ALBANY	SEE FORMAL ASSISTING DRAWINGS
28	28	ALBANY	ALBANY	SEE FORMAL ASSISTING DRAWINGS
29	29	ALBANY	ALBANY	SEE FORMAL ASSISTING DRAWINGS
30	30	ALBANY	ALBANY	SEE FORMAL ASSISTING DRAWINGS
31	31	ALBANY	ALBANY	SEE FORMAL ASSISTING DRAWINGS
32	32	ALBANY	ALBANY	SEE FORMAL ASSISTING DRAWINGS
33	33	ALBANY	ALBANY	SEE FORMAL ASSISTING DRAWINGS
34	34	ALBANY	ALBANY	SEE FORMAL ASSISTING DRAWINGS
35	35	ALBANY	ALBANY	SEE FORMAL ASSISTING DRAWINGS
36	36	ALBANY	ALBANY	SEE FORMAL ASSISTING DRAWINGS
37	37	ALBANY	ALBANY	SEE FORMAL ASSISTING DRAWINGS
38	38	ALBANY	ALBANY	SEE FORMAL ASSISTING DRAWINGS
39	39	ALBANY	ALBANY	SEE FORMAL ASSISTING DRAWINGS
40	40	ALBANY	ALBANY	SEE FORMAL ASSISTING DRAWINGS
41	41	ALBANY	ALBANY	SEE FORMAL ASSISTING DRAWINGS
42	42	ALBANY	ALBANY	SEE FORMAL ASSISTING DRAWINGS
43	43	ALBANY	ALBANY	SEE FORMAL ASSISTING DRAWINGS
44	44	ALBANY	ALBANY	SEE FORMAL ASSISTING DRAWINGS
45	45	ALBANY	ALBANY	SEE FORMAL ASSISTING DRAWINGS
46	46	ALBANY	ALBANY	SEE FORMAL ASSISTING DRAWINGS
47	47	ALBANY	ALBANY	SEE FORMAL ASSISTING DRAWINGS
48	48	ALBANY	ALBANY	SEE FORMAL ASSISTING DRAWINGS
49	49	ALBANY	ALBANY	SEE FORMAL ASSISTING DRAWINGS
50	50	ALBANY	ALBANY	SEE FORMAL ASSISTING DRAWINGS
51	51	ALBANY	ALBANY	SEE FORMAL ASSISTING DRAWINGS
52	52	ALBANY	ALBANY	SEE FORMAL ASSISTING DRAWINGS
53	53	ALBANY	ALBANY	SEE FORMAL ASSISTING DRAWINGS
54	54	ALBANY	ALBANY	SEE FORMAL ASSISTING DRAWINGS
55	55	ALBANY	ALBANY	SEE FORMAL ASSISTING DRAWINGS
56	56	ALBANY	ALBANY	SEE FORMAL ASSISTING DRAWINGS
57	57	ALBANY	ALBANY	SEE FORMAL ASSISTING DRAWINGS
58	58	ALBANY	ALBANY	SEE FORMAL ASSISTING DRAWINGS
59	59	ALBANY	ALBANY	SEE FORMAL ASSISTING DRAWINGS
60	60	ALBANY	ALBANY	SEE FORMAL ASSISTING DRAWINGS
61	61	ALBANY	ALBANY	SEE FORMAL ASSISTING DRAWINGS
62	62	ALBANY	ALBANY	SEE FORMAL ASSISTING DRAWINGS
63	63	ALBANY	ALBANY	SEE FORMAL ASSISTING DRAWINGS
64	64	ALBANY	ALBANY	SEE FORMAL ASSISTING DRAWINGS
65	65	ALBANY	ALBANY	SEE FORMAL ASSISTING DRAWINGS
66	66	ALBANY	ALBANY	SEE FORMAL ASSISTING DRAWINGS
67	67	ALBANY	ALBANY	SEE FORMAL ASSISTING DRAWINGS
68	68	ALBANY	ALBANY	SEE FORMAL ASSISTING DRAWINGS
69	69	ALBANY	ALBANY	SEE FORMAL ASSISTING DRAWINGS
70	70	ALBANY	ALBANY	SEE FORMAL ASSISTING DRAWINGS
71	71	ALBANY	ALBANY	SEE FORMAL ASSISTING DRAWINGS
72	72	ALBANY	ALBANY	SEE FORMAL ASSISTING DRAWINGS
73	73	ALBANY	ALBANY	SEE FORMAL ASSISTING DRAWINGS
74	74	ALBANY	ALBANY	SEE FORMAL ASSISTING DRAWINGS
75	75	ALBANY	ALBANY	SEE FORMAL ASSISTING DRAWINGS
76	76	ALBANY	ALBANY	SEE FORMAL ASSISTING DRAWINGS
77	77	ALBANY	ALBANY	SEE FORMAL ASSISTING DRAWINGS
78	78	ALBANY	ALBANY	SEE FORMAL ASSISTING DRAWINGS
79	79	ALBANY	ALBANY	SEE FORMAL ASSISTING DRAWINGS
80	80	ALBANY	ALBANY	SEE FORMAL ASSISTING DRAWINGS
81	81	ALBANY	ALBANY	SEE FORMAL ASSISTING DRAWINGS
82	82	ALBANY	ALBANY	SEE FORMAL ASSISTING DRAWINGS
83	83	ALBANY	ALBANY	SEE FORMAL ASSISTING DRAWINGS
84	84	ALBANY	ALBANY	SEE FORMAL ASSISTING DRAWINGS
85	85	ALBANY	ALBANY	SEE FORMAL ASSISTING DRAWINGS
86	86	ALBANY	ALBANY	SEE FORMAL ASSISTING DRAWINGS
87	87	ALBANY	ALBANY	SEE FORMAL ASSISTING DRAWINGS
88	88	ALBANY	ALBANY	SEE FORMAL ASSISTING DRAWINGS
89	89	ALBANY	ALBANY	SEE FORMAL ASSISTING DRAWINGS
90	90	ALBANY	ALBANY	SEE FORMAL ASSISTING DRAWINGS
91	91	ALBANY	ALBANY	SEE FORMAL ASSISTING DRAWINGS
92	92	ALBANY	ALBANY	SEE FORMAL ASSISTING DRAWINGS
93	93	ALBANY	ALBANY	SEE FORMAL ASSISTING DRAWINGS
94	94	ALBANY	ALBANY	SEE FORMAL ASSISTING DRAWINGS
95	95	ALBANY	ALBANY	SEE FORMAL ASSISTING DRAWINGS
96	96	ALBANY	ALBANY	SEE FORMAL ASSISTING DRAWINGS
97	97	ALBANY	ALBANY	SEE FORMAL ASSISTING DRAWINGS
98	98	ALBANY	ALBANY	SEE FORMAL ASSISTING DRAWINGS
99	99	ALBANY	ALBANY	SEE FORMAL ASSISTING DRAWINGS
100	100	ALBANY	ALBANY	SEE FORMAL ASSISTING DRAWINGS

