

**LEGEND**

- ⊕ Sanitary Sewer Manhole (Unless noted)
- ⊖ Sanitary Sewer Service Line Cleanout
- ⊕ Fire Hydrant
- ⊕ Water Valve
- ⊕ Curb Stop
- ⊕ Utility Pole
- ⊕ Electric Vault
- ⊕ Traffic Light
- ⊕ Telecommunications Vault
- ⊕ Sign
- Underground Electric
- Overhead Utility Line
- Underground Telecommunications Line
- Fiber Optic Line
- Sanitary Sewer Line
- Water Main
- Natural Gas Line
- ⊕ Found Survey Monument as noted
- ⊕ Set Rebar with cap marked "RW Psk 6385"
- ⊕ Control Point
- Drainage Arrow

**ENGINEER'S NOTES**

1. Install 5ft Fence at edge of major drainage easement and south boundary of site outfall as shown. Fence shall be maintained until vegetation is established.
2. Detention cell sized for current and possible future use.
3. Existing CMP Culvert to be rehabilitated with 45" band added to deflect drainage to detention cell as shown.
4. Install 150 SF of Class 2 Rip Rap at CMP outfall and pond outfall as shown.
5. Roof Drains at front of building are to be discharged into parking lot via sidewalk gutter drains. See Detail 61-4 of the Standard Specifications.
6. Roof Drains at back of building are to be discharged into the swale running east of the north side of the site.
7. All disturbed areas shall be seeded or sodded and mulched and watered in accordance with the City of Rapid Standard Specifications for Public Works Construction - 2004 Edition (as revised).

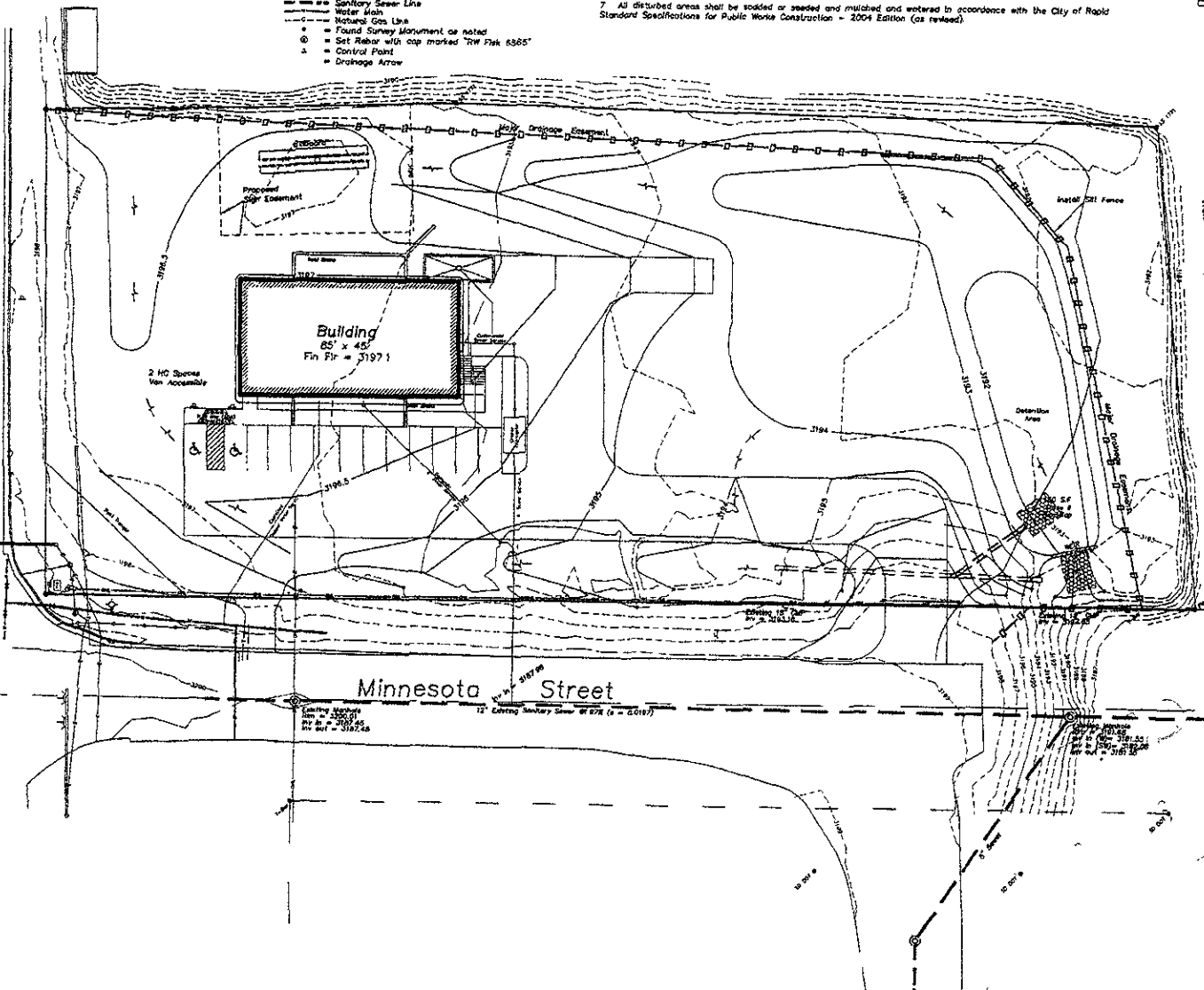
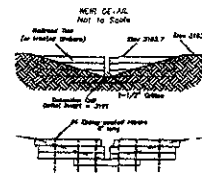
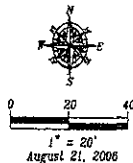

**GRADING & DRAINAGE PLAN**  
 Piedmont Processing  
 Lot A of Tract 2 of Kormyo Subdivision  
 SW 1/4 NW 1/4 Sec. 17, T1N, R8E, B.H.M.  
 Rapid City, Pennington County, South Dakota

**Fisk Land Surveying & Consulting Engineers, Inc.**  
 1023 4th Street  
 P.O. Box 818  
 Rapid City, South Dakota  
 57709  
 (605) 348-1538  
 (605) 341-1112 (fax)

Surveyed by BLM  
 Date: 8/15/06  
 Drawn by: RW  
 Date: 8/21/06  
 Checked by: WF  
 Revisions:

Project No.  
 06-06-06

Sheet  
 4  
 of  
 5