

06SR071

NOTE: HORIZONTAL AND VERTICAL LOCATIONS ARE APPROXIMATE THE CONTRACT SHALL CONFIRM HORIZONTAL AND VERTICAL LOCATIONS PRIOR TO ANY EXCAVATION

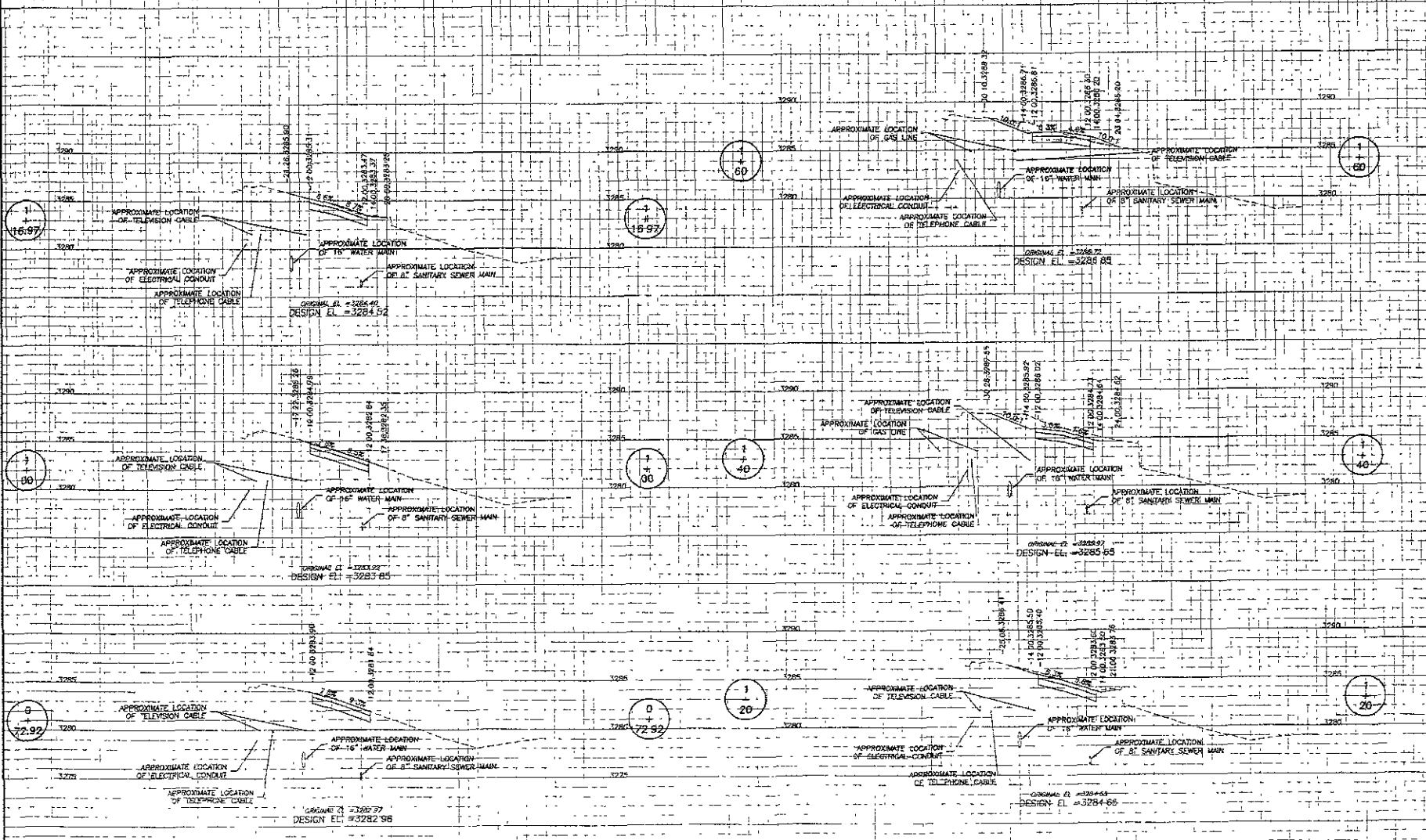

DREAM DESIGN INTERNATIONAL, INC.
 PROFESSIONAL STRUCTURAL & CIVIL ENGINEERING CONSULTANTS
 535 ALABAMA AVE. S.W. SUITE 1100 BLDG. 0201 S.W. 3RD AVE.
 FT. WORTH, TEXAS 76102 TEL: 817-535-1100 FAX: 817-535-1101

REV	NO.	DATE	DESCRIPTION
1	1	05-04-27	ISSUED FOR TC
2	2	05-10-10	FOR REVIEW
3	3	05-10-10	FOR REVIEW
4	4	05-05-05	FOR REVIEW

PRELIMINARY FOR REVIEW ONLY

SOCIAL SERVICES ROAD
 CROSS SECTIONS STA. 0+72.92 TO 1+60

06SR071

NOTE. HORIZONTAL AND VERTICAL LOCATIONS ARE APPROXIMATE THE CONTRACT SHALL CONFIRM HORIZONTAL AND VERTICAL LOCATIONS PRIOR TO ANY EXCAVATION

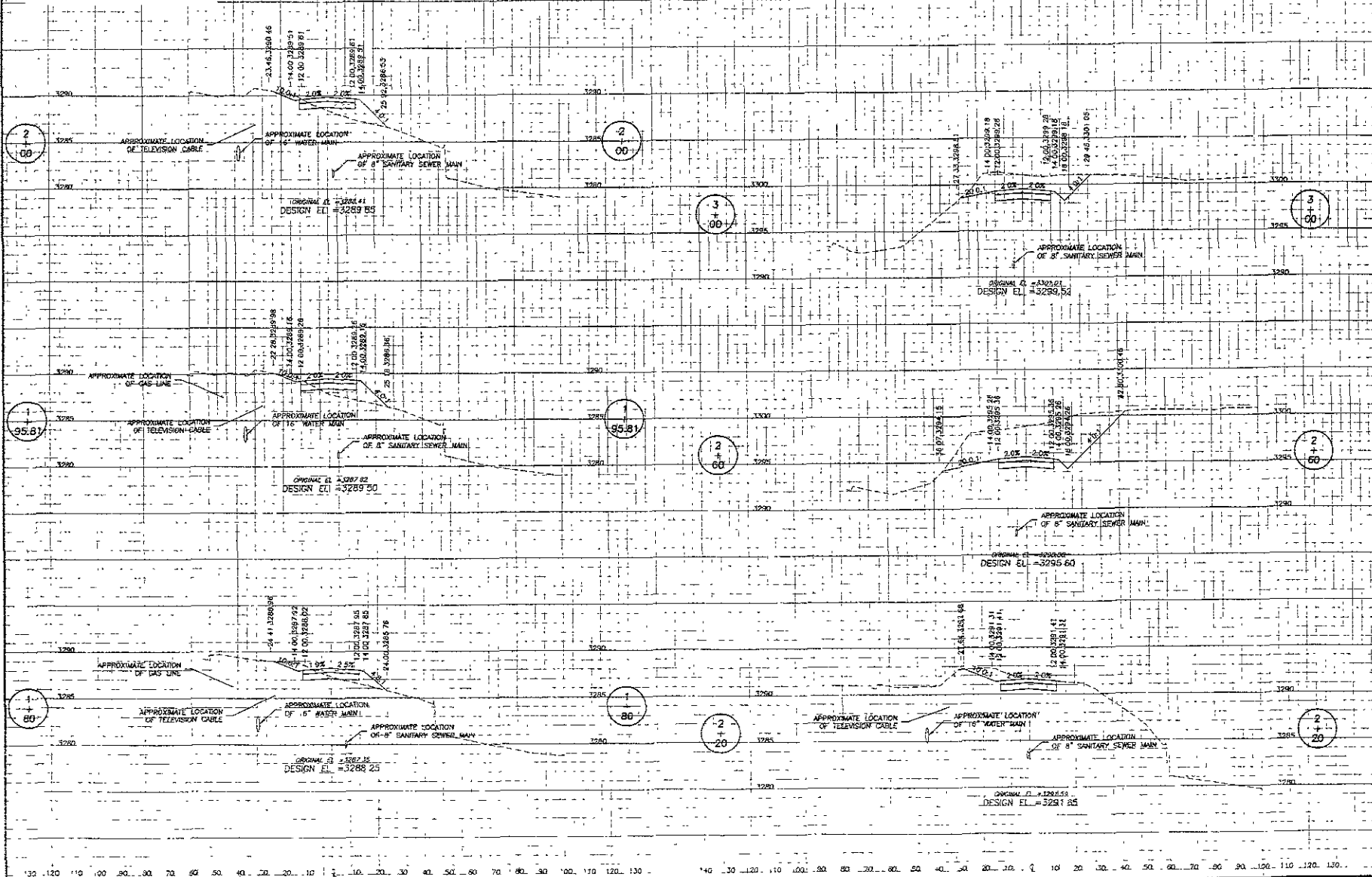

DREAM DESIGN INTERNATIONAL, INC.
 PROFESSIONAL STRUCTURAL & CIVIL ENGINEERING CONSULTANTS
 528 MANASSAS CITY ST. SUITE 4 MANASSAS CITY, VA 20108
 PH: 703-345-2530 FAX: 703-345-2545 EMAIL: info@dreamdesigninc.com

REV 1	PROJECT # 00-0477
REV 2	DESIGNED BY TC
REV 3	SKETCH DATE 10-11-06
REV 4	ADJUSTED BY TC
	REVISION BY: JAR/LEM
	DATE: 05-06

SOCIAL SERVICES ROAD
 CROSS SECTIONS STA 1+80 TO 3+00

PRELIMINARY FOR REVIEW ONLY

7 OF 9

06SR071

NOTE: HORIZONTAL AND VERTICAL LOCATIONS ARE APPROXIMATE. THE CONTRACTOR SHALL CONFIRM HORIZONTAL AND VERTICAL LOCATIONS PRIOR TO ANY EXCAVATION.

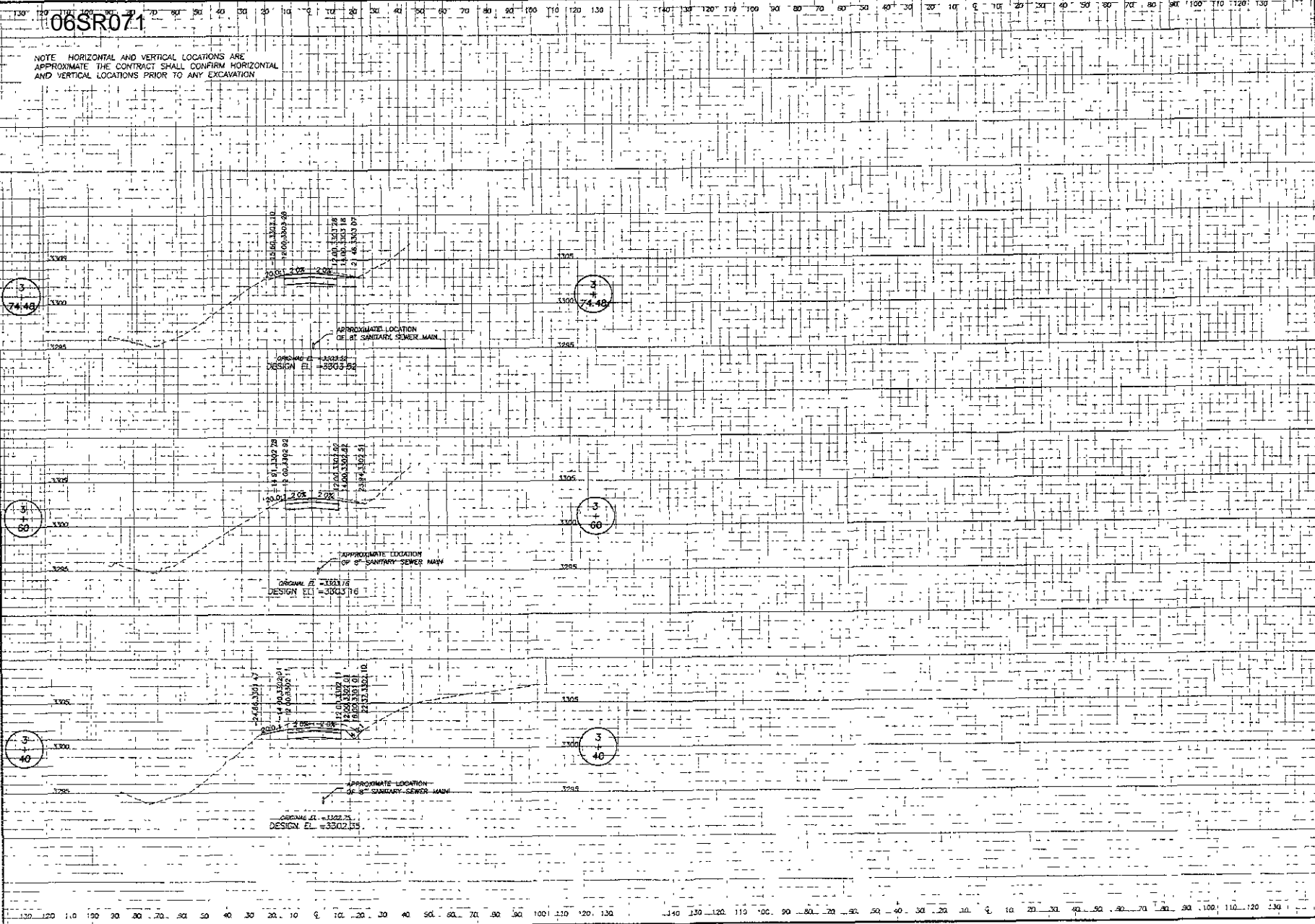

DREAM DESIGN INTERNATIONAL, INC.
 PROFESSIONAL STRUCTURAL & CIVIL ENGINEERING CONSULTANTS
 11100 242 1555 FAX: 11100 242 1546 www.dreamdesigninc.com

NO. 1
NO. 2
NO. 3
NO. 4

PROJECT: 10-0027
 DRAWN BY: TC
 DESIGN DATE: 10/11/06
 CHECKED BY: TC
 SURVEYED BY: ARLETH
 SURVEY DATE: 05/06

SOCIAL SERVICES ROAD
 PRELIMINARY FOR REVIEW ONLY
 CROSS SECTIONS STA. 3+40 TO 3+74.48