

06PD083

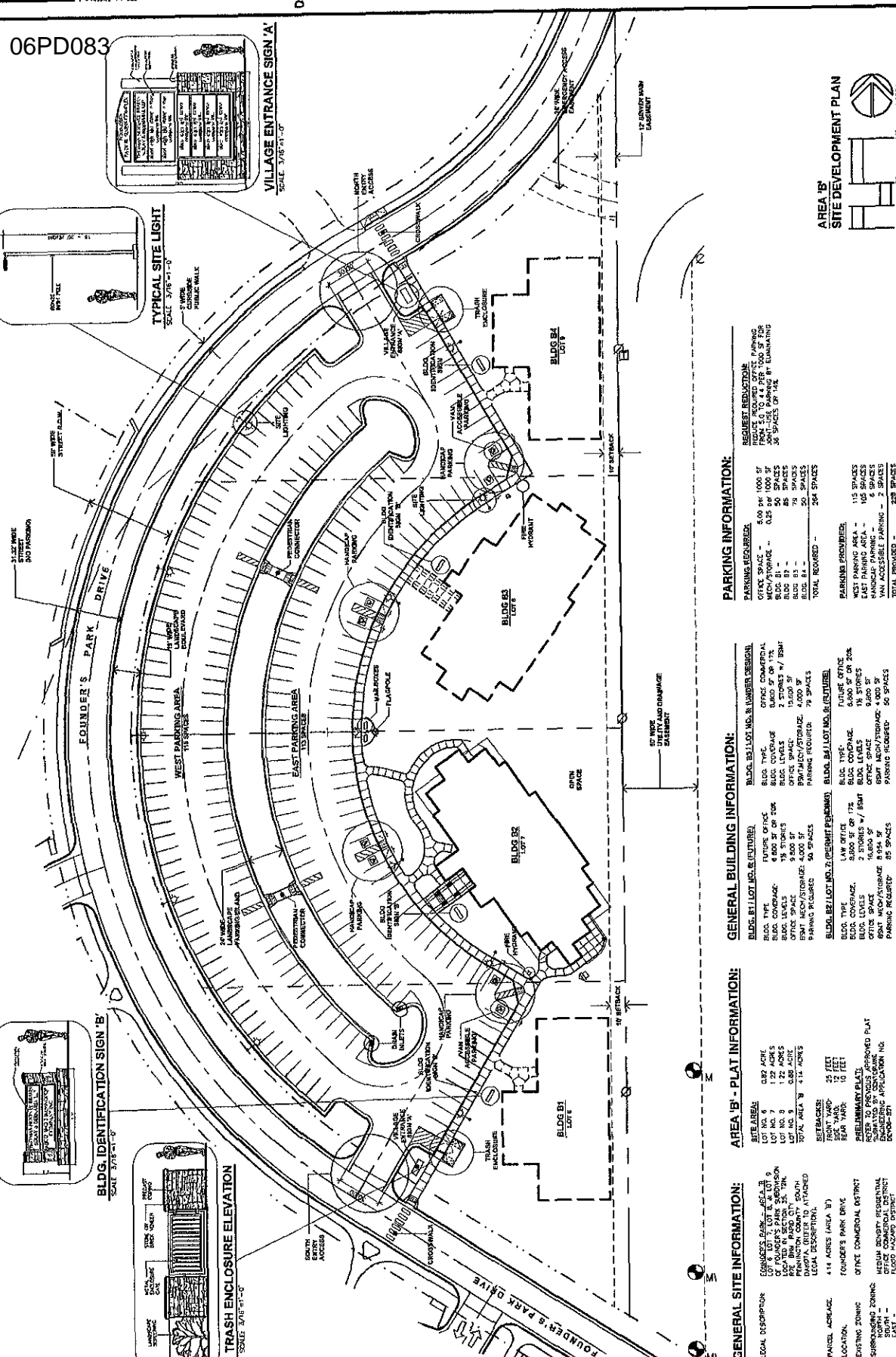
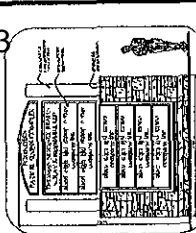
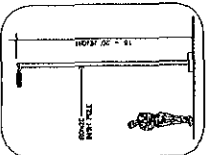
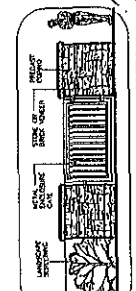
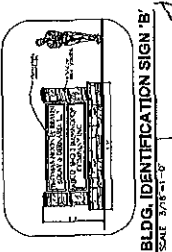

**PARKING INFORMATION:**

REQUIREMENT	REQUIREMENT	REQUIREMENT
PARKING REQUIRED:	REDUCE REQUIRED OFFICE PARKING	REDUCE REQUIRED OFFICE PARKING
BLDG. B1 - 1,000 SF	BLDG. B1 - 1,000 SF	BLDG. B1 - 1,000 SF
BLDG. B2 - 50 SPACES	BLDG. B2 - 50 SPACES	BLDG. B2 - 50 SPACES
BLDG. B3 - 50 SPACES	BLDG. B3 - 50 SPACES	BLDG. B3 - 50 SPACES
BLDG. B4 - 50 SPACES	BLDG. B4 - 50 SPACES	BLDG. B4 - 50 SPACES
TOTAL REQUIRED - 204 SPACES	TOTAL REQUIRED - 204 SPACES	TOTAL REQUIRED - 204 SPACES
PARKING PROVIDED:	PARKING PROVIDED:	PARKING PROVIDED:
WEST PARKING AREA - 115 SPACES	EAST PARKING AREA - 105 SPACES	MANAGING PARKING - 5 SPACES
TOTAL PROVIDED - 225 SPACES	TOTAL PROVIDED - 225 SPACES	TOTAL PROVIDED - 225 SPACES

**GENERAL BUILDING INFORMATION:**

BLDG. B1 (LOT NO. 6) (FUTURE)	BLDG. B2 (LOT NO. 7) (PERMIT PENDING)	BLDG. B3 (LOT NO. 8) (FUTURE)
BLDG. TYPE: OFFICE COMMERCIAL	BLDG. TYPE: LAW OFFICE	BLDG. TYPE: FUTURE OFFICE
BLDG. COVERAGE: 4,800 SF OR 7%	BLDG. COVERAGE: 5,800 SF OR 7%	BLDG. COVERAGE: 6,800 SF OR 20%
OFFICE SPACE: 2,500 SF	OFFICE SPACE: 2,500 SF	OFFICE SPACE: 14 STORIES
FRONT MECH./STORAGE: 4,000 SF	FRONT MECH./STORAGE: 4,000 SF	FRONT MECH./STORAGE: 4,000 SF
PARKING REQUIRED: 79 SPACES	PARKING REQUIRED: 79 SPACES	PARKING REQUIRED: 50 SPACES

**GENERAL SITE INFORMATION:**

GENERAL SITE INFORMATION:	AREA 'B' - PLAT INFORMATION:
LEGAL DESCRIPTION: 4.14 ACRES (AREA 'B')	SITE AREA: 0.82 ACRE
LOCATION: FOUNDER'S PARK DRIVE	LOT NO. 9: 0.82 ACRE
EXISTING ZONING: OFFICE COMMERCIAL DISTRICT	LOT NO. 8: 1.22 ACRES
SHRIMPING ZONING: OFFICE COMMERCIAL DISTRICT	LOT NO. 7: 0.88 ACRE
SETBACKS: FRONT YARD - 25 FEET	TOTAL AREA 'B': 4.14 ACRES
REAR YARD - 10 FEET	PERCENTAGE COVERED: 17.1%
SIDE YARD - 10 FEET	PERCENTAGE OPEN: 82.9%
PERMITTED PLAT: SUBMITTED BY PERKINS+WILL	PERMITTED PLAT: SUBMITTED BY PERKINS+WILL
PERMITTED PLAT: SUBMITTED BY PERKINS+WILL	PERMITTED PLAT: SUBMITTED BY PERKINS+WILL
PERMITTED PLAT: SUBMITTED BY PERKINS+WILL	PERMITTED PLAT: SUBMITTED BY PERKINS+WILL

