



Physical Works, Inc.
 206 West 10th St.
 Rapid City, SD 57701
 Phone: 605-342-5555
 Fax: 605-342-5556
 www.physicalworks.com

AREA 'B'
 FINAL
 PLANNED
 DEVELOPMENT
 SUBMITTAL
 SEPT 29, 2006

GRADING PLAN - AREA 'B'
 VILLAGE AT FOUNDERS PARK
 RAPID CITY, SOUTH DAKOTA

Project No. 0622745
 File Name: 13-06-06.dwg
 Drawn By: JLS
 Checked By: JLS
 Date: 09-29-06
 Project: Founders Park

This drawing is prepared by Physical Works, Inc. and is the property of Physical Works, Inc. It is to be used only for the project and site described herein. It is not to be used for any other project or site without the written consent of Physical Works, Inc.

3.2

06PD083

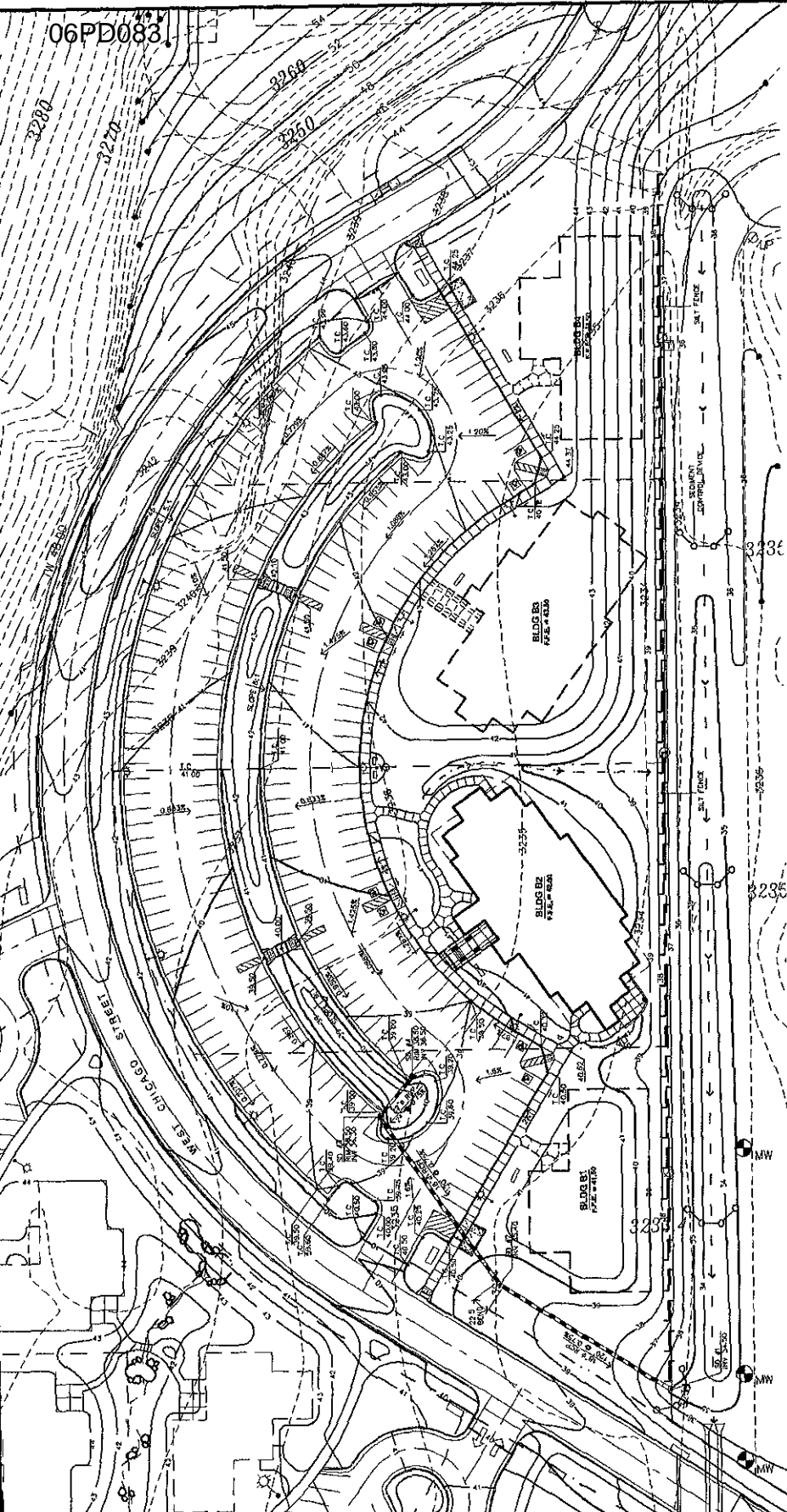

- GRADING LEGEND:**
- ◆ BENCH MARK ELEVATION
 - PROPOSED CONTOUR
 - EXISTING CONTOUR
 - DRAINAGE SWALE
 - TOP OF CURB ELEVATION
 - HIGH POINT ELEVATION
 - TOP OF WALL ELEVATION
 - BOTTOM OF WALL ELEVATION
 - SPOT ELEVATION
 - SET FENCE
 - SEGMENT CONTROL DEVICE

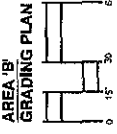

DRAINAGE PLAN:

- REFER TO PREVIOUS APPROVED DRAINAGE PLAN TO CORRELATE WITH THIS PLAN. SEE PERMIT APPLICATION NO. 06V06-021 FOR FURTHER DETAILS.

EROSION CONTROL:

- SEE EROSION CONTROL PLAN FOR ALL EROSION CONTROL MEASURES TO BE INSTALLED AND MAINTAINED THROUGHOUT CONSTRUCTION AND PERMANENT EROSION CONTROL MEASURES TO BE INSTALLED AT THE END OF CONSTRUCTION.
- SEE EROSION CONTROL PLAN FOR ALL EROSION CONTROL MEASURES TO BE INSTALLED AND MAINTAINED THROUGHOUT CONSTRUCTION AND PERMANENT EROSION CONTROL MEASURES TO BE INSTALLED AT THE END OF CONSTRUCTION.
- SEE EROSION CONTROL PLAN FOR ALL EROSION CONTROL MEASURES TO BE INSTALLED AND MAINTAINED THROUGHOUT CONSTRUCTION AND PERMANENT EROSION CONTROL MEASURES TO BE INSTALLED AT THE END OF CONSTRUCTION.

GRADING NOTES:

- VERIFY ALL ELEVATIONS AND SPOT ELEVATIONS WITH THE CITY OF RAPID CITY RECORD DRAWINGS. CORRECT ANY DISCREPANCIES IMMEDIATELY.
- SEE EROSION CONTROL PLAN FOR ALL EROSION CONTROL MEASURES TO BE INSTALLED AND MAINTAINED THROUGHOUT CONSTRUCTION AND PERMANENT EROSION CONTROL MEASURES TO BE INSTALLED AT THE END OF CONSTRUCTION.
- SEE EROSION CONTROL PLAN FOR ALL EROSION CONTROL MEASURES TO BE INSTALLED AND MAINTAINED THROUGHOUT CONSTRUCTION AND PERMANENT EROSION CONTROL MEASURES TO BE INSTALLED AT THE END OF CONSTRUCTION.
- SEE EROSION CONTROL PLAN FOR ALL EROSION CONTROL MEASURES TO BE INSTALLED AND MAINTAINED THROUGHOUT CONSTRUCTION AND PERMANENT EROSION CONTROL MEASURES TO BE INSTALLED AT THE END OF CONSTRUCTION.
- SEE EROSION CONTROL PLAN FOR ALL EROSION CONTROL MEASURES TO BE INSTALLED AND MAINTAINED THROUGHOUT CONSTRUCTION AND PERMANENT EROSION CONTROL MEASURES TO BE INSTALLED AT THE END OF CONSTRUCTION.