

**RAPID CITY AREA
SCHOOL DISTRICT 51/4**
South Middle School
2 Indiana Street
Rapid City, South Dakota 57701



July 28, 2006

Notice of SDCL 11-6-19 Review to Construct a Sign at South Middle School

To Neighbors of South Middle School,

The Rapid City Area School District is proposing to construct a sign for South Middle School along the north side of Indiana Street.

The sign is proposed to be 8' tall, which will include a 4' x 8' sign face. The lighted sign face is double sided with a lexan face. Approximately two feet of the bottom of the sign face is proposed to be a Daktronics electronic message center. The lower 4' of the sign pole will be aluminum or brick monument and approximately 3' wide.

In particular, the message board will announce school activities, special events, school closings, parent-teacher conferences, and other school related information. No other use of the sign will be allowed. We will limit the hours of operation, level of illumination, and duration of changing messages to minimize any impact on the traveling public and the adjacent properties.

We believe this sign will enhance our communication with our school community and be a benefit to people of south Rapid City over many years. South Middle School has been an integral part of south Rapid City in the past and we want to continue to be a positive influence as we head into the future. We also want to be a good neighbor and let you know of our intentions with this sign.

We encourage you to call Larry Stevens, principal, at 394-4024, or Mike Kenton, Support Services Director, at 394-4105, with any comments or questions you might have concerning this issue before August 9, 2006.

Respectfully,

Larry Stevens
Principal

06SR059

Double sided
lighted sign - lexan face

8'

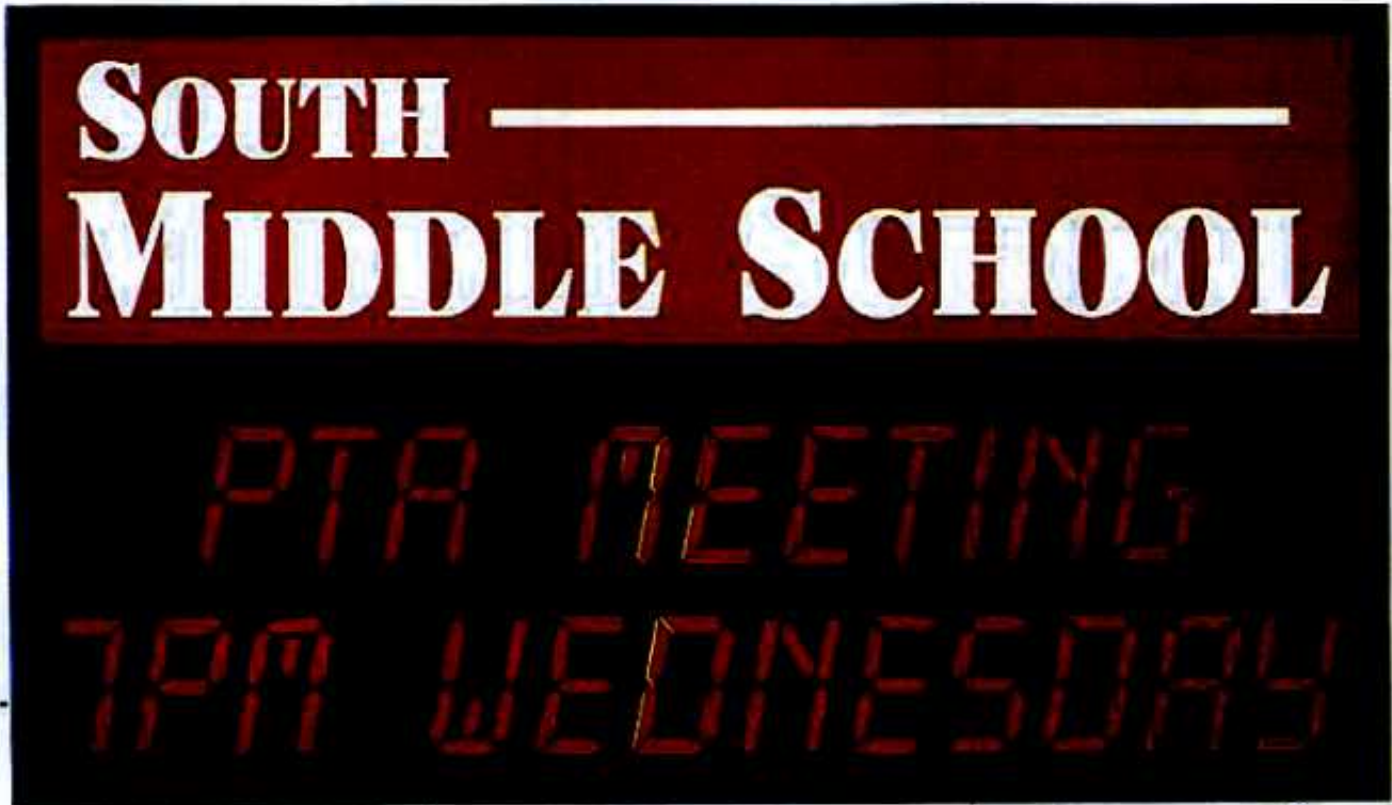

4'

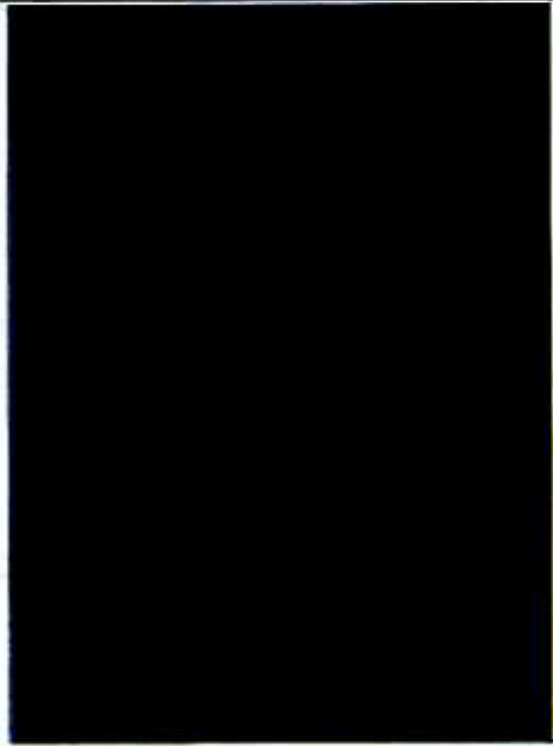

Pole Cover
Aluminum or
brick monument

↑
Electronic
message center
(Elektronics)

4'

RECEIVED

06SR059

SOUTH MIDDLE SCHOOL

SHUTTLE PARK ASSOCIATION
SUBDIVISION SECTION 13, T1N, R15E, S12M, 13.12 ACRES

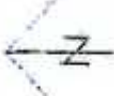

REC

SCALE 1" = 100'

APR

Rapid City
Municipality

OAK AVENUE

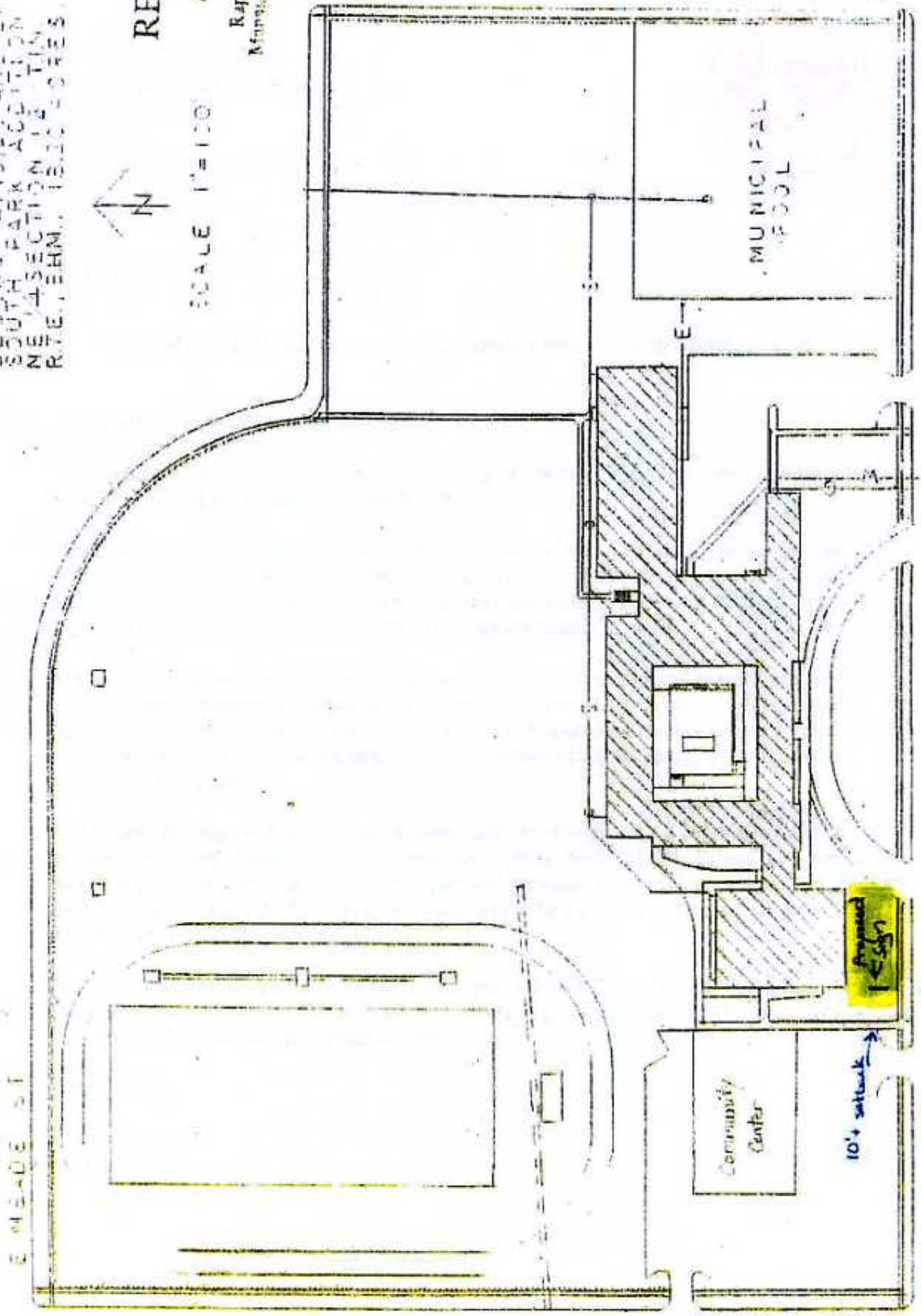

Community Center

MUNICIPAL POOL

10' setback

Proposed
1' x 5' x 10'

10' setback

OAK AVENUE

MAPLE AVENUE