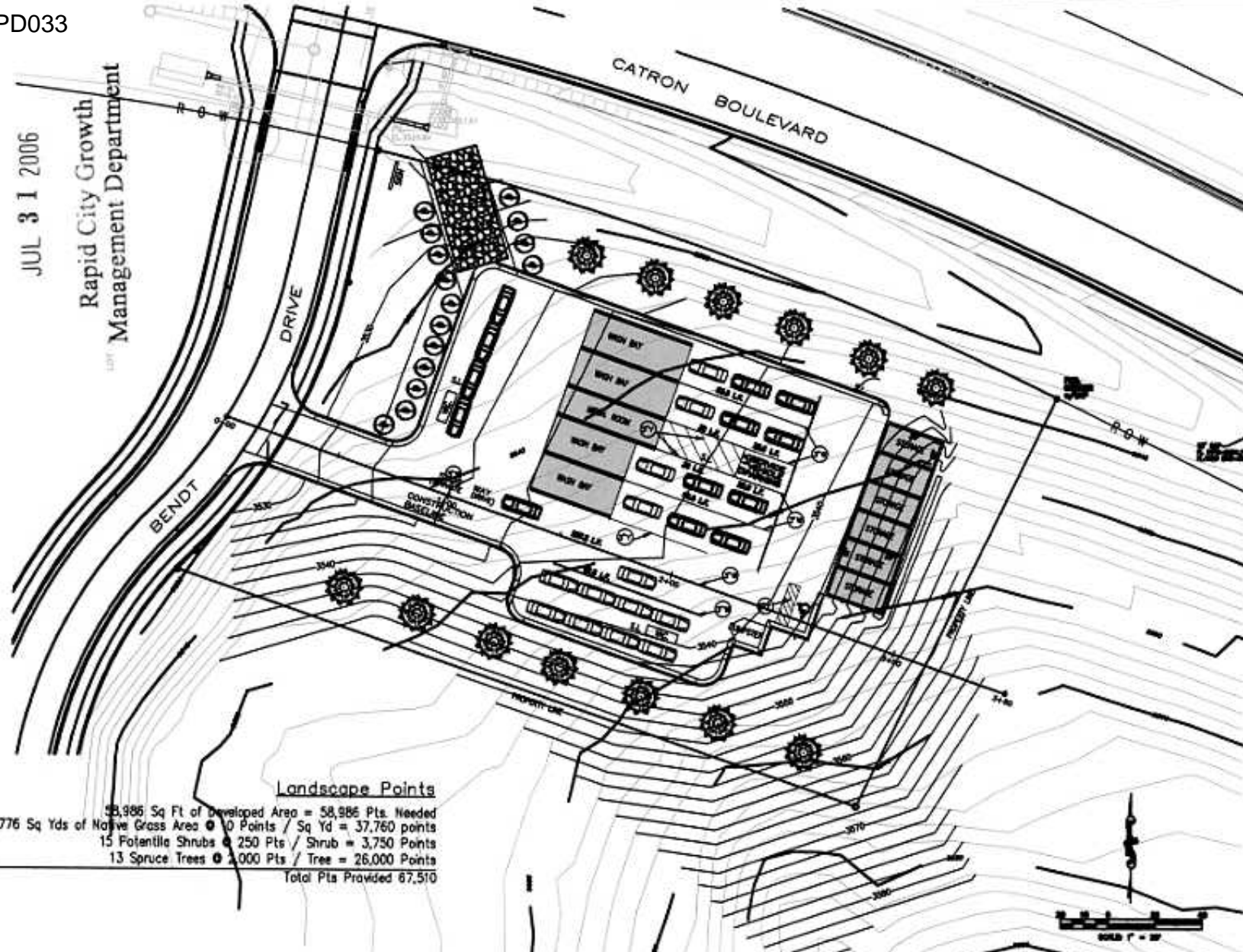

RECEIVED

JUL 31 2006

Rapid City Growth
Management DepartmentLandscape Points

58,986 Sq Ft of Developed Area = 58,986 Pts. Needed
 3,776 Sq Yds of Native Grass Area @ 10 Points / Sq Yd = 37,760 points
 15 Potentilla Shrubs @ 250 Pts / Shrub = 3,750 Points
 13 Spruce Trees @ 2,000 Pts / Tree = 26,000 Points
 Total Pts Provided 67,510

STONE CREEK SOUTH
The AUTO SPA PCD
PARKING, STRIPING &
LANDSCAPE PLAN

SHEET

1

OF

DATE: 04.03.06
 DRAWN BY: [Signature]
 CHECKED BY: [Signature]
 PROJECT: 05-0086

Boschee Engineering
 520 Kansas City Street, Suite 307
 Rapid City, South Dakota, 57701
 (605) 942-8747
 www.boschee-engineering.com