

BASIS OF ESTIMATE

- TOPSOIL REMOVAL (P-152) - STRIP - OVER ALL EXCAVATION OR EMBANKMENT AREAS (INCLUDED IN UNCLASSIFIED EXCAVATION QUANTITY FOR PAYMENT)
- MATERIAL (P-152) - 10 C.Y./CY EXCAVATION/EMBANKMENT
20 C.Y./CY AGGREGATE BASE
- EMBANKMENT (P-152) - 30% ADDITIONAL VOLUME HAS BEEN ADDED FOR SHRINKAGE
- SODDIT GRAVEL SURFACING (SDDOT SPEC 882.2) - COMPACTED VOLUME IN PLACE
- CRUSHED AGGREGATE BASE COURSE (P-209) - COMPACTED VOLUME IN PLACE
- POROUS MATERIAL NO. 1 (D-705) - 0.60 C.Y./LF (FOR SUBDRAIN)
- TOPSOIL REPLACEMENT (P-905) - MEASURED IN STOCKPILES BY AVERAGE END AREAS OR PRISMATICAL METHOD (PAID FOR AS TOPSOILING)
- LOOSE ROCK (RRRPR CL-55 - (P-920) - VOLUME IN PLACE

- 1
- 2
- 3
- 4
- 5
- 6
- 7
- 8
- 9

- INSTALL CHAIN LINK FENCE
- REMOVE EXISTING FENCE
- INSTALL BARBED WIRE FENCE
- CONSTRUCT TEMPORARY T-RAMP FOR U.S. FOREST SERVICE ACCESS
- INSTALL STORM SEWER
- CONSTRUCT PARALLEL T-RAMP WITH A SURCHARGE GRADING
- CONSTRUCT ACCESS ROADS
- RELOCATE LIGHTED WINDSOOE
- REPLACE EARTH EMBANKMENT

NO	DESCRIPTION	LOCATION	ELEVATION
JACK CAP D	PROBABLY CONTAINING OIL (FUEL/AVIATION)	STATION 11+22.72 TO 11+22.72 STA. 11+42.14 TO 11+42.14	3160.93
JACK CAP E	PROBABLY CONTAINING OIL (FUEL/AVIATION)	STATION 11+22.72 TO 11+22.72 STATION 11+42.14 TO 11+42.14	3169.35
AP STA 1	TOPSOIL REMOVAL	STATION 11+22.72 TO 11+22.72 STATION 11+42.14 TO 11+42.14	3180.91
PP-52	3" ALUMINUM CAP	STATION 11+22.72 TO 11+22.72 STATION 11+42.14 TO 11+42.14	3172.44
USDA CAP	CAP	STATION 11+22.72 TO 11+22.72 STATION 11+42.14 TO 11+42.14	3149.96
EM1 (SURVEY+4)		STATION 11+22.72 TO 11+22.72 STATION 11+42.14 TO 11+42.14	3139.96
EM2		STATION 11+22.72 TO 11+22.72 STATION 11+42.14 TO 11+42.14	3160.53
142ND CAP	CAP	STATION 11+22.72 TO 11+22.72 STATION 11+42.14 TO 11+42.14	3191.30
REBAR CAP	CAP	STATION 11+22.72 TO 11+22.72 STATION 11+42.14 TO 11+42.14	3177.95
32ND CAP	CAP	STATION 11+22.72 TO 11+22.72 STATION 11+42.14 TO 11+42.14	3142.00
SEMO	RM "MIL"	STATION 11+22.72 TO 11+22.72 STATION 11+42.14 TO 11+42.14	3173.26
CP2	REBAR	STATION 11+22.72 TO 11+22.72 STATION 11+42.14 TO 11+42.14	3146.00
CP10	REBAR	STATION 11+22.72 TO 11+22.72 STATION 11+42.14 TO 11+42.14	3153.91
CP13	REBAR	STATION 11+22.72 TO 11+22.72 STATION 11+42.14 TO 11+42.14	3152.72
CP14	REBAR	STATION 11+22.72 TO 11+22.72 STATION 11+42.14 TO 11+42.14	3129.96
CP15	REBAR	STATION 11+22.72 TO 11+22.72 STATION 11+42.14 TO 11+42.14	3091.10
CP17	REBAR	STATION 11+22.72 TO 11+22.72 STATION 11+42.14 TO 11+42.14	3153.91

06SR010

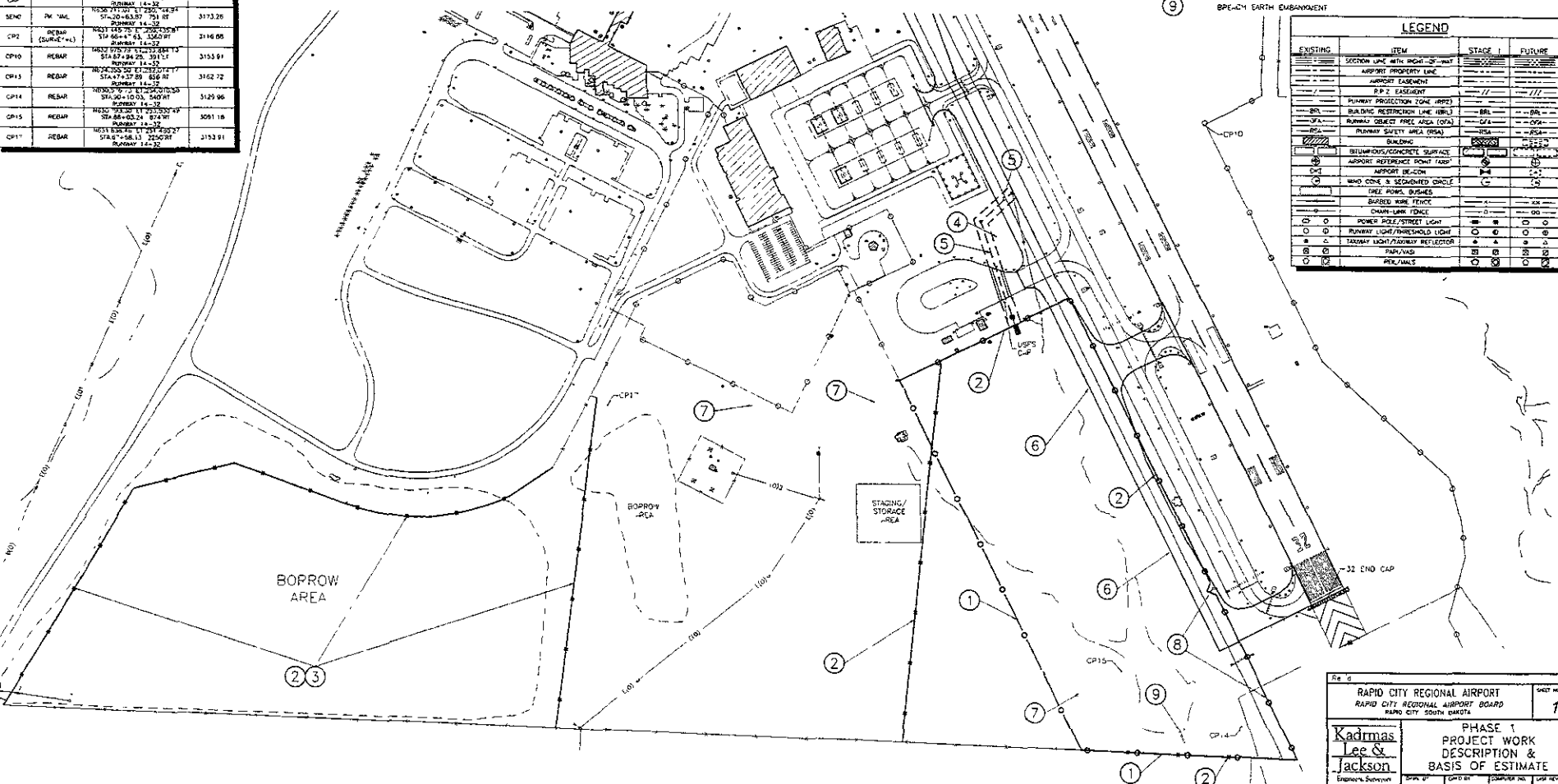
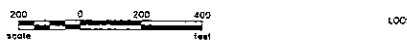

LEGEND			
EXISTING	ITEM	STAGE 1	FUTURE
---	SECTION LINE WITH RIGHT-OF-WAY	---	---
---	AIRPORT PROPERTY LINE	---	---
---	AIRPORT EASEMENT	---	---
---	E.P.P. EASEMENT	---	---
---	PLUNNEY PROJECTION LINE (RFB)	---	---
---	BUILDING RESTRICTION LINE (RBL)	---	---
---	BURNING OBJECT FREE AREA (OFA)	---	---
---	PLUNNEY SAFETY AREA (PSA)	---	---
---	BUILDING	---	---
---	BELOW-GRADE/CONCRETE SURFACE	---	---
---	AIRPORT REFERENCE POINT (ARP)	---	---
---	AIRPORT SECTION	---	---
---	WIND CONE & DESIGNATED CIRCLE	---	---
---	DRY POND, BUSHES	---	---
---	BARBED WIRE FENCE	---	---
---	CHAIN-LINK FENCE	---	---
---	POWER POLE/STREET LIGHT	---	---
---	RUNWAY LIGHT/TAXIWAY LIGHT	---	---
---	TAXIWAY LIGHT/TAXIWAY REFLECTOR	---	---
---	PARKING	---	---
---	POLE/VALVE	---	---

R-10
 RAPID CITY REGIONAL AIRPORT
 RAPID CITY REGIONAL AIRPORT BOARD
 RAPID CITY SOUTH DAKOTA
 SHEET NO. 1
Kadmas Lee & Jackson
 ENGINEERS, SURVEYORS AND PLANNERS
 10531 100th Street, Rapid City, SD 57701
 (605) 343-1000
 PROJECT NO. 1053100
 DATE: 07/25/2004