

06SR009

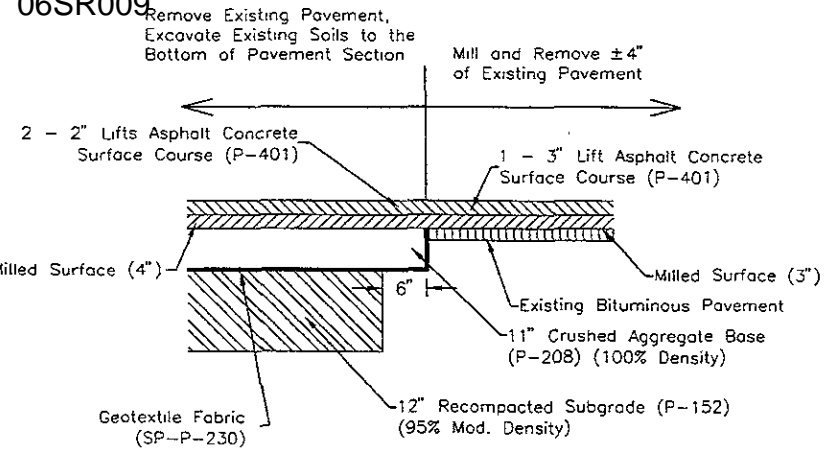

TRANSITION DETAIL
STA. 22+50 RUNWAY AND TAXIWAY

NO SCALE

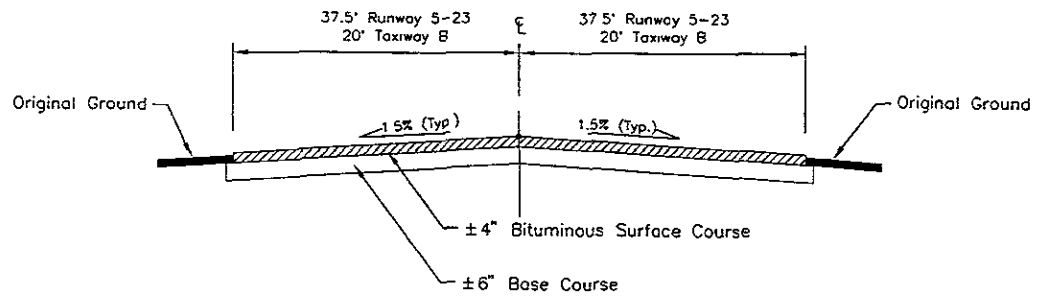

EXISTING PAVEMENT SECTION

NO SCALE

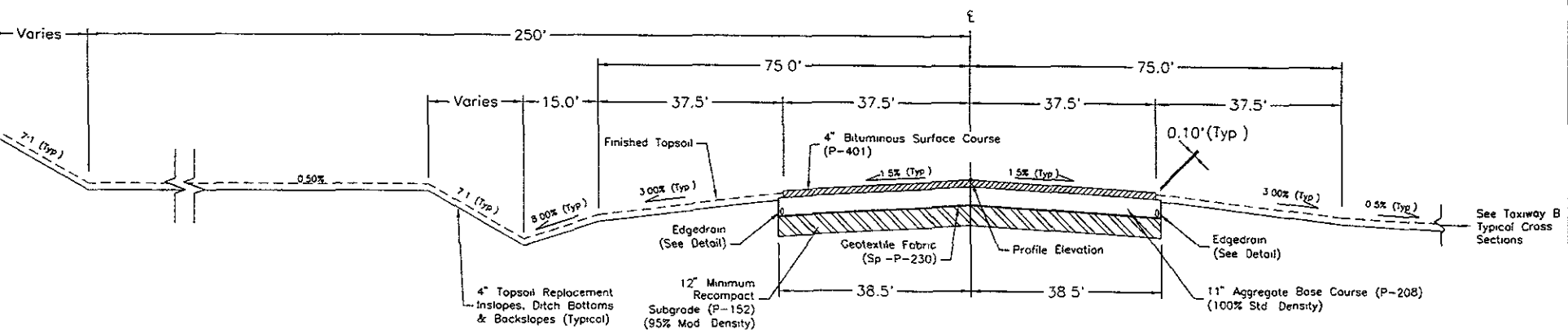

RUNWAY 5-23 TYPICAL SECTION
STA. 22+50 TO STA. 48+49.33

NO SCALE

Rev'd	3/3/2004	SHEET NO.	5
RAPID CITY REGIONAL AIRPORT RAPID CITY REGIONAL AIRPORT BOARD RAPID CITY, SOUTH DAKOTA			
Kadmas Lee & Jackson		RUNWAY 5/23 TYPICAL CROSS SECTIONS	
DATE OF DESIGN	DATE OF CONSTRUCTION	PROJECT NO.	DATE
05	10/06/2011	10502011	2/16/2004
J:\kadrmas\10502011\1146_Construction\10502011_rtc.dwg			

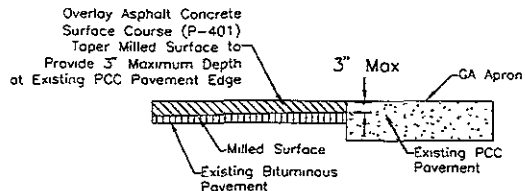

NEW BITUMINOUS TO EXISTING PCC PAVEMENT DETAIL
STA 20+90 RUNWAY 5/23 AND TAXIWAY B

NO SCALE

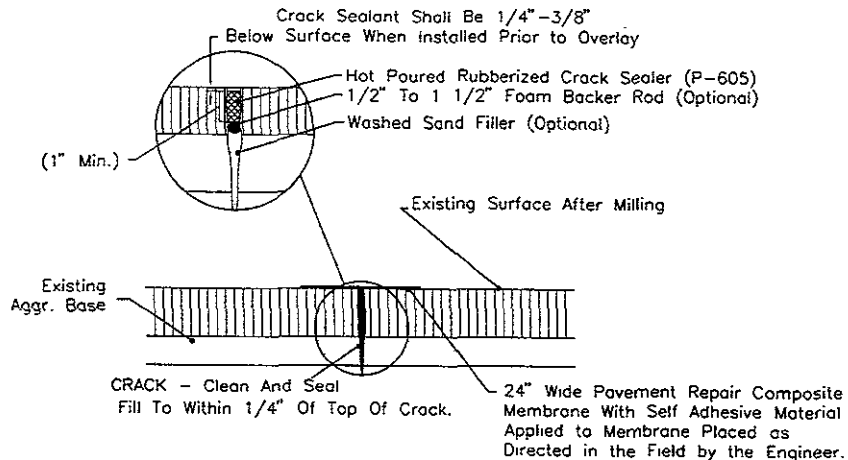

CRACK REPAIR DETAIL

NO SCALE

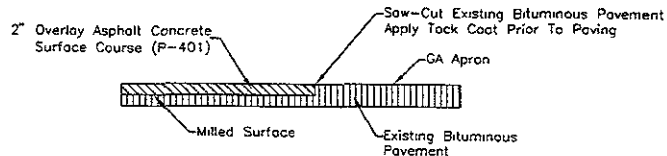

EXISTING TO NEW BITUMINOUS PAVEMENT DETAIL
TAXIWAY B AT GA APRON

SEE NOTE NOTE 1

NO SCALE

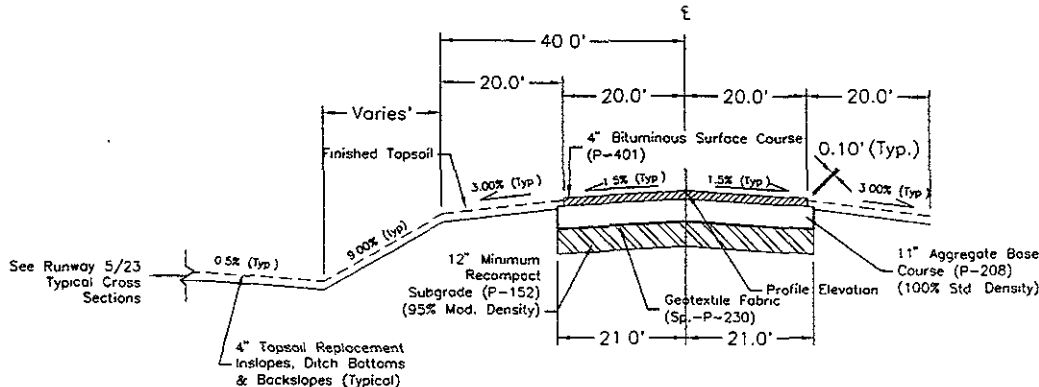

TAXIWAY B TYPICAL SECTION
STA. 22+50 TO STA. 48+49.33

NO SCALE

NOTE 1
 MILL ±2" OF EXISTING BITUMINOUS PAVEMENT AT THE FOLLOWING LOCATIONS:
 STA 12+49.33 TO 16+98.25, 37.5' LT & RT, RUNWAY STATIONING
 STA 10+86.3 TO 16+47.0, 20' LT & RT, TAXIWAY STATIONING
 MATCH GA APRON AT
 STA 12+54.4, 64' RT, N = 636490.66, E = 1250813.62, TAXIWAY STATIONING
 STA 12+85.7, 112.3' RT, N = 636415.25, E = 1250851.07, TAXIWAY STATIONING
 STA 13+14.0, 70.8' RT, N = 636449.21, E = 1250919.81, TAXIWAY STATIONING

MILL ±4" OF EXISTING BITUMINOUS PAVEMENT AT THE FOLLOWING LOCATIONS:
 STA 20+90 TO 22+50, 37.5' LT & RT, RUNWAY STATIONING
 STA 20+90 TO 22+50, 20' LT & RT, TAXIWAY STATIONING

Rev'd 3/2/2004		RAPID CITY REGIONAL AIRPORT		Sheet No.
		RAPID CITY REGIONAL AIRPORT BOARD		6
		RAPID CITY, SOUTH DAKOTA		
Kadmas Lee & Jackson		TAXIWAY B TYPICAL CROSS SECTIONS		
Engineer, Subgrader and Planner	DRW BY JL	CHECK BY TC	ISSUED FOR 10502011	DATE 2/16/2004
C:\Users\j1062011\My Documents\10502011.dwg				

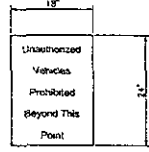
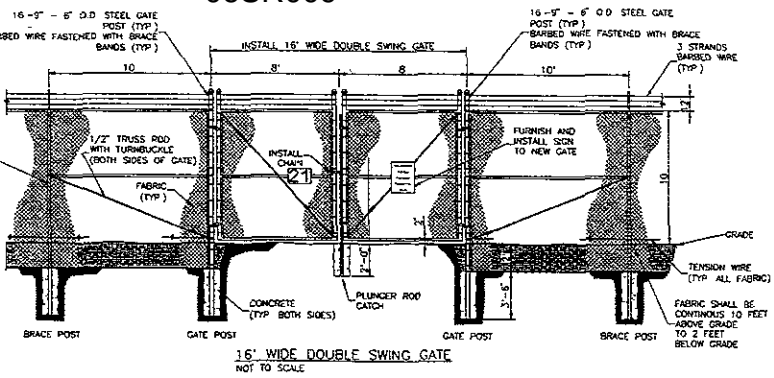

GATE SIGN
BLACK LETTERS ON WHITE BACKGROUND
NOT TO SCALE



GATE SIGN
BLACK LETTERS ON WHITE BACKGROUND
NOT TO SCALE

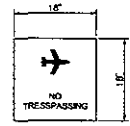

FENCE SIGN
BLACK LETTERS ON WHITE BACKGROUND
NOT TO SCALE

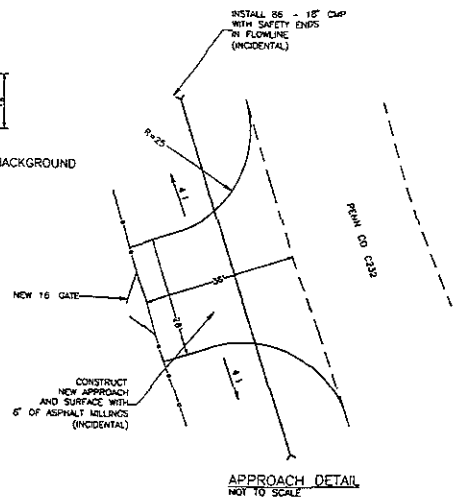

APPROACH DETAIL
NOT TO SCALE

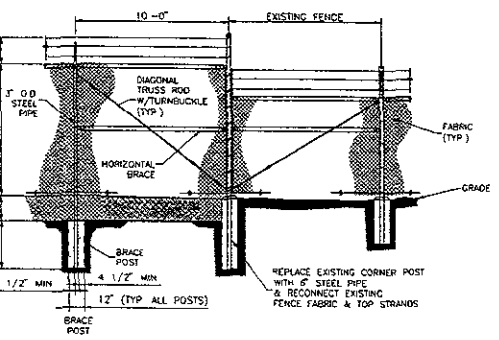
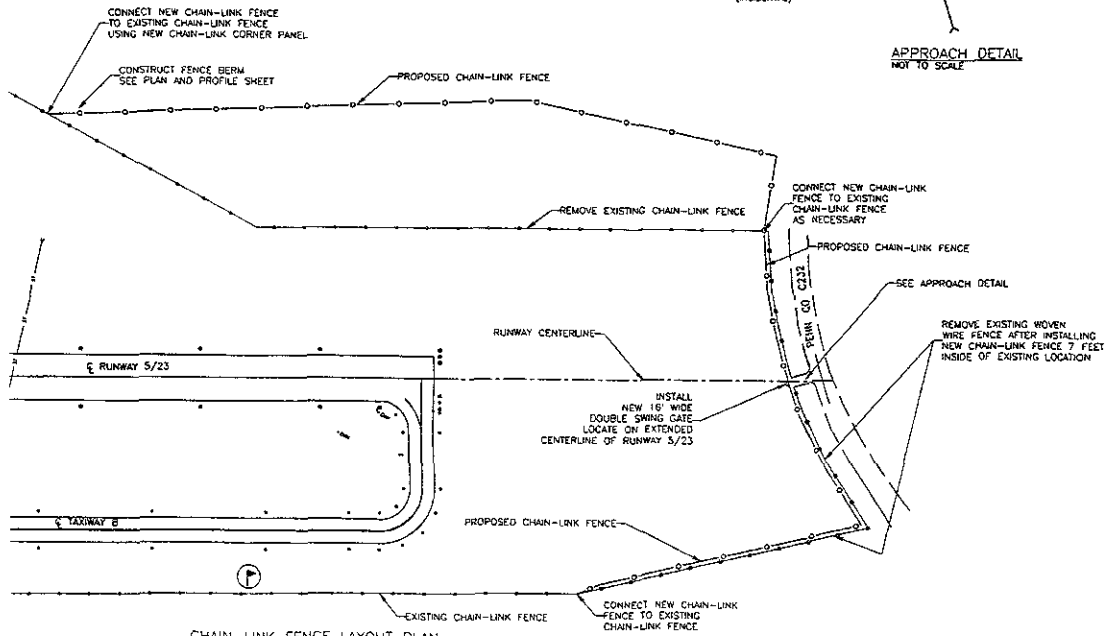
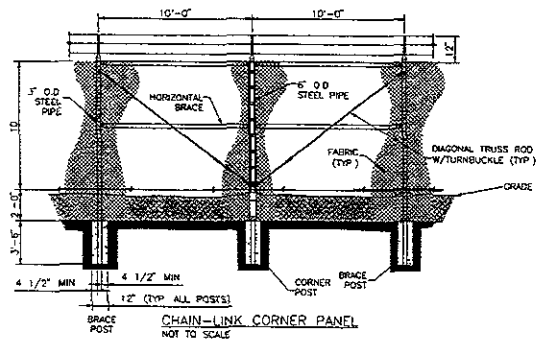

TIE TO EXISTING CHAIN-LINK CORNER PANEL
NOT TO SCALE

NOTES

- EXISTING WOVEN WIRE FENCE SHALL BE REMOVED AND STOCK PILED AT A LOCATION DESIGNATED BY AIRPORT MANAGEMENT AND SHALL BECOME THE PROPERTY OF THE CONTRACTOR TO BE REMOVED FROM AIRPORT PROPERTY
- EXISTING WOVEN WIRE FENCE SHALL REMAIN IN PLACE UNTIL NEW FENCE AND GATE IS COMPLETE
- EXISTING SIGNS SHALL BE SALVAGED FOR USE ON THE NEW FENCE
- A TREATED WOOD THRESHOLD SHALL BE INSTALLED BETWEEN BOTH GATE SUPPORT POSTS AND THE PLUNGER ROD CATCH

Rev. 0		sheet no.	8
RAPID CITY REGIONAL AIRPORT RAPID CITY REGIONAL AIRPORT BOARD RAPID CITY, SOUTH DAKOTA			
Kadmas Lee & Jackson		FENCING PLAN & DETAILS	
Engineer, Structural	Checked by	Drawn by	Date
201 Return	MS	TC	10/02/01 2/16/2004
C:\p0001\10502011\A_Construction\10502011.dwg			

RUNWAY 5-23 & TAXWAY "B" INTERSECTION
 RUNWAY 5-23 STA. 12+49.34
 TAXWAY "B" STA. 10+49.00
 N = 636719.68 E = 1250782.93

BECH. RUNWAY 5-23 ASPHALT PAVEMENT
 STA. 12+49.33 CENTERLINE
 N = 636719.68 E = 1250782.93

MATCH TAXWAY "A" ASPHALT
 STA. 16+96.26 CENTERLINE
 N = 635908.60 E = 1251149.18

RUNWAY 5-23 & RUNWAY 14-32 INTERSECTION
 RUNWAY 5-23 STA. 20+00.00
 RUNWAY 14-32 STA. 54+37.20
 N = 637083.22 E = 1251418.19

MATCH RUNWAY 14-32 PCC PAVEMENT
 STA. 20+30.0 CENTERLINE
 N = 637083.22 E = 1251498.88

INSTALL WOOD EXCELSIOR FIBER MAT
 STA. 28+50 TO 35+00 LT - 867.5 Y

INSTALL EDGEWALKER OUTLETS & END SECTIONS
 STA. 22+55 RT - 1 EA.
 STA. 22+55 LT - 1 EA.
 STA. 28+55 RT - 1 EA.
 STA. 28+55 LT - 1 EA.
 STA. 33+50 RT - 1 EA.
 STA. 33+50 LT - 1 EA.

INSTALL EDGEWALKER OUTLET (PCC 4" INCH)
 STA. 22+55 194.5 RT TO 25+26 38.5 RT - 170 LF
 STA. 28+55 36.5 RT TO 28+55 77.0 RT - 38.5 LF
 STA. 33+50 38.5 RT TO 33+50 77.0 RT - 38.5 LF
 STA. 22+55 86.5 LT TO 23+06 38.5 LT - 74 LF
 STA. 28+55 38.5 LT TO 28+55 77.0 LT - 38.5 LF
 STA. 33+50 38.5 LT TO 33+50 77.0 LT - 38.5 LF

INSTALL EDGEWALKER CLEANOUTS
 STA. 23+23 RT - 1 EA.
 STA. 23+09 LT - 1 EA.
 STA. 28+55 RT & LT - 1 EA. SDC

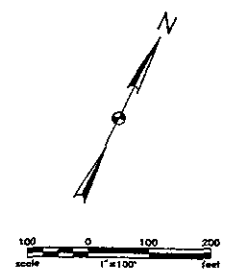
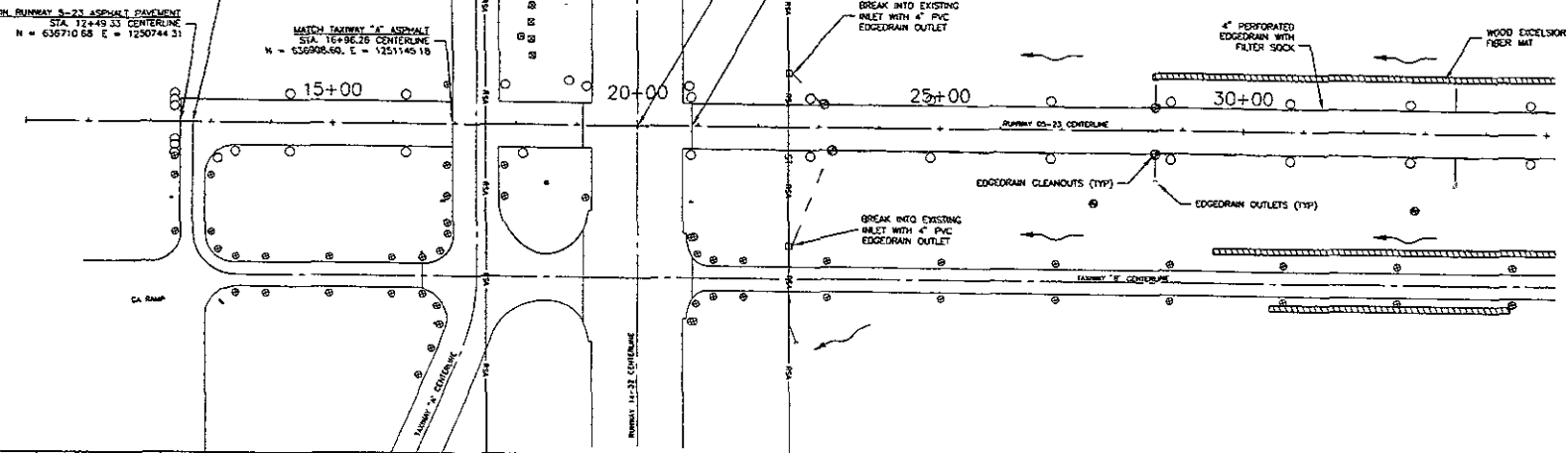

LEGEND

- EROSION CONTROL BLANKET
- RUNWAY 14/32 SAFETY AREA
- EXISTING BARBED WIRE FENCE
- EXISTING CHAIN LINK FENCE
- PROPOSED CHAIN LINK FENCE
- EDGEDRAIN
- EXISTING TELEPHONE
- EXISTING FAA CABLE
- RUNWAY LIGHT
- TAXIWAY LIGHT
- GUIDANCE SIGN
- DRAINAGE DIRECTION
- ELECTRICAL PULL BOX

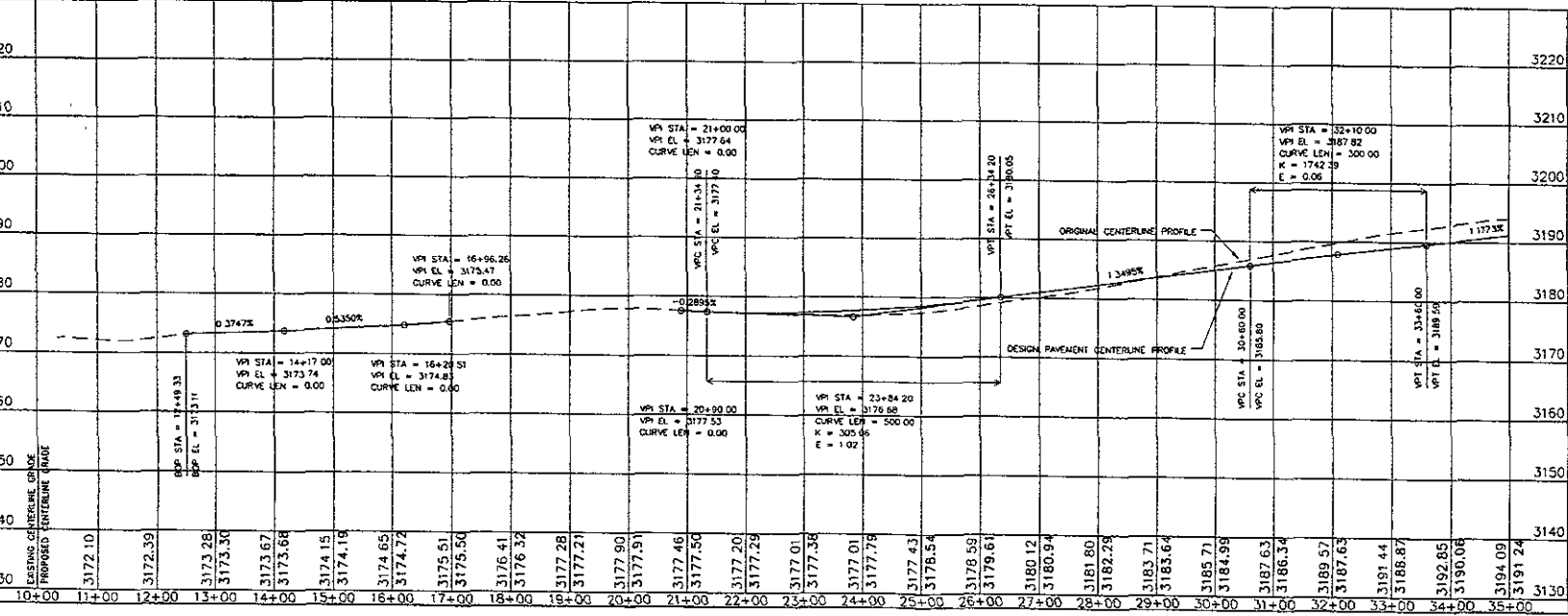

Rev'd

RAPID CITY REGIONAL AIRPORT
 RAPID CITY REGIONAL AIRPORT BOARD
 RAPID CITY, SOUTH DAKOTA

Sheet No. 9

Kadmas Lee & Jackson
 Engineers, Surveyors and Planners

RUNWAY 5/23
 PLAN AND PROFILE

DATE: 12/15/05
 DRAWN BY: JC
 CHECKED BY: JES
 PROJECT NO.: 06SR009
 SHEET NO.: 9
 DATE: 2/16/2006

© Kadmas, Lee & Jackson, 2004

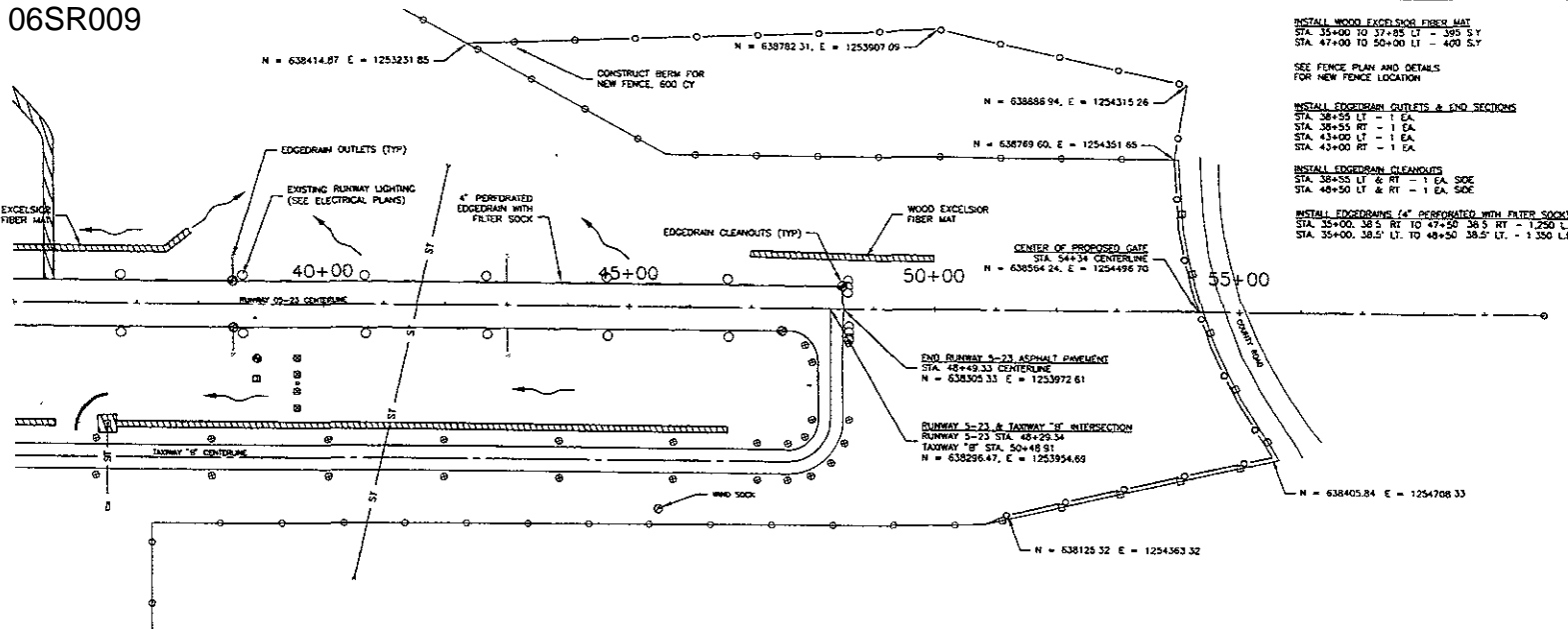

INSTALL WOOD EXCELSIOR FIBER MAT
 STA. 35+00 TO 37+85 LT - 395 S.Y.
 STA. 47+00 TO 50+00 LT - 400 S.Y.
 SEE FENCE PLAN AND DETAILS FOR NEW FENCE LOCATION

INSTALL EDGEDRAIN OUTLETS & END SECTIONS
 STA. 38+55 LT - 1 EA.
 STA. 38+55 RT - 1 EA.
 STA. 43+00 LT - 1 EA.
 STA. 43+00 RT - 1 EA.

INSTALL EDGEDRAIN CLEANOUTS
 STA. 38+55 LT & RT - 1 EA. SIDE
 STA. 48+50 LT & RT - 1 EA. SIDE

INSTALL EDGEDRAIN 4" PERFORATED WITH FILTER SOCK
 STA. 35+00, 38.5 RT TO 47+50, 38.5 RT - 1,250 LF
 STA. 35+00, 38.5 LT TO 48+50, 38.5 LT - 1,350 LF

INSTALL EDGEDRAIN OUTLET PIPES (4" PVC)
 STA. 38+55, 38.5 RT TO 38+55, 77.0 RT - 38.5 LF
 STA. 47+00 TO 50+00 LT - 38.5 LF
 STA. 38+55, 38.5 LT TO 38+55, 77.0 LT - 38.5 LF
 STA. 43+00, 38.5 LT TO 43+00, 77.0 LT - 38.5 LF

- LEGEND**
- EROSION CONTROL BLANKET
 - RUNWAY SAFETY AREA
 - EXISTING BARBED WIRE FENCE
 - EXISTING CHAIN LINK FENCE
 - PROPOSED CHAIN LINK FENCE
 - EDGEDRAIN
 - EXISTING TELEPHONE
 - EXISTING FAA CABLE
 - RUNWAY LIGHT
 - TAXIWAY LIGHT
 - GUIDANCE SIGN
 - DRAINAGE DIRECTION
 - ELECTRICAL PULL BOX

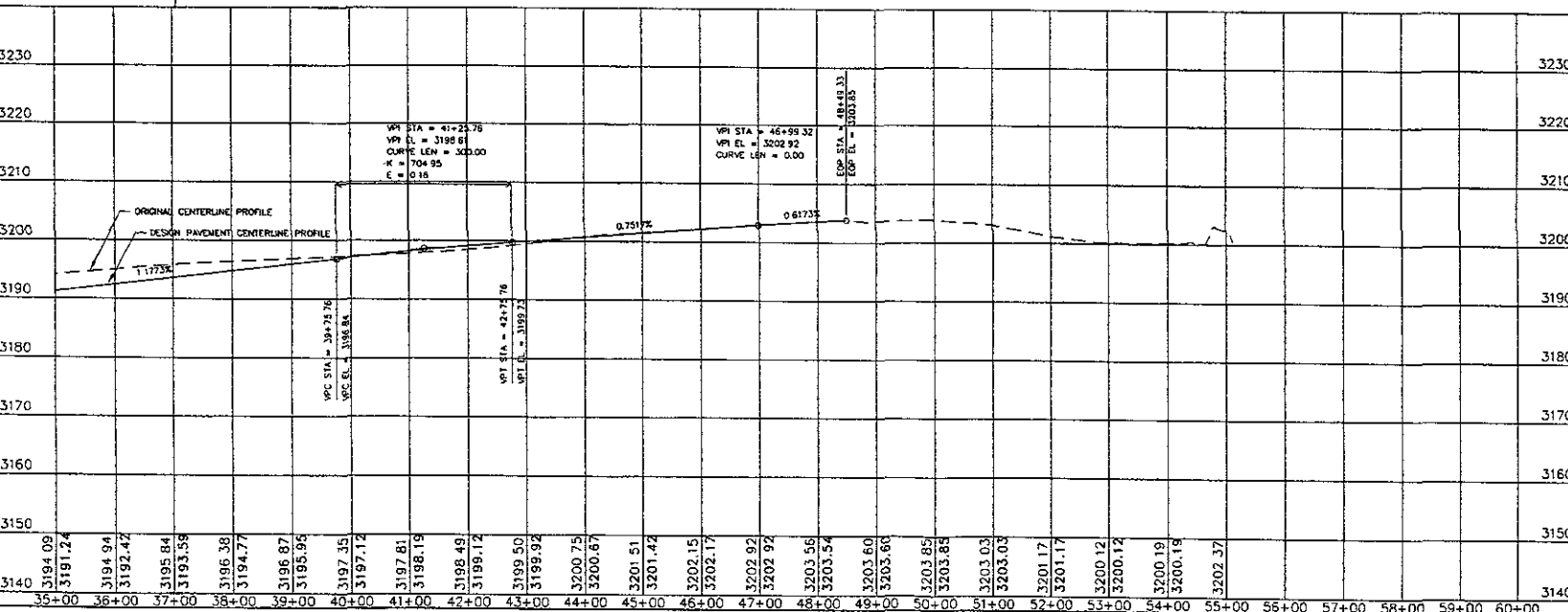

Rev: 1
 RAPID CITY REGIONAL AIRPORT
 RAPID CITY REGIONAL AIRPORT BOARD
 RAPID CITY SOUTH DAKOTA

Kadmas Lee & Jackson
 ENGINEERS, SURVEYORS AND PLANNERS
 1000 N. UNIVERSITY AVENUE
 SPOKANE, IDAHO 83402
 TEL: (208) 325-1100
 FAX: (208) 325-1101
 PROJECT NO: 10502011
 DATE: 5/16/2004

PROJECT: 10502011
 DRAWING: 02.dwg
 SHEET NO: 10

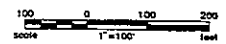

- LEGEND**
- EROSION CONTROL BLANKET
 - RUNWAY SAFETY AREA
 - EXISTING BARBED WIRE FENCE
 - EXISTING CHAIN LINK FENCE
 - PROPOSED CHAIN LINK FENCE
 - EDGEDRAIN
 - EXISTING TELEPHONE
 - EXISTING FAA CABLE
 - RUNWAY LIGHT
 - TAXIWAY LIGHT
 - GUIDANCE SIGN
 - DRAINAGE DIRECTION
 - ELECTRICAL PULL BOX

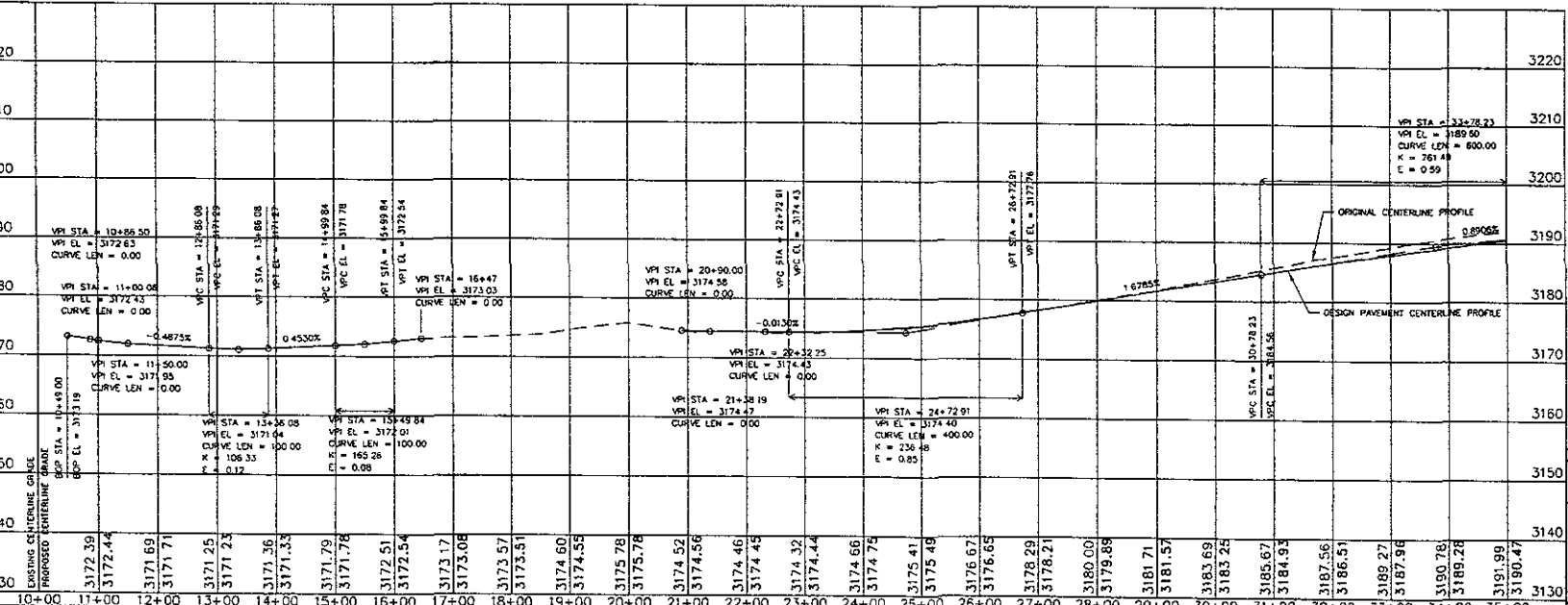
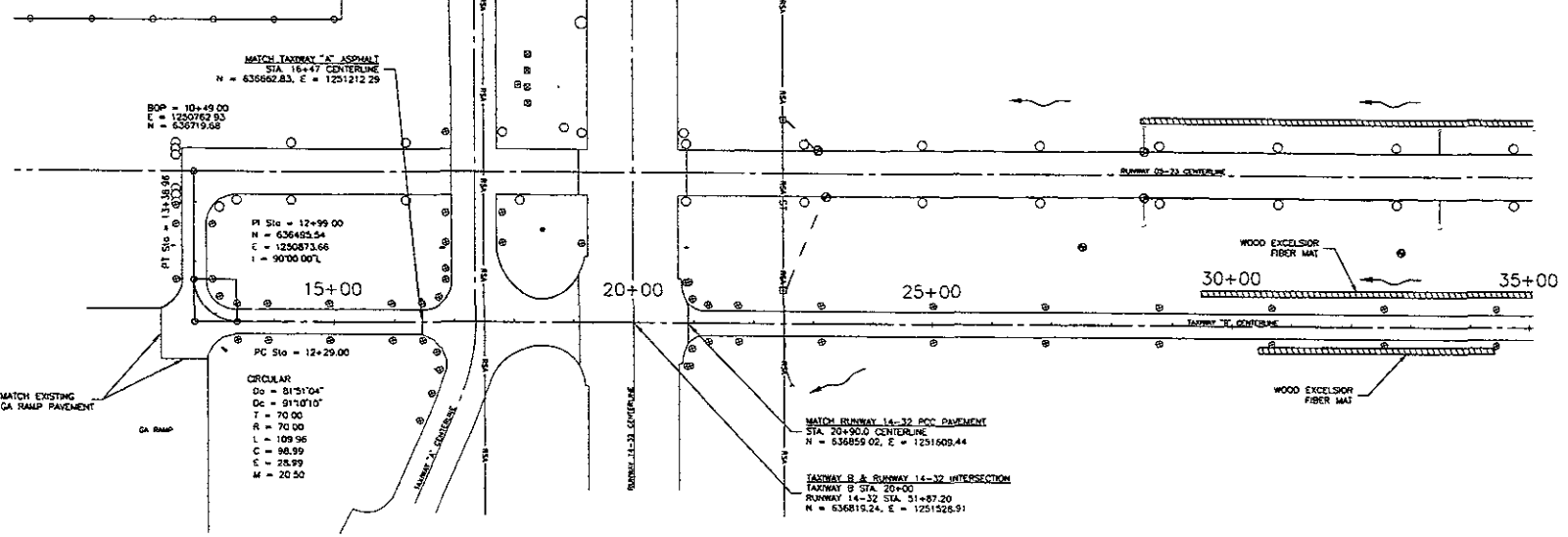

Revised	DATE	BY
RAPID CITY REGIONAL AIRPORT		Sheet No. 11
RAPID CITY REGIONAL AIRPORT BOARD		
RAPID CITY, SOUTH DAKOTA		
		TAXIWAY B PLAN AND PROFILE
Drawn by: TC/AS	Checked by: TC	Project No. 10502011
Date: 2/16/2004		Sheet: 2/16/2004

INSTALL WOOD EXCELSIOR FIBER MAT
 STA. 35+00 TO 35+86 LT - 88.5'
 STA. 36+35 TO 44+61 LT - 1 417.5'

SEE FENCE PLAN AND DETAILS
 FOR NEW FENCE LOCATION

NOTE 1
 FIELD VERIFY LOCATION OF DITCH BLOCK
 AND TOP ELEVATION

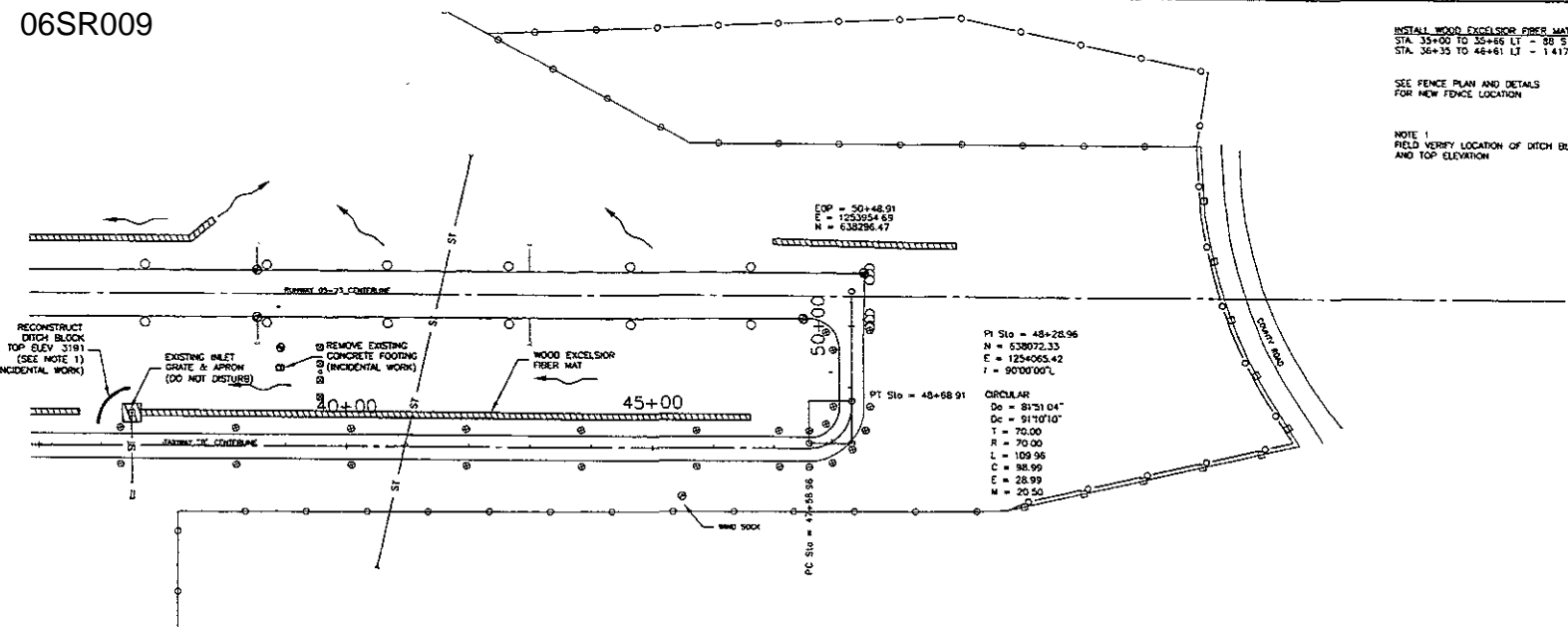
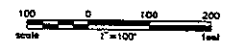

- LEGEND**
- EROSION CONTROL BLANKET
 - RUNWAY SAFETY AREA
 - EXISTING BARBED WIRE FENCE
 - EXISTING CHAIN LINK FENCE
 - PROPOSED CHAIN LINK FENCE
 - EDGEDRAIN
 - EXISTING TELEPHONE
 - EXISTING FAA CABLE
 - RUNWAY LIGHT
 - TAXIWAY LIGHT
 - GUIDANCE SIGN
 - DRAINAGE DIRECTION
 - ELECTRICAL PULL BOX

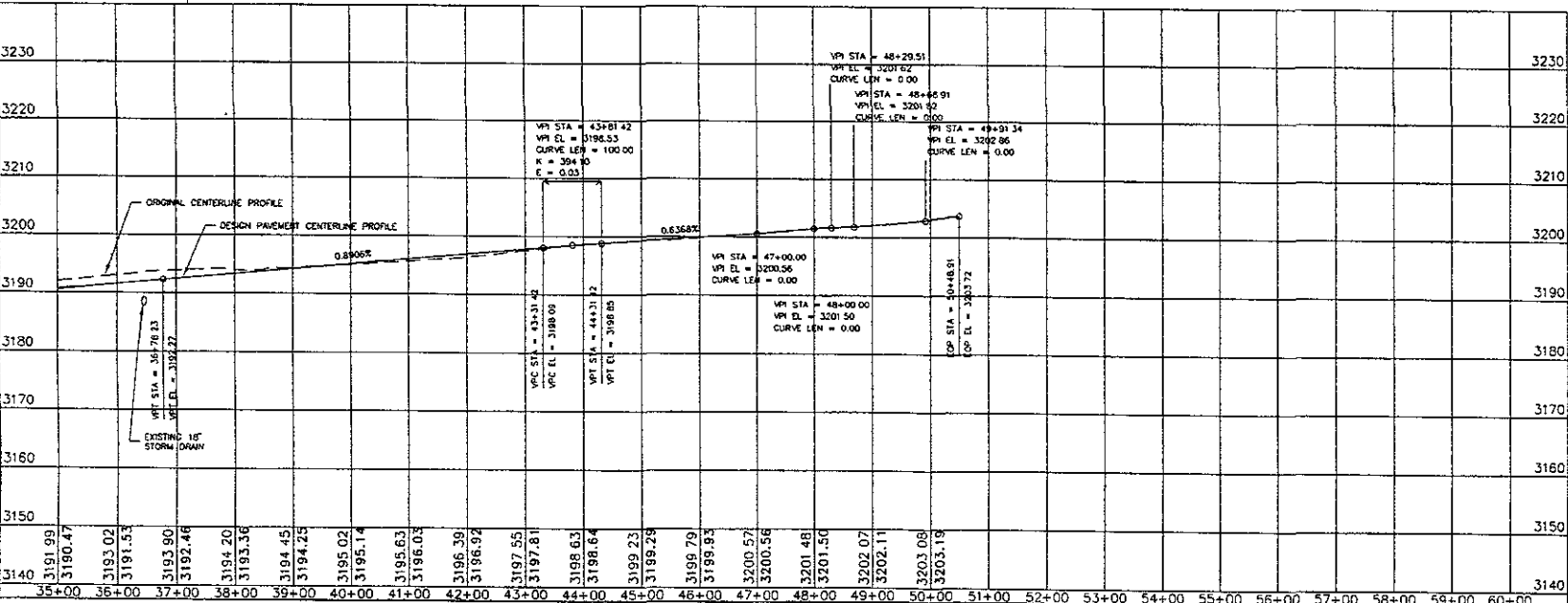

Rev'd
 RAPID CITY REGIONAL AIRPORT
 RAPID CITY REGIONAL AIRPORT BOARD
 RAPID CITY, SOUTH DAKOTA

SHEET NO
 12

Kadmas Lee & Jackson
 Engineers, Surveyors and Planners
 TAXIWAY B PLAN AND PROFILE
 Date of TC/JS Date of TC PROJECT NO. 10502011 SHEET NO. 2/18/2004
 2:\Projects\10502011\As Constructed\10502011_Taxiway_B.dwg