

TYPICAL ROADWAY SECTIONS

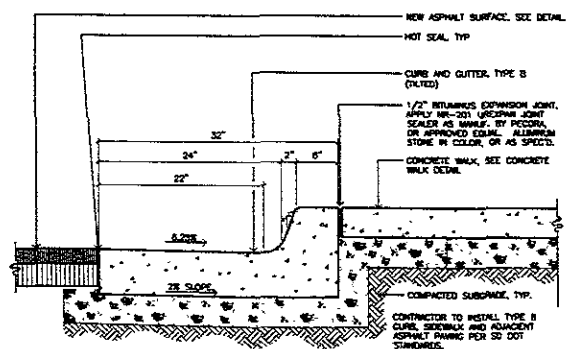

SECTION: TYPE B CONCRETE CURB AND SIDEWALK
SCALE: 1 1/2" = 1'-0"

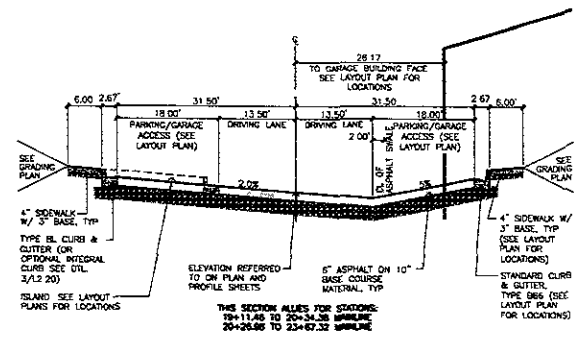
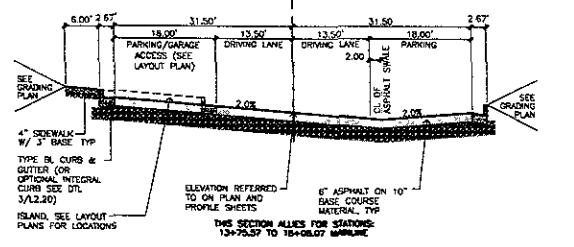
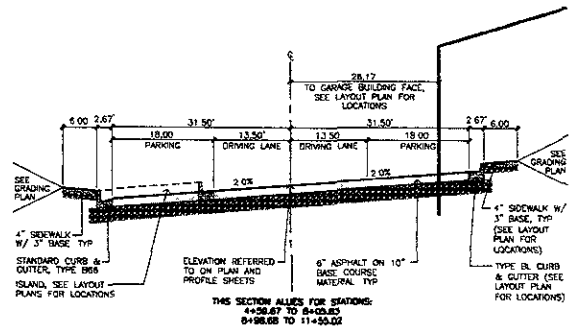

TYPICAL ROADWAY SECTIONS

RECEIVED

OCT 14 2005

Rapid City

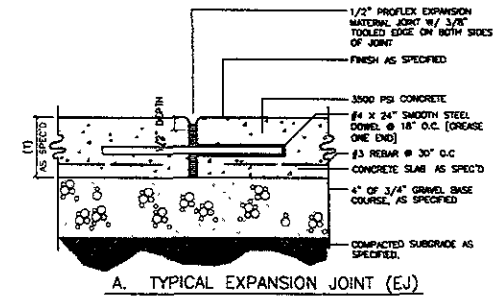

A. TYPICAL EXPANSION JOINT (EJ)

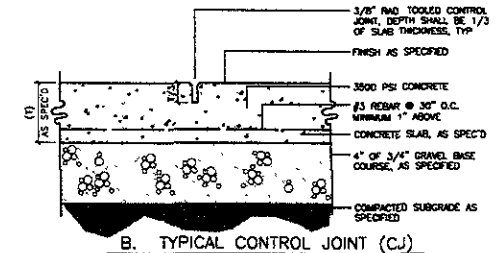

B. TYPICAL CONTROL JOINT (CJ)

SECTION: TYPICAL CONCRETE JOINT DETAILS
SCALE: 3" = 1'-0"

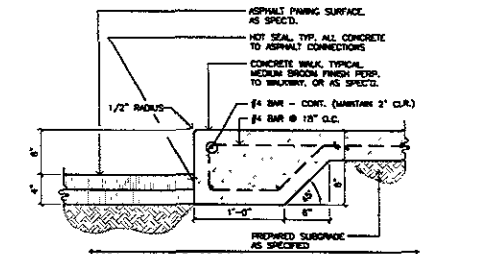

SECTION: INTEGRAL CONCRETE CURB
SCALE: 1 1/2" = 1'-0"

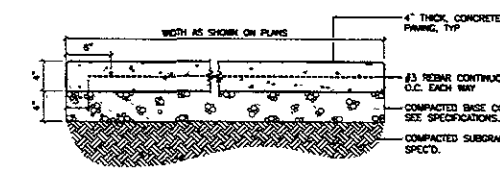

SECTION: TYPICAL CONCRETE PAVING
SCALE: 1 1/2" = 1'-0"

Wyss Associates, Inc.
Landscape Architecture
Civil/Construction Design
Planning & Recreation Design
228 South Street
Rapid City, SD 57701-1910
Phone: 605/378-0241
Fax: 605/378-0242
Email: info@wyssassociates.com

Black Hills Estates Eagle Ridge
Rapid City, South Dakota

Site Details

DESIGNED BY: WSP
DRAWN BY: CDR/KE
APPROVED BY: P
PROJECT NO: 053
DATE: October 14, 2005
NO. REVISION: DK
Sheet: L2.20
9 of

OCT 14 2005

Rapid City Growth Management Department

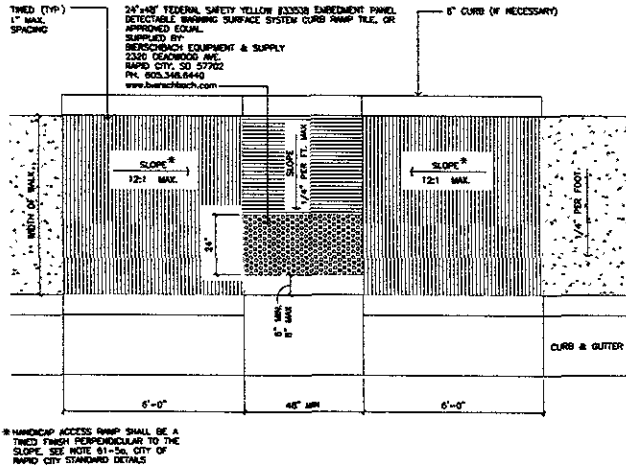

1 PLAN: TYPICAL CONC. ACCESS RAMP
SCALE: 1/2" = 1'-0"

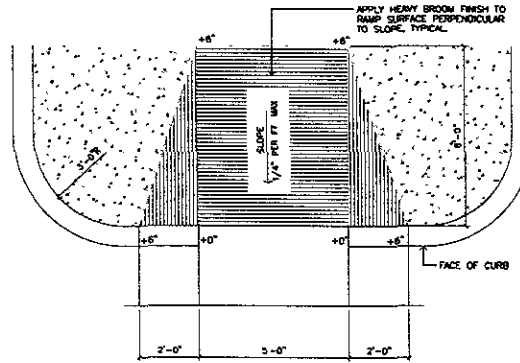

2 PLAN: TYPICAL CONC. ACCESS RAMP AT RECEPTACLE LOCATIONS
SCALE: 1/2" = 1'-0"

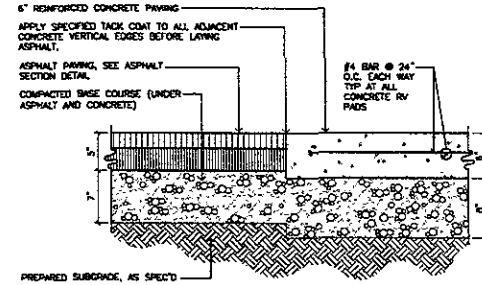

3 SECTION: ASPHALT TO CONCRETE TRANSITION
SCALE: 1/2" = 1'-0"

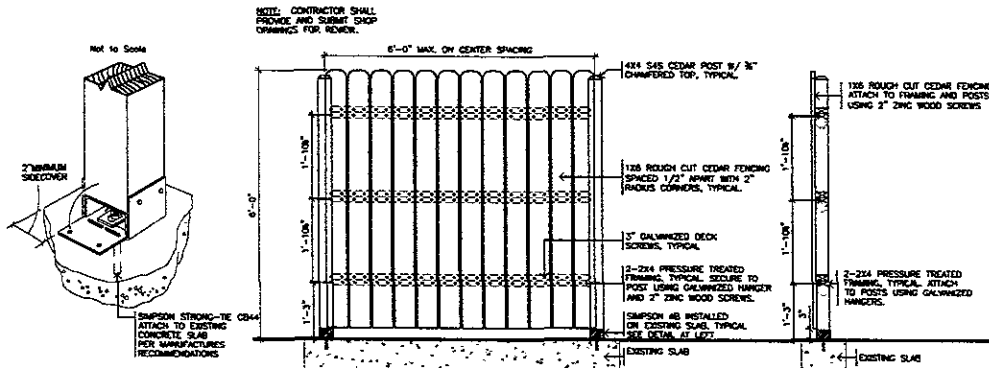

4 SECTION/ELEVATION: ROUGH CUT CEDAR FENCING
SCALE: 1/2" = 1'-0"

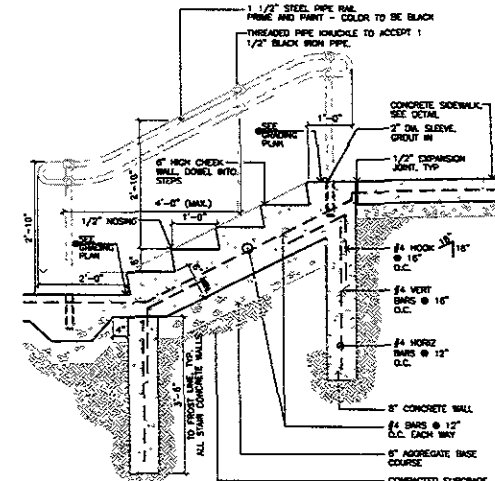

5 SECTION: STAIR / HANDRAIL DETAIL
SCALE: 3/4" = 1'-0"

Wyss Associates, Inc.
Landscape Architecture
Civil & Recreation Design
228 South Street - Rapid City, South Dakota 57701-3870
Phone: 605.342.8556
www.wyssassociates.com

Black Hills Estates
Eagle Ridge
Rapid City, South Dakota

Site Details

DESIGNED BY:	MMKP	
DRAWN BY:	CHS A	
APPROVED BY:	P	
PROJECT NO.:	955	
DATE:	October 14, 2005	
NO.	REVISION	D/E

12.21
10 of

GENERAL BASKETBALL COURT NOTES

1 ALL COURT STRIPING IS TO BE 2" WIDE. LATENT LINE PAINT IS MANUFACTURED BY: LUXCOAT INTERNATIONAL, INC. 4051 NORTH POINT ROAD BALTIMORE, MD 21222 PH: 800-374-3080 OR APPROVED EQUAL. COLOR TO BE WHITE. SEE SPECIFICATIONS FOR PROCEDURES AND PRODUCT INFORMATION.

CONTROL POINT, SEE LAYOUT PLAN FOR FURTHER COORDINATION R: 632029.75 E: 12411076.23

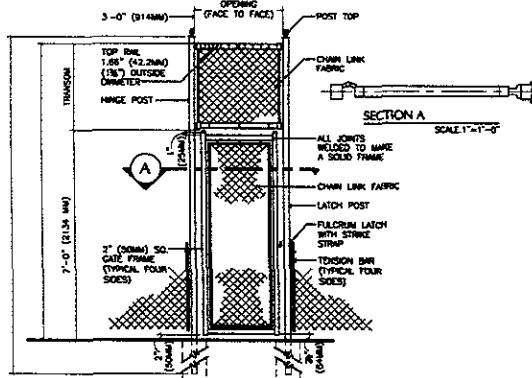

GATE ELEVATION

END & CORNER POST TOP OPTIONS	NOTES
	1. METRIC DIMENSIONS ARE NOMINAL EQUIVALENTS TO U.S. DIMENSIONS 2. SPECIFICATIONS SHOWN CAN BE CHANGED BY THE MANUFACTURER ONLY
	3. FOOTING WIDTH TO BE 4(X) POST WIDTH. MIN. DEPTH TO BE 36" (914MM)
	4. GATES MAY BE MANUALLY OR ELECTRICALLY OPERATED. HARDWARE WILL VARY FOR ELECTRICALLY OPERATED GATES

MIN. HEIGHT (H)
7'-0" (2134MM)
OPENING (P/F)
5'-0" (1524MM)

1 TYPICAL HIGH FENCE SWING GATE
SCALE: 1/2" = 1'-0"

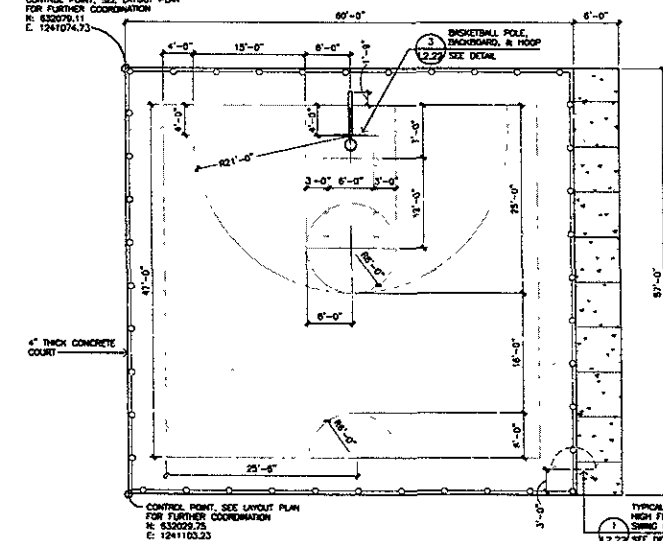

2 PLAN: BASKETBALL HALF-COURT LAYOUT
SCALE: 1/8" = 1'-0"

GENERAL BASKETBALL POLE NOTES

1 THE EXTENSION FROM CLAMP BOLT THREADES ARE TO BE DISTORTED WITH A HAMMER AND CHISEL WHEN INSTALLATION IS COMPLETED.

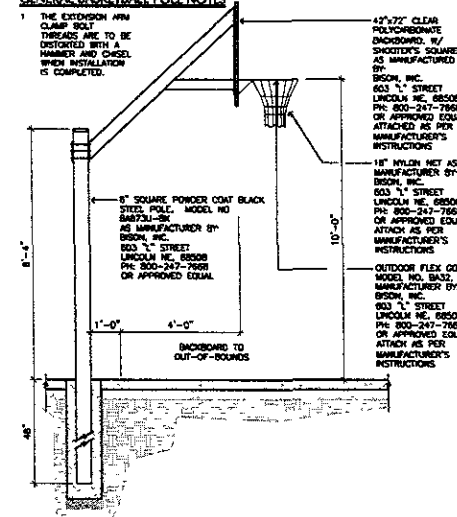

3 DETAIL: BASKETBALL POLE, BACKBOARD, & HOOP
SCALE: 1/2" = 1'-0"

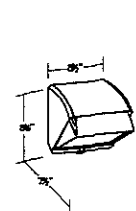

CUTOFF WALLPAPER WITH CLEAR SHIELD FOR 30 TO 100 WATTS VPS, 30 TO 100 WATTS METAL HALIDE (PLAISE START) STANDARD 30 43 BATT CELL LENS IS FLAT, TEMPERED GLASS. 37 CUTOFF STRIP INCLUDED. LAMP INCLUDED. ARCHITECTURAL BRONZE FINISH.

THE LIGHTING, INC. 170 LUDLOW AVENUE NORTHVILLE, MI 48757

TELEPHONE: 888 848 1000 (TOLL-FREE) 201-784-8880 (LOCAL OR OUT-OF-COUNTRY) FAX: 888 848-1232 (TOLL-FREE) 201-784-0077 (LOCAL OR OUT-OF-COUNTRY)

4 WP1 CUTOFF DETAIL
SCALE: 1/2" = 1'-0"

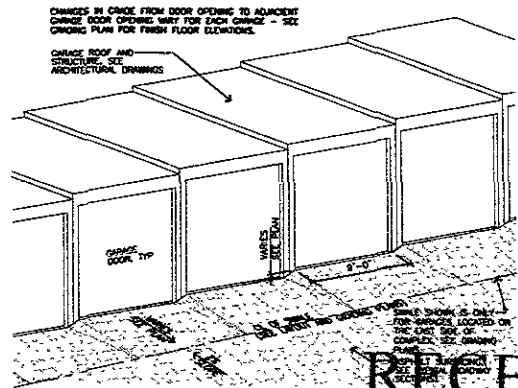

5 GRADING AT APARTMENT GARAGES
SCALE: 1/4" = 1'-0"

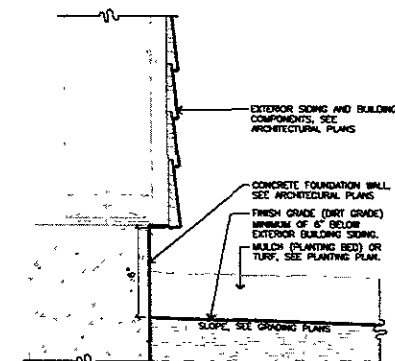

6 SECTION: GRADE DETAIL AT BUILDING
SCALE: 3" = 1'-0"

Wyss Associates, Inc.

Landscape Architecture
Civil/Construction Design
Planning & Recreation Design

Rapid City, South Dakota 57701-3870
Phone: 605-342-9100
Fax: 605-342-9101
email: info@wyssassociates.com

Black Hills Estates Eagle Ridge
Rapid City, South Dakota

Site Details

DESIGNED BY: MSSP
DRAWN BY: CAROL K
APPROVED BY: P
PROJECT NO.: 038
DATE: October 14, 2005

NO.	REVISION	DATE

L2.22

Sheet 11 of 11

OCT 14 2005

Rapid City Growth Management Department

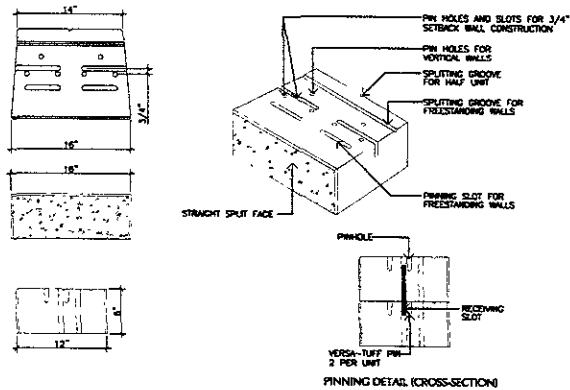

1 UNIT DIMENSIONS
12.23 NOT TO SCALE

GUARDRAIL ONLY REQUIRED AT SITE WALLS (ABOVE 4' TALL) ON WEST SIDE OF COMPLEX AT REAR AND SIDE OF GARAGE STALLS.

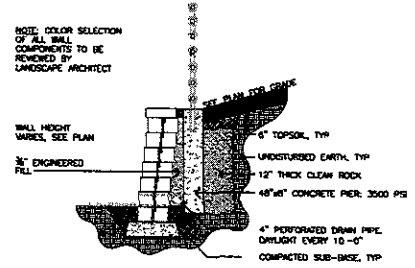

2 SECTION: REINFORCED RETAINING WALL
12.23 SCALE: 1/2" = 1'-0"

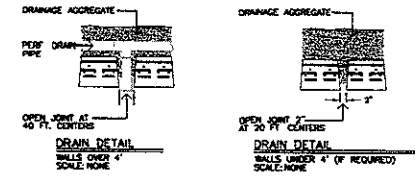

3 PLAN SECTION - DRAIN DETAILS
12.23 SCALE: 1/2" = 1'-0"

GUARDRAIL AND GEOGRID REINFORCEMENT ONLY REQUIRED AT SITE WALLS (ABOVE 4' TALL) ON WEST SIDE OF COMPLEX AT REAR AND SIDE OF GARAGE STALLS.

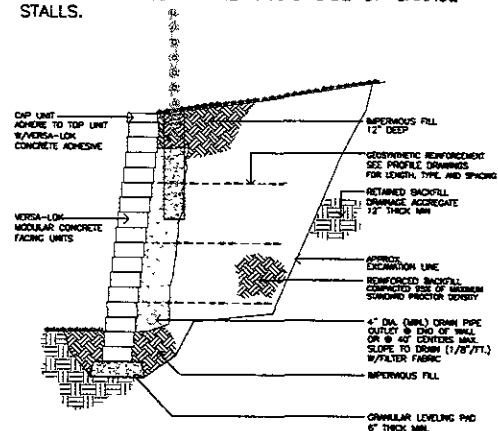

4 TYPICAL SECTION - REINFORCED RETAINING WALL
12.23 SCALE: 1/2" = 1'-0"

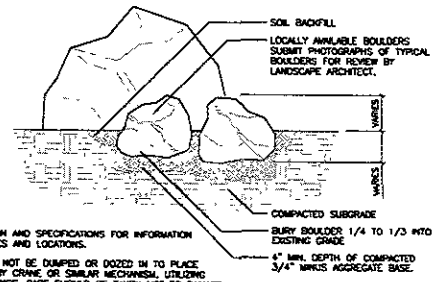

NOTES:
REFER TO PLAN AND SPECIFICATIONS FOR INFORMATION ON ROCK SIZES AND LOCATIONS.
ROCKS SHALL NOT BE DAMPED OR DOZED IN TO PLACE BUT BE SET BY CRANE OR SIMILAR MECHANISM, UTILIZING SLINGS OR TONGS. CARE SHOULD BE TAKEN NOT TO DAMAGE EXPOSED SURFACES OF STONES. DAMAGED SURFACES SHALL BE REPAIRED AS APPROVED BY THE OWNER'S REPRESENTATIVE.

5 LANDSCAPE BOULDER PLACEMENT
12.23 SCALE: 1" = 1'-0"

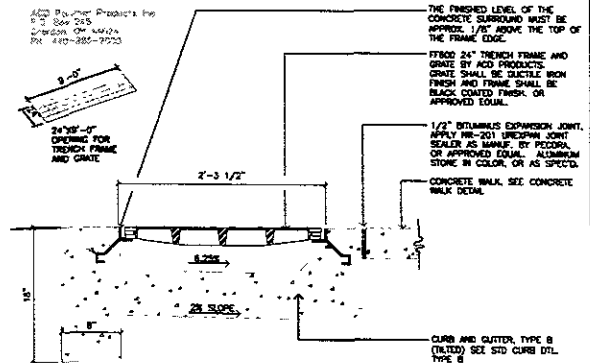

6 SECTION: TRENCH DRAIN THROUGH CURB ISLAND
12.23 SCALE: 1/2" = 1'-0"

Wyss Associates, Inc.
Landscape Architecture
Civil/Concrete/Architectural
Parks & Recreation Design
720 South Street - Rapid City, South Dakota 57701-3070
Ph: 605.448.2359 Fax: 605.448.6598
email: info@wyssassociates.com

Black Hills Estates Eagle Ridge
Rapid City, South Dakota

Project Name: Site Details

Next Title

DESIGNED BY: WSP
DRAWN BY: CHA-K
APPROVED BY: P
PROJECT NO: 055
DATE: October 14, 2005

NO.	REVISION	D.C.

Sheet: 12 OF 12.23

All common bar, stainless steel and other received angles include in the copy/printing.