

05PD044

RECEIVED

JUN 27 2005

Rapid City Growth
Management Department

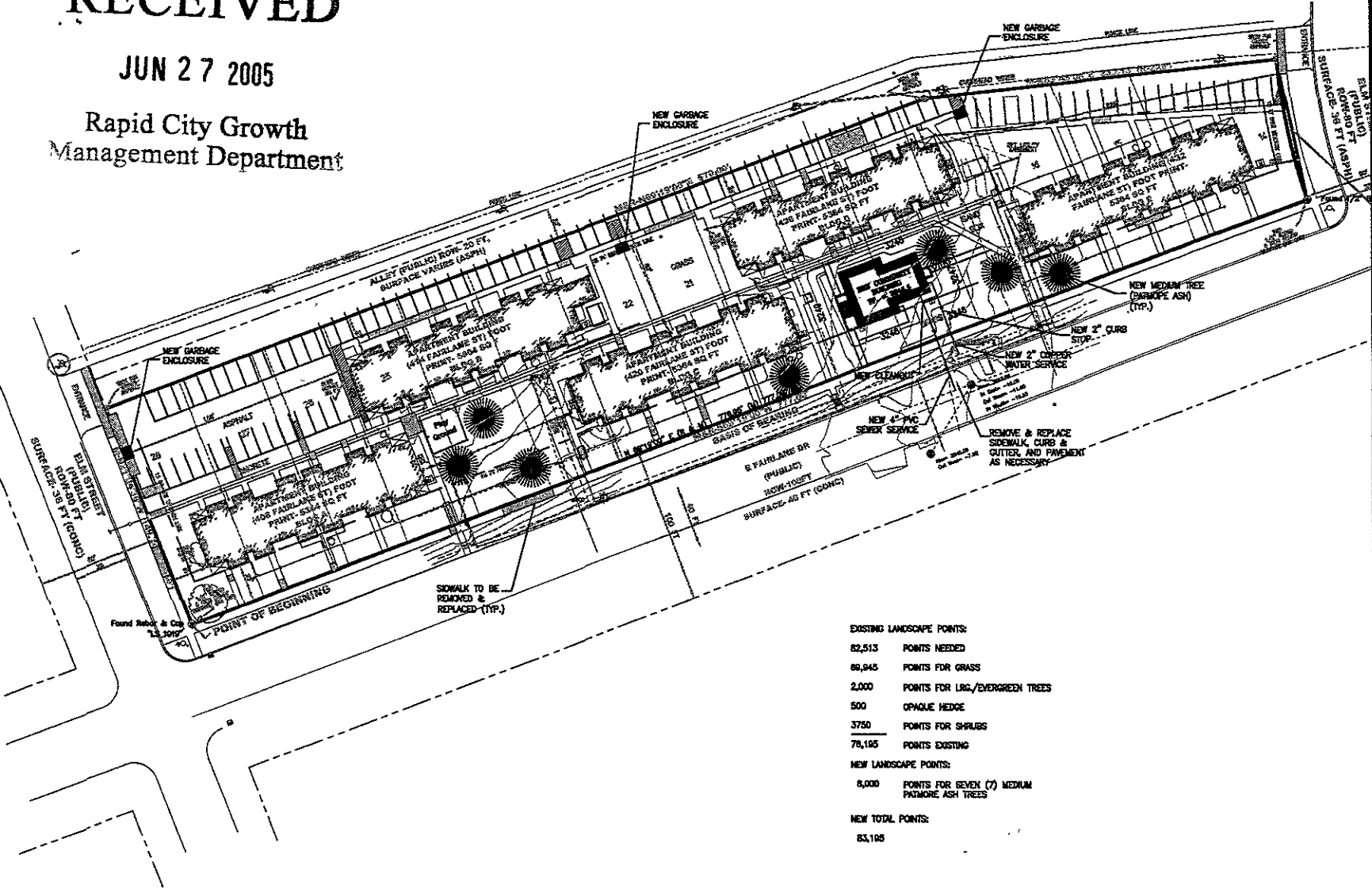

EXISTING LANDSCAPE POINTS:	
82,513	POINTS NEEDED
80,045	POINTS FOR GRASS
2,000	POINTS FOR LRG./EVERGREEN TREES
500	OPAQUE HEDGE
3750	POINTS FOR SHRUBS
78,195	POINTS EXISTING
NEW LANDSCAPE POINTS:	
5,000	POINTS FOR SEVEN (7) MEDIUM PATMORE ASH TREES
NEW TOTAL POINTS:	
83,195	



A1 SITE CONDITIONS, LAYOUT, GRADING, UTILITIES, & LANDSCAPING
SCALE 1" = 30'-0"



TSP, Inc.
800 Kansas City Street
Rapid City, SD 57701
phone: (605) 343-6162
fax: (605) 343-7159
www.tspinc.com

Architecture
Engineering
Construction

PROJECT TITLE

PROJECT TITLE

PROJECT TITLE

PROJECT TITLE

PROJECT TITLE

PROJECT TITLE

PROJECT TITLE

PROJECT TITLE

PROJECT TITLE

PROJECT TITLE

PROJECT TITLE

PROJECT TITLE

PROJECT TITLE

PROJECT TITLE

PROJECT TITLE

PROJECT TITLE

PROJECT TITLE

PROJECT TITLE

PROJECT TITLE

PROJECT TITLE

PROJECT TITLE

PROJECT TITLE

PROJECT TITLE

PROJECT TITLE

PROJECT TITLE

DRIFTWOOD ESTATES
SITE CONDITIONS,
LAYOUT, GRADING
UTILITIES & LANDSCAPING

C-101

PRELIMINARY - NOT FOR CONSTRUCTION