

**SITE FURNISHING SCHEDULE**

WABASH VALLEY MANUFACTURING, INC  
1-800-233-8819 OR APPROVED EQUAL

KEY	QTY	MODEL NO.	DESCRIPTION	COLOR
E	3	SC4030P	6 BENCH W/BACK & W/ROUND MOUNT	FRAME: GREEN - BENCH: BURGUNDY
F	3	UP3002PW/7100	33 GAL. RECEPTACLE W/ W/ROUND MOUNT	BURGUNDY
G	2	12224003	48" ROUND SHADE PEEDESTAL TABLE W/ W/ROUND MOUNT	FRAME: GREEN - TABLE: BURGUNDY
H	1	12222001	48" ROUND SHADE PEEDESTAL TABLE W/ W/ROUND MOUNT	FRAME: GREEN - TABLE: BURGUNDY

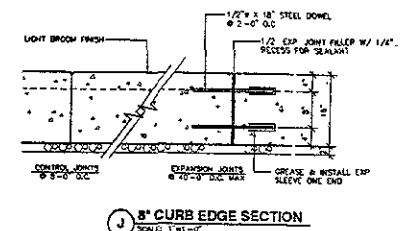
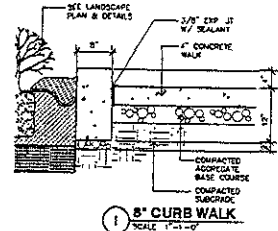
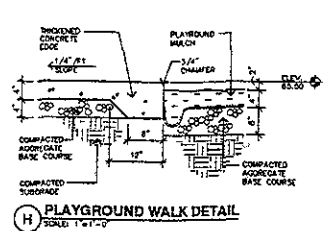
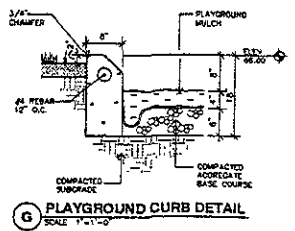
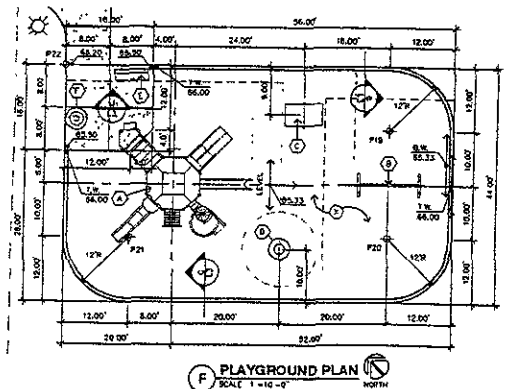

**RECREATION EQUIPMENT SCHEDULE**

MIRACLE RECREATION EQUIPMENT CO  
1-800-523-4202 OR APPROVED EQUAL

KEY	QTY	MODEL NO.	DESCRIPTION
A	1	714-082	KIDS' CHOICE PLAYSTRUCTURE
B	1	714-052-25	ARCH BRING W/ SLASH-PROOF SEAT
C	1	130-070	MULTI-FORM
D	1	299-410	PICTURE

**DISNEY WORKSPACES**  
126 East Memphis St.  
Suite 30  
Memphis, TN 38103  
Phone: 901-524-0299  
Fax: 901-524-9588

**EXPANDED PLANS & DETAILS**  
RED ROCK MEADOWS PARK  
RABBIT CITY, SOUTH DAKOTA

Project No. 06-272  
File Name: 17-088-000-000.dwg  
Drawn By: [blank]  
Checked By: [blank]  
Date: 3-14-20  
Revision: [blank]



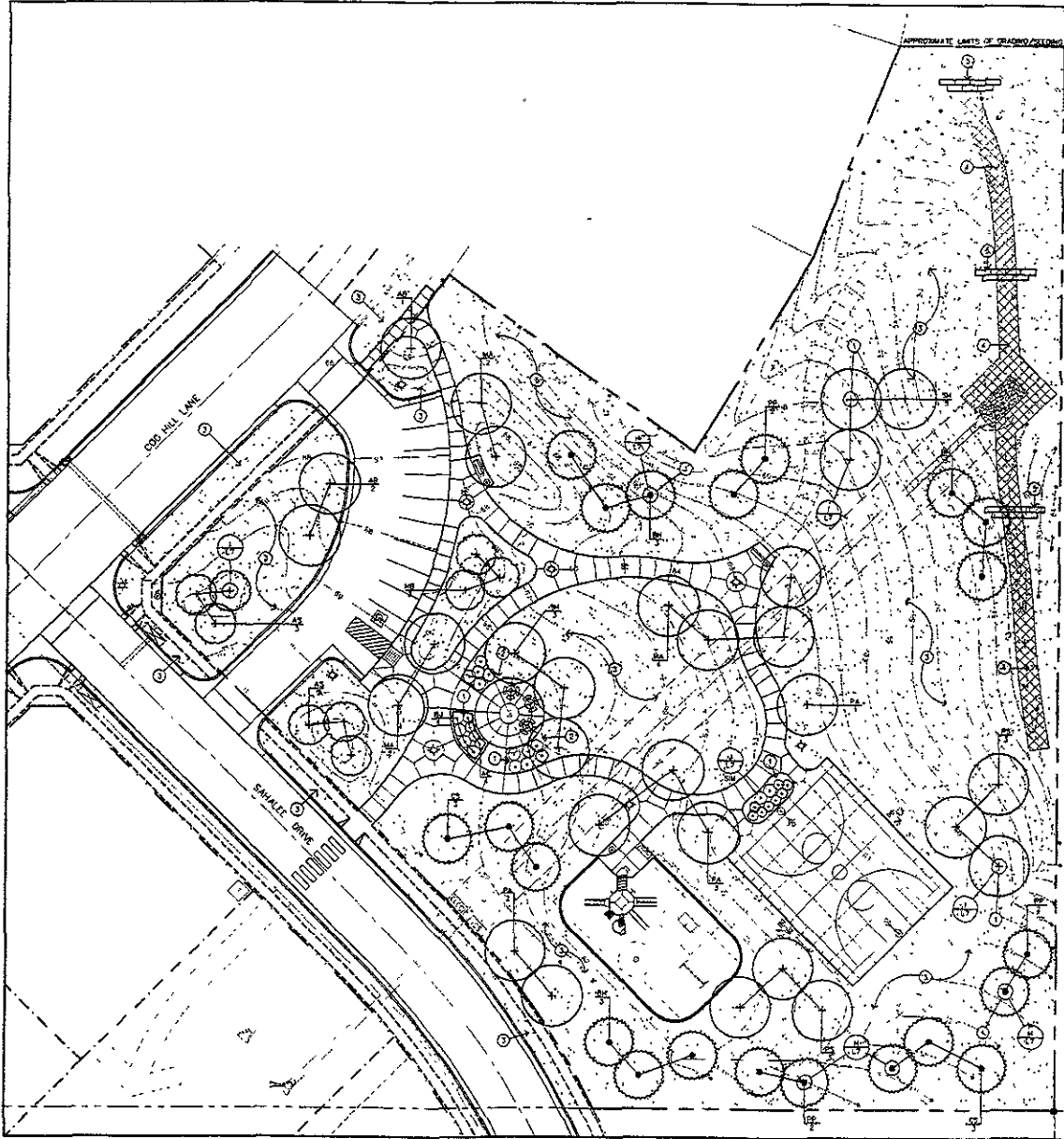

**LANDSCAPE SYMBOLS:**

- DECIDUOUS TREE
- ORNAMENTAL TREE
- UPRIGHT JUMPER TREE
- DECIDUOUS SHRUB
- EVERGREEN SHRUB
- LANDSCAPE DOING
- TURF LIMITS
- SEEDING AREA
- EROSION CONTROL BLANKET

**LANDSCAPE KEY NOTES:**

1. TREEING MIXTURE PROVIDE 3" MIN DEPTH SOFTWOOD BARK MULCH AS SPECIFIED OR APPROVED EQUAL.
2. LANDSCAPE DOING: INSTALL THE FOLLOWING LANDSCAPE DOING OF APPROVED EQUAL AS INDICATED ON PLAN = 1/8" x 3" DEEP STEEL PLATEBACK DOING BY DAKOTA STEEL & SUPPLY (800) 364-7000.
3. CURB SETTING: SEEDING AREAS TO HAVE A MINIMUM TOPSOIL DEPTH OF 4 INCHES. SEE TURF SETTING REQUIREMENTS FOR SEED SPECIFICATION. REFER TO GRADING PLAN.
4. EROSION CONTROL BLANKET: PROVIDE AND INSTALL EROSION CONTROL BLANKET BY NORTH AMERICAN GREEN INC. 501.00. INSTALL AS PER MANUF. SPEC.
5. GRASS SEEDING PROTECTION: EROSION SALES - SEE GRADING PLAN.

**LANDSCAPE NOTES:**

- LANDSCAPING SYMBOLS: THE CONTRACTOR IS RESPONSIBLE TO VERIFY ALL LANDSCAPING UTILITIES PRIOR TO CONSTRUCTION. NOTIFY OWNER IMMEDIATELY OF ANY DISCREPANCIES. SOUTH DAKOTA ONE CALL NUMBER: 800-781-7474.
- VERIFY QUANTITIES: QUANTITIES PROVIDED ON DRAWINGS ARE FOR REFERENCE ONLY. CONTRACTOR IS RESPONSIBLE FOR DETERMINING ACTUAL QUANTITIES OF ALL MATERIALS TO COMPLETE PROJECT.
- PLANTING SOIL: PROVIDE 12" MIN. PLANTING SOIL IN ALL SOFT & PERMANENT AREAS. SEE SPECIFICATIONS AND LANDSCAPE DETAILS.

**GRASS SEEDING REQUIREMENTS:**

**SEEDING MIXTURES:**  
 Laysne Kentucky Bluegrass 20.00%  
 Broomfield Kentucky Bluegrass 20.00%  
 Midland Kentucky Bluegrass 20.00%  
 Lincolnton Kentucky Bluegrass 20.00%  
**SEEDING RATE:** Mechanical drill seed at a rate of 3 lbs. per 1,000 S.F.

**PLANT MATERIAL SCHEDULE**

EXT.	QUANTITY	COMMON NAME	SCIENTIFIC NAME	SIZE
<b>DECIDUOUS TREES</b>				
AB	2	Austinn Blaze Ash	Fragaria americana 'Austinn Blaze'	1 1/2" S&B
PA	6	Panorama Ash	Fragaria americana 'Panorama'	2" S&B
SA	3	Skyline Honeylocust	Gleditsia triacanthos 'Skyline'	2" S&B
SH	3	Shenandoah Maple	Acer spicatum 'Shenandoah'	1 1/2" S&B
<b>ORNAMENTAL TREES</b>				
AS	4	Aust. Brilliance Sanicberry	Azalea indica 'Aust. Brilliance'	1 1/2" S&B
NS	3	Norway Spruce	Picea canadensis	1 1/2" S&B
<b>EVERGREEN TREES</b>				
BR	9	Broom Hills Spruce	Picea canadensis	8" H. S&B
PF	6	Ponderosa Pine	Pinus ponderosa	8" H. S&B
<b>DECIDUOUS SHRUBS</b>				
AC	10	Ashle Currant	Ribes cynosbati	1 1/2" H.
CR	4	Crab Apple	Malus domestica 'Crabapple'	1 1/2" H.
FR	2	Firethorn	Elaeagnus argentea	1 1/2" H.
GT	2	Golden Thread Spirea	Spiraea alba 'Golden Thread'	1 1/2" H.
IS	2	Ironstone Spirea	Spiraea alba 'Ironstone'	1 1/2" H.
NS	2	Norway Spruce	Picea canadensis	1 1/2" H.
<b>EVERGREEN SHRUBS</b>				
BC	35	Blue Chip Juniper	Juniperus horizontalis 'Blue Chip'	8" cont.
BO	2	Blueberry Delight Juniper	Juniperus communis 'Blueberry Delight'	8" cont.
BJ	9	Buffalo Juniper	Juniperus repens 'Buffalo'	8" cont.

**LANDSCAPE PLAN**



**LANDSCAPE PLAN**  
 RED ROCK MEADOWS PARK  
 RAPID CITY, SOUTH DAKOTA

Project No. 404-112  
 File Name: 05SR024.dwg  
 Drawn By: JLS  
 Checked By: JLS  
 Date: 3-18-05

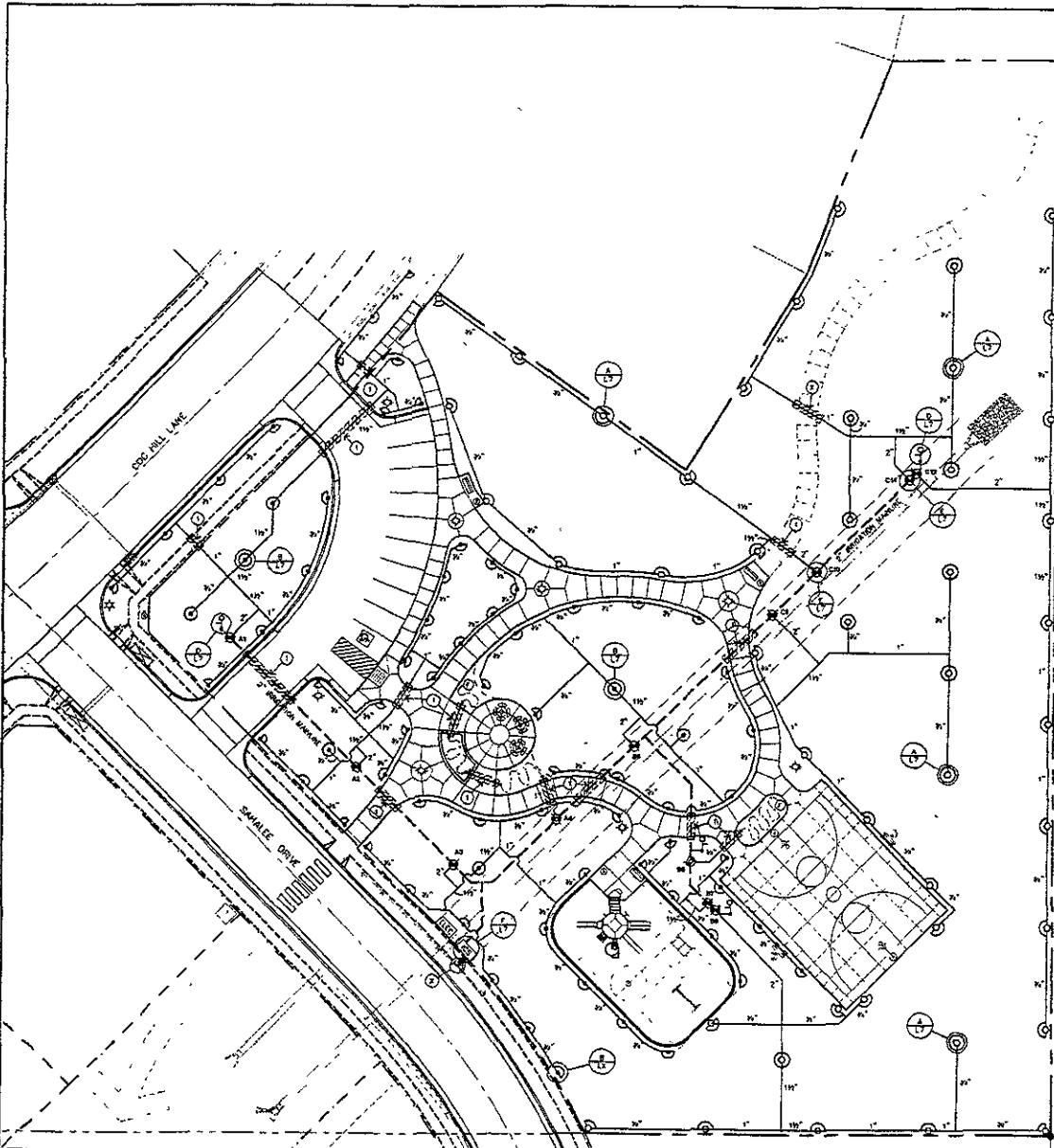

**IRRIGATION KEY NOTES:**

- ① INSTALL SCHEDULE 40 PVC SLEEVES 1/2" BELOW PAVEMENT. SIZE SLEEVES AS INDICATED BELOW.
  - 2" SLEEVE - ALL MAINLINE PIPE
  - 2" SLEEVE - 1/2" & 3/4" LATERAL PIPE
  - 2" SLEEVE - 1/2" & 3/4" LATERAL PIPE
  - 2" SLEEVE - 1/2" & 3/4" LATERAL PIPE
- ② TAP EXISTING WATER MAIN FOR IRRIGATION SERVICE CONNECTION. ACTUAL CURB STOP & GROUND COUPLER BLOW-OUT AND STRIKE IRRIGATION POINT-OF-CONNECTION IS APPROXIMATE.
- ③ INSTALL IRRIGATION EQUIPMENT ENCLOSEURE EXCEPT PRESSURE AND CONTROLLER.

**IRRIGATION NOTES:**

- THE CONTRACTOR IS RESPONSIBLE FOR LOCATING ALL PUBLIC AND PRIVATE UTILITIES IN THE PROJECT AREA PRIOR TO CONSTRUCTION. NOTIFY ARCHITECT OF ANY CONFLICTS.
- ALL CONSTRUCTION TO BE IN ACCORDANCE WITH APPLICABLE CODES. NOTHING IN THESE DRAWINGS SHALL RELIEVE THE CONTRACTOR FROM COMPLYING WITH ALL APPLICABLE SAFETY REGULATIONS.
- ALL IRRIGATION PIPING & EQUIPMENT TO BE INSTALLED IN ACCORDANCE WITH STANDARDS AS ESTABLISHED BY THE IRRIGATION ASSOCIATION.
- QUANTITIES PROVIDED ON DRAWINGS ARE FOR INFORMATION ONLY. CONTRACTOR IS RESPONSIBLE FOR DETERMINING ACTUAL QUANTITIES OF ALL MATERIALS, EQUIPMENT & SUPPLIES REQUIRED TO COMPLETE PROJECTS.
- THIS SYSTEM WAS DESIGNED FOR A 50 P.S.F. STATIC WATER PRESSURE AND 90 G.P.M. UNLESS INDICATED OTHERWISE ON PLANS. SHOULD THE PRESSURE AND FLOWRATE BE LESS THAN THE INDICATED ARCHITECT BEFORE PROCEEDING WITH THE INSTALLATION SO THAT EXCESSIVE DAMAGE IS NOT MADE IN SPRINKLING. IF PRESSURE IS MUCH GREATER, NOTIFY ARCHITECT. IT MAY REQUIRE A PRESSURE REDUCING DEVICE.

**IRRIGATION EQUIPMENT SCHEDULE**

KEY	QUANTITY	EQUIPMENT DESCRIPTION	TECHNICAL INFORMATION
⊕	1 EA	CURB STOP	PER STATE SPEC.
⊕	1 EA	METAL EQUIPMENT ENCLOSEURE	WATSTEEL NO. C8360-18TH (GREN)
⊕	1 EA	FIBERGLASS GROUND SLEEVE	NONDUC FIBERGLASS NO. 05-81-M
⊕	1 EA	2" REDUCED PRESSURE BACKFLOW ASSURE.	WATTS NO. 909-07      FERCO 823VA-HY/INTD
⊕	1 EA	3/4" DRAIN VALVE	WATTS NO. 80-2      HEBCO 91-081
⊕	1 EA	12 STATION CONTROLLER	RANBIRD ESP-13-10      TORO 10-09-10
⊕	4 EA	DAWN COUPLER VALVE	RANBIRD 448C      TORO 100-23VC
⊕	12 EA	VALVE BOX & COVER	AUMCO NO. 18104      CARSON NO. 910-12
⊕	10 EA	1 1/4" ELECTRIC CONTROL VALVE	RANBIRD 150-PCA      TORO 252-26-08
⊕	49 EA	LANDSCAPE SPRINKLER	RANBIRD 5004-PC-6.0      TORO 3700C-PC-6.0-LA
⊕	73 EA	MEDIUM TURF SPRINKLER	RANBIRD 3504-PC-3.0      TORO 3700C-PC-3.0-LA

**IRRIGATION PIPE SCHEDULE**

KEY	QUANTITY	EQUIPMENT DESCRIPTION	TECHNICAL INFORMATION
—	240 LF (VERIFY)	IRRIGATION SLEEVE (2" - 1")	SCHEDULE 40 P.V.C.
—	480 LF (VERIFY)	2" IRRIGATION MAINLINE	SDR 21 CLASS 200 P.V.C. 1120
—	240 LF (VERIFY)	2" IRRIGATION LATERAL	SDR 21 CLASS 200 P.V.C. 1120
—	500 LF (VERIFY)	1 1/2" IRRIGATION LATERAL	SDR 21 CLASS 200 P.V.C. 1120
—	800 LF (VERIFY)	1" IRRIGATION LATERAL	SDR 21 CLASS 200 P.V.C. 1120
—	2,200 LF (VERIFY)	3/4" IRRIGATION LATERAL	SDR 21 CLASS 200 P.V.C. 1120
—	220 LF (VERIFY)	IRRIGATION CONTROL CABLE	PAUC-18 GAUGE-7 CONDUCTOR COLOR CODED TYPE TO DIRECT BURST

**DRIP IRRIGATION EQUIPMENT SCHEDULE**

KEY	QUANTITY	EQUIPMENT DESCRIPTION	TECHNICAL INFORMATION
⊕	2 EA	CONTROL ZONE KIT	RANBIRD 302-100 COM
⊕	200 LF (VERIFY)	LANDSCAPE DRIPLINE (0.6 GPH @ 24")	RANBIRD LD-06-24
⊕	2 EA	TUBING END CLOSURE	RANBIRD 700-CT-21

**IRRIGATION PLAN**



**LANDSCAPE ARCHITECTURE**  
 325 Gates Joseph Dr.  
 Raleigh, NC 27603-5701  
 Phone: 919/594-2394  
 Fax: 919/594-2938

**IRRIGATION PLAN**  
 RED ROCK MEADOWS PARK  
 RAPID CITY, SOUTH DAKOTA

Project No.: 804-212  
 File Name: L5-IRRIGATION-PLAN-REV.DWG  
 Date: 1/10  
 Created By: RFP  
 Date: 2-18-09  
 Revision:

This drawing is prepared and issued under the supervision of a Licensed Professional Engineer. The Engineer's name and license number are shown on this drawing. The Engineer's seal is required for all drawings. The Engineer's seal is required for all drawings. The Engineer's seal is required for all drawings.

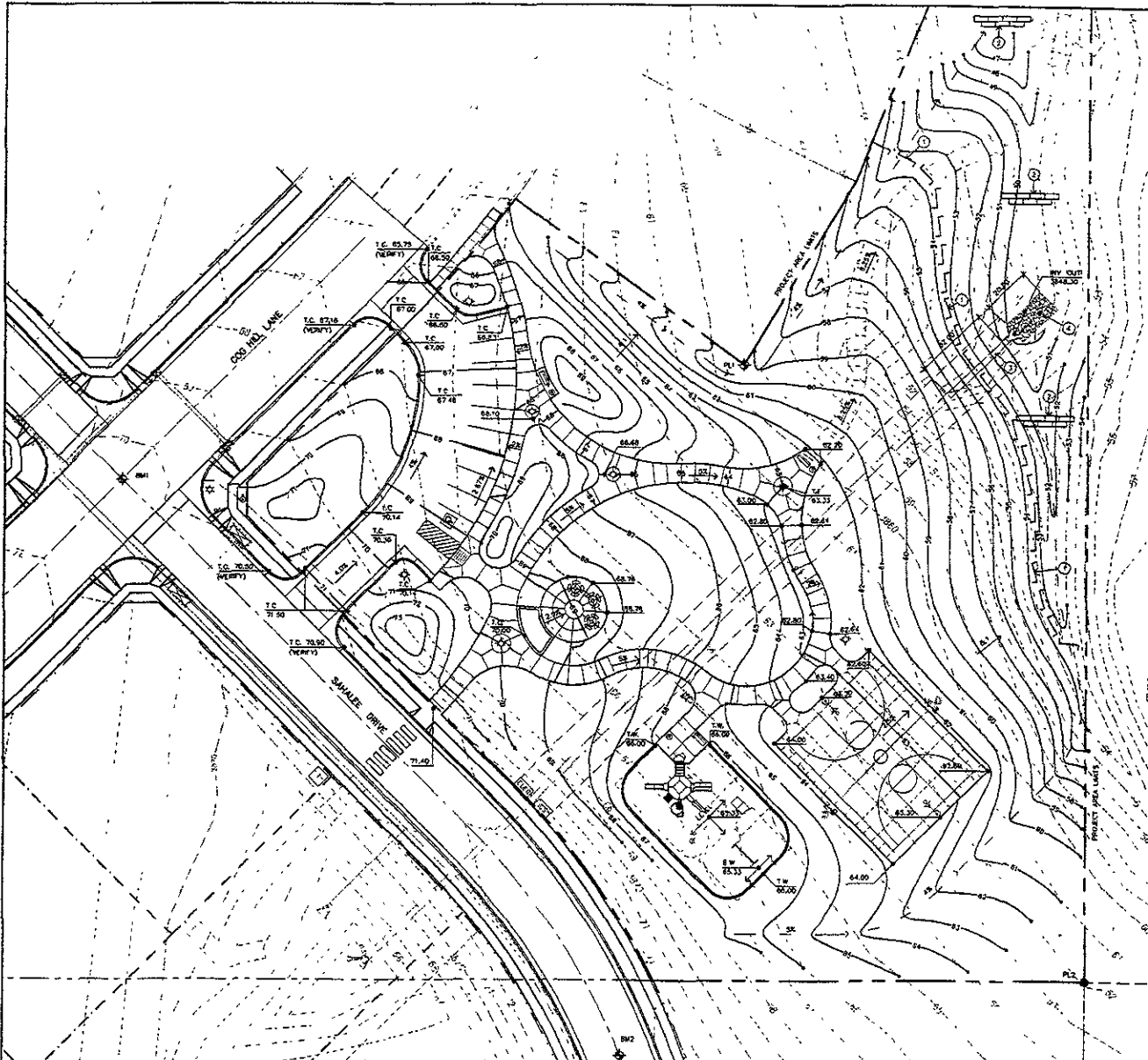

**GRADING NOTES:**

- **IMPROVEMENTS:** THE CONTRACTOR IS RESPONSIBLE FOR LOCATING ALL PUBLIC AND PRIVATE UTILITIES IN THE PROJECT AREA PRIOR TO CONSTRUCTION. NOTIFY AGENCIES OF ALL DISCREPANCIES. SOUTH DAKOTA ONE CALL INFORMATION: 800-785-3474
- **GRID STANDING:** CONTRACTOR IS TO FIELD VERIFY ALL NECESSARY ELEVATIONS PRIOR TO EXCAVATION OPERATIONS AND NOTIFY OWNER'S REPRESENTATIVE OF ANY DISCREPANCIES.
- **TOPSOIL:** STRIP & STOCKPILE TOPSOIL ON-SITE FOR REUSE. ALL SEEDING AND LANDSCAPE AREAS TO HAVE A MINIMUM OF 3 INCHES OF TOPSOIL.

**GRADING KEY NOTES:**

1. **SALT PILE:** CONTRACTOR TO INSTALL TEMPORARY SALT FENCE TO COMPLY WITH CITY OF RAPID CITY REQUIREMENTS.
2. **DRAINAGE SWALE PERIMETER:** METALLIC EXPOSURE BAILS TO EXPOSE WITH CITY OF RAPID CITY REQUIREMENTS.
3. **EXPOSED STAIRS:** 200 LBS OF 3/4" TOP SOIL TO BE MOVED EXISTING FLARED SECTION TO END OF PIPE.
4. **EXPOSURE PROTECTION:** RELOCATE ROCK PIPES TO DRAIN CUTLINE.

**GRADING LEGEND:**

- ⊕ BENCH MARK ELEVATION
- - - PROPOSED CONTOUR
- EXISTING CONTOUR
- DRAINAGE SWALE
- T.C. TOP OF CURB ELEVATION
- F.L. FLOW LINE ELEVATION
- H.P. HIGH POINT ELEVATION
- L.W. BOTTOM OF WALL ELEVATION
- B.W. BOTTOM OF WALL ELEVATION
- T.S. TOP OF STAIR ELEVATION
- B.S. BOTTOM OF STAIR ELEVATION
- 73.50 SPOT ELEVATION
- SALT FENCE
- EXPOSURE BAIL

**BENCH MARK DATA**

POINT NO.	X	Y	Z
BECON VALUE	EAST-WEST	NORTH-SOUTH	ELEVATION
BM1	12514.53	11693.70	5652.97
BM2	12475.70	11449.72	5673.22
<b>PROPERTY CORNERS:</b>			
PL1	12476.50	11742.09	
PL2	12623.22	11481.96	

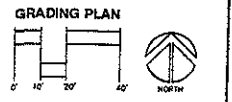

**GRADING PLAN**  
 RED ROCK MEADOWS PARK  
 RAPID CITY, SOUTH DAKOTA

Project No. 800-212  
 File Name 17-230-17-01-01.dwg  
 Drawn By LD  
 Checked By AS  
 Date 3-18-05  
 Revision

The drawings are prepared in accordance with the standards of the American Society of Civil Engineers (ASCE) and the American Society of Professional Engineers (ASPE). The drawings are to be used for the construction of the project and are not to be used for any other purpose without the written consent of the engineer.

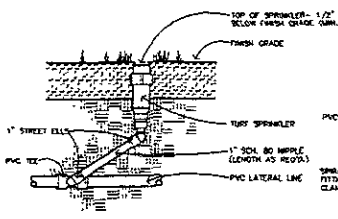

**A** LARGE-TURF SPRINKLER ASSEMBLY  
NO SCALE

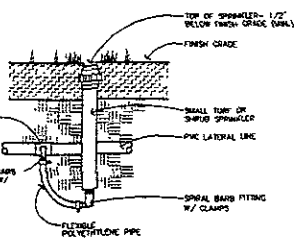

**B** SMALL-TURF SPRINKLER ASSEMBLY  
NO SCALE

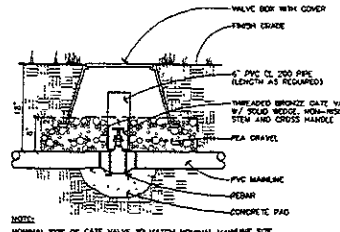

**C** ISOLATION GATE VALVE DETAIL  
NO SCALE

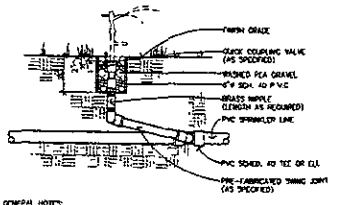

**D** QUICK COUPLING VALVE  
SCALE: 1/4\"/>

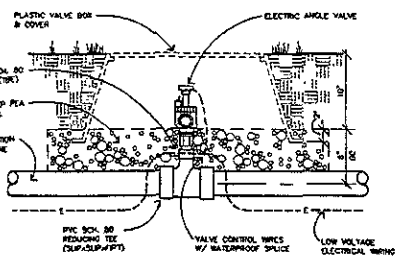

**E** ZONE VALVE BOX - SINGLE  
NO SCALE

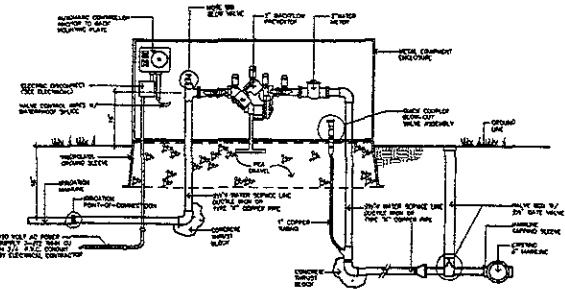

**F** WATER SERVICE DETAIL  
SCALE: 3/4\"/>

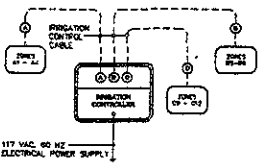

**G** IRRIGATION CONTROL WIRING DIAGRAMS  
NO SCALE

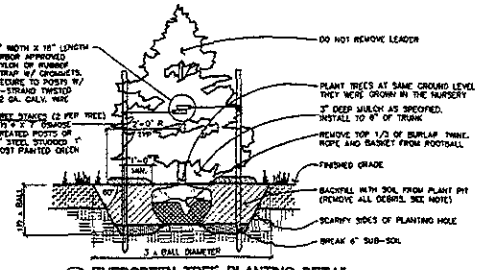

**H** EVERGREEN TREE PLANTING DETAIL  
NO SCALE

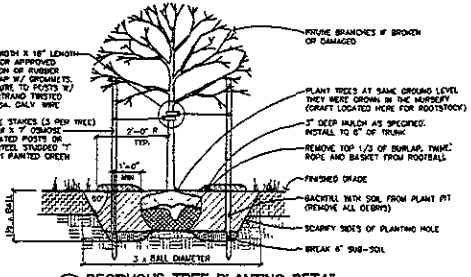

**I** DECIDUOUS TREE PLANTING DETAIL  
NO SCALE

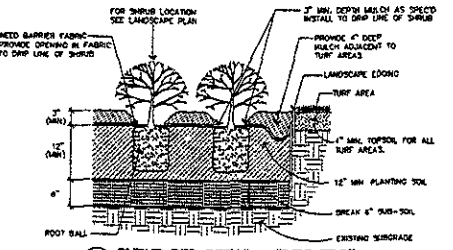

**J** SHRUB BED DETAIL - TURF EDGE  
NO SCALE



**IRRIGATION & LANDSCAPE DETAILS**  
 RED ROCK MEADOWS PARK  
 RAPID CITY, SOUTH DAKOTA

Project No. 804-212  
 File Name: 15-000-001-001.dwg  
 Drawn By: TD  
 Checked By: RJ  
 Date: 3-18-05  
 Revision:

This drawing is controlled by the Project Manager and is the property of Designworks, Inc. It is to be used only for the project and site identified on this drawing. No part of this drawing may be reproduced or transmitted in any form or by any means, electronic, mechanical, photocopying, recording, or by any information storage and retrieval system, without the prior written permission of Designworks, Inc.