

LAYOUT NOTES:

1. ALL DIMENSIONS ARE TO TOP BACK OF CURB, EDGE OF SIDEWALK, AND FACE OF BUILDING.
2. ALL DIMENSIONS ARE FEET UNLESS OTHERWISE SPECIFIED.

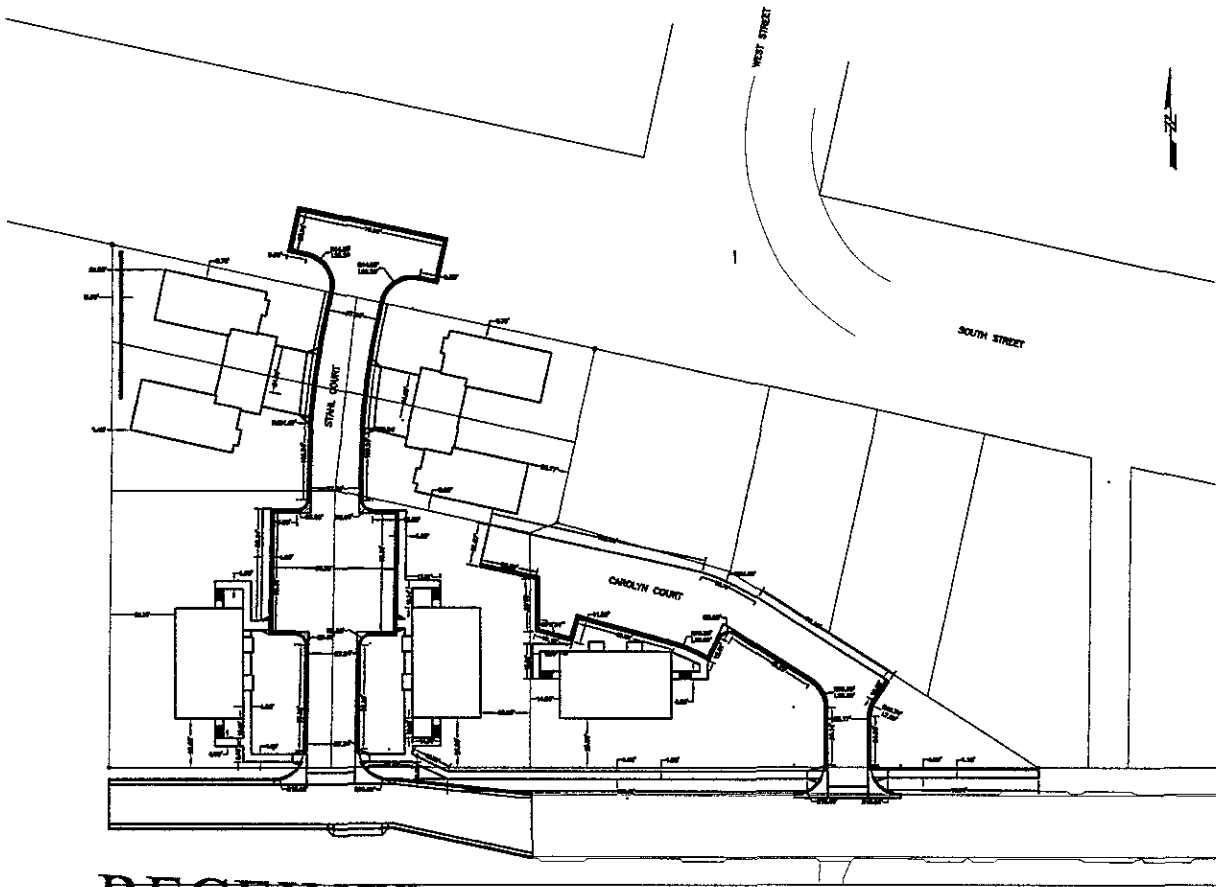

**APPROXIMATE TO BE USED**  
 ALL WORK SHALL BE CONSTRUCTED IN ACCORDANCE WITH THE CITY OF RAPID CITY STANDARD SPECIFICATIONS FOR PUBLIC WORKS CONSTRUCTION WITH SECTION WITH ALL CURRENT UPDATES.

**UTILITIES**  
 THE INFORMATION ON THESE DRAWINGS CONCERNING THE TYPE, SIZE AND LOCATION OF UTILITIES HAS BEEN OBTAINED FROM THE BEST INFORMATION AVAILABLE. THE CONTRACTOR IS RESPONSIBLE FOR VERIFYING THE LOCATION OF ALL UTILITIES PRIOR TO COMMENCING CONSTRUCTION. THE CONTRACTOR IS RESPONSIBLE FOR NOTICING AND MARKING UTILITIES IN PLACE. THE CONTRACTOR SHALL COORDINATE ALL RELATIONS WITH THE UTILITY COMPANIES.

ELECTRICAL, TELEPHONE, TELEVISION AND GAS UTILITIES MAY BE LOCATED ANYWHERE WITHIN THE RESPECTIVE UTILITY COMPANIES' SERVICE AREAS. ALL UTILITY COMPANIES SHALL BE CONTACTED BY THE CONTRACTOR BEFORE COMMENCING WORK IS COMPLETED.

- UTILITIES**
- |  |  |
|--|--|
| SEWER MAINS ONE DIA. 1-300-753-7074  | CURB STREET LIGHTS   |
| SELECTED BLACK HILLS POWER & LIGHT COMPANY   | CITY OF RAPID CITY TRAFFIC SIGNALS 709 STEELE AVENUE (605) 348-3300  |
| 400 RICHMOND AVENUE (605) 348-3300   | 709 STEELE AVENUE (605) 348-4976                                     |
| OTHER OFFICE BLACK HILLS UTILITIES 810 RICHMOND AVENUE (605) 721-8200                  | CAST SOUTHWEST-CANON UTILITIES 710 GAMING CITY STREET (605) 342-0780 |
| CORNING WASTE CITY OF RAPID CITY UTILITIES DEPARTMENT 810 STEELE AVENUE (605) 344-0285 | WALLINGTON BROS. PROPRIETARY PAVING COMPANY (605) 644-8822           |
| TELEPHONE 18 WEST (605) 873-1311   | 13 CALLEMAN 1001 EAST PENNSYLVANIA STREET (605) 342-3442             |

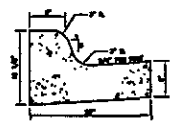

STANDARD CURB & GUTTER

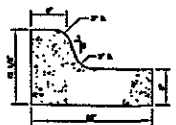

SEAL CURB & GUTTER

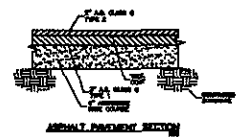

ASPHALT PAVEMENT SETTING

DATE: 02-09-05	SCALE: 1"=30' HOR	DRAWN: JRS	DESIGNED: JRY	CHECKED: DFC

STAHN VICTORIAN ADDITION  
LAYOUT PLAN

PROJECT NO.  
J01-102

SHEET NO.  
2/4

RECEIVED

FEB - 9 2005

Rapid City Growth  
Management Department