

RECEIVED

JAN 14 2005

Rapid City Growth Management Department

Land Projects\8801\Stoney Creek\dwg\8801Plan.dwg, LAYOUT, 01/14/2005 12:25:57 PM

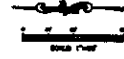
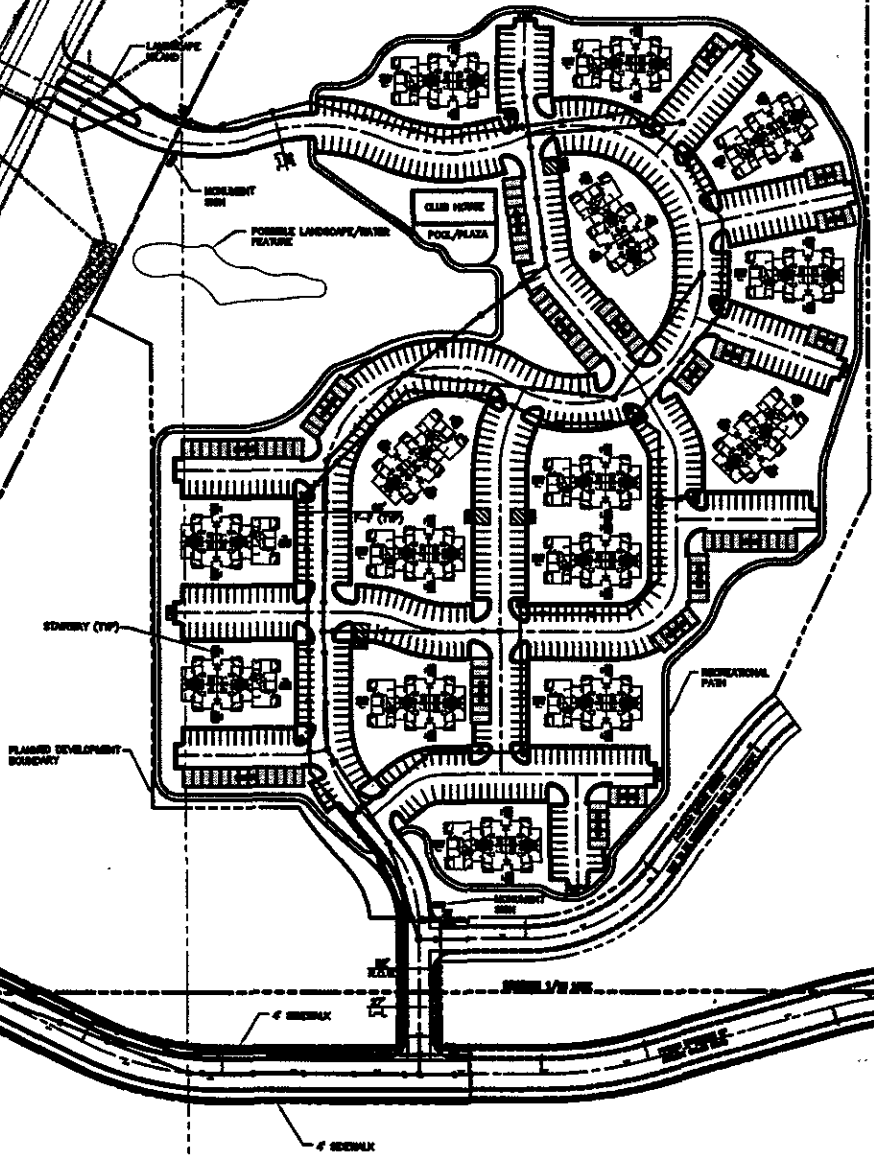

GENERAL NOTES:

1. This plan is prepared by the City of Rapid City, South Dakota, and is subject to the City's zoning and subdivision regulations. The City's zoning and subdivision regulations are available on the City's website at www.rapidcity.org.

2. The City of Rapid City, South Dakota, is not responsible for the accuracy or completeness of the information provided on this plan. The City of Rapid City, South Dakota, is not responsible for the accuracy or completeness of the information provided on this plan.

3. The City of Rapid City, South Dakota, is not responsible for the accuracy or completeness of the information provided on this plan. The City of Rapid City, South Dakota, is not responsible for the accuracy or completeness of the information provided on this plan.

GENERAL NOTES:

1. This plan is prepared by the City of Rapid City, South Dakota, and is subject to the City's zoning and subdivision regulations. The City's zoning and subdivision regulations are available on the City's website at www.rapidcity.org.

2. The City of Rapid City, South Dakota, is not responsible for the accuracy or completeness of the information provided on this plan. The City of Rapid City, South Dakota, is not responsible for the accuracy or completeness of the information provided on this plan.

3. The City of Rapid City, South Dakota, is not responsible for the accuracy or completeness of the information provided on this plan. The City of Rapid City, South Dakota, is not responsible for the accuracy or completeness of the information provided on this plan.

FMG, Inc.
 1000 S. DAKOTA
 RAPID CITY, SD 57702-0017
 (605) 342-4109 FAX (605) 343-4325
www.fmginc.com



File Number	
Project	
Client	
Design	
Drawn	
Checked	
Approved	

STONEY CREEK APARTMENTS
 CATRON BOULEVARD
 RAPID CITY, SOUTH DAKOTA

Revision/Date
 Sheet Name
CONCEPTUAL LAYOUT AND NOTES
 Sheet Number