

04PD073

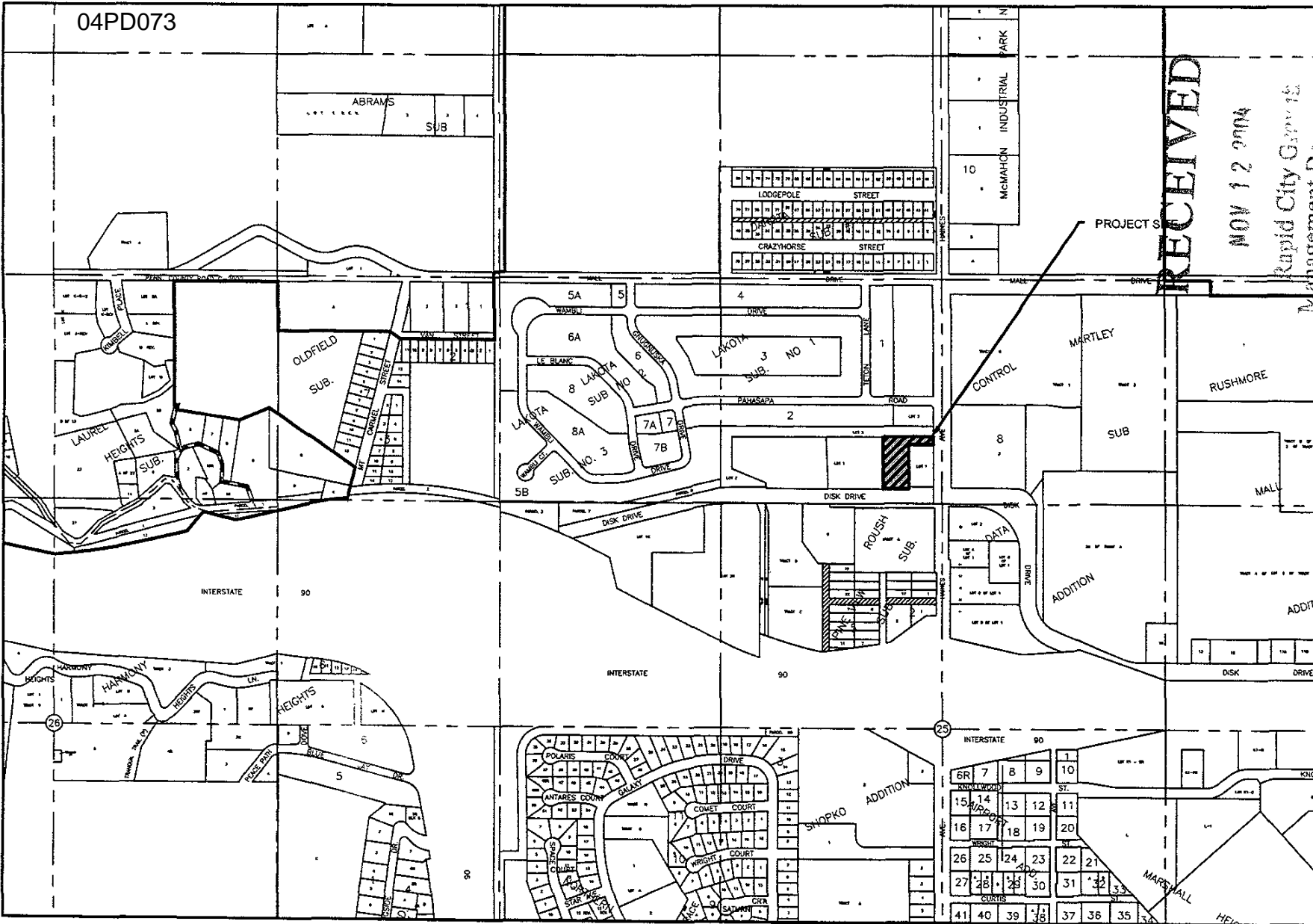

RECEIVED

NOV 12 2004

Rapid City City & County
Management Department

File Number: 0407
 Location: 1001A SECTION 30
 T4S, R7E, S4M
 Surveyed By: [Signature]
 Date: 06/07/04
 Original From: [Signature]
 Drawn By: [Signature]
 Checked By: [Signature]

IHOP RESTAURANT
 DISK DRIVE
 RAPID CITY, SD

VICINITY
 MAP

Sheet Number:
1 OF 1

FMG, Inc.
 6000 Sturgis Road
 Rapid City, SD 57701
 (605) 342-1100 FAX (605) 342-4222

04PD073

CRAZYHORSE STREET

NEIGHBORHOOD COMMERCIAL

DRIVE

MALL

DRIVE

TETON LANE (LDR ZONING)

LAKOTA SUB. NO. 1

SUB. 3

PAHASAPA ROAD

ROAD

(LDR ZONING)

LOT 3 (LDR ZONING)

LOT 2 (LDR ZONING)

PROJECT SITE FOR IHOP PLANNED DEVELOPMENT

LOT 1 TUNES PLUS (GENERAL COMMERCIAL)

CONTROL 3 (GENERAL COMMERCIAL)

KOWE'S SUB. RECEIVED

SUB. 5

LOT 4

DISK DRIVE

DISK DRIVE

EXISTING DETENTION POND

GENERAL COMMERCIAL

HARBEE'S LOT 2

LOT 4 PER ONE

LOT 5 SAME AS IN THE KITCHEN

LOT 6 KOHLS

DRIVE

SCALE: 1" = 60'

ALL INFORMATION SHOWN HEREON IS FROM AERIAL PHOTOGRAPHS TAKEN IN 1998. PROPERTY LINES SHOWN IN PINK CITY SURVEY IS APPROXIMATE FOR LOCATIONS ON THE PHOTO. THE LINES OF ANY SUBDIVISION ARE TO THE LOCATION OF ANY INFORMATION SHOWN ON THE MAP.

FMG, Inc.
3700 S. Giorgio Road
Rapid City, SD 57702-0317
(605) 342-4105 FAX (605) 342-4223



NOT FOR CONSTRUCTION

File Number: 04PD073
Location: 1/4 SEC. 10, T. 14N, R. 10W
Submitted By: [unclear]
Date: 02/08/04
Designed By: [unclear]
Drawn By: [unclear]
Checked By: [unclear]

IHOP RESTAURANT
DISK DRIVE
RAPID CITY, SD

Revision/Date
Sheet Name:
AERIAL VICINITY MAP

Sheet Number:
A1 of A1

- 1 GAS METER SEE CIVIL AND PLUMBING DRAWINGS.
- 2 TELEPHONE BACKBOARD SEE ELECTRICAL AND CIVIL DRAWINGS.
- 3 MAIN SWITCHBOARD SEE ELECTRICAL DRAWINGS.
- 4 PROPOSED TRANSFORMER PAD, SEE ELECTRICAL.
- 5 GREASE WASTE INTERCEPTOR, SEE PLUMBING AND CIVIL DRAWINGS.
- 6 NOT USED.
- 7 NOT USED.
- 8 ASPHALT OR CONCRETE PAVEMENT SEE CIVIL DRAWINGS.
- 9 3' x 5' MINIMUM LEVEL LANDING TYPICAL (2% MAXIMUM SLOPE IN ANY DIRECTION)
- 10 ADA SIGNAGE SEE SHEET CS-2
- 11 ENTRY WALK SEE DETAIL 2/SD-1
- 12 NOT USED.
- 13 PROPOSED FREE-STANDING SIGN LOCATION SEE ELECTRICAL DRAWINGS FOR POWER REQUIREMENTS
- 14 CURB RAMP MAX. 1/2 SLOPE x 6'-0" LONG SEE DETAIL 5/SD-3
- 15 4" WIDE PARKING STALL STRIPE
- 16 CONCRETE APRON
- 17 LINE OF AVENING TYPICAL
- 18 AREA DRAIN SEE CIVIL DRAWINGS
- 19 GUTTER TYPICAL
- 20 SITE LIGHT POLE SEE ELECTRICAL DRAWINGS
- 21 NOT USED
- 22 NOT USED
- 23 NOT USED
- 24 WHEELSTOP TYPICAL SEE DETAIL 10/SD-3.
- 25 HANDICAP PARKING SIGN TYPICAL, SEE DETAIL 11/SD-3
- 26 NOT USED
- 27 3/4" WIDE x 1/4" DEEP DIRECTIONAL GROOVES - 12" OVERALL DEPTH
- 28 INTERNAL RAMP, SEE DETAIL ON CS-2
- 29 WATER METER

NOTE: COORDINATE ALL SITE INFORMATION AND DETAILS WITH CIVIL DRAWINGS

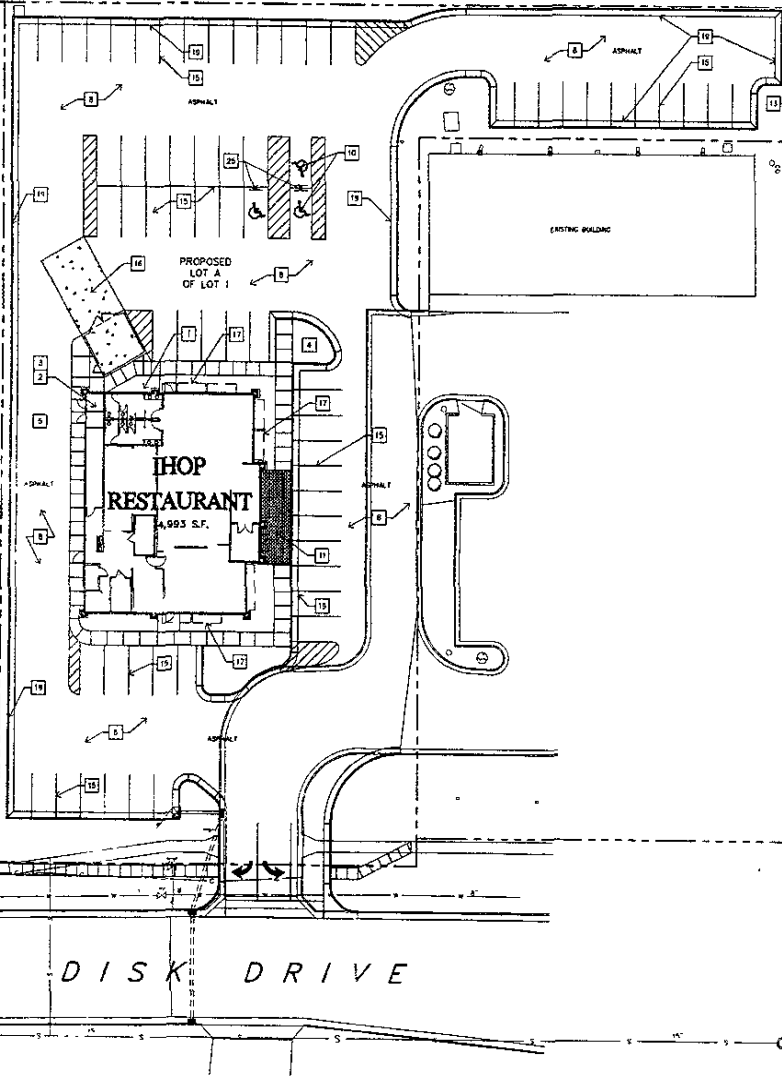

1 SITE PLAN
SCALE: 1" = 20'-0"



RECEIVED

NOV 12 2004

Rapid City Growth
Management Department

2 EXTERIOR ENTRY WALK PLAN
SCALE: 1/4" = 1'-0"

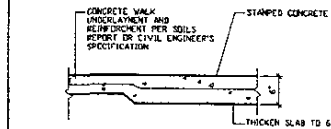

A: NORMAL CONDITION

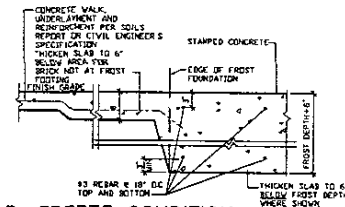

B: FREEZE CONDITION

3 ENTRY TILE "SECTIONS"
SCALE: 1" = 1'-0"

REVISIONS	

CONSULTANT

SEAL

CS-2
CARPENTER STRINGHAM
 522 WEST 100 SOUTH
 SALT LAKE CITY, UTAH 84102
 PHONE 801.338.4555
 FAX 801.338.4555
 WWW.STRINGHAM.COM
 ARCHITECTURE PLANNING INTERIORS

IHOP
RESTAURANT

STORE NO. **3044**

LOCATION:
 IHOP RESTAURANT
 Disk Drive & Holmes Avenue
 Rapid City, South Dakota 57701

DATE	11/03/04
ISSUED FOR:	
PERMITS	
DES	
CONSTRUCTION	
SCALE	AS NOTED
DRAWN BY:	
JOB NO.	04-142 01
SHEET TITLE	

SITE PLAN
SHEET NO.
SD-1