

RECEIVED

SEP 24 2004

Rapid City Growth Management Department

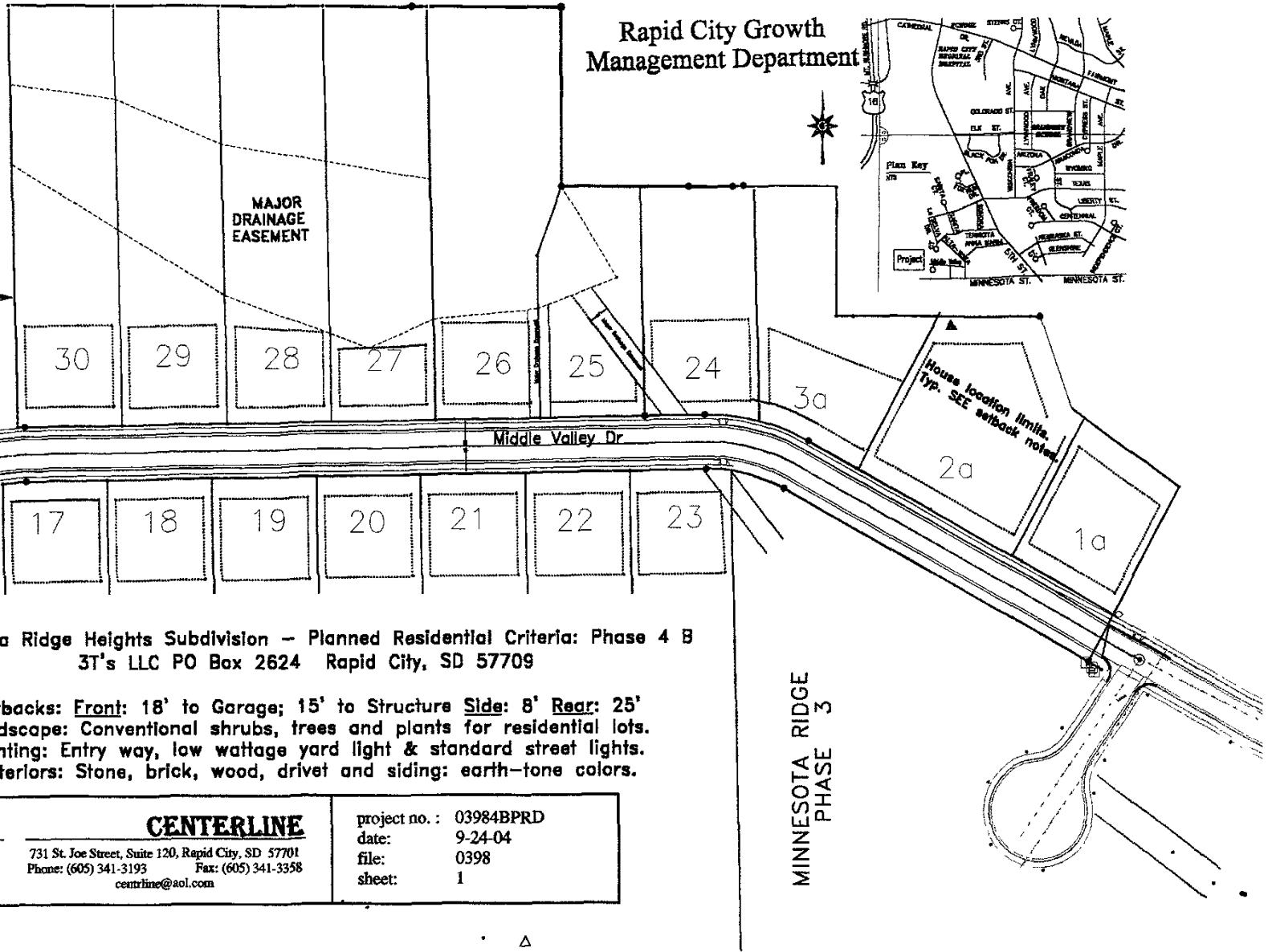
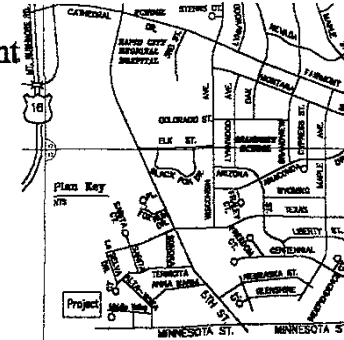

MINNESOTA RIDGE
PHASE 3

Minnesota Ridge Heights Subdivision - Planned Residential Criteria: Phase 4 B
3T's LLC PO Box 2624 Rapid City, SD 57709

Setbacks: Front: 18' to Garage; 15' to Structure Side: 8' Rear: 25'
Landscape: Conventional shrubs, trees and plants for residential lots.
Lighting: Entry way, low wattage yard light & standard street lights.
Exteriors: Stone, brick, wood, drivet and siding: earth-tone colors.

	CENTERLINE	project no. : 03984BPRD
	731 St. Joe Street, Suite 120, Rapid City, SD 57701 Phone: (605) 341-3193 Fax: (605) 341-3358 centrline@aol.com	date: 9-24-04 file: 0398 sheet: 1