

LOT 9 NOTICE
 BEFORE STARTING YOUR PROJECT MAKE
 SURE YOU HAVE CHECKED FOR UNDER-
 GROUND UTILITIES ON ALL PUBLIC AND
 PRIVATE PROPERTY.

PLOT PLAN
 FOR LOT 9 BLK. 2
 OF TERRACITA HIGHLIGHTS SUBDIVISION
 IN THE CITY OF RAPID CITY
 IN THE COUNTY OF
 PENNINGTON COUNTY, SOUTH DAKOTA

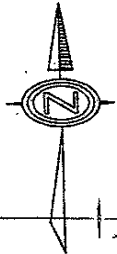

SCALE 1" = 10'-0"

PROVIDE PAVED PARKING
 AND DRIVEWAY PER
 RAPID CITY MUNICIPAL
 CODE SECTION 17.50 270.1

RECEIVED

AUG 27 2004

Rapid City Growth
 Management Department

Craig Schaefer Home

3917 City View Drive

Rapid City, SD 57701

Existing Deck to be Enclosed
With Dakota Sunrooms Enclosure

August 16, 2004

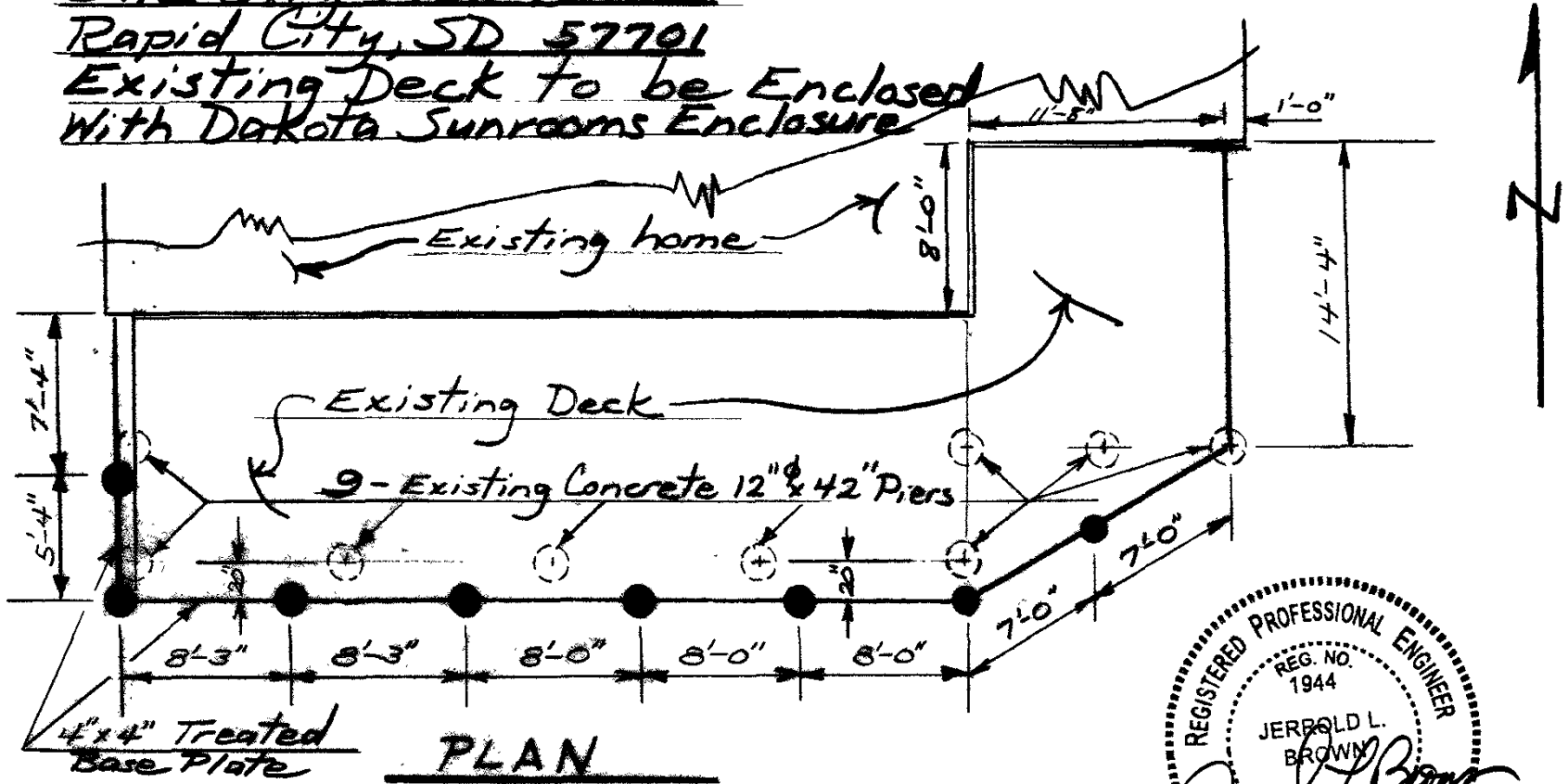

- New 12" ϕ x 42" Concrete Piers - 8 total
- Concrete Piers ~ Use 3000psi Concrete
- Use: 2 - 5/8" x 9" Anchor bolts each Pier

RECEIVED

AUG 27 2004

Rapid City Growth
Management Department

Jerrold L. Brown, P.E.
4712 Edgewood Dr.
Rapid City, S.D. 57702