

EXISTING APPROACH ONTO OMAHA STREET WILL BE UTILIZED FOR NEW DEVELOPMENT APPROACH. THIS WAS APPROVED & CONSTRUCTED WITH OMAHA STREET CONSTRUCTION. PER GARY ENGEL WITH SOUTH DAKOTA D.O.T. 8-21-04.

THESE 4 PARKING SPACES CHANGED TO LANDSCAPE TO ALLOW FOR IMPROVED LANDSCAPING EDGE ALONG OMAHA STREET

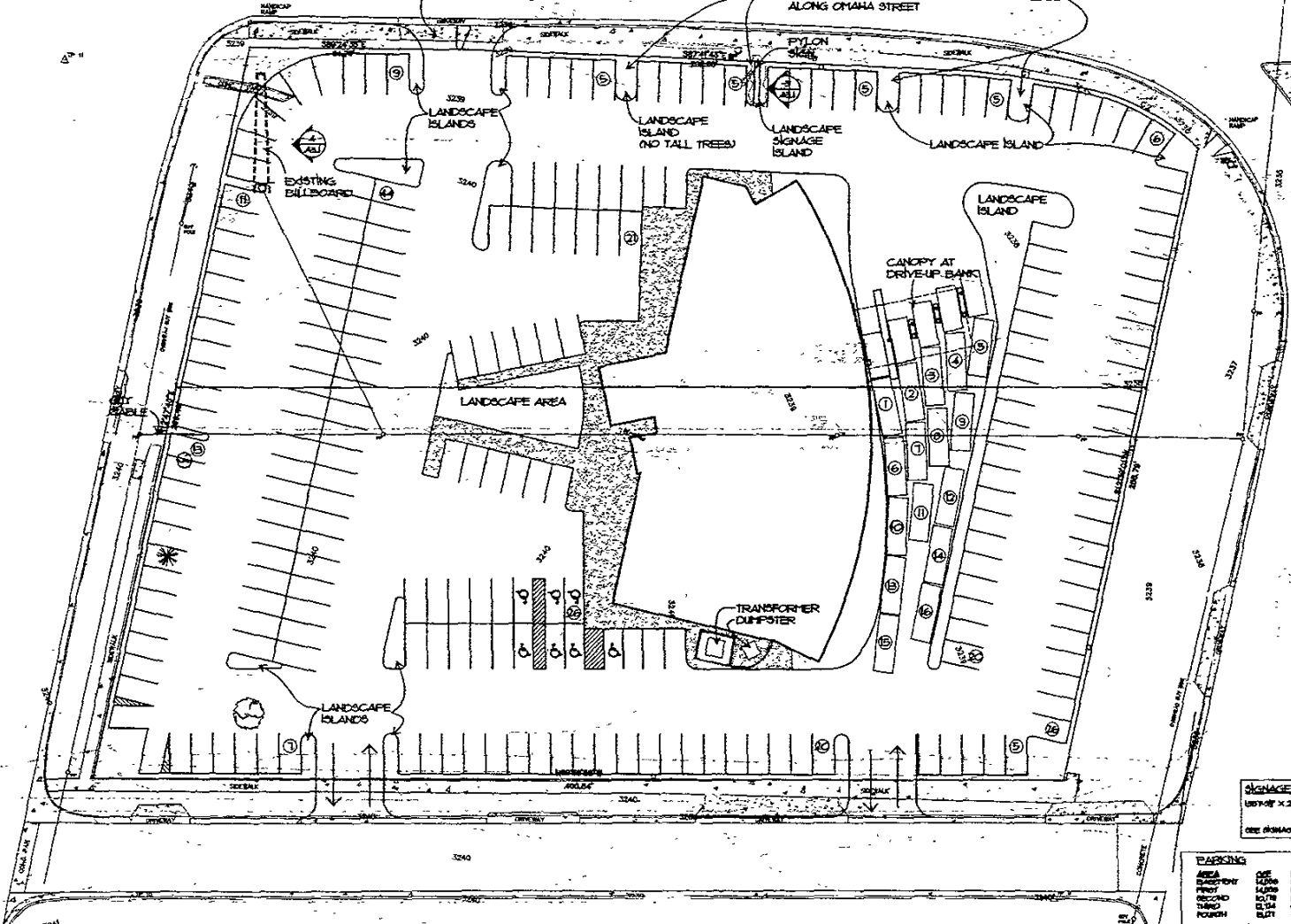

SIGNAGE CALCULATION
 10'x10' x 2 SF = BUILDING DAMAGE - 2,540 SF
 SITE SIGNAGE - 2,540 SF
 SEE DAMAGE DRAINAGE ON A11 & A12

PARKING

AREA	TYPE	REGULAR (10'x20')	PARKING REQUIRED
EMPLOYE	1475	34	34
PROF	1475	34	34
SECUR	1475	34	34
THRD	1475	34	34
FOURTH	1475	34	34
TOTAL PARKING REQUIRED			201 - 202
PARKING PROVIDED IN MEAL DECK			-20
4 SPACES CHANGED TO LANDSCAPE ISLANDS			-4
SPACES BIOMANUALLY PROVIDED			[22]

T. ACCESSIBLE SPACES
 5 ARE VAN ACCESSIBLE
 8 CURVE-UP LINES WITH 16 STALLS SPACES

1 SITE PLAN
 A11 NTS

PRELIMINARY
 NOT FOR
 CONSTRUCTION

ARC
 ARCHITECTURAL
 CONSULTANTS
 1015 S. UNIVERSITY AVE. SUITE 101
 RAPID CITY, SOUTH DAKOTA 57701
 TEL: 605.342.2222 FAX: 605.342.2223

PROJECT NO. 2003-018
 DATE: 8/20/04
 DRAWING NO. SITE PLAN

First Western Gateway
 Rapid City, South Dakota
 SITE PLAN

A1.1