

SPECIAL EXCEPTION EXHIBIT

PRIMARY ACCESS VIA SAMMIS TRAIL
TRAIL CONSTRUCTED WITH
PHASE 1

← TO HWY 16 SAMMIS TRAIL



SCALE: 1" = 400'

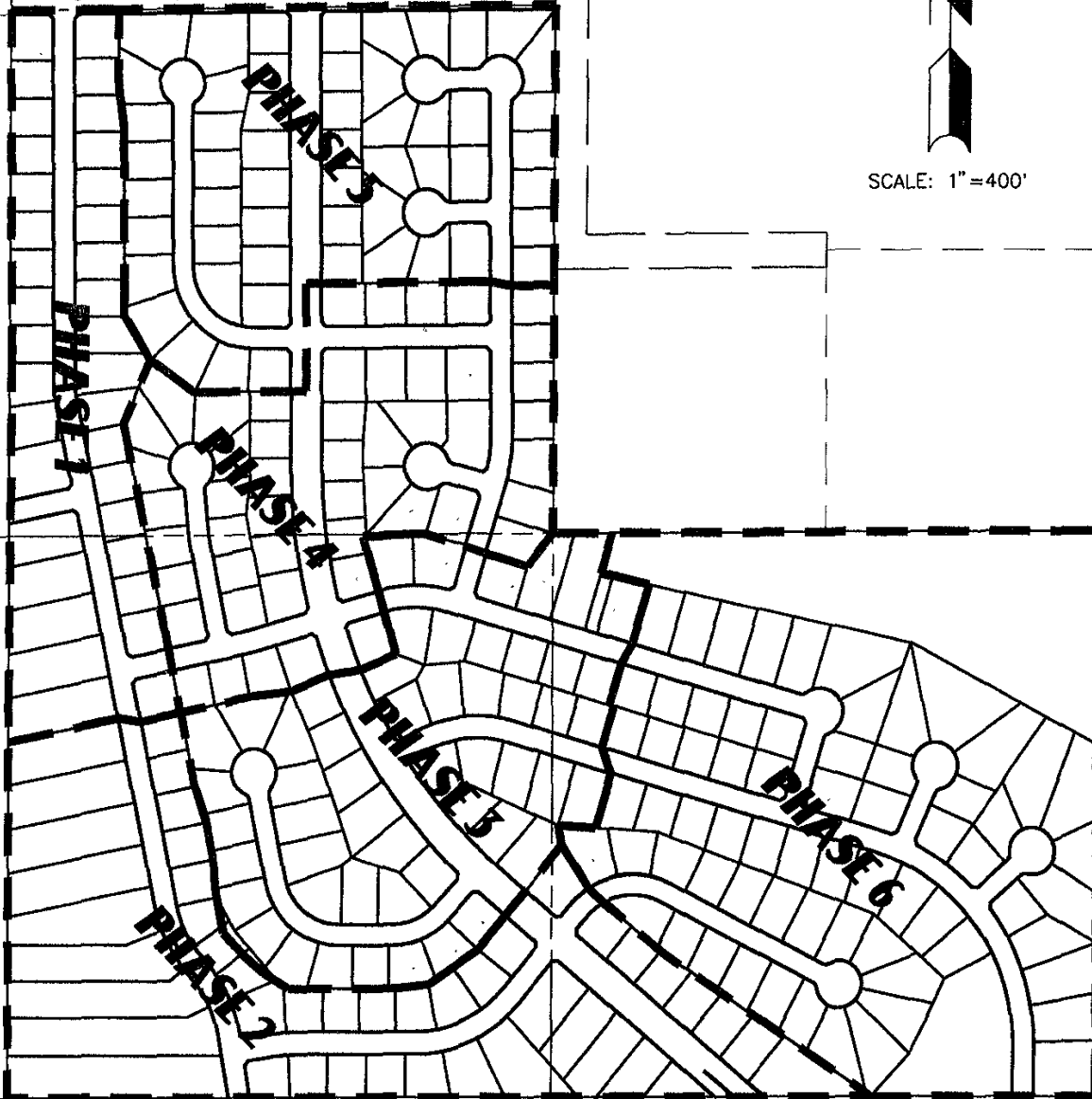

SECONDARY ACCESS VIA HART RANCH ROAD
CONSTRUCTED AT THE END OF PHASE 2

HYLAND PARK SUBDIVISION

| | |
|------------------|--------|
| JOB NO: 04-0008 | REV 1: |
| DATE: 06/25/2004 | REV 2: |
| DRAWN BY: RDC | REV 3: |



D.D.I.
DREAM DESIGN INTERNATIONAL, INC.
 PROFESSIONAL STRUCTURAL & CIVIL ENGINEERING CONSULTANTS
 528 KANSAS CITY ST., SUITE 4, RAPID CITY, SD 57701
 PH. 605-348-0638 FAX. 605-348-0545 EMAIL: eng@dreamdesigninc.com

PLOT SCALE: 1" = 400' DATE: 06/24/04 TIME: 07:38 PM \\Server\architect\04-0008\hyland\special_exception.dwg