

Top view

# Footing Detail For Brick Base

04SR047

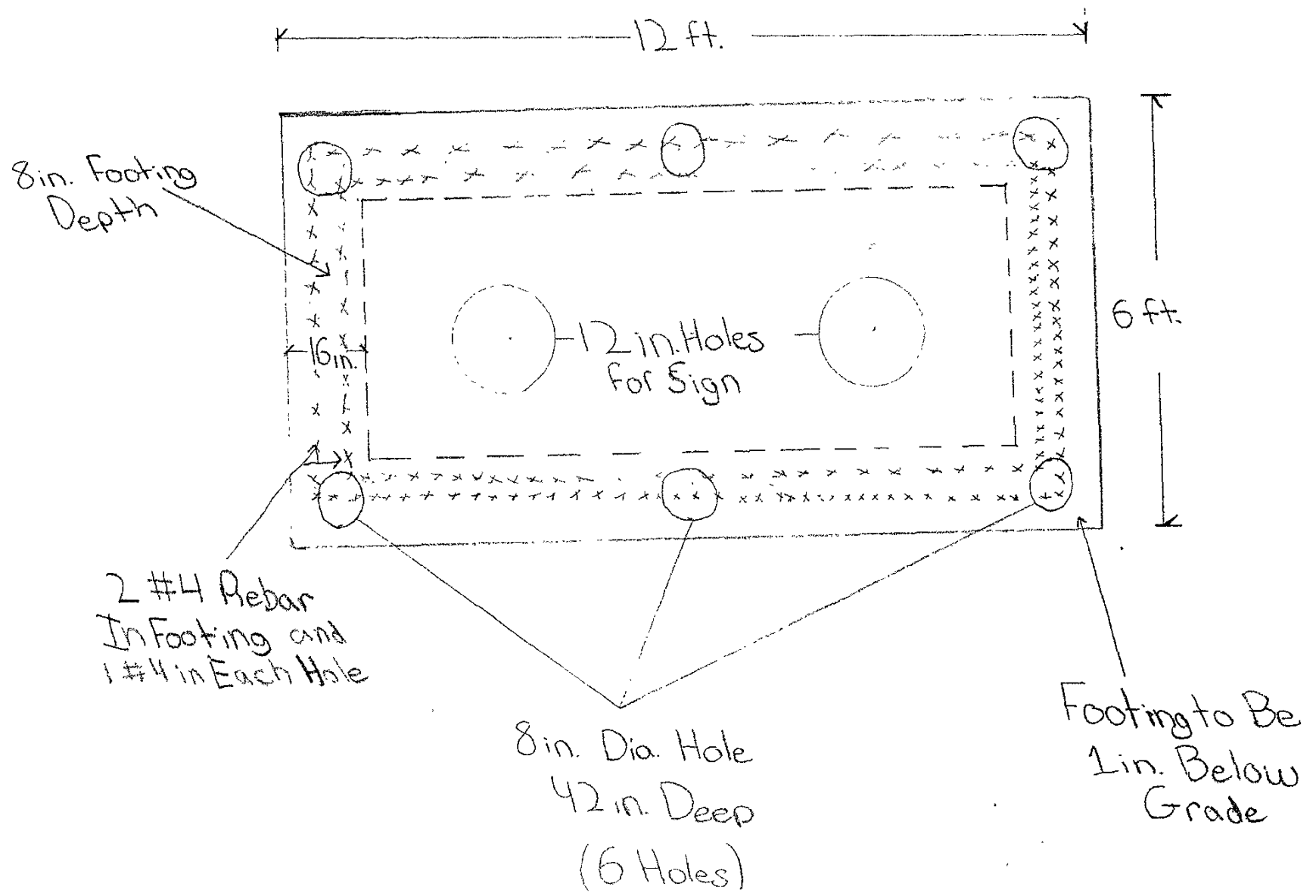

## GENERAL NOTES:

- LETTERING SHOULD BE IN A HISTORIC STYLE FONT.
- 8' HIGH MAROON, RAISED LETTERS FOR MAIN TEXT.
- 3' HIGH MAROON, RAISED LETTERS FOR SECONDARY TEXT.
- WOOD STRUCTURE TO BE PAINTED TO MATCH EXISTING PERGOLA.
- ALL WOOD TO BE PRESSURE TREATED PINE.

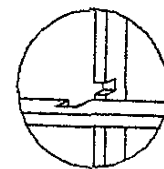

DOUBLE DADO EXAMPLE

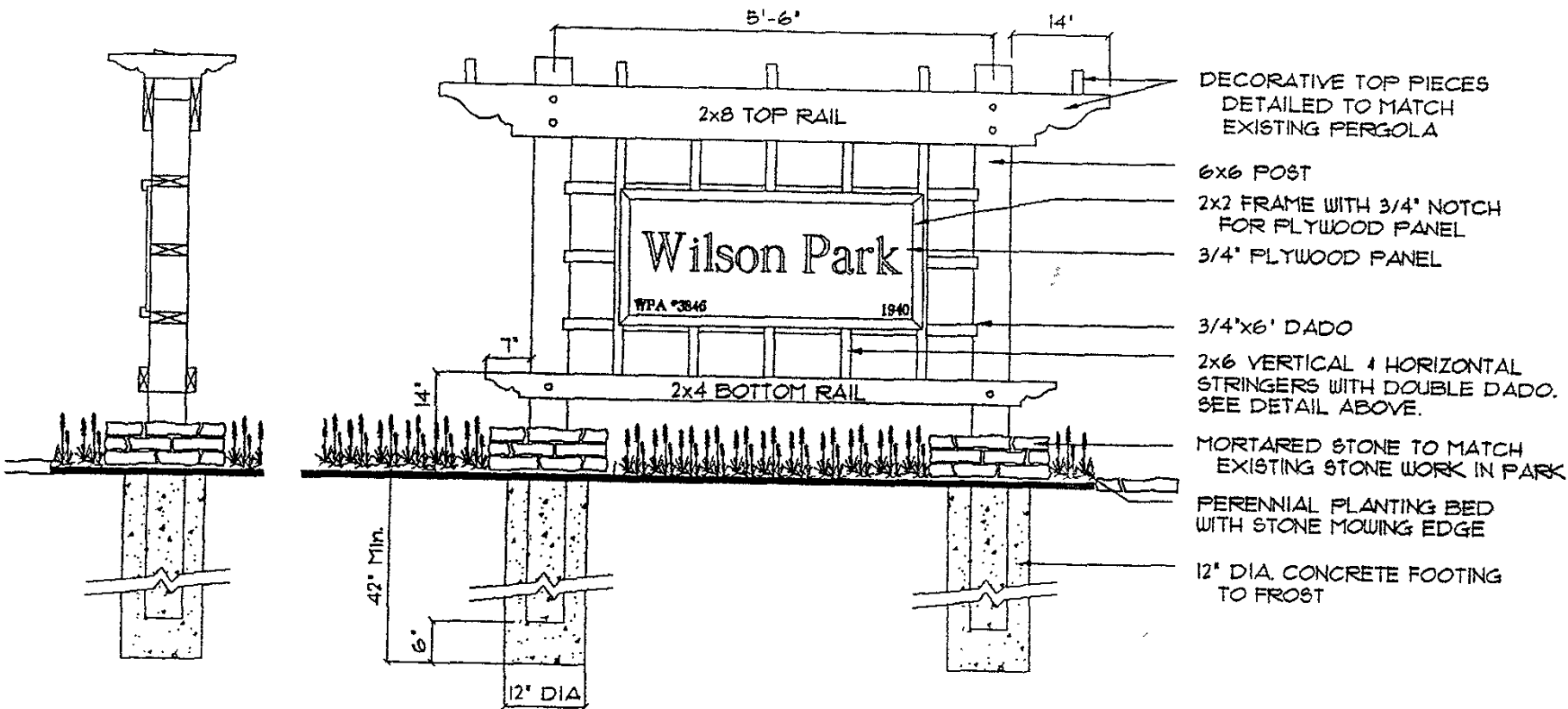

CONCEPT 'B'

# Wilson Park Sign Detail

May 4th, 1994

Scale 1/2" = 1'-0"

 Wyss  
Associates, Inc.  
Landscape Architecture

728 Sixth Street  
Rapid City, SD 57701-3870  
(605) 348-2268 Fax (605) 348-6506